

# Ultra Compact Modbus Gateways

Models MESP211D, MESP211T



### PRODUCT FEATURES

- Modbus TCP Ethernet, Modbus ASCII & RTU RS-232/422/485
- Modbus Flexibility – Serial & Ethernet, Masters & Slaves
- View Messaging Status in Real Time
- Ultra Compact IP30 Metal Enclosure
- International Power Supply (included)

Models MESP211D and MESP211T, Vlinx™ series Modbus Gateways, connect Modbus devices to Ethernet networks and let you monitor and control Modbus devices from anywhere on the Ethernet LAN or WAN. Supporting up to 16 masters and 32 slaves, these gateways feature an auto-detecting 10/100 Ethernet copper RJ-45 port and a serial port that supports RS-232/422/485 communications via a DB9 male or a terminal block connection.

The product is built for use in industrial environments with a heavy-duty metal enclosure that is panel (standard) or DIN rail mountable (with optional adapters). The product can be supplied with a DC power source ranging from 10 to 30 VDC and features a barrel connector. A power supply is included.

### Ease of Use

Configuration, upgrades and monitoring of the serial server are simple, easy tasks with Vlinx Manager Software. It installs on your PC giving access to the serial server via your desktop. Remotely manage the Modbus Gateway over a LAN or WAN via the build-in web server. This is helpful for off-site troubleshooting and can be done with an ordinary web browser.

### Software Support

Windows XP (32/64 bit), 2003 Server (32/64 bit), Vista 32/64 bit), 2008 Server (32/64 bit), Windows 7 (32/64 bit), Windows 8 (32/64 bit), Windows 10 (32/64 bit).

### ORDERING INFORMATION

MODEL NUMBER	PROTOCOL	SERIAL PORT	ETHERNET PORT	ETHERNET CONNECTOR
MESP211D	RS-232/422/485	DB9 Male	1	RJ45
MESP211T	RS-232/422/485	Removable Terminal Block	1	RJ45

### ACCESSORIES

**SMI6-12-V-P5** - Included Power Supply, 12 VDC 6 Watt, 5MM Plug, International AC Input, International AC Blades

**DRAD35** - Optional DIN rail adapter clip (pair)

**232NM9** - Optional null modem crossover cable

All product specifications are subject to change without notice.  
MESP211D & MESP211T\_3617ds

# Ultra Compact Modbus Gateways

Models MESP211D, MESP211T



## SPECIFICATIONS

SERIAL TECHNOLOGY	
RS-232 (DB9)	TD, RD, DTR, DSR, RTS, CTS, DCD plus Signal Ground
RS-485 2-Wire	Data A(-), Data B(+), GND
RS-422/485 4-Wire	TDA(-), TDB(+), RDA(-), RDB(+), GND
Serial Protocols & Connectors	
MESP211D:	RS-232/422/485 (DB9 male)
MESP211T:	RS-232/422/485 (removeable terminal block)
Data Rate	Up to 230.4 Kbps
POWER	
Source	Power supply, included
Input Voltage	10 to 30 VDC
Power Connector Dimensions	5.5 x 2.1 mm
Power Consumption	2.5 Watts, maximum
POWER SUPPLY (INCLUDED)	
Input Voltage	90 to 264 VAC
Frequency	47 to 63 Hz
Power Consumption	No load; Level VI = 0.1W; ErP Tier 1 = 0.075W
Operating Temperature	0 to +40 °C
Storage Temperature	-10 to +70 °C
Operating Humidity	20 to 80%
Storage Humidity	10 to 90%
Internation Blade Kit	North America, Europe, U.K., Australia, China, Japan
MECHANICAL	
LED Indicators	Serial Port, Ethernet, Ready
Switches	Reset Button
Dimensions	7.938 x 5.257 x 2.209 cm (3.125 x 2.070 x 0.870 in)
Enclosure	Metal, IP 30
ENVIRONMENTAL	
Operating Temperature	-40 to +80 °C (-40 to +176 °F)
Operating Humidity	10 to 95% Non-condensing
MEANTIME BEFORE FAILURE (MTBF)	
MTBF	MESP211D: 997311 hours MESP211T: 1020400 hours
MTBF Calculation Method	MIL 217 F Parts Count Reliability Prediction

## SPECIFICATIONS- continued

NETWORK	
Serial Memory	8 KB per port
Network Memory	4 KB
LAN	10/100 Mbps auto-detecting, 10BaseT or 100BaseTX
Ethernet	IEEE 802.3 auto-detecting & auto MDI/MDI-X, 10BaseT and 100Base TX
PROTOCOLS	
Protocols	TCP, IPv4, UDP, ARP, HTTP 1.0, ICMP/PING, DHCP/BOOTP
IP Mode	Static, DHCP
TCP/UDP	User definable
UDP	Unicast or Multicast
OTHER	
Connection Mode	Server, Client, VCOM, Paired
Client Connection	At power up or upon data arrival
Search	Serial direct COM and Ethernet Auto Search or specific IP
Diagnostics	Display PC IP, ping, test VCOM
Firmware Upgrade	via Vlinx™ Manager
CONFIGURATION SOFTWARE	
Vlinx™ Manager	Windows XP (32/64), 2003 Server (32/64), Vista (32/64), 2008 Server (32/64), 7 (32/64), 8/8.1 (32/64), 10 (32/64)
REGULATORY / CERTIFICATIONS / SAFETY	
Compliance	FCC Part 15 Class B
EMC	2004/108/EC, Electromagnetic Compatibility Directive 2011/65/EU, Reduction of Hazardous Substances Directive EN55022:+AC, Information Technology Equipment - Class B RF Emissions EN55024:, Information Technology Equipment - Immunity (Light Industrial Environments) EN61000-4-2 ESD Immunity EN61000-4-3:+A2:, Radiated Field Immunity (RFI) EN61000-4-4:, EFT/Burst Immunity EN61000-4-5:, Electrical Surges Immunity EN61000-4-6:, RF Conducted Immunity

## MECHANICAL DIAGRAM - MESP211T

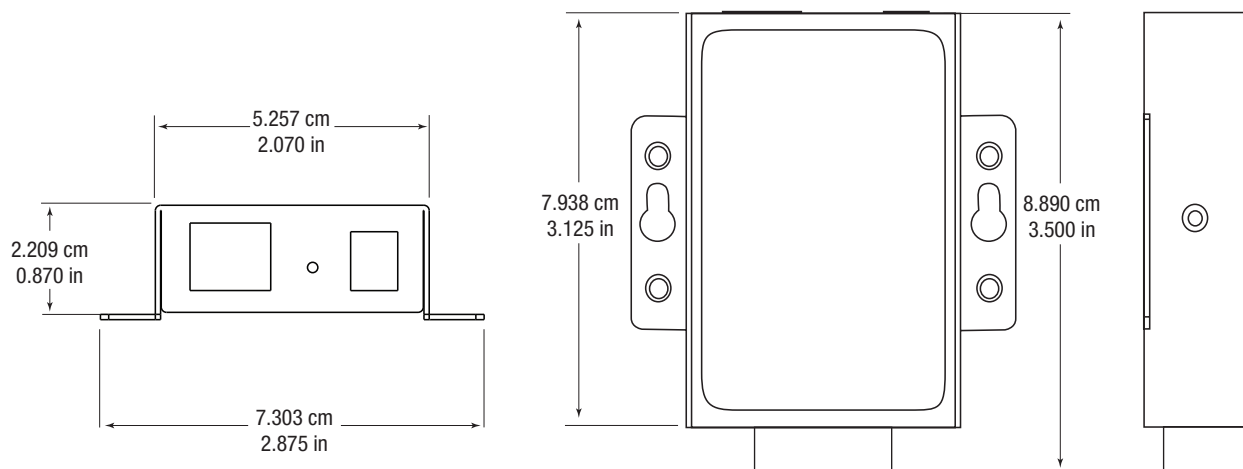

**B+B SMARTWORX**

Powered by

**ADVANTECH**

orders@advantech-bb.com  
support@advantech-bb.com

Corporate Headquarters: 707 Dayton Road, PO Box 1040 Ottawa, IL 61350 USA 815-433-5100 Fax 433-5104  
European Office: Westlink Commercial Park, Oranmore Co. Galway Ireland +353 91 792444 Fax +353 91 792445