

REV.	DATE	REVISION RECORD	DR.
A	04/06/2000	ORIGINAL	L.L.
B	05/17/2000	"60 VAC MAX., 0.1 A, 3 VA MAX." IT WAS "0.25 A & 120 VAC."	L.L.

NOTES:

1. ELECTRICAL:

1.1. CONTACT CAPACITY 60 VAC MAX., 0.1 A, 3 VA MAX..

2. OPERATE:

2.1. WHEN STATIONARY IN ANY POSITION

THE SWITCH CONTACTS WILL ALWAYS REMAIN OPEN
AND UPON VIBRATION OR MOVEMENT THE CONTACTS
WILL INTERMITTENTLY CLOSE.

3. FINISH:

3.1. EXTERNALLY TIN PLATED.

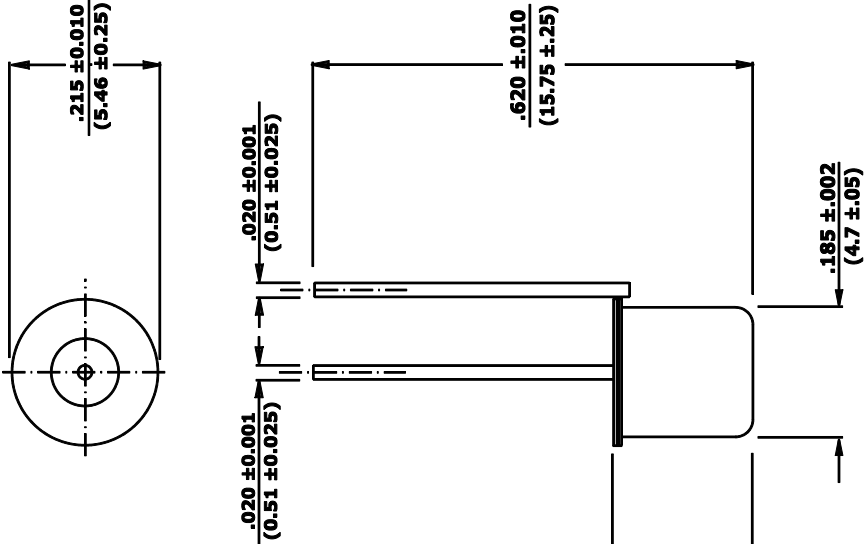

COMUS INTERNATIONAL

454 ALLWOOD RD. CLIFTON, NJ 07012 U.S.A. PH (973) 777-6900

TOLERANCES (except as noted)		REF.:	SCALE:	DRAWN BY: L.L.	APPROVED:
			NONE		
DECIMAL + .01 (.254) 2 Digit - .005 (.127) 3 Digit		TITLE: MINIATURE NORMALLY OPEN VIBRATION SENSOR			
		DATE: 05/06/2000	DRAWING NUMBER: CM1344-1		