



Copyright FCI.



FCIconnect.com



1 | 2

3 |

4

PRODUCT NUMBER	PITCH
YK516xx3x0J0G	9.50 mm

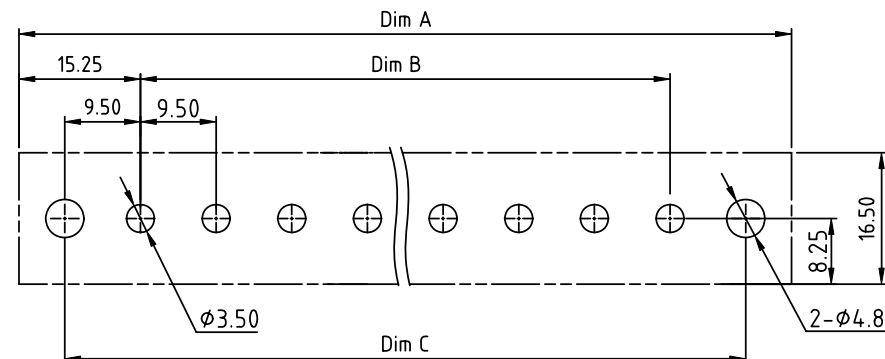
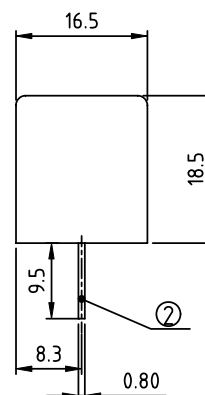
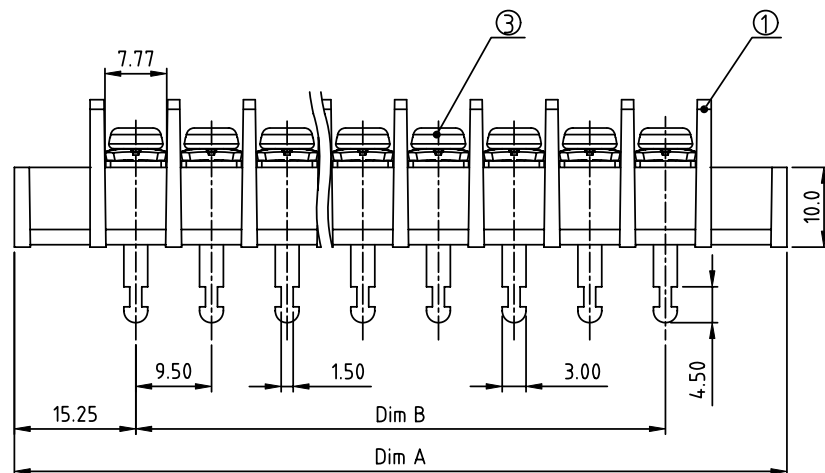
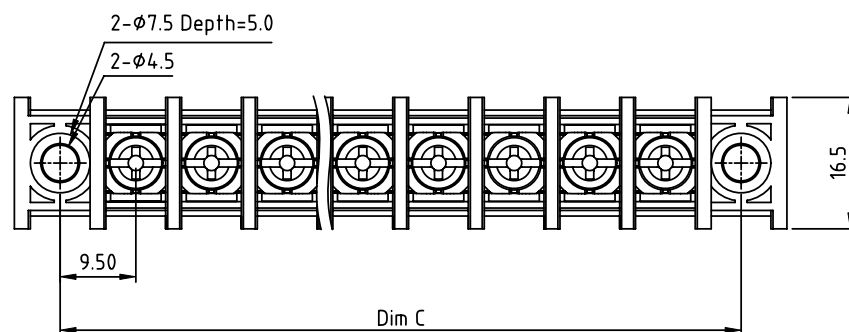

RECOMMENDED P.C.B LAYOUT TOP VIEW

MATERIALS & ELECTRICAL
RATED VOLTAGE & CURRENT: 300 V, 25 A
WITHSTAND VOLTAGE: AC 2000 V/Min
INSULATION RESISTANCE: 1000 MΩ OR MORE AT DC 500 V
OPERATING TEMPERATURE RANG: -40 °C ~ +115 °C
SCREW TORQUE VALUE: 8.8 Lb-In.
WIRE RANGE: 14 ~ 22AWG
1) MOLDED PARTS: Thermoplastic, UL 94 V-0 BLACK
2) TERMINAL: BRASS, 0.8t
3) TERMINAL SCREWS: STEEL, M3.5
APPROVAL: c us

DIMENSION

Dim A	(N+2)×9.5+2.0
Dim B	(N-1)×9.5
Dim C	(N+1)×9.5

N=Number of poles

Poles	Tolerance
2p-3p	±0.30
4p-12p	±0.40
13p-30p	±0.60

PART NO.: YK 516xx 3 x 0 J0G

No. of poles
02 2 poles
03 3 poles
...
30 30 poles

Plated

Code	Terminal	Screw
0	G/F	G/F
1	G/F	Zinc
2	Tin	G/F
3	Tin	Zinc

RoHS compliant
(lead<4%)
In copper Alloy

mat'l. code				surface ASME Y14.5 ✓	tolerance ASME Y14.5	projection 	product family TERMINAL BLOCK	
ltr	ecn	no	dr	date	tolerances unless otherwise specified	MM	title TERMINAL BLOCK	
					angles X°±1°	scale	BARRIER TYPE, WITH FLANGE	
					dr	EVAN LU	061314	sheet 1 of 1
					enr	EVAN LU	061314	size A4
					chr	HANKE FENG	061314	type CUSTOMER Drawing
					appd	SHI JUN	061314	
sheet index	revision sheet	A		1				