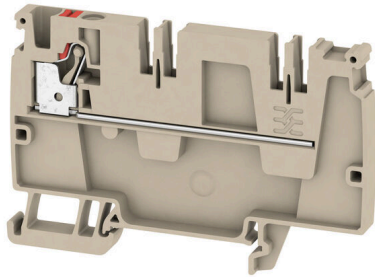

AAP21 4 LI RD**Weidmüller Interface GmbH & Co. KG**

Klingenbergstraße 26

D-32758 Detmold

Germany

www.weidmueller.com**Product image**

The unique modular concept can be tailored to every type of machine. The potential distribution terminal blocks AAP are successful thanks to their uniform design with two possible constructions – alternating or grouped. In the grouped structure of the control voltage distribution, the potentials are located on different terminal blocks and thus form entire potential blocks.

General ordering data

| | |
|------------|--|
| Version | Modular distribution terminals, PUSH IN, 4 mm ² , 250 V, 32 A, dark beige |
| Order No. | 2428930000 |
| Type | AAP21 4 LI RD |
| GTIN (EAN) | 4050118438277 |
| Qty. | 50 items |

AAP21 4 LI RD

Weidmüller Interface GmbH & Co. KG
 Klingenbergstraße 26
 D-32758 Detmold
 Germany

www.weidmueller.com

Technical data

Approvals

Approvals



| | |
|-------------------------|----------------------------|
| ROHS | Conform |
| UL File Number Search | UL Website |
| Certificate No. (cURus) | E60693 |

Dimensions and weights

| | | | |
|--------------------------|-------------|----------------|-------------|
| Depth | 53.5 mm | Depth (inches) | 2.1063 inch |
| Depth including DIN rail | 54 mm | Height | 82 mm |
| Height (inches) | 3.2283 inch | Width | 6.1 mm |
| Width (inches) | 0.2402 inch | Net weight | 12.09 g |

Temperatures

| | | | |
|----------------------------------|----------------|----------------------------------|----------------|
| Storage temperature | -25 °C...55 °C | Ambient temperature | -60 °C...85 °C |
| Continuous operating temp., min. | -60 °C | Continuous operating temp., max. | 130 °C |

Environmental Product Compliance

| | | | |
|--------------------------|-----------------------------|------------------|--|
| RoHS Compliance Status | Compliant without exemption | | |
| REACH SVHC | No SVHC above 0.1 wt% | | |
| Product Carbon Footprint | Cradle to gate | 0.132 kg CO2 eq. | |

Material data

| | | | |
|--------------------------------|-------|---------------------------|------------|
| Basic material | Wemid | Colour | dark beige |
| Colour of operational elements | red | UL 94 flammability rating | V-0 |

Rating data IECEx/ATEX

| | | | |
|--------------------------------|-------------------|---------------------------------|-------------------|
| Certificate No. (ATEX) | TUEV17ATEX8063U | Certificate No. (IECEX) | IECEXTUR17.0029U |
| Max. voltage (ATEX) | 250 V | Current (ATEX) | 32 A |
| Wire cross section max. (ATEX) | 4 mm ² | Max. voltage (IECEX) | 250 V |
| Current (IECEX) | 32 A | Wire cross section max. (IECEX) | 4 mm ² |
| Marking EN 60079-7 | Ex ec II C Gc | Ex 2014/34/EU label | II 2 G D |

System specifications

| | | | |
|-------------------------------|-----|-------------------------------------|-------|
| End cover plate required | Yes | Number of potentials | 1 |
| Number of levels | 1 | Number of clamping points per level | 1 |
| Number of potentials per tier | 1 | Levels cross-connected internally | No |
| PE connection | No | Mounting rail | TS 35 |
| N-function | No | PE function | No |
| PEN function | No | | |

AAP21 4 LI RD

Weidmüller Interface GmbH & Co. KG

Klingenbergstraße 26

D-32758 Detmold

Germany

www.weidmueller.com

Technical data

Additional technical data

| | | | |
|---------------------|-------|--------------------------|---------|
| With snap-in pegs | No | Open sides | right |
| Snap-on | No | Type of fixing | Snap-on |
| Installation advice | Rail | Explosion-tested version | Yes |
| Type of mounting | TS 35 | | |

CSA rating data

| | | | |
|-------------------------------|--------|-----------------------|-----------------|
| Wire cross section max. (CSA) | 10 AWG | Voltage size C (CSA) | 300 V |
| Current size C (CSA) | 20 A | Certificate No. (CSA) | 200039-70089609 |
| Voltage size B (CSA) | 300 V | Current size B (CSA) | 20 A |
| Voltage size D (CSA) | 600 V | Current size D (CSA) | 5 A |
| Wire cross section min. (CSA) | 26 AWG | | |

Conductors for clamping (additional connection)

Connection type, additional connection PUSH IN

Conductors for clamping (rated connection)

| | |
|---|----------------------|
| Gauge to IEC 60947-1 | A4 |
| Wire connection cross section AWG, max. | AWG 12 |
| Connection direction | top |
| Stripping length | 12 mm |
| Type of connection | PUSH IN |
| Number of connections | 1 |
| Clamping range, max. | 4 mm ² |
| Clamping range, min. | 0.14 mm ² |
| Blade size | 0.6 x 3.5 mm |
| Wire connection cross section AWG, min. | AWG 26 |
| Wire connection cross-section, finely stranded with wire-end ferrules DIN 46228/4, max. | 4 mm ² |
| Wire connection cross-section, finely stranded with wire-end ferrules DIN 46228/4, min. | 0.14 mm ² |
| Wire connection cross-section, finely stranded with wire-end ferrules DIN 46228/1, max. | 4 mm ² |
| Wire connection cross-section, finely stranded with wire-end ferrules DIN 46228/1, min. | 0.14 mm ² |
| Wire connection cross section, finely stranded, max. | 4 mm ² |
| Wire connection cross section, finely stranded, min. | 0.14 mm ² |
| Connection cross-section, stranded, max. | 4 mm ² |
| Connection cross-section, stranded, min. | 0.14 mm ² |
| Twin wire-end ferrules, max. | 1.5 mm ² |
| Twin wire-end ferrules, min. | 0.5 mm ² |
| Wire connection cross-section, solid core, max. | 4 mm ² |
| Wire connection cross-section, solid core, min. | 0.14 mm ² |
| Connection cross-section, finely stranded, min. | 0.14 mm ² |

Creation date 07.06.2026 08:26:00 MEZ

Catalogue status / Drawings

AAP21 4 LI RD

Weidmüller Interface GmbH & Co. KG

Klingenbergstraße 26
D-32758 Detmold
Germany

www.weidmueller.com

Technical data

| | | | |
|---|--|---------|---------------------|
| Tube length for wire-end ferrule with plastic collar DIN 46228/4 | Tube length | min. | 6 mm |
| | | max. | 12 mm |
| | Cross-section for conductor connection | min. | 0.5 mm ² |
| | | max. | 1 mm ² |
| | Tube length | min. | 8 mm |
| | | max. | 12 mm |
| Tube length for twin wire-end ferrule | Tube length | min. | 8 mm |
| | | max. | 12 mm |
| | Cross-section for conductor connection | min. | 0.5 mm ² |
| | | max. | 1.5 mm ² |
| | Tube length | min. | 10 mm |
| | | max. | 12 mm |
| Tube length for wire-end ferrule without plastic collar DIN 46228/1 | Tube length | min. | 6 mm |
| | | max. | 10 mm |
| | Cross-section for conductor connection | min. | 0.5 mm ² |
| | | max. | 1 mm ² |
| | Tube length | min. | 7 mm |
| | | max. | 12 mm |
| | Cross-section for conductor connection | min. | 1.5 mm ² |
| | | max. | 2.5 mm ² |
| | Tube length | min. | 9 mm |
| | | max. | 15 mm |
| | Cross-section for conductor connection | nominal | 4 mm ² |

General

| | | | |
|---|--------|---------------------|----------------------------------|
| Wire connection cross section AWG, max. | AWG 12 | Installation advice | Rail |
| Wire connection cross section AWG, min. | AWG 26 | Standards | In accordance with IEC 60947-7-1 |
| Mounting rail | TS 35 | | |

Rating data

| | | | |
|--|-------------------|---------------------------------|----------------------------------|
| Rated cross-section | 4 mm ² | Rated voltage | 250 V |
| Rated DC voltage | 250 V | Nominal current | 32 A |
| Current at maximum wires | 32 A | Standards | In accordance with IEC 60947-7-1 |
| Volume resistance according to IEC 60947-7-x | 1 mΩ | Rated impulse withstand voltage | 4 kV |
| Power loss in accordance with IEC 60947-7-x | 1.02 W | Surge voltage category | III |
| Pollution severity | 3 | | |

UL rating data

| | | | |
|--|--------|--|--------|
| Conductor size Factory wiring max. (cURus) | 10 AWG | Voltage size B (cURus) | 300 V |
| Voltage size D (cURus) | 600 V | Certificate No. (cURus) | E60693 |
| Conductor size Field wiring min. (cURus) | 26 AWG | Conductor size Factory wiring min. (cURus) | 26 AWG |
| Current size B (cURus) | 20 A | Voltage size C (cURus) | 300 V |
| Current size C (cURus) | 20 A | Current size D (cURus) | 5 A |
| Conductor size Field wiring max. (cURus) | 10 AWG | | |

Technical data

Classifications

| | | | |
|-------------|-------------|-------------|-------------|
| ETIM 8.0 | EC000897 | ETIM 9.0 | EC000897 |
| ETIM 10.0 | EC000897 | ECLASS 14.0 | 27-25-01-01 |
| ECLASS 15.0 | 27-25-01-01 | | |

Drawings

