

Dimensions		
Positions	A	B
06	4.0	11.20
08	6.0	13.20
10	8.0	15.20
12	10.0	17.20
14	12.0	19.20
16	14.0	21.20

Positions	A	B
30	28.0	35.20
32	30.0	37.20
34	32.0	39.20
38	36.0	43.20
40	38.0	45.20
44	42.0	49.20

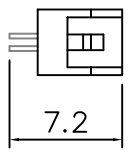
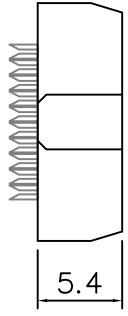

Positions	A	B
18	16.0	23.20
20	18.0	25.20
22	20.0	27.20
24	22.0	29.20
26	24.0	31.20
28	26.0	33.20

Positions	A	B
50	48.0	55.20
60	58.0	65.20
62	60.0	67.20
64	62.0	69.20
68	66.0	73.20

Product Specification

Material

Insulator :Glass-Filled Thermoplastic PBT, UL94V-0 rates

Contact :Brass or Phosphor Bronze

Plated full gold or selected gold in mating area, 100u" min. tin plated on termination area, with entire contact under-plated 50u" min. Nickel

Electrical

Contact Resistance :20 milliohms

Max at 1 AMP DC.

Insulation Resistance :5000 mohms at 500 VDC

Dielectric Withstanding Voltage : 250 VAC/rms 60Hz for 1 minute

Current Rating :3 AMP

Voltage Rating :250 VAC/rms 60Hz

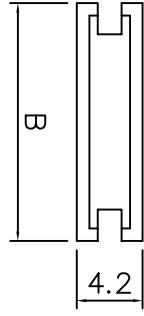
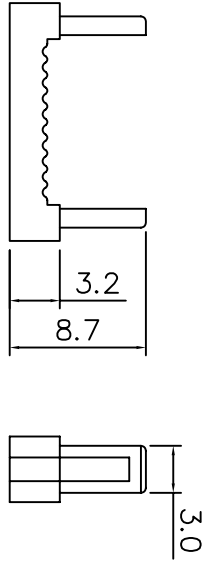

T826 X XX XX XX C EU

IDC Socket:
2.00mm Pitch

- Housing Color
- 0: Grey w CPK
 - 1: Black w CPK
 - 2: Grey w/o CPK
 - 3: Black w/o CPK
- CPK=Central Polarization Key

No of Positions:
06: 6 positions
:
:
68: 68 positions

Plating Options:
A1: Flash Gold
A2: 15u"0,4um Gold
A3: 30u"0,8um Gold
SN:Tin

Variation Code:
00: W/O Strain Relief
01: With Strain Relief

EU: RoHS
Compliant

C: Fixed Index



TOLERANCE (mm)	APPROVALS	DATE	TITLE		
X. ±0.3	DRAWN Roger	24/Nov/2006	IDC Socket		
X.X ±0.2	CHECKED Rob K.	27/Nov/2006			
X.XX ±0.15	APPROVED Rob K.	28/Nov/2006			
UNLESS OTHERWISE SPECIFIED			UNIT : mm	SIZE : A4	DRAWING N° T826 Series
			AMPHENOL Amphenol European Design Center		
			Scale N.A.	Sheet 1 of 1	REV. A