

PRODUCT NUMBER  
SEE TABLE

68682 - XXX - LF

LEAD FREE OPTION  
PACKAGING OPTION. OMIT IF NOT REQUIRED  
NO OF POSITIONS PER ROW  
PLATING CODE  
BASE PART NUMBER

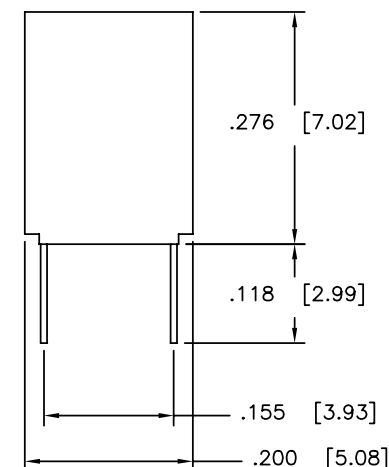
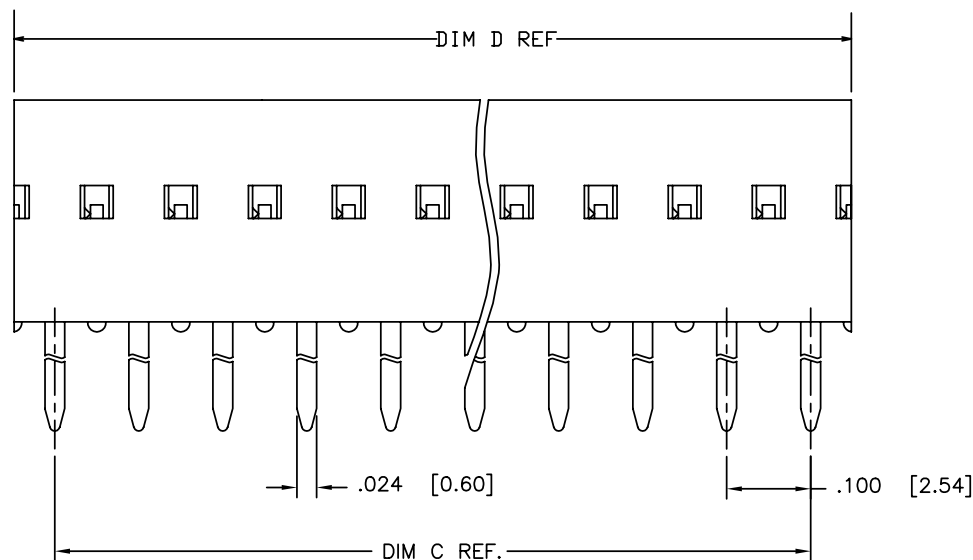
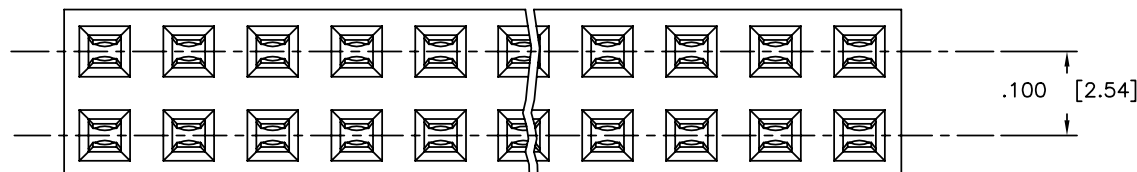

mat'l. code				surface		tolerance		projection		product family	
-				ISO 1302		ISO 406		ISO 1101		DUBOX	
ltr	ecn no	dr	date	tolerances unless otherwise specified		linear		INCH/MM		title	
T	N-005184	SH	2011-08-18	angles		.001/.01		.001/.01		DUBOX DBL. ROW DBL. ENTRY	
U	ELX-N-13980	DCS	2013-01-28	linear		.001/.005		.001/.005		VERT. CARD CONN. ASS'Y.	
V	ELX-N-14177	DCS	2013-03-04	0°±2°		.0001±.0020		.0001±.005		scale 4:1	
				dr	S. RAMP	02/25/91		FCI		dwg no	sheet 1 of 3 size
P	M06-0433	MN	06/17/06	enr	M. HAHN	02/25/91				68682	A3
R	M09-0121	MHT	7/24/09	chr	M. HAHN	02/25/91					
S	M09-0124	MHT	9/07/09	appd	M. HAHN	02/25/91					
sheet	revision	V	V	V	V	V	V	V	V	type Product Customer Drawing	
index	sheet	1	2	3	3	3	3	3	3		

PDS: Rev :V

STATUS: Released

Printed: Mar 13, 2013

PRODUCT NO NOTE 8	PLATING CONTACT AREA MIN NOTE 11	PLATING SOLDER TAIL
68682-2XX	15u"/.38u Au DR GXT, OVER 50u"/1.27 Ni	100u"/160u" SN 2.54u"/4.06u"
68682-3XX	30u"/.76u Au DR GXT, OVER 50u"/1.27 Ni	100u"/160u" SN 2.54u"/4.06u"
68682-4XX	100u"/160u" SN 2.54u"/4.06u"	100u"/160u" SN 2.54u"/4.06u"
68682-5XX	50u"/1.27u Au OVER 50u"/1.27 Ni	100u"/160u" SN 2.54u"/4.06u"
68682-6XX	30u"/.76u Au DR GXT, OVER 50u"/1.27 Ni	100u"/160u" SN 2.54u"/4.06u"
68682-8XX	30u"/.76u Au OVER 50u"/1.27 Ni	100u"/160u" SnPb 2.54u"/4.06u"

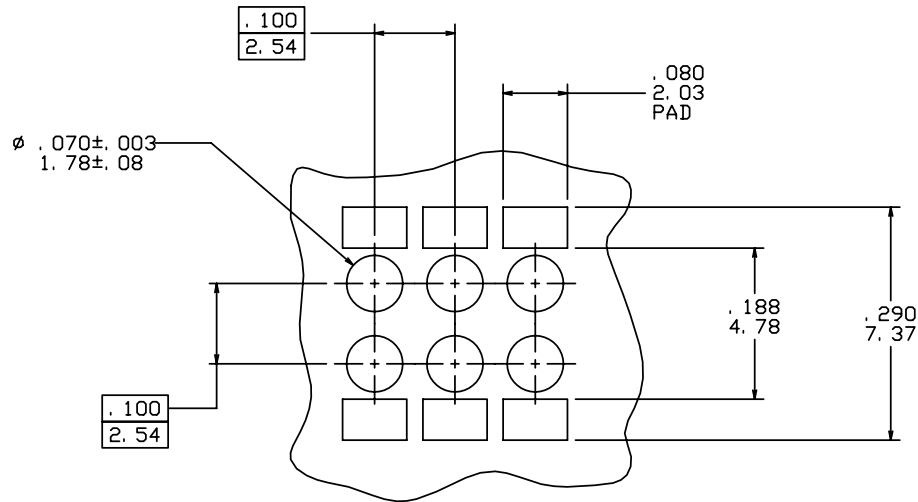

FIGURE A

#### NOTES:

- 1 MATERIAL TERMINAL: PHOSPHOR BRONZE.
- 2 RECOMMENDED APPLICATION DATA:
  - A. RECOMMENDED HOLE PATTERN IS SHOWN IN FIGURE A.
  - B. ALL MATING PINS TO BE .025/.64 SQUARE ON TRUE CENTER OF GIVEN TERMINAL SPACINGS WITHIN .015/.38 DIA
  - C. SUGGESTED MATING PIN LENGTH .210±.020/5.33±.51
  - D. TERMINALS CAN ONLY BE USED FOR PC BOARD WITH NON PLATED THROUGH HOLES.
  - E. RECOMMENDED PC BOARD THICKNESS: .062/1.58
- ③ MATERIAL HOUSING: PPS FILLED, COLOR BLACK, FLAME RETARDANT PER UL-94V-0.  
PART WILL WITHSTAND EXPOSURE TO 260° C PEAK TEMPERATURE FOR 20 SEONDS IN WAVE SOLDER, INFRA-RED OR VAPOR PHASE SOLDER PROCESS.
- ④ FCI, FCI FINAL PART NUMBER AND DATE CODE TO BE MARKED ON TUBE LABEL.
- ⑤ PREPLATED, STAMPED TERMINALS.
- ⑥ PART NUMBER WITH SUFFIX "U" IS FOR SAWING PURPOSES ONLY.
7. STANDARD TUBE PACKAGE PER BUS-14-097/3.
- ⑧ ADD LF SUFFIX AT THE END OF PART NUMBER FOR LEAD FREE OPTION.
9. THIS PRODUCT MEETS EUROPEAN UNION DIRECTIVES AND OTHER COUNTRY REGULATION AS DESCRIBED IN GS-22-008.
- ⑩ "THIS PRODUCT HAS 100% TIN PLATING IN THE INTERFACE AND HAS NOT BEEN TESTED FOR WHISKER GROWTH IN ALL INTERCONNECT ENVIRONMENTS".

mat'l. code				surface	tolerance	projection	product family
-				ISO 1302 ✓	ISO 406 ISO 1101	ISO 1101	DUBOX
ltr	ecn	no	dr	date	tolerances unless otherwise specified	INCH/MM	title
v					angles	linear	DUBOX DBL. ROW DBL. ENTRY
					0°±2'	linear	VERT. CARD CONN. ASS'Y.
					dr	S. RAMP	02/25/91
					enr	M. HAHN	02/25/91
					chr	M. HAHN	02/25/91
					appd	M. HAHN	02/25/91
sheet	revision						
index	sheet						

1					2 3					4					5					6				
PRODUCT NO					NO. OF POSITION					DIM C					DIM D					LF OPTION				
68682-Y02					2 X 2					. 100/2. 54					. 217/5. 51					NOTE 8				
-Y03					2 X 3					. 200/5. 08					. 317/8. 05									
-Y04					2 X 4					. 300/7. 62					. 417/10. 59									
-Y05					2 X 5					. 400/10. 16					. 517/13. 13									
-Y06					2 X 6					. 500/12. 70					. 617/15. 67									
-Y07					2 X 7					. 600/15. 24					. 717/18. 21									
-Y08					2 X 8					. 700/17. 78					. 817/20. 75									
-Y09					2 X 9					. 800/20. 32					. 917/23. 29									
-Y10					2 X 10					. 900/22. 86					1. 017/25. 83									
-Y11					2 X 11					1. 000/25. 40					1. 117/28. 37									
-Y12					2 X 12					1. 100/27. 94					1. 217/30. 91									
-Y13					2 X 13					1. 200/30. 48					1. 317/33. 45									
-Y14					2 X 14					1. 300/33. 02					1. 417/35. 99									
-Y15					2 X 15					1. 400/35. 56					1. 517/38. 53									
-Y16					2 X 16					1. 500/38. 10					1. 617/41. 07									
-Y17					2 X 17					1. 600/40. 64					1. 717/43. 61									
-Y18					2 X 18					1. 700/43. 18					1. 817/46. 15									
-Y19					2 X 19					1. 800/45. 72					1. 917/48. 69									
-Y20					2 X 20					1. 900/48. 26					2. 017/51. 23									
-Y21					2 X 21					2. 000/50. 80					2. 117/53. 77									
-Y22					2 X 22					2. 100/53. 34					2. 217/56. 31									
-Y23					2 X 23					2. 200/55. 88					2. 317/58. 85									
-Y24					2 X 24					2. 300/58. 42					2. 417/61. 39									
-Y25					2 X 25					2. 400/60. 96					2. 517/63. 93									
-Y26					2 X 26					2. 500/63. 50					2. 617/66. 47									
-Y27					2 X 27					2. 600/66. 04					2. 717/69. 01									
-Y28					2 X 28					2. 700/68. 58					2. 817/71. 55									
-Y29					2 X 29					2. 800/71. 12					2. 917/74. 09									
-Y30					2 X 30					2. 900/73. 66					3. 017/76. 63									
-Y31					2 X 31					3. 000/76. 20					3. 117/79. 17									
-Y32					2 X 32					3. 100/78. 74					3. 217/81. 71									
-Y33					2 X 33					3. 200/81. 28					3. 317/84. 25									
-Y34					2 X 34					3. 300/83. 82					3. 417/86. 79									
68682-Y35					2 X 35					3. 400/86. 36					3. 517/89. 33									
PRODUCT NO					NO. OF POSITION					DIM C					DIM D									
68682-Y36					2 X 36					3. 500/88. 90					3. 617/91. 87					NOTE 8				
-Y37					2 X 37					3. 600/91. 44					3. 717/94. 41									
-Y38					2 X 38					3. 700/93. 98					3. 817/96. 95									
-Y39					2 X 39					3. 800/96. 52					3. 917/99. 49									
-Y40					2 X 40					3. 900/99. 06					4. 017/102. 03									
-Y41					2 X 41					4. 000/101. 60					4. 117/104. 57									
-Y42					2 X 42					4. 100/104. 14					4. 217/107. 11									
-Y43					2 X 43					4. 200/106. 68					4. 317/109. 65									
-Y44					2 X 44					4. 300/109. 22					4. 417/112. 19									
-Y45					2 X 45					4. 400/111. 76					4. 517/114. 73									
-Y46					2 X 46					4. 500/114. 30					4. 617/117. 27									
-Y47					2 X 47					4. 600/116. 84					4. 717/119. 81									
-Y48					2 X 48					4. 700/119. 38					4. 817/122. 35									
-Y49					2 X 49					4. 800/121. 92					4. 917/124. 89									
68682-Y50					2 X 50					4. 900/124. 46					5. 017/127. 43									
68682-Y50U					2 X 50					4. 900/124. 46					5. 017/127. 43									
SEE NOTE 6																								

FCI

FCIconnect.com

Copyright FCI

mat'l. code				surface				tolerance				projection				product family			
-				ISO 1302				ISO 406				ISO 1101				DUBOX			
ltr		ecn		no		dr		date		tolerances unless otherwise specified				INCH/MM		title			
v										angles		linear		scale 4:1		DUBOX DBL. ROW DBL. ENTRY			
										0°±2°						VERT. CARD CONN. ASS'Y.			
										dr		S. RAMP		02/25/91		dwg no			
										enr		M. HAHN		02/25/91		sheet 3 of 3			
										chr		M. HAHN		02/25/91		size			
										appd		M. HAHN		02/25/91		A3			
																type			
																Product Customer Drawing			
sheet		revision																	
index		sheet																	

Downloaded from

Arrow.com

PDS: Rev :V

STATUS: Released

Printed: Mar 13, 2013