

HC-D 7-AML-26/GW/PA BK - Housing



1410686

<https://www.phoenixcontact.com/us/products/1410686>

Please be informed that the data shown in this PDF document is generated from our online catalog. Please find the complete data in the user documentation. Our general terms of use for downloads are valid.



HEAVYCON D7 panel mounting base, with single locking latch, height: 25.5 mm, angled, PA, color: black

Commercial data

Item number	1410686
Packing unit	1 pc
Note	Made to order (non-returnable)
Sales key	BF55
Product key	AF7AAE
Catalog page	Page 492 (C-4-2015)
GTIN	4046356859424
Weight per piece (including packing)	22.99 g
Weight per piece (excluding packing)	22.22 g
Customs tariff number	85389099
Country of origin	DE

HC-D 7-AML-26/GW/PA BK - Housing



1410686

<https://www.phoenixcontact.com/us/products/1410686>

Technical data

Notes

General	for contact inserts HC-A03, A04, D07, D08, Q02, Q03, Q04, Q05, Q07, Q12
---------	---

Product properties

Product type	Housing with locking latch
Housing type	Panel mounting base
Type	D7
Pg screw connection	none

Dimensions

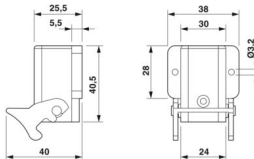
Dimensional drawing	
Width	40.5 mm
Height	25.5 mm
Length	38 mm

Installation dimensions

Width of the assembly cutout	21 mm
Length of the assembly cutout	21 mm

Material specifications

Seal material	NBR
Housing material	PA
Locking latch material	PA

Environmental and real-life conditions

Ambient conditions

Degree of protection	IP54
	IP65 (with sealing screw)
Ambient temperature (operation)	-40 °C ... 125 °C

HC-D 7-AML-26/GW/PA BK - Housing

1410686

<https://www.phoenixcontact.com/us/products/1410686>



Drawings

Dimensional drawing

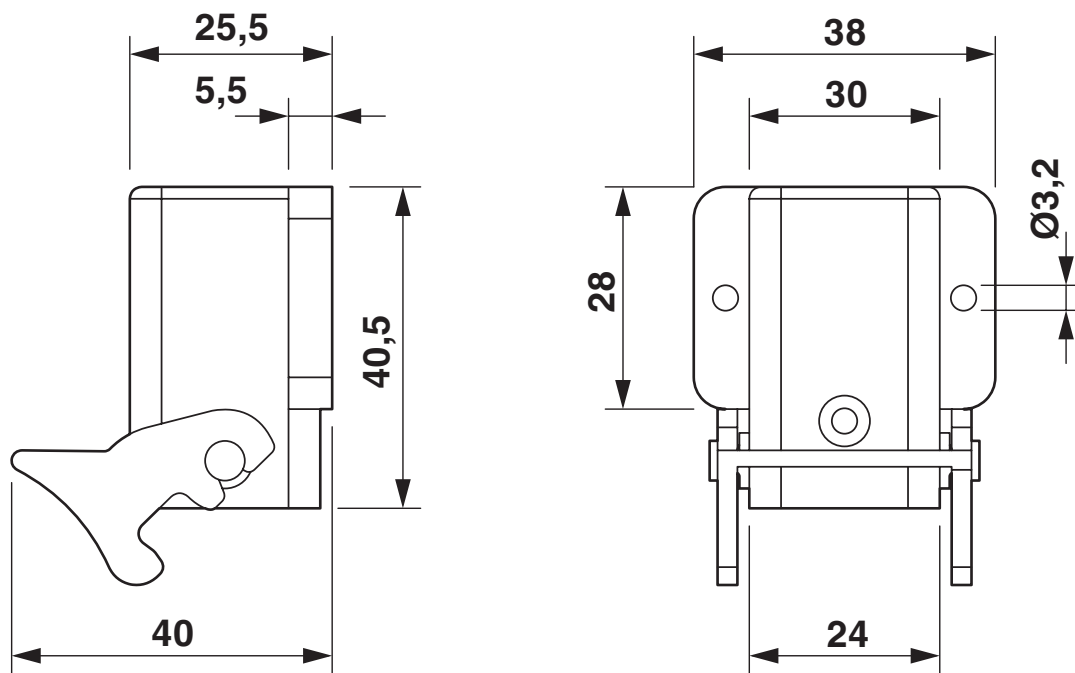

Dimensional drawing

Dimensional drawing

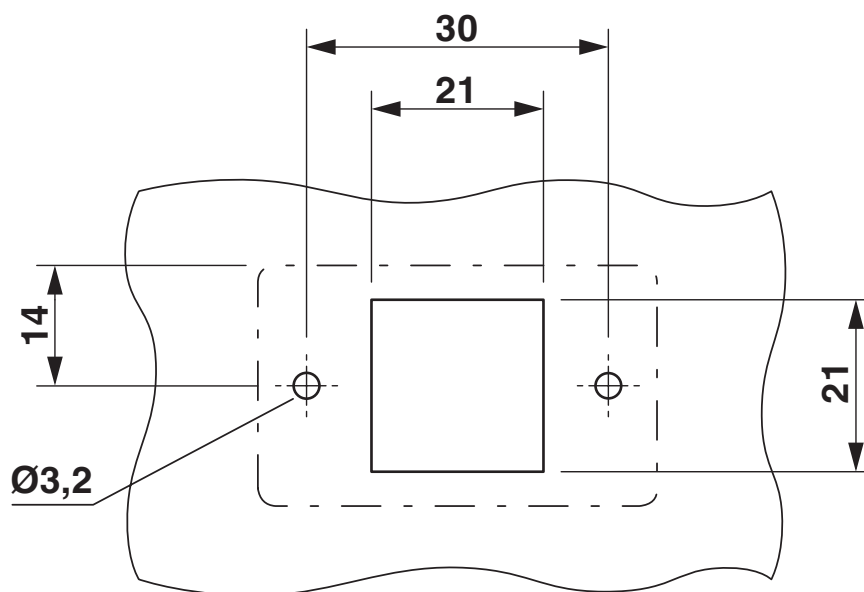

Mounting cutout

HC-D 7-AML-26/GW/PA BK - Housing

1410686

<https://www.phoenixcontact.com/us/products/1410686>



Classifications

ECLASS

ECLASS-13.0	27440202
-------------	----------

HC-D 7-AML-26/GW/PA BK - Housing



1410686

<https://www.phoenixcontact.com/us/products/1410686>

Environmental product compliance

EU RoHS	
Fulfills EU RoHS substance requirements	Yes, No exemptions
China RoHS	
Environment friendly use period (EFUP)	EFUP-E
	No hazardous substances above the limits
EU REACH SVHC	
REACH candidate substance (CAS No.)	No substance above 0.1 wt%

Phoenix Contact 2025 © - all rights reserved
<https://www.phoenixcontact.com>

Phoenix Contact USA
586 Fulling Mill Road
Middletown, PA 17057, United States
(+717) 944-1300
info@phoenixcon.com