

ST Series

all categories > through hole technology > test pin > test pin for logic circuit test, recommended through-hole diameter 0.5, 0.6, 0.8, 1.0, 1.2 phi mm

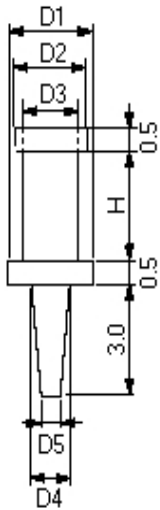

Test Pin for Logic Circuit Test, Recommended through-hole dia

- Best use for logic circuit test.
- Pins for through-hole diameter 0.5, 0.6, 0.8, 1.0, 1.2 phi mm are available.
- Finish....Au plating over Ni
- Material....Brass

- [Save To Favorites](#)
- [Download Catalog](#)

[Ask a Question](#)

[Pre-Production Quote Request](#)

[Request Sample](#)

[ADD TO CART](#)

>> request quote / information | >> download specs

N/O	D1 (phi mm)	D2 (phi mm)	D3 (phi mm)	D4 (phi mm)	D5 (phi mm)	H (mm)	Recommended Through-hole Diameter (phi mm)
ST-1-1	2.0	1.8	1.2	0.8	0.65	3.0	0.8
ST-1-2	2.0	1.8	1.2	0.8	0.65	6.0	0.8
ST-1-3	2.0	1.8	1.2	0.8	0.65	10.0	0.8
ST-2-1	2.5	2.2	1.4	1.0	0.8	3.5	1.0
ST-2-2	2.5	2.2	1.4	1.0	0.8	6.5	1.0
ST-2-3	2.5	2.2	1.4	1.0	0.8	10.5	1.0
ST-3-1	2.5	2.2	1.4	1.2	1.0	3.5	1.2
ST-3-2	2.5	2.2	1.4	1.2	1.0	6.5	1.2
ST-3-3	2.5	2.2	1.4	1.2	1.0	10.5	1.2
ST-4-1	1.5	1.5	1.0	0.8	0.65	3.0	0.8
ST-4-2	1.5	1.5	1.0	0.8	0.65	5.0	0.8
ST-5-1	1.2	1.2	0.8	0.6	0.5	3.0	0.6
ST-5-2	1.2	1.2	0.8	0.6	0.5	5.0	0.6
ST-6-1	1.0	1.0	0.7	0.5	0.4	3.0	0.5
ST-6-2	1.0	1.0	0.7	0.5	0.4	5.0	0.5