

GEN. ST.	01	02	03	04	05	06	07	08	0D	50	60	70	80	90	REV.	DATE	DESCRIPTION	BY	C'K'D'																	
INT. ST.	10	11	12	13	14	18	20	31	32	33	34	38	39	40	42	43	44	45	46	48	56	70	72	73	75	76	81	82	83	84	88					

LOADING PATTERN MATING SIDE

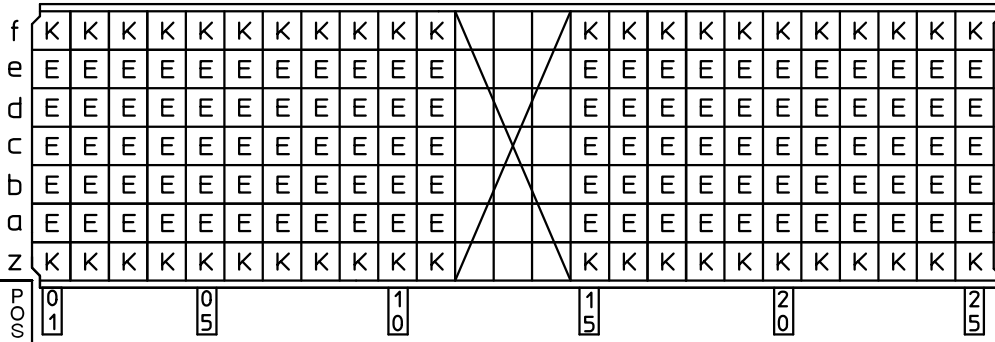

LOADED CONNECTOR ASSEMBLY (FOR EXAMPLE)

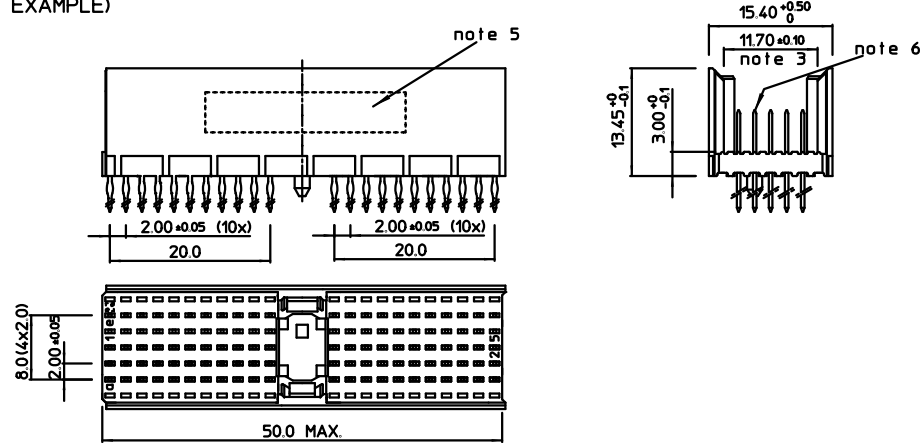

SHEET NR. : 259

CONTACT OVERVIEW SEATING PLANE FOR CONNECTOR

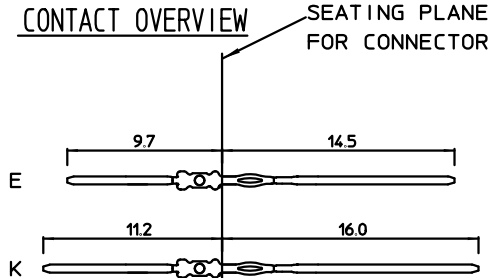

LAY-OUT P.C.B.-HOLE

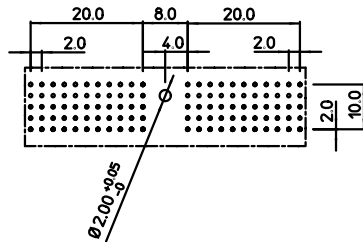

PLATING TABLE

HM2P--P----- PLATING CODE (DIGIT 13 AND 14)

CODE	CONTACT AREA		
E9	1.00 μ Au min over 1.3 μ Ni min.	SHORT / WIRE WRAP CONTACTS	PERFORMANCE LEVEL 1 (500 mating cycles)
N9	0.80 μ Au min over 1.3 μ Ni min.	SHORT / WIRE WRAP CONTACTS	PERFORMANCE LEVEL 2 (250 mating cycles)
Z1	0.40 μ Au min over 1.3 μ Ni min.	SHORT / WIRE WRAP CONTACTS	PERFORMANCE LEVEL 3 (50 mating cycles)
GL	1.00 μ Au min over 1.3 μ Ni min.	REAR PLUG-UP CONTACTS	PERFORMANCE LEVEL 1 (500 mating cycles)
GF	0.80 μ Au min over 1.3 μ Ni min.	REAR PLUG-UP CONTACTS	PERFORMANCE LEVEL 2 (250 mating cycles)
GC	0.40 μ Au min over 1.3 μ Ni min.	REAR PLUG-UP CONTACTS	PERFORMANCE LEVEL 3 (50 mating cycles)

RECOMMENDED PLATED THROUGH HOLE DIMENSIONS

- * DIAM.DRILLED HOLE : 0.675/0.725
- * DIAM.FINISHED HOLE : 0.55/0.65
- * Cu THICKNESS : 25/50 μ m.
- * SnPb THICKNESS : 4/10 μ m.

NOTES

1. CSA CERTIFIED, FILE NUMBER LR 44961-51.
2. UL APPROVED, FILE NUMBER E31151.
3. MEASURED AT THE BOTTOM.
4. MATERIAL CONTACT: PHOSPHORBRONZE
HOUSING: CREAM WHITE GLASFILLED
POLYESTER UL-94V0
5. CONNECTOR PRINTED WITH P/N AND DATE CODE.
6. FOR ACTUAL CONTACT LOADINGS, SEE LOADING PATTERN MATING SIDE.

1DEC ±0.2 2DEC ±0.1 ANGLES ±1° HOEKEN	APPR. DRAFT CHECKED	DATE 10-08-98	SIGN. N.Frel	LOADING PATTERN OVERVIEW CAT. No. HM2P07PME124--
WE RESERVE THE RIGHT TO CHANGE DIMENSIONS OR REQUIREMENTS WITHOUT PRIOR NOTICE.	PROD. MGR. PR. ENG. MGR. PR. MGT. MGR.			SCALE
ALL DIMENSIONS IN MM ALLE AFMETINGEN IN MM	REFERENCES / REFERENTIES			FRAMATOME CONNECTORS BELGIUM N.V. A. SPINOYSTRAT 8, 2800 MECHELEN
				BS,C ,201843,643,00 DRAWING No. CUSTOMER DRAWING