

RCU-G-02.00-AMS-AM

RCU SERIES

IP68 SEALED USB CABLE PLUG

SPECIFICATIONS

For complete specifications see www.samtec.com?RCU

Insulator Material:

Glass Filled Thermoplastic

Contact Material:

Phosphor Bronze

Current Rating:

4.2 A per pin

(1 pin powered)

Operating Temp Range:

-20 °C to +80 °C

Shield Material:

Phosphor Bronze

Wire:

20 AWG (Power)

25 AWG (Signal)

28 AWG (Drain)

Mates with:
RPCU, RPBU

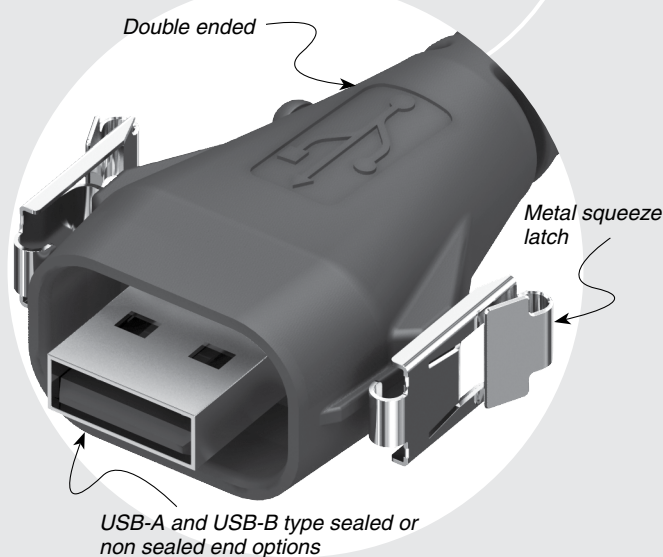

DUST CAPS

-AMS = DCA-RCU-01-01-A

-BMS = DCA-RCU-01-01-B

ALSO AVAILABLE (MOQ Required)

- Other wire lengths
- End option 2 with -AMS, -BMS or -BM

RCU

PLATING

-G
= 30 μ" (0.76 μm)
Gold on contact,
Nickel on shell

WIRE LENGTH

-01.00
= (1 m) 40" Cable
-02.00
= (2 m) 79" Cable
Standard lengths

END 1 OPTION

-AMS
= USB A Type,
Sealed
-BMS
= USB B Type,
Sealed

END 2 OPTION

-AM
= USB A Type,
Not Sealed
-BC
= Blunt Cut

