

This document is the property of Amphenol Corporation and is delivered on the express condition that it is not to be disclosed, reproduced or used, in whole or in part, for manufacture or sale by anyone other than Amphenol Corporation without its prior consent, & that no right is granted to disclose or to use any information in this document.

CUSTOMER DRAWING

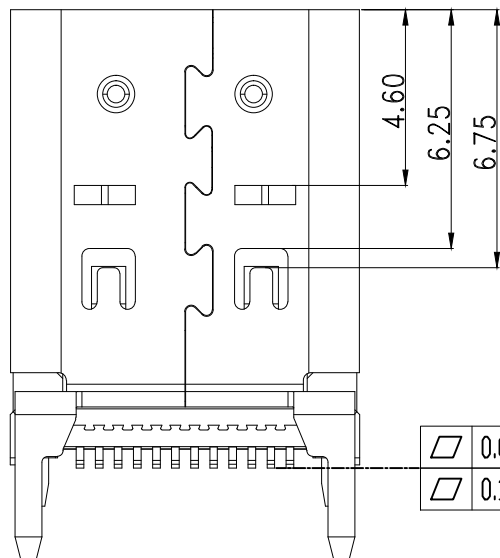

	0.08	24X SMT Tails (Before IR)
	0.10	24X SMT Tails (After IR)

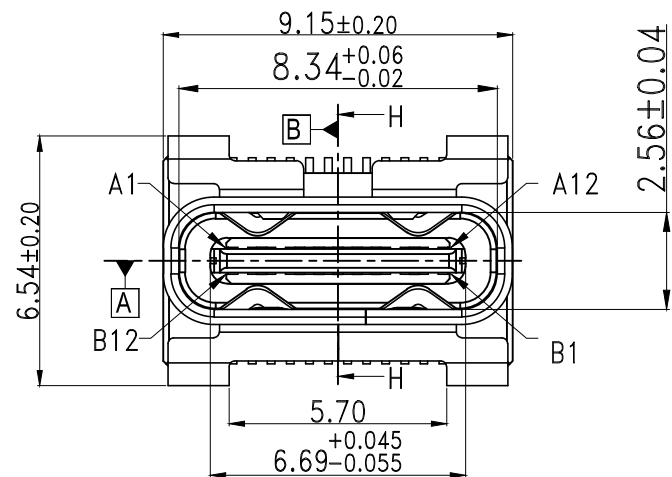
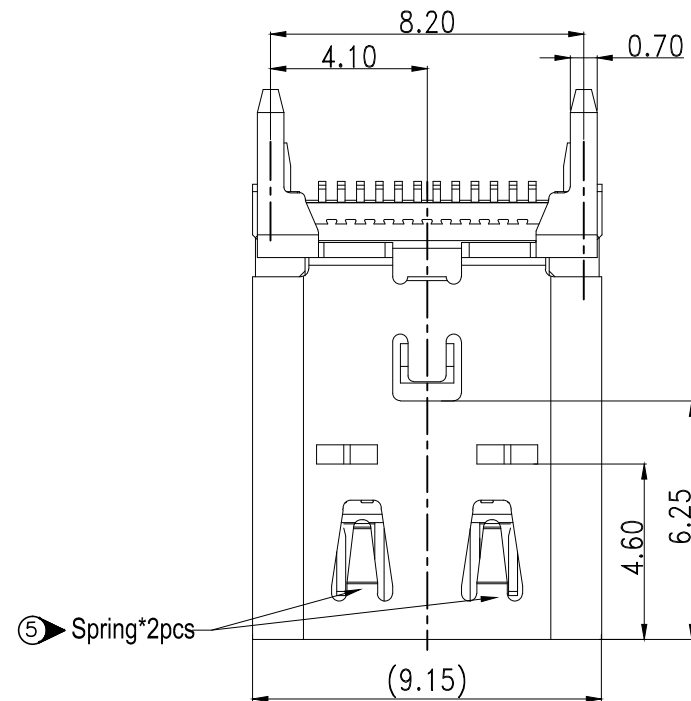
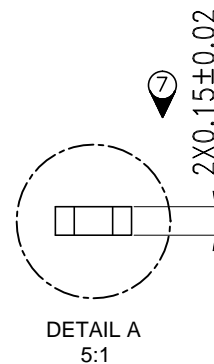
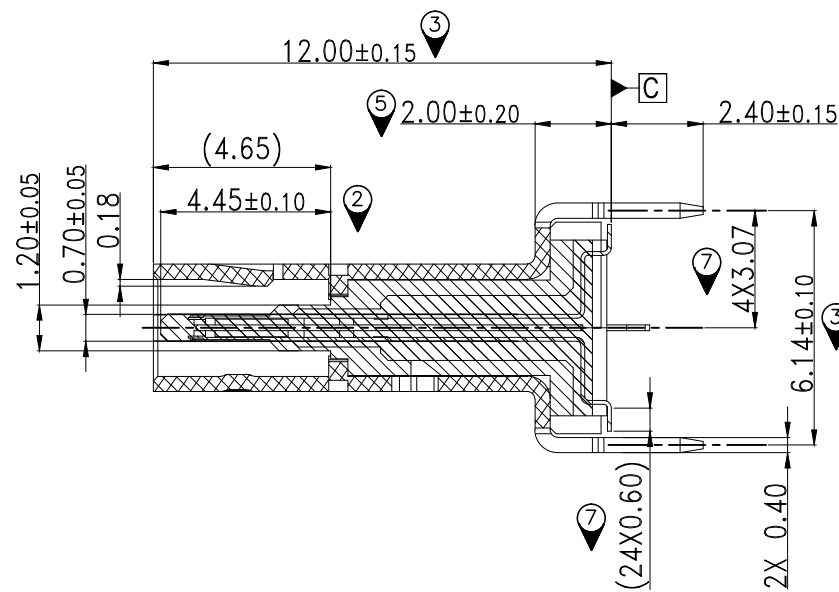
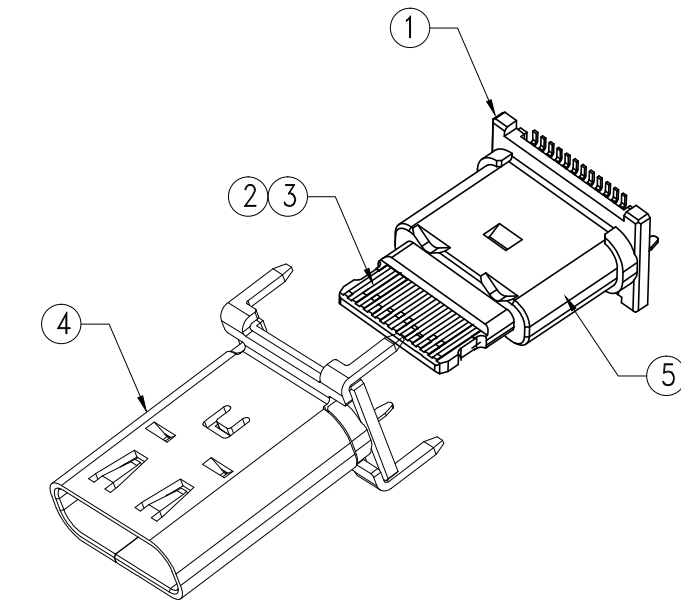

REVISIONS				
SYM	ECN	DESCRIPTION	DATE	APPROVED
1	1903****	FIRST RELEASE	2019.03.06	Michael.ip
2	1904****	Add tongue to iron case opening dimensions	2019.04.22	Michael.ip
3	1905****	Increase the size of the iron shell foot position	2019.05.07	Michael.ip
4	1905****	Update package drawing	2019.05.07	Michael.ip
5	1906****	Extended the length dimension of solder tail; Modify the dimension 2.0±0.20; add the spring structure	2019.06.28	Michael.ip
6	1907****	Change the length dimension of solder tail; Modify the solder width of mid plate.	2019.07.11	Michael.ip
7	2103****	Add Pick Area	2021.03.09	Michael.ip
8	2106****	Update package quantity	2021.06.25	Michael.ip
9	2107****	Soldering Area Plating Matte Tin Change Gold Flash	2021.07.29	Michael.ip

Pin No	Signal Name	Mating Sequence	Pin No	Signal Name	Mating Sequence
A1	GND	First	B12	GND	First
A2	TX1+	Second	B11	RX1+	Second
A3	TX1-	Second	B10	RX1-	Second
A4	VBUS	First	B9	VBUS	First
A5	CC1	Second	B8	SBU2	Second
A6	D+	Second	B7	D-	Second
A7	D-	Second	B6	D+	Second
A8	SBU1	Second	B5	CC2	Second
A9	VBUS	First	B4	VBUS	First
A10	RX2-	Second	B3	TX2-	Second
A11	RX2+	Second	B2	TX2+	Second
A12	GND	First	B1	GND	First

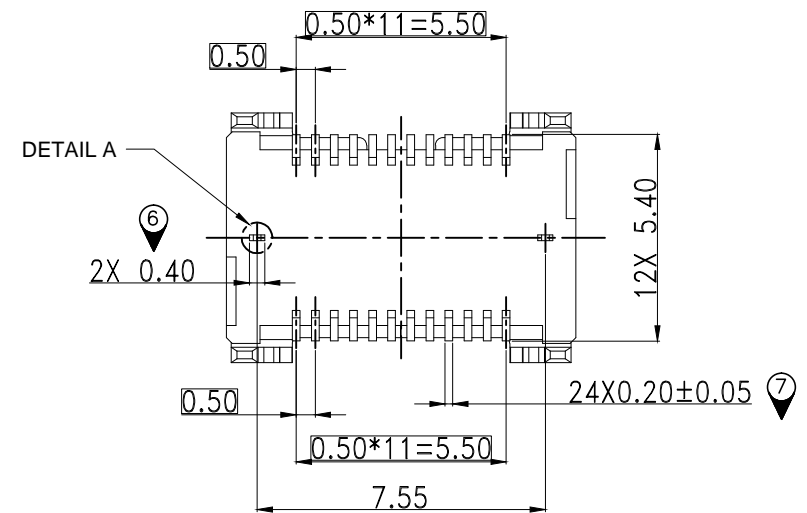

6	Cap	1	High Temperature Plastic	Black,UL 94V-0
5	Mid Plate	1	Stainless Steel	Nickel : 50u" min
4	Main Shell	1	Stainless Steel	Solder Nickel : 50u" min
3	Bottom Terminal	12	Copper Alloy	See NOTES
2	Top Terminal	12	Copper Alloy	See NOTES
1	Molding Housing	1	High Temperature Plastic	Black,UL 94V-0
Item	Description	Q'TY	Material	

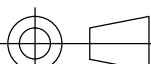
Bill Of Material					
UNLESS OTHERWISE SPECIFIED TOLERANCES U.S. METRIC .X +/- 0.50 .XX +/- 0.15 .XXX +/- 0.10 FRACTIONS +/- ANGLES +/- 3° FOR MATERIALS AND FINISHES SEE NOTES REMOVE SHARP EDGES DIMENSIONS U.S. INCHES (METRIC) (MM)		APPROVAL		DATE	
		DRAWN Allan.Lai		06/25/21	
		CHECKED Michael.Qin		06/25/21	
		CHECKED Michael.Qin			
		DRAWING FILE :			
		Amphenol			
		Amphenol East Asia Limited			
		TITLE Customer Drawing For			
		USB 3.1 ,Type C socket connector, Vertical type, L=12mm, No Water proof			
		SIZE		DRAWING NO.	
A3		C 12401951		9	
SCALE		NONE		SHEET 1 OF 2	

CUSTOMER DRAWING

REVISIONS

SYM	ECN	DESCRIPTION	DATE	APPROVED
		please see sheet 1/2		

NOTES:

- 1.Material : See Bill Of Material
- 2.Waterproof : No Waterproof
- 3.Electrical Characteristics:
 - Low Level Contact Resistance: 40mΩ Max
 - Insulation resistance :100MΩ Min
 - Dielectric Withstanding Voltage:100 VAC
 - Contact Current Rating ::5A Max
- 4.Mechanical Characteristics:
 - Insertion Force: 5~20N
 - Extraction Force: 8~20N
 - After Durability Extraction Force: 6~20N
- 5.Durability: 10000 Cycles
- 6.Packaging Type: Carrier Reel.
- 7.Material Should Be Fulfilled Amphenol SPEC# SSN002 And Customer Requirements, For HALOGEN FREE Products, Also Need To Meet SSN004
- 8.Part Number:12401951XX12A

- 9 Plating Spec: _____
- E4: Mating Area: Au 30u" Min
Solder Area: Gold Flash
50u"Min Nickel Under Plating Over All
- A:HF
Package Spec.
2:Reel
Date Code Description
1:With D/C

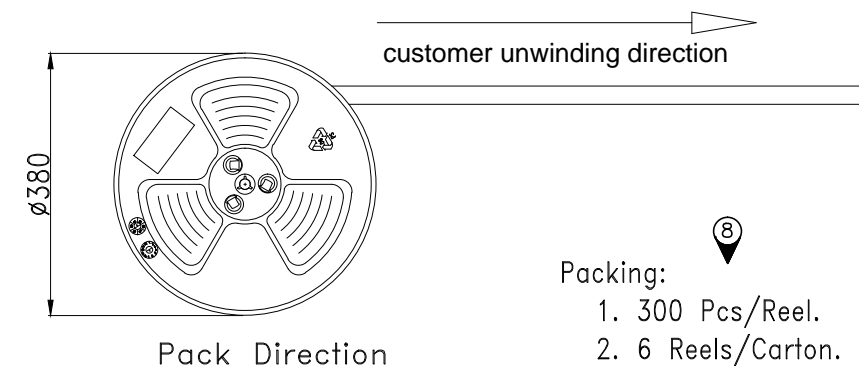
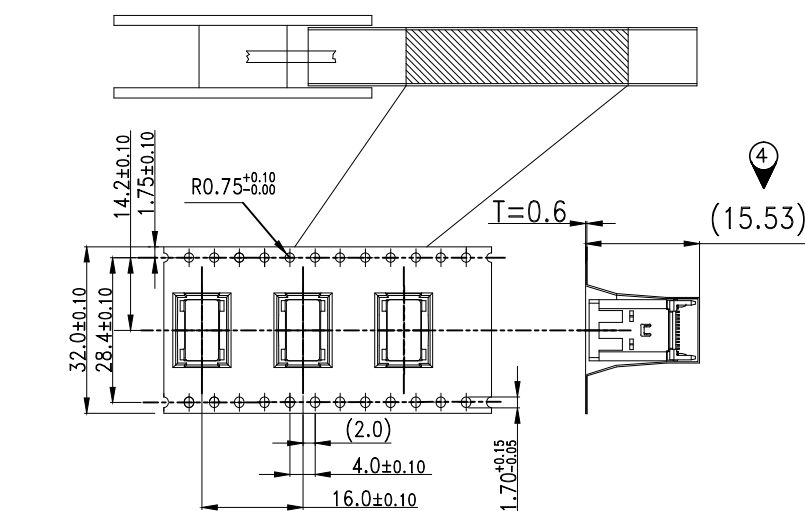
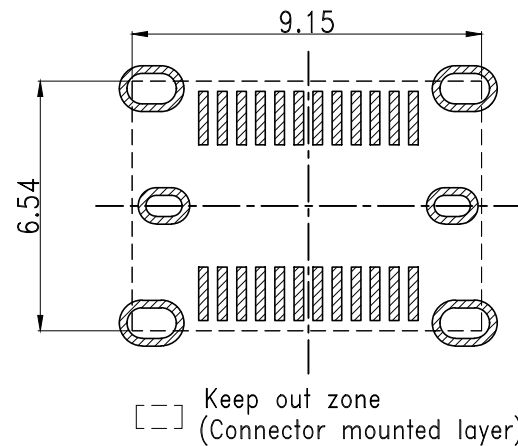
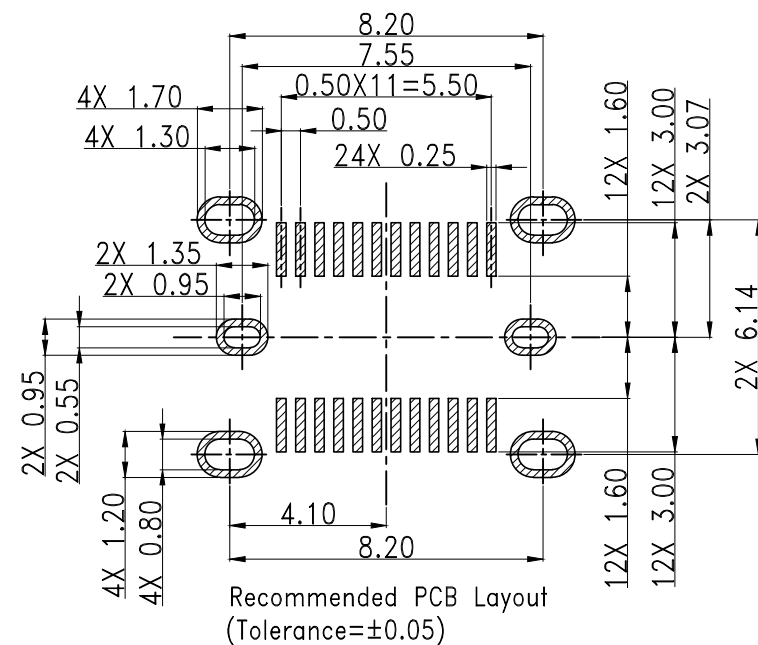

- Packing:
1. 300 Pcs/Reel.
 2. 6 Reels/Carton.

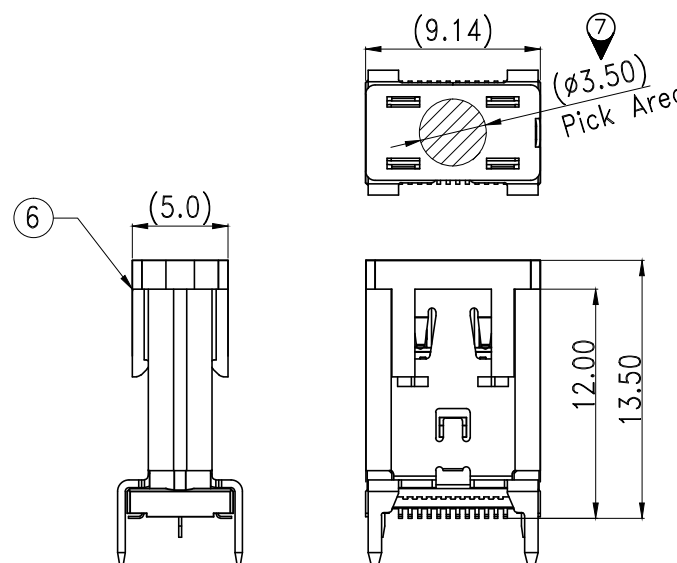

Cap Assembly Condition(REF)

Packing quantity:

UNLESS OTHERWISE SPECIFIED TOLERANCES				APPROVAL		DATE	Amphenol Amphenol East Asia Limited TITLE Customer Drawing For USB 3.1 ,Type C socket connector, Vertical type, L=12mm, No Water proof		
				DRAWN	Allan.Lai	06/25/21			
				CHECKED	Michael.Qin	06/25/21			
				CHECKED	Michael.Qin				
FOR MATERIALS AND FINISHES SEE NOTES				DRAWING FILE :			SIZE	DRAWING NO.	REV.
REMOVE SHARP EDGES				ANGLE OF PROJECTION			A3	C 12401951	9
DIMENSIONS							SCALE	NONE	SHEET 2 OF 2
U.S. INCHES									
(METRIC) (MM)									