

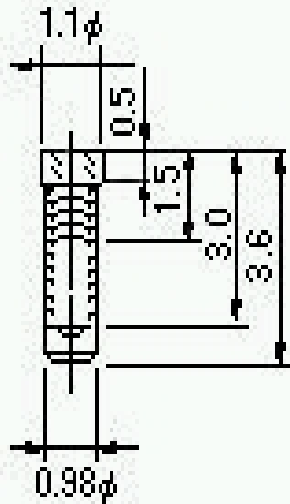

PD Series

all categories > through hole technology > socket pin > pd series > PD-12



#### Socket Pin - PD-12

- Confirm applicable male pin diameter before use.
- Contact Resistance....10m ohm or less
- Depth (mm)...3.0
- Finish....  
Contact part..Au p  
Body part..Sn p
- Material....  
Contact part..Beryllium copper  
Body part..Brass
- Mating/unmating (durability)...100 or more
- Mating/unmating Forces (g or more)...20
- Rated Current (A)...1
- Rated Voltage....125V AC, DC
- Recommended Male Pin Diameter (phi mm)...0.35 to 0.5
- Recommended Through-hole Diameter (phi mm)...1.0
- Temperature Range (Degrees Celcius)...-40 to +125

-  [Save To Favorites](#)
-  [Download Catalog](#)

>> request quote / information | >> download specs