

REVISIONS			
REV	DESCRIPTION, ECN, EAR NO.	DATE	APP'D
A	PROPOSAL	NOV.06/2019	A.GREEN

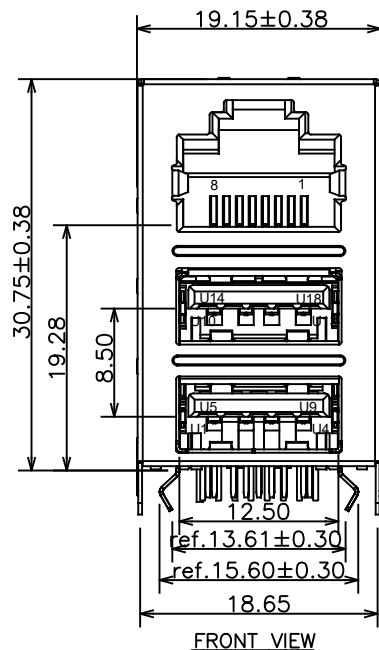

FRONT VIEW

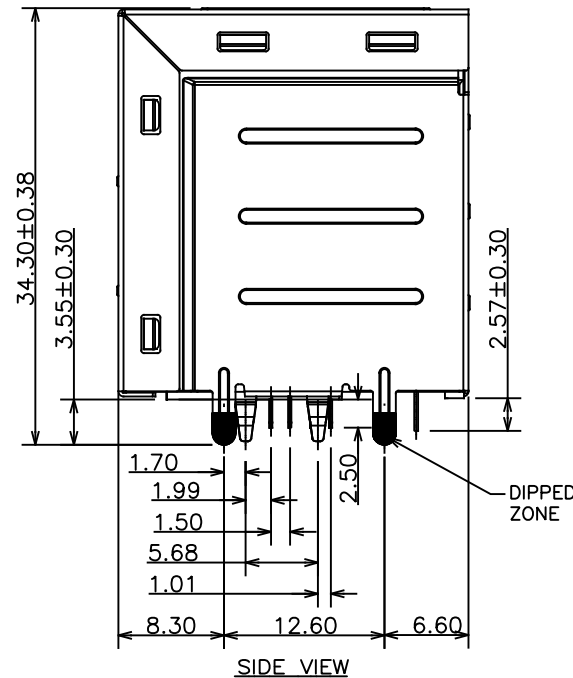

SIDE VIEW

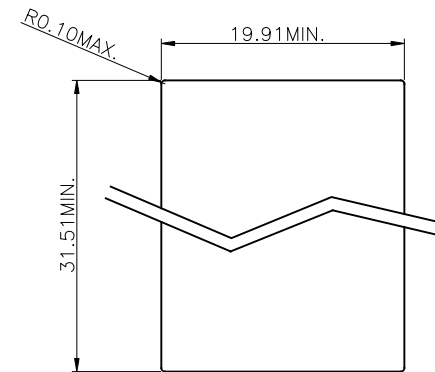

RECOMMENDED PANEL CUTOUT

#### MATERIALS:

RJ:  
HOUSING & COVER: ENGINEERING THERMOPLASTIC  
FLAMMABILITY RATING UL 94V-0, COLOUR: BLACK  
CONTACTS: PHOSPHOR BRONZE  
PLATING: SELECTIVE GOLD PLATING ON MATING SURFACES  
SEE AMPHENOL PART NUMBER FOR DETAIL.  
50  $\mu$  " [1.27 MICRONS]  
MIN. NICKEL UNDERPLATE  
100  $\mu$  " TIN PLATING ON CONTACT TAILS.  
SHIELD: STAINLESS STEEL, WITH TIN-DIP ON SOLDER TABS.

#### USB:

HOUSING: ENGINEERING THERMOPLASTIC  
FLAMMABILITY RATING UL 94V-0,  
COLOUR: BLUE  
CONTACTS: PHOSPHOR BRONZE  
PLATING: SELECTIVE GOLD FLASH ON MATING SURFACES  
50  $\mu$  " [1.27 MICRONS]  
MIN. NICKEL UNDERPLATE  
100  $\mu$  " TIN PLATING ON CONTACT TAILS  
SHIELD: STAINLESS STEEL WITH NICKEL.

AMPHENOL PART NUMBER: RJE36-188-2X05

GOLD PLATING  
0 = GOLD FLASH  
1 = 6  $\mu$  INCH  
2 = 15  $\mu$  INCH  
3 = 30  $\mu$  INCH  
4 = 50  $\mu$  INCH

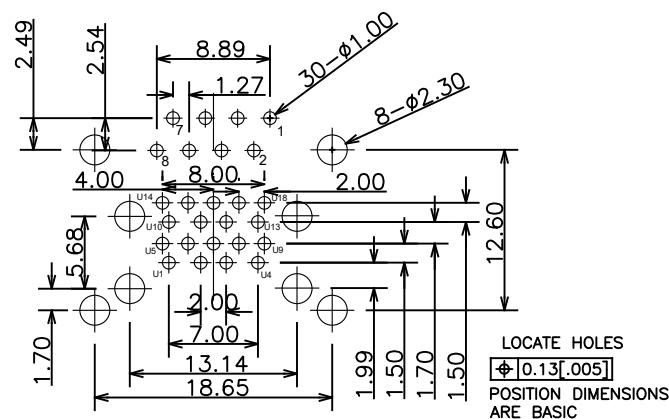

RECOMMENDED P.C.B. LAYOUT  
(COMPONENT SIDE OF BOARD)  
TOLERANCE:  $\pm 0.05$



UNLESS SPECIFIED OTHERWISE		DRAWN	JACK.GUO	DATE	NOV.06/2019	Amphenol Canada Corp. Commercial Products	
PRIMARY UNITS	MILLIMETER	CHECKED	L.CHAN	NOV.06/2019			
SECONDARY		M.E. APP'D					
REFERENCE IN PARENTHESES		Q.A. APP'D					
GENERAL TOLERANCES		DWG APPR.	A.GREEN	NOV.06/2019		TITLE RJ45 OVER TWO USB 3.0 COMBO, DIP TYPE WITHOUT TABS, WITHOUT LEDS-RoHS COMPLIANT	
1 DECIMAL PLACE	$\pm 0.30$	ENG. REL. NO.					
2 DECIMAL PLACES	$\pm 0.25$	REF.					
3 DECIMAL PLACES	$\pm 0.20$	THIRD ANGLE PROJECTION					
ANGULAR DEGREES	$\pm 1.0^\circ$	DO NOT SCALE DRAWING				DWG. NO. P-RJE36-188-2X05 CODE ID NO. 03554 DWG SIZE: C SCALE: N/A SHEET 1 OF 1	