

TYPE 103
SAME AS TYPE 10
EXCEPT AS SHOWN

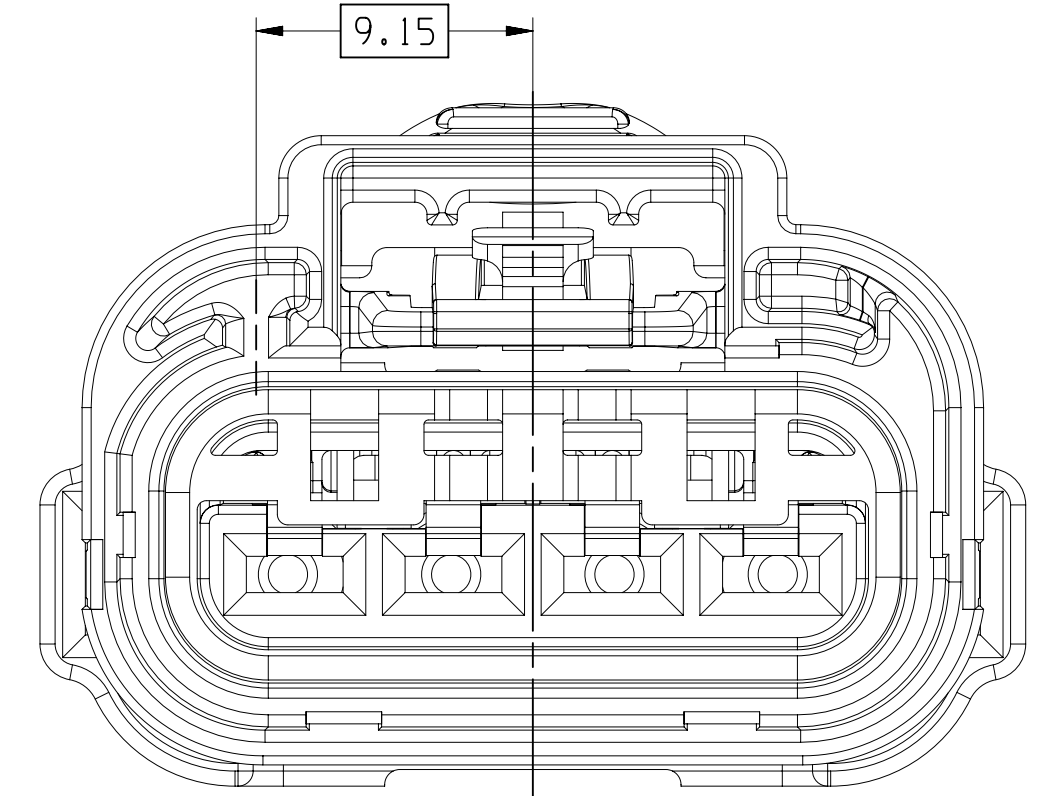

TYPE 105
SAME AS TYPE 10
EXCEPT AS SHOWN

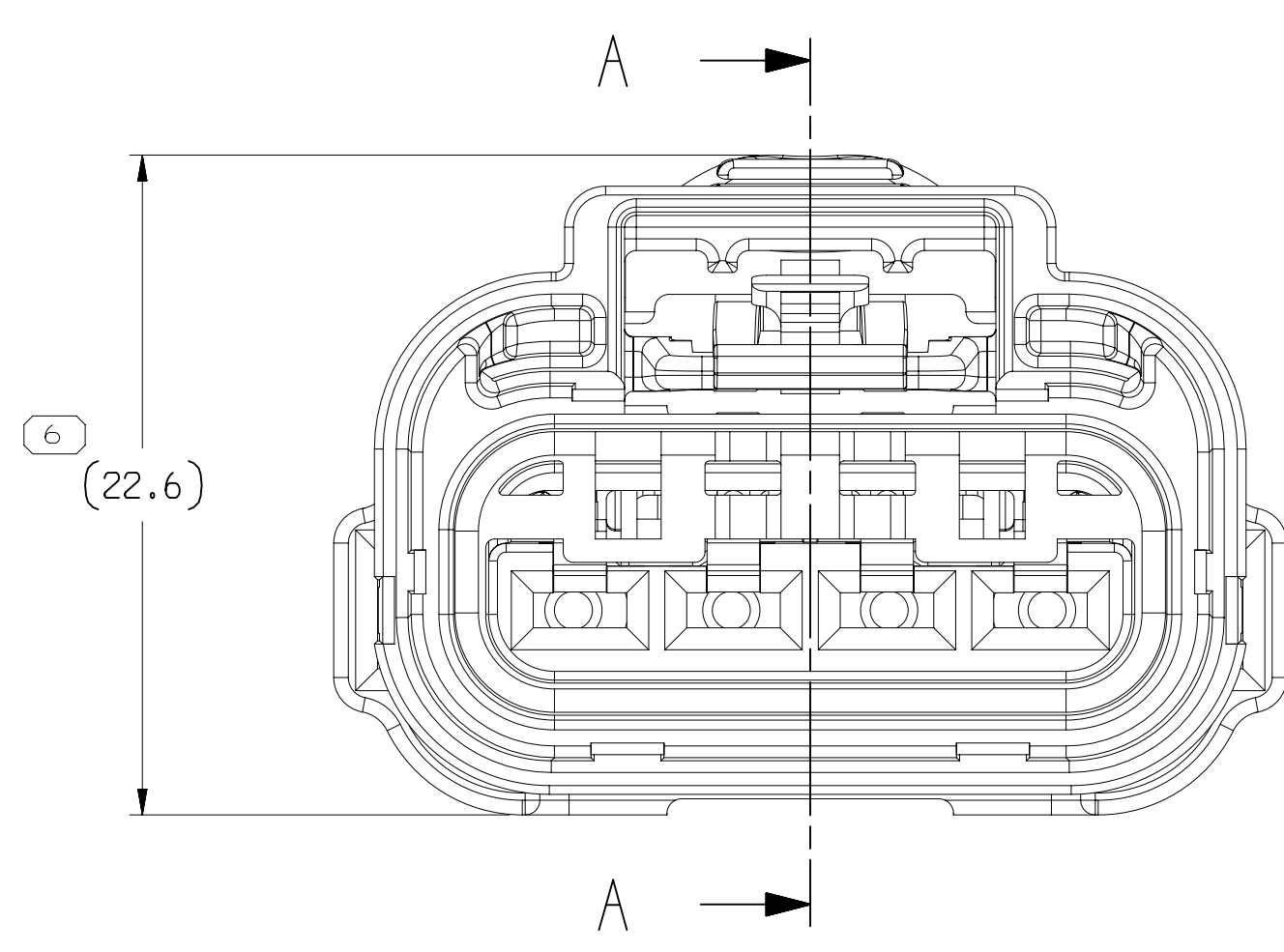

TYPE 101

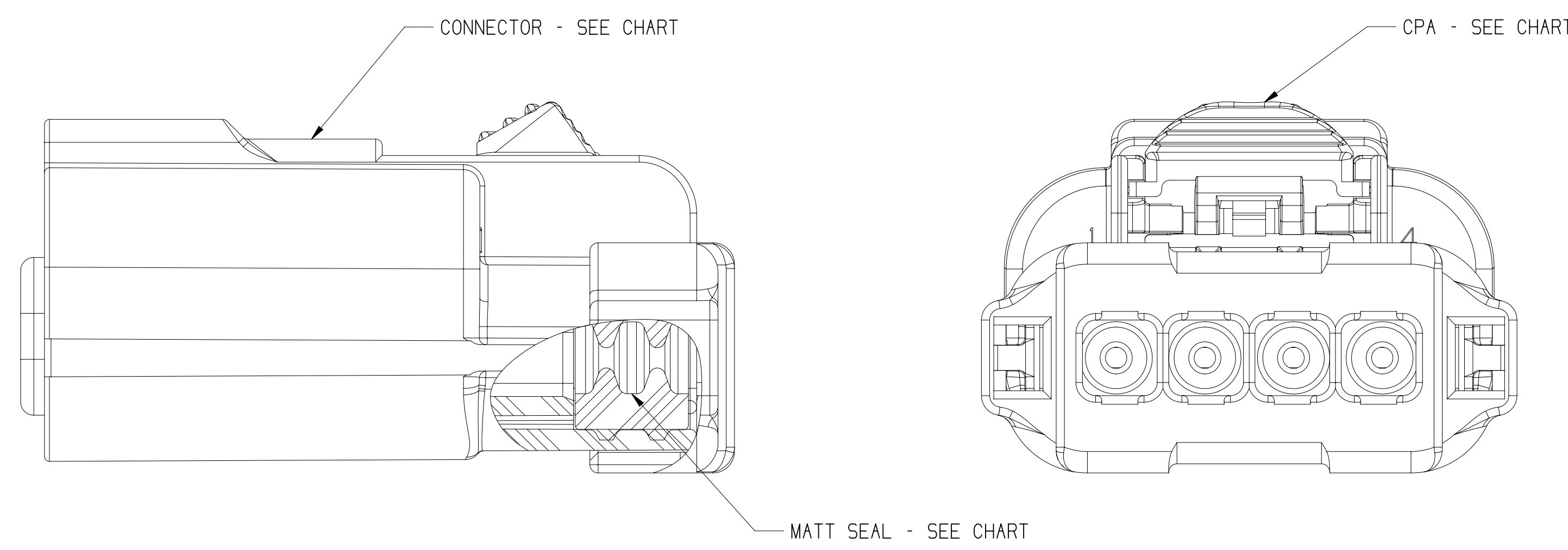

AL - SEE CHART

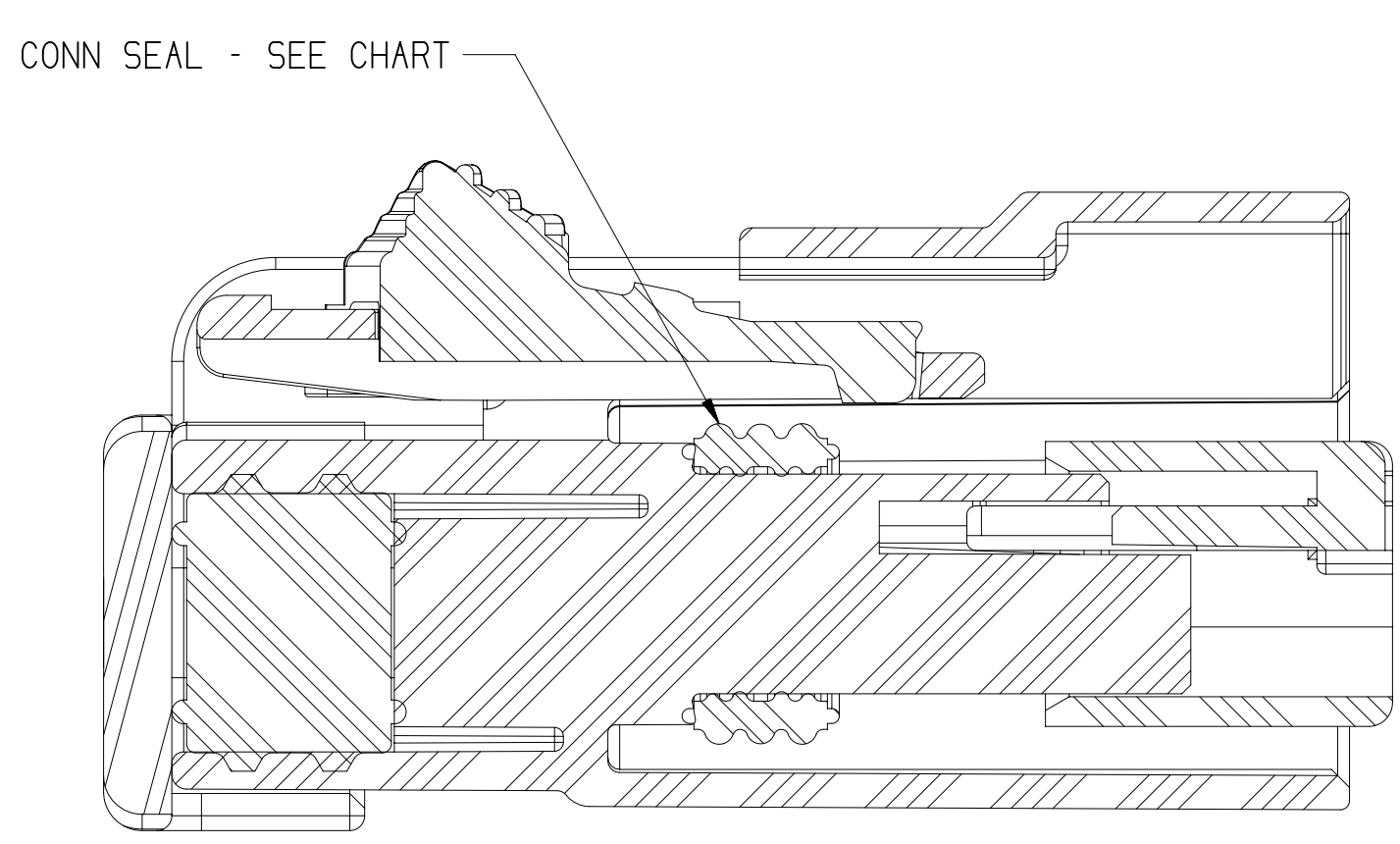

SECTION A-A

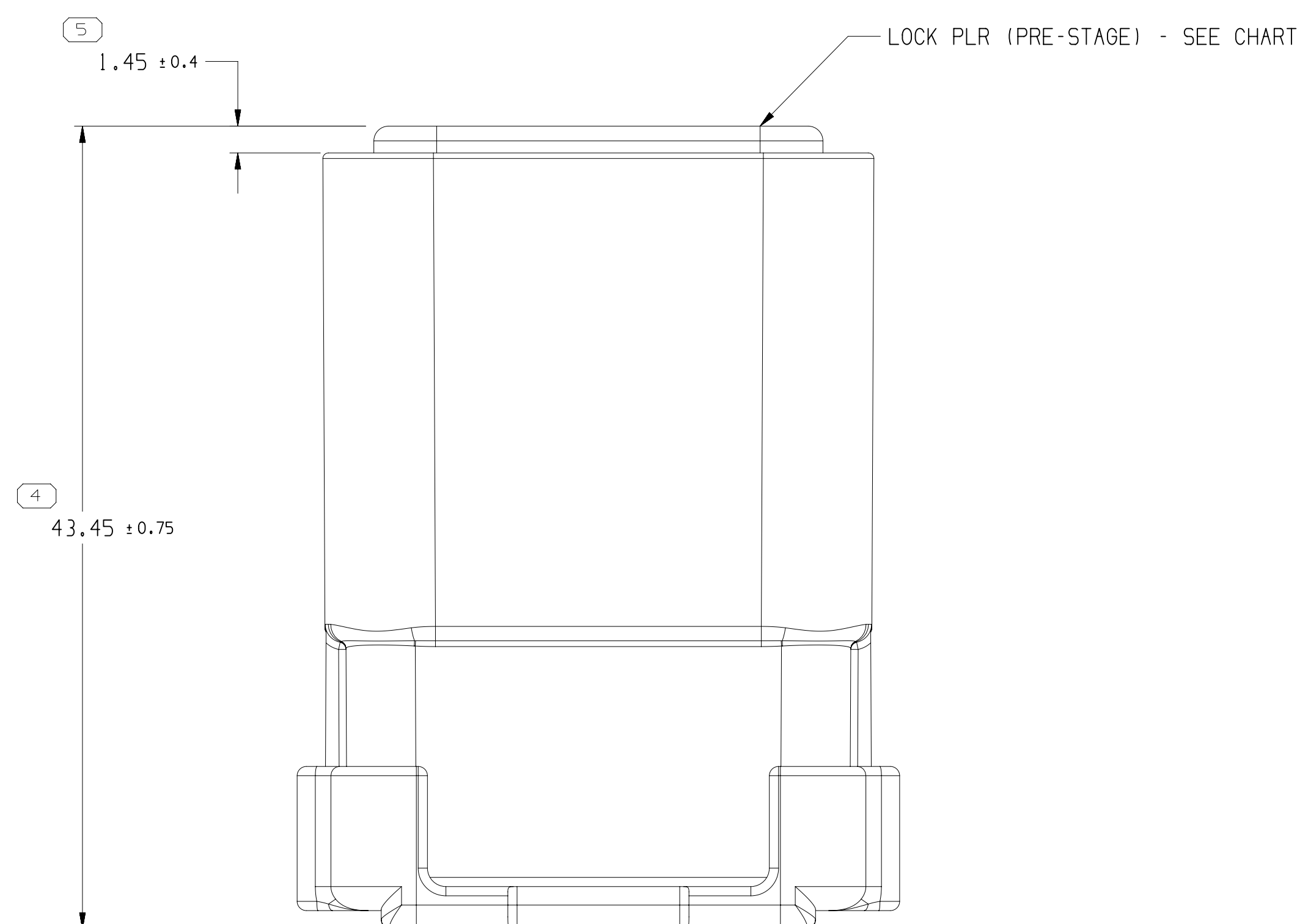

— LOCK PLR (PRE-STAGE) - SEE CHART

35333814	01	AF	105	35333810	54200442	33511959	54200459	33511960	C17019-U	33185280	54200440	15537508	15519096	125° C	O.D., 1.72±0.08 TO 3.80±0.08 ON ANY LOCATION	-			
35333813	01	AF	104	35333809	54200442	33511959	54200459	33511960	C17019-U	33185280	54200440	15537508	15519096	125° C	O.D., 1.72±0.08 TO 3.80±0.08 ON ANY LOCATION	-			
35333812	01	AF	103	35333807	54200442	33511959	54200459	33511960	C17019-U	33185280	54200440	15537508	15519096	125° C	O.D., 1.72±0.08 TO 3.80±0.08 ON ANY LOCATION	-			
35337229	01	AD	102	35264993	54200442	33511959	54200459	33511960	C17019-U	33185280	-	35234776	15519096	125° C	O.D., 1.72±0.08 TO 3.80±0.08 ON ANY LOCATION	-			
35243535	02	AG	101	35264993	54200442	33511959	54200459	33511960	C17019-U	33185280	54200440	15537508	15519096	125° C	O.D., 1.72±0.08 TO 3.80±0.08 ON ANY LOCATION	-			
PART NO	REV	N/P	TYPE	CONNECTOR	MVL	APTV	MVL	APTV	MVL	APTV	MVL	APTV	CPA	TEMP APPV	1	2	3	4	PLUS
					LOCK PLR		CONN SEAL		MATT SEAL		RETAINER								

NOTES

1. UNLESS OTHERWISE SPECIFIED AND/OR INDICATED:
DIMENSIONS ARE TO FACE OF VIEW SHOWN AND
AUTOMATICALLY ROUNDED BY COMPUTER FOR INSPECTION
(SEE MATH MODEL FOR PRECISE DIMENSIONS). FOR ALL
OTHER DIMENSIONS NOT SHOWN BUT REQUIRED FOR TOOL
BUILD, SEE MATH MODEL FOR PRECISE TOOL PAPER DATA.
2. THIS PRODUCT IS NOT CATEGORIZED AS AN APPEARANCE ITEM, MINOR
IMPERFECTIONS INCLUDING BUT NOT LIMITED TO, FLOW MARKS, COLOR
BLEMISHES, GATE VESTIGES, AND SOFT FLASH THAT DO NOT AFFECT THE
FIT, FORM, OR FUNCTION OF THE PART ARE PERMISSIBLE PER ENP-4-3.CS.01.EN.
3. FOR APPLICATION DATA SEE THE INDIVIDUAL APPLICATION DRAWINGS.
4. SEALING CODE 4 - DESIGN WILL MEET REQUIREMENTS OF SAE/USCAR-2
CONNECTOR SYSTEM ENVIRONMENTAL TEST FLOWCHART
(PRESSURE/VACUUM AND SUBMERSION).

DIMENSIONAL RANGE (MM)		CHART							
FROM	> 0	> 20	> 30	> 70	> 100	> 150	> 200	> 250	> 300
TO	20	30	70	100	150	200	250	300	400
TOLERANCE UNLESS OTHERWISE SPECIFIED									
	+0.15	+0.2	+0.3	+0.4	+0.5	+0.6	+0.8	+1	+1.2

TITLE <div style="font-size: 2em; font-weight: bold; text-align: center;">P</div>		PART DRAWING	
VOLUME (OF) <div style="font-size: 2em; font-weight: bold; text-align: center;">1</div>		DISTR CODE <div style="font-size: 2em; font-weight: bold; text-align: center;">D</div>	
THIS DOCUMENT IS NOT OTHERWISE SPECIFIED UNLESS IT IS IN ACCORDANCE WITH ASME Y14.100 (MAY 1993 EDITION) AND Y14.101 (LATEST EDITION) OF PRACTICES FOR FIRST ANGLE OR SECOND ANGLE OF PICTORIAL REPRESENTATION.			
ALL DIMENSIONS ARE IN MILLIMETERS			
REFERENCE:			
THIRD ANGLE PROJECTION		DO NOT SCALE	
USE MATH AS SHOWN		DRAWING NUMBER <div style="font-size: 2em; font-weight: bold; text-align: center;">35268455</div>	
SIZE <div style="font-size: 2em; font-weight: bold; text-align: center;">A</div>		SCALE <div style="font-size: 2em; font-weight: bold; text-align: center;">1:1</div>	
FRAME NO <div style="font-size: 2em; font-weight: bold; text-align: center;">1</div>		SHEET NO <div style="font-size: 2em; font-weight: bold; text-align: center;">1</div>	
TOTAL NO <div style="font-size: 2em; font-weight: bold; text-align: center;">1</div>		TOTAL NO <div style="font-size: 2em; font-weight: bold; text-align: center;">1</div>	

224020523