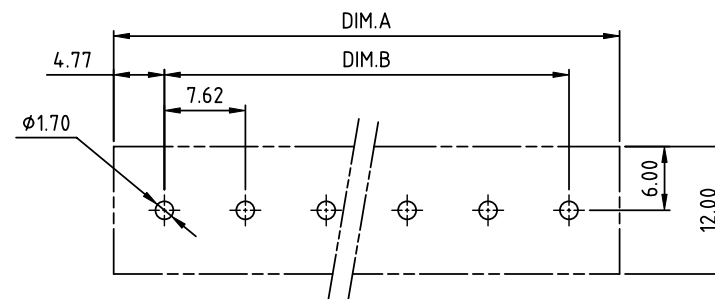
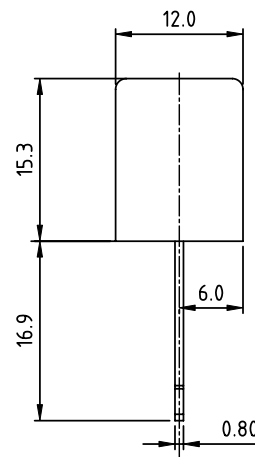
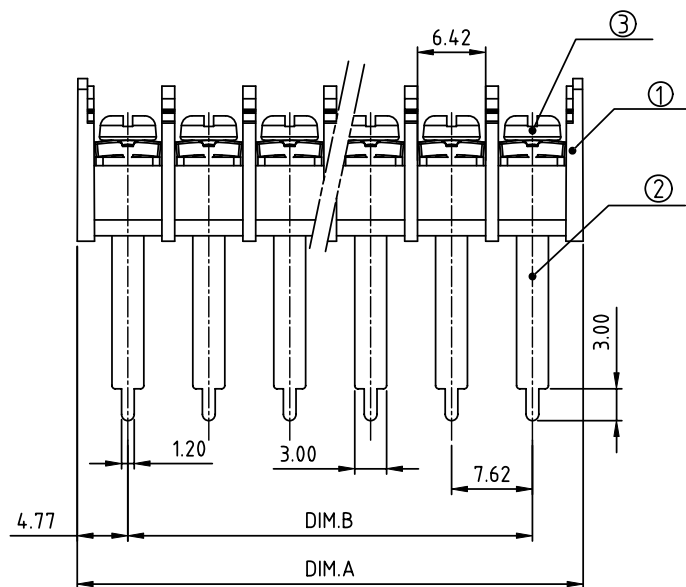
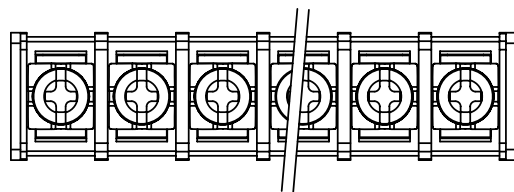

PRODUCT NUMBER

PITCH

YK304xx0x0J0G

7.62 mm

RECOMMENDED P.C.B LAYOUT
TOP VIEW

MATERIALS ELECTRICAL
 RATED VOLTAGE & CURRENT:
 WITHSTAND VOLTAGE:
 INSULATION RESISTANCE:
 OPERATING TEMPERATURE RANGE:
 SCREW TORQUE VALUE:
 WIRE RANGE:
 1) HOUSING:
 2) TERMINAL:
 3) TERMINAL SCREWS:

300 V, 15 A
 AC 2000 V/Min
 1000 MΩ OR MORE AT DC 500 V
 -40 °C ~ +115 °C
 5.2 Lb-In.
 14 ~ 22 AWG
 THERMOPLASTIC, UL 94 V-0 BLACK
 BRASS, 0.8t
 STEEL, M3

DIMENSION

Dim A	(N-1)×7.62+9.54
Dim B	(N-1)×7.62

N=Number of poles

Poles	Tolerance
2p-4p	±0.20
5p-10p	±0.30
11p-16p	±0.40
17p-20p	±0.50

PART NO.: YK 304xx 0 x 0 J0G

No. of poles
 02 2 poles
 03 3 poles
 ...
 20 20 poles

Plated

Code	Terminal	Screw
0	G/F	G/F
1	G/F	Zinc
2	Tin	G/F
3	Tin	Zinc

RoHS compliant
 (lead<4%)
 In copper Alloy

mat'l. code				surface ASME Y14.5 ✓	tolerance ASME Y14.5	projection MM	product family TERMINAL BLOCK	
ltr	ecn	no	dr	date	tolerances unless otherwise specified	MM	title TERMINAL BLOCK	
					angles X°±1°	scale	BARRIER TYPE	
					dr HANKE FENG 060914		dwg no	
					enr HANKE FENG 060914		YK304xx0x0J0G	
					chr HANKE FENG 060914		sheet 1 of 1	
					appd SHI JUN 060914		size A4	
sheet index				revision	A		type CUSTOMER Drawing	
				sheet	1			