

# ON Semiconductor

## Is Now



To learn more about onsemi™, please visit our website at  
[www.onsemi.com](http://www.onsemi.com)

**onsemi** and **onsemi** and other names, marks, and brands are registered and/or common law trademarks of Semiconductor Components Industries, LLC dba "**onsemi**" or its affiliates and/or subsidiaries in the United States and/or other countries. **onsemi** owns the rights to a number of patents, trademarks, copyrights, trade secrets, and other intellectual property. A listing of **onsemi** product/patent coverage may be accessed at [www.onsemi.com/site/pdf/Patent-Marking.pdf](http://www.onsemi.com/site/pdf/Patent-Marking.pdf). **onsemi** reserves the right to make changes at any time to any products or information herein, without notice. The information herein is provided "as-is" and **onsemi** makes no warranty, representation or guarantee regarding the accuracy of the information, product features, availability, functionality, or suitability of its products for any particular purpose, nor does **onsemi** assume any liability arising out of the application or use of any product or circuit, and specifically disclaims any and all liability, including without limitation special, consequential or incidental damages. Buyer is responsible for its products and applications using **onsemi** products, including compliance with all laws, regulations and safety requirements or standards, regardless of any support or applications information provided by **onsemi**. "Typical" parameters which may be provided in **onsemi** data sheets and/or specifications can and do vary in different applications and actual performance may vary over time. All operating parameters, including "Typicals" must be validated for each customer application by customer's technical experts. **onsemi** does not convey any license under any of its intellectual property rights nor the rights of others. **onsemi** products are not designed, intended, or authorized for use as a critical component in life support systems or any FDA Class 3 medical devices or medical devices with a same or similar classification in a foreign jurisdiction or any devices intended for implantation in the human body. Should Buyer purchase or use **onsemi** products for any such unintended or unauthorized application, Buyer shall indemnify and hold **onsemi** and its officers, employees, subsidiaries, affiliates, and distributors harmless against all claims, costs, damages, and expenses, and reasonable attorney fees arising out of, directly or indirectly, any claim of personal injury or death associated with such unintended or unauthorized use, even if such claim alleges that **onsemi** was negligent regarding the design or manufacture of the part. **onsemi** is an Equal Opportunity/Affirmative Action Employer. This literature is subject to all applicable copyright laws and is not for resale in any manner. Other names and brands may be claimed as the property of others.

# FDMS4D4N08C

## MOSFET – POWERTRENCH<sup>®</sup>, N-Channel Shielded Gate

**80 V, 123 A, 4.3 mΩ**

### Description

This N-Channel MV MOSFET is produced using ON Semiconductor's advanced POWERTRENCH<sup>®</sup> process that incorporates Shielded Gate technology. This process has been optimized to minimise on-state resistance and yet maintain superior switching performance with best in class soft body diode.

### Features

- Shielded Gate MOSFET Technology
- Max  $r_{DS(on)}$  = 4.3 mΩ at  $V_{GS} = 10$  V,  $I_D = 44$  A
- Max  $r_{DS(on)}$  = 10.4 mΩ at  $V_{GS} = 6$  V,  $I_D = 22$  A
- 50% Lower  $Q_{rr}$  than Other MOSFET Suppliers
- Lowers Switching Noise/EMI
- MSL1 Robust Package Design
- 100% UIL Tested
- RoHS Compliant

### Typical Applications

- Primary DC–DC MOSFET
- Synchronous Rectifier in DC–DC and AC–DC
- Motor Drive
- Solar



**ON Semiconductor<sup>®</sup>**

[www.onsemi.com](http://www.onsemi.com)

### ELECTRICAL CONNECTION

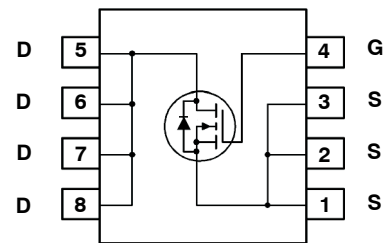

**N-Channel MOSFET**

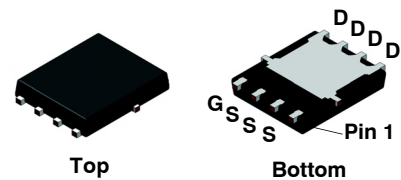

**Power 56  
(PQFN8 5x6)  
CASE 483AE**

### MARKING DIAGRAM

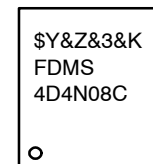

|             |                         |
|-------------|-------------------------|
| \$Y         | = ON Semiconductor Logo |
| &Z          | = Assembly Plant Code   |
| &3          | = Numeric Date Code     |
| &K          | = Lot Code              |
| FDMS4D4N08C | = Specific Device Code  |

### ORDERING INFORMATION

See detailed ordering and shipping information on page 2 of this data sheet.

# FDMS4D4N08C

## MOSFET MAXIMUM RATINGS ( $T_A = 25^\circ\text{C}$ , Unless otherwise specified)

| Symbol         | Parameter   | Ratings         | Unit             |
|----------------|---|-----------------|------------------|
| $V_{DS}$       | Drain to Source Voltage                                     | 80              | V                |
| $V_{GS}$       | Gate to Source Voltage                                      | $\pm 20$        | V                |
| $I_D$          | Drain Current –Continuous $T_C = 25^\circ\text{C}$ (Note 5) | 123             | A                |
|                | –Continuous $T_C = 100^\circ\text{C}$ (Note 5)              | 78              |                  |
|                | –Continuous $T_A = 25^\circ\text{C}$ (Note 1a)              | 17              |                  |
|                | –Pulsed (Note 4)  | 498             |                  |
| $E_{AS}$       | Single Pulse Avalanche Energy (Note 3)                      | 486             | mJ               |
| $P_D$          | Power Dissipation $T_C = 25^\circ\text{C}$                  | 125             | W                |
|                | Power Dissipation $T_A = 25^\circ\text{C}$ (Note 1a)        | 2.5             |                  |
| $T_J, T_{STG}$ | Operating and Storage Junction Temperature Range            | $-55$ to $+150$ | $^\circ\text{C}$ |

Stresses exceeding those listed in the Maximum Ratings table may damage the device. If any of these limits are exceeded, device functionality should not be assumed, damage may occur and reliability may be affected.

## THERMAL CHARACTERISTICS

| Symbol          | Parameter   | Ratings | Unit                      |
|-----------------|---|---------|---------------------------|
| $R_{\theta JC}$ | Thermal Resistance, Junction to Case              | 1.0     | $^\circ\text{C}/\text{W}$ |
| $R_{\theta JA}$ | Thermal Resistance, Junction to Ambient (Note 1a) | 50      |                           |

## PACKAGE MARKING AND ORDERING INFORMATION

| Device Marking | Device      | Package                             | Shipping <sup>†</sup>      |
|----------------|-------------|-------------------------------------|----------------------------|
| FDMS4D4N08C    | FDMS4D4N08C | PQFN8 5x6<br>(Pb-Free/Halogen Free) | 3000 Units/<br>Tape & Reel |

<sup>†</sup>For information on tape and reel specifications, including part orientation and tape sizes, please refer to our Tape and Reel Packaging Specifications Brochure, BRD8011/D.

# FDMS4D4N08C

## ELECTRICAL CHARACTERISTICS (T<sub>J</sub> = 25°C unless otherwise noted)

| Symbol | Parameter | Test Conditions | Min. | Typ. | Max. | Units |
|--------|-----------|-----------------|------|------|------|-------|
|--------|-----------|-----------------|------|------|------|-------|

### OFF CHARACTERISTICS

|                                      |   |  |    |    |      |       |
|--------------------------------------|---|--|----|----|------|-------|
| BV <sub>DSS</sub>                    | Drain to Source Breakdown Voltage         | I <sub>D</sub> = 250 μA, V <sub>GS</sub> = 0 V | 80 |    |      | V     |
| $\frac{\Delta BV_{DSS}}{\Delta T_J}$ | Breakdown Voltage Temperature Coefficient | I <sub>D</sub> = 250 μA, referenced to 25°C    |    | 63 |      | mV/°C |
| I <sub>DSS</sub>                     | Zero Gate Voltage Drain Current           | V <sub>DS</sub> = 64 V, V <sub>GS</sub> = 0 V  |    |    | 1    | μA    |
| I <sub>GSS</sub>                     | Gate to Source Leakage Current            | V <sub>GS</sub> = ±20 V, V <sub>DS</sub> = 0 V |    |    | ±100 | nA    |

### ON CHARACTERISTICS (Note NO TAG)

|  |  |   |     |      |      |       |
|--|--|---|-----|------|------|-------|
| V <sub>GS(th)</sub>                    | Gate to Source Threshold Voltage                         | V <sub>GS</sub> = V <sub>DS</sub> , I <sub>D</sub> = 250 μA           | 2.0 | 3.0  | 4.0  | V     |
| $\frac{\Delta V_{GS(th)}}{\Delta T_J}$ | Gate to Source Threshold Voltage Temperature Coefficient | I <sub>D</sub> = 250 μA, referenced to 25°C                           |     | -8.2 |      | mV/°C |
| r <sub>DS(on)</sub>                    | Static Drain to Source On Resistance                     | V <sub>GS</sub> = 10 V, I <sub>D</sub> = 44 A                         |     | 3.7  | 4.3  | mΩ    |
|  |  | V <sub>GS</sub> = 6 V, I <sub>D</sub> = 22 A                          |     | 5.7  | 10.4 |       |
|  |  | V <sub>GS</sub> = 10 V, I <sub>D</sub> = 44 A, T <sub>J</sub> = 125°C |     | 5.9  | 7.2  |       |
| g <sub>FS</sub>                        | Forward Transconductance                                 | V <sub>DS</sub> = 5 V, I <sub>D</sub> = 44 A                          |     | 98   |      | S     |

### DYNAMIC CHARACTERISTICS

|                  |                              |  |     |      |      |    |
|------------------|------------------------------|--|-----|------|------|----|
| C <sub>ISS</sub> | Input Capacitance            | V <sub>DS</sub> = 40 V, V <sub>GS</sub> = 0 V, f = 1 MHz |     | 2920 | 4090 | pF |
| C <sub>OSS</sub> | Output Capacitance           |  |     | 1045 | 1465 |    |
| C <sub>RSS</sub> | Reverse Transfer Capacitance |  |     | 35   | 50   |    |
| R <sub>G</sub>   | Gate Resistance              |  | 0.1 | 1.3  | 2.5  | Ω  |

### SWITCHING CHARACTERISTICS

|                     |                               |   |   |    |    |    |
|---------------------|-------------------------------|---|---|----|----|----|
| t <sub>d(on)</sub>  | Turn – On Delay Time          | V <sub>DD</sub> = 40 V, I <sub>D</sub> = 44 A, V <sub>GS</sub> = 10 V, R <sub>GEN</sub> = 6 Ω |   | 17 | 31 | ns |
| t <sub>r</sub>      | Rise Time                     |   |   | 7  | 15 |    |
| t <sub>d(off)</sub> | Turn – Off Delay Time         |   |   | 25 | 40 |    |
| t <sub>f</sub>      | Fall Time                     |   |   | 5  | 10 |    |
| Q <sub>g</sub>      | Total Gate Charge             | V <sub>GS</sub> = 0 V to 10 V   | V <sub>DD</sub> = 40 V, I <sub>D</sub> = 44 A | 40 | 56 | nC |
| Q <sub>g</sub>      | Total Gate Charge             | V <sub>GS</sub> = 0 V to 6 V  |   | 25 | 35 |    |
| Q <sub>gs</sub>     | Gate to Source Charge         |   |   | 13 |    |    |
| Q <sub>gd</sub>     | Gate to Drain "Miller" Charge |   |   | 8  |    |    |
| Q <sub>OSS</sub>    | Output Charge                 | V <sub>DD</sub> = 40 V, V <sub>GS</sub> = 0 V   |   | 60 |    | nC |
| Q <sub>sync</sub>   | Output Charge                 | V <sub>DS</sub> = 0 V, I <sub>D</sub> = 44 A  |   | 35 |    |    |

### DRAIN-SOURCE DIODE CHARACTERISTICS

|                 |                                       |  |  |     |     |    |
|-----------------|---------------------------------------|--|--|-----|-----|----|
| V <sub>SD</sub> | Source to Drain Diode Forward Voltage | V <sub>GS</sub> = 0 V, I <sub>S</sub> = 2.1 A (Note 2) |  | 0.7 | 1.2 | V  |
|                 |                                       | V <sub>GS</sub> = 0 V, I <sub>S</sub> = 44 A (Note 2)  |  | 0.8 | 1.3 |    |
| t <sub>rr</sub> | Reverse Recovery Time                 | I <sub>F</sub> = 22 A, di/dt = 300 A/μs                |  | 26  | 42  | ns |
| Q <sub>rr</sub> | Reverse Recovery Charge               |  |  | 44  | 71  | nC |
| t <sub>rr</sub> | Reverse Recovery Time                 | I <sub>F</sub> = 22 A, di/dt = 1000 A/μs               |  | 20  | 32  | ns |
| Q <sub>rr</sub> | Reverse Recovery Charge               |  |  | 106 | 169 | nC |

Product parametric performance is indicated in the Electrical Characteristics for the listed test conditions, unless otherwise noted. Product performance may not be indicated by the Electrical Characteristics if operated under different conditions.

## FDMS4D4N08C

### NOTES:

1.  $R_{\theta JA}$  is determined with the device mounted on a 1 in<sup>2</sup> pad 2 oz copper pad on a 1.5 × 1.5 in. board of FR-4 material.  $R_{\theta CA}$  is determined by the user's board design.

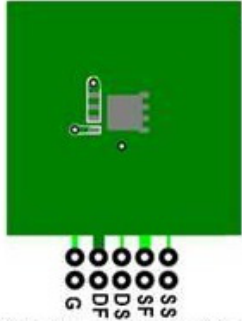

a) 50°C/W when mounted on a 1 in<sup>2</sup> pad of 2 oz copper.

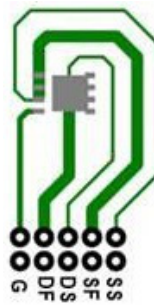

b) 125°C/W when mounted on a minimum pad of 2 oz copper.

2. Pulse Test: Pulse Width < 300  $\mu$ s, Duty cycle < 2.0%.
3.  $E_{AS}$  of 486 mJ is based on starting  $T_J = 25^\circ\text{C}$ ;  $L = 3$  mH,  $I_{AS} = 18$  A,  $V_{DD} = 80$  V,  $V_{GS} = 10$  V. 100% tested at  $L = 0.1$  mH,  $I_{AS} = 51$  A.
4. Pulsed  $I_D$  please refer to Fig. 11 SOA graph for more details.
5. Computed continuous current limited to Max Junction Temperature only, actual continuous current will be limited by thermal & electro-mechanical application board design.

TYPICAL CHARACTERISTICS ( $T_J = 25^\circ\text{C}$  unless otherwise noted)

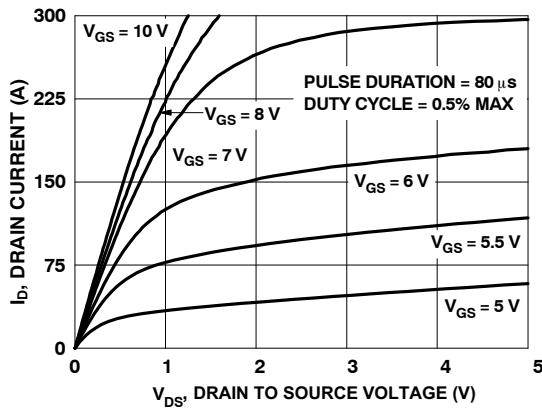

Figure 1. On Region Characteristics

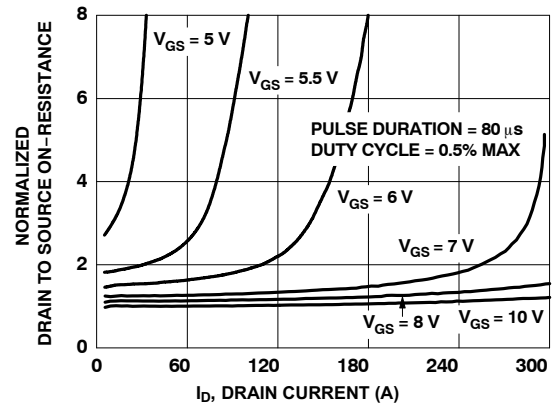

Figure 2. Normalized On-Resistance vs. Drain Current and Gate Voltage

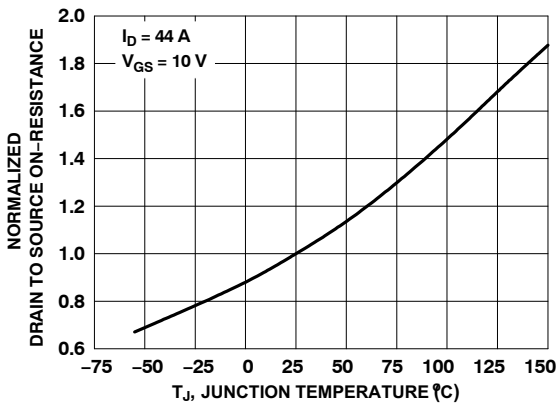

Figure 3. Normalized On Resistance vs. Junction Temperature

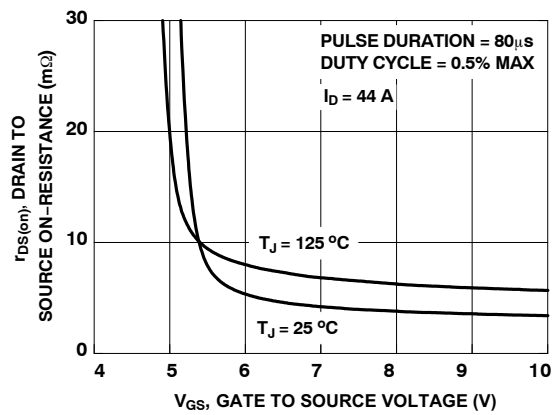

Figure 4. On-Resistance vs. Gate to Source Voltage

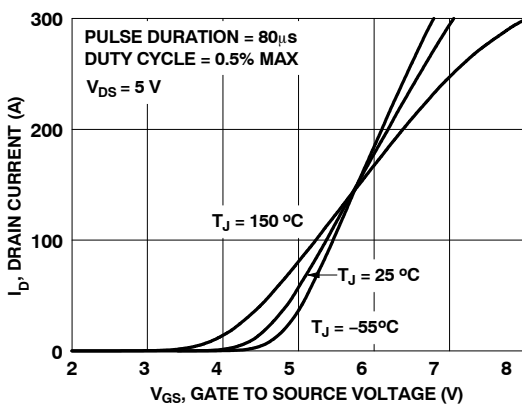

Figure 5. Transfer Characteristics

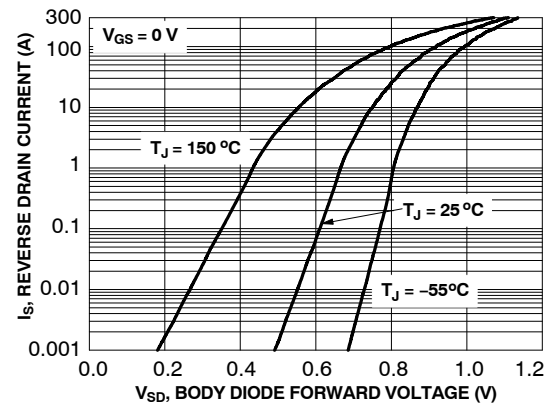

Figure 6. Source to Drain Diode Forward Voltage vs. Source Current

TYPICAL CHARACTERISTICS (continued)

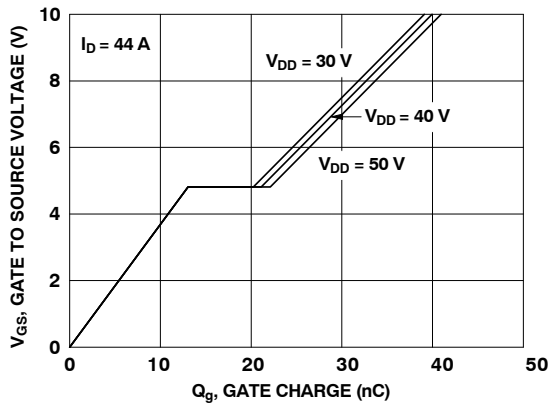

Figure 7. Gate Charge Characteristics

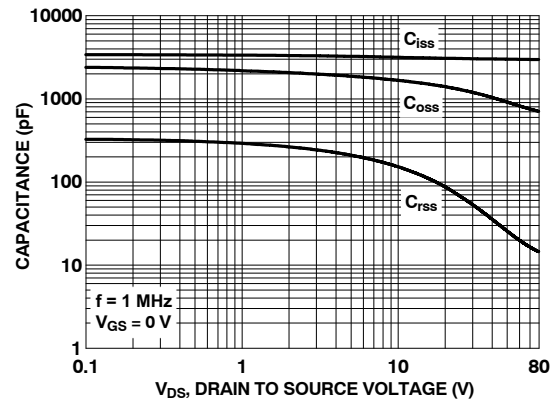

Figure 8. Capacitance vs. Drain to Source Voltage

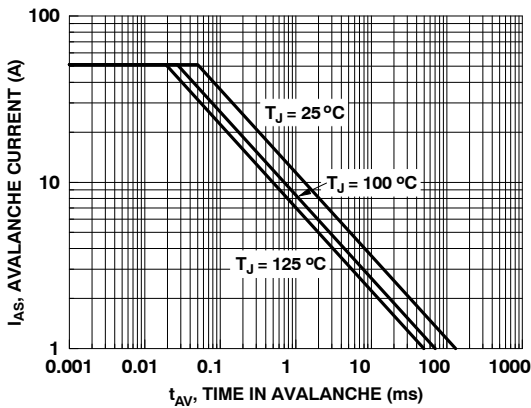

Figure 9. Unclamped Inductive Switching Capability

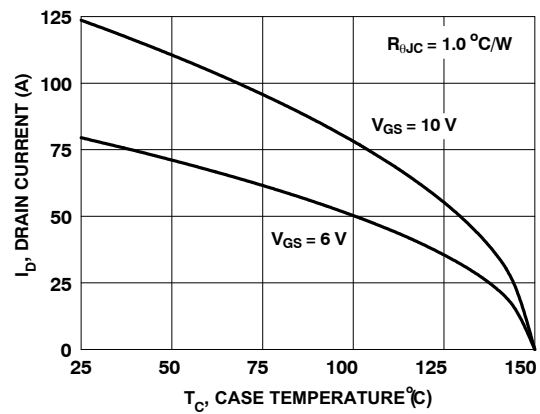

Figure 10. Maximum Continuous Drain Current vs. Case Temperature

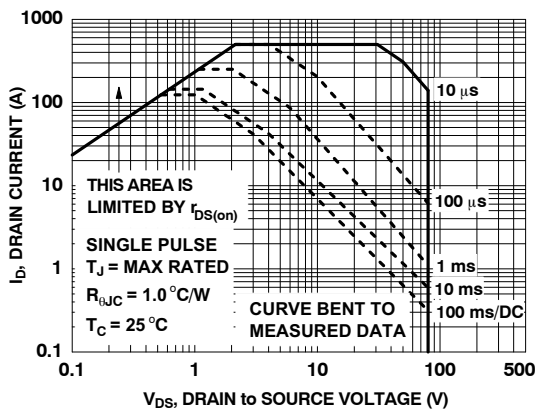

Figure 11. Forward Bias Safe Operating Area

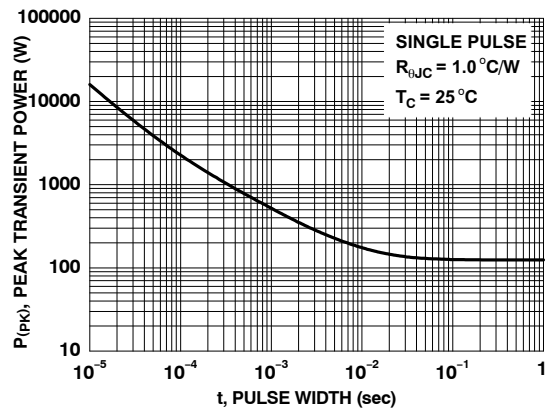

Figure 12. Single Pulse Maximum Power Dissipation

## TYPICAL CHARACTERISTICS (continued)

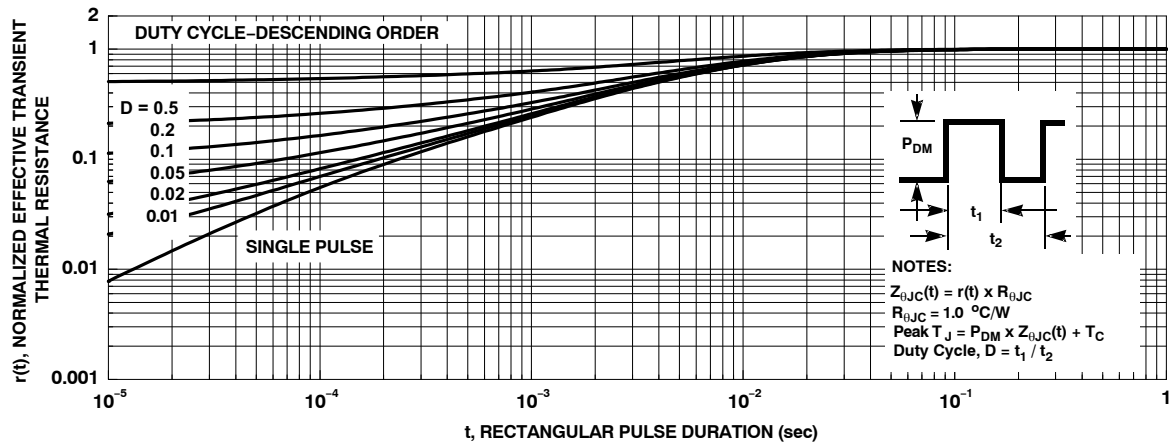

Figure 13. Junction-to-Case Transient Thermal Response Curve



# MECHANICAL CASE OUTLINE

## PACKAGE DIMENSIONS

ON Semiconductor®

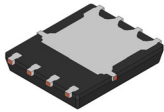

**PQFN8 5X6, 1.27P**  
CASE 483AE  
ISSUE B

DATE 06 JUL 2021

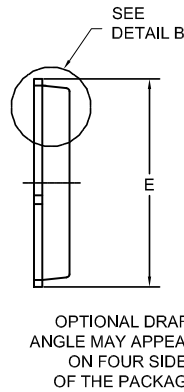
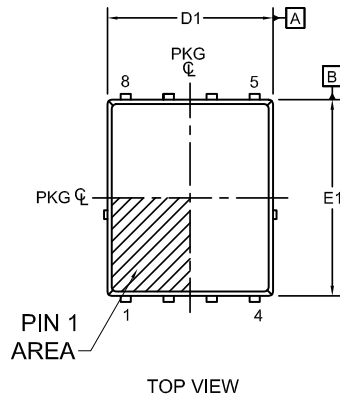

### NOTES:

1. DIMENSIONING AND TOLERANCING PER ASME Y14.5M, 2009.
2. CONTROLLING DIMENSION: MILLIMETERS
3. COPLANARITY APPLIES TO THE EXPOSED PADS AS WELL AS THE TERMINALS.
4. DIMENSIONS D1 AND E1 DO NOT INCLUDE MOLD FLASH, PROTRUSIONS, OR GATE BURRS.
5. SEATING PLANE IS DEFINED BY THE TERMINALS. "A1" IS DEFINED AS THE DISTANCE FROM THE SEATING PLANE TO THE LOWEST POINT ON THE PACKAGE BODY.
6. IT IS RECOMMENDED TO HAVE NO TRACES OR VIAS WITHIN THE KEEP OUT AREA.

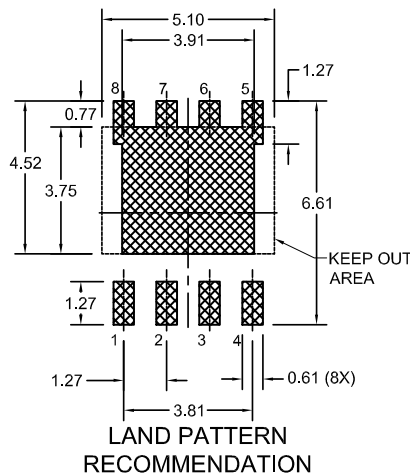
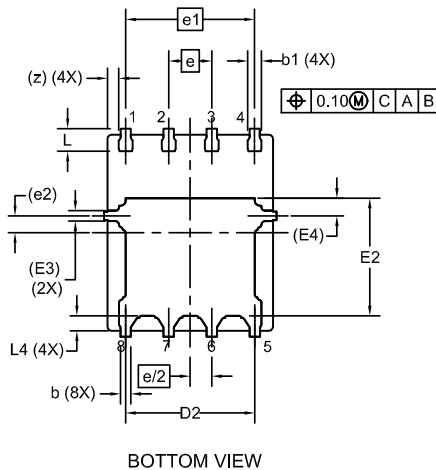
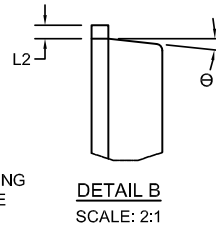
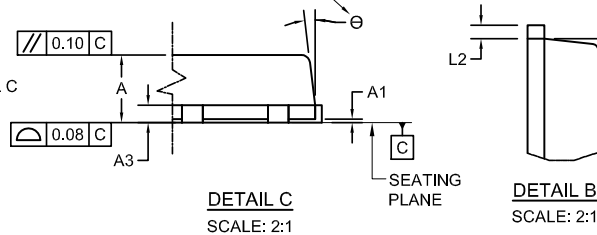
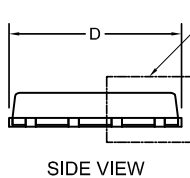

\*FOR ADDITIONAL INFORMATION ON OUR PB-FREE STRATEGY AND SOLDERING DETAILS, PLEASE DOWNLOAD THE ON SEMICONDUCTOR SOLDERING AND MOUNTING TECHNIQUES REFERENCE MANUAL, SOLDERM/D.

| DIM   | MILLIMETERS |      |      |
|-------|-------------|------|------|
|       | MIN.        | NOM. | MAX. |
| A     | 0.90        | 1.00 | 1.10 |
| A1    | 0.00        | -    | 0.05 |
| b     | 0.21        | 0.31 | 0.41 |
| b1    | 0.31        | 0.41 | 0.51 |
| A3    | 0.15        | 0.25 | 0.35 |
| D     | 4.90        | 5.00 | 5.20 |
| D1    | 4.80        | 4.90 | 5.00 |
| D2    | 3.61        | 3.82 | 3.96 |
| E     | 6.05        | 6.15 | 6.25 |
| E1    | 5.70        | 5.80 | 5.90 |
| E2    | 3.38        | 3.48 | 3.78 |
| E3    | 0.30 REF    |      |      |
| E4    | 0.52 REF    |      |      |
| e     | 1.27 BSC    |      |      |
| e/2   | 0.635 BSC   |      |      |
| e1    | 3.81 BSC    |      |      |
| e2    | 0.50 REF    |      |      |
| L     | 0.51        | 0.66 | 0.76 |
| L2    | 0.05        | 0.18 | 0.30 |
| L4    | 0.34        | 0.44 | 0.54 |
| z     | 0.34 REF    |      |      |
| theta | 0°          | -    | 12°  |

**DOCUMENT NUMBER:** 98AON13655G

Electronic versions are uncontrolled except when accessed directly from the Document Repository. Printed versions are uncontrolled except when stamped "CONTROLLED COPY" in red.

**DESCRIPTION:** PQFN8 5X6, 1.27P

**PAGE 1 OF 1**

ON Semiconductor and are trademarks of Semiconductor Components Industries, LLC dba ON Semiconductor or its subsidiaries in the United States and/or other countries. ON Semiconductor reserves the right to make changes without further notice to any products herein. ON Semiconductor makes no warranty, representation or guarantee regarding the suitability of its products for any particular purpose, nor does ON Semiconductor assume any liability arising out of the application or use of any product or circuit, and specifically disclaims any and all liability, including without limitation special, consequential or incidental damages. ON Semiconductor does not convey any license under its patent rights nor the rights of others.

ON Semiconductor and  are trademarks of Semiconductor Components Industries, LLC dba ON Semiconductor or its subsidiaries in the United States and/or other countries. ON Semiconductor owns the rights to a number of patents, trademarks, copyrights, trade secrets, and other intellectual property. A listing of ON Semiconductor's product/patent coverage may be accessed at [www.onsemi.com/site/pdf/Patent-Marking.pdf](http://www.onsemi.com/site/pdf/Patent-Marking.pdf). ON Semiconductor reserves the right to make changes without further notice to any products herein. ON Semiconductor makes no warranty, representation or guarantee regarding the suitability of its products for any particular purpose, nor does ON Semiconductor assume any liability arising out of the application or use of any product or circuit, and specifically disclaims any and all liability, including without limitation special, consequential or incidental damages. Buyer is responsible for its products and applications using ON Semiconductor products, including compliance with all laws, regulations and safety requirements or standards, regardless of any support or applications information provided by ON Semiconductor. "Typical" parameters which may be provided in ON Semiconductor data sheets and/or specifications can and do vary in different applications and actual performance may vary over time. All operating parameters, including "Typicals" must be validated for each customer application by customer's technical experts. ON Semiconductor does not convey any license under its patent rights nor the rights of others. ON Semiconductor products are not designed, intended, or authorized for use as a critical component in life support systems or any FDA Class 3 medical devices or medical devices with a same or similar classification in a foreign jurisdiction or any devices intended for implantation in the human body. Should Buyer purchase or use ON Semiconductor products for any such unintended or unauthorized application, Buyer shall indemnify and hold ON Semiconductor and its officers, employees, subsidiaries, affiliates, and distributors harmless against all claims, costs, damages, and expenses, and reasonable attorney fees arising out of, directly or indirectly, any claim of personal injury or death associated with such unintended or unauthorized use, even if such claim alleges that ON Semiconductor was negligent regarding the design or manufacture of the part. ON Semiconductor is an Equal Opportunity/Affirmative Action Employer. This literature is subject to all applicable copyright laws and is not for resale in any manner.

## PUBLICATION ORDERING INFORMATION

### LITERATURE FULFILLMENT:

Email Requests to: [orderlit@onsemi.com](mailto:orderlit@onsemi.com)

ON Semiconductor Website: [www.onsemi.com](http://www.onsemi.com)

### TECHNICAL SUPPORT

#### North American Technical Support:

Voice Mail: 1 800-282-9855 Toll Free USA/Canada

Phone: 011 421 33 790 2910

#### Europe, Middle East and Africa Technical Support:

Phone: 00421 33 790 2910

For additional information, please contact your local Sales Representative

