

CUSTOMER PRINT

PART NUMBER: W4292-1XSG-3ES

- NOTES:
1. ALL PARTS TO BE BULK PACKED.
 2. CONTACTS ASSEMBLED INTO CONNECTOR.
 3. BACK WELL FILLED WITH EPOXY.
 4. ALL DIMENSIONS ARE REFERENCE ONLY EXCEPT WHERE NOTED WITH A TOLERANCE. DIMENSIONS IN BRACKETS [] ARE METRIC.
 5. PC TAIL LENGTH OPTIONS:
 - STANDARD (SHORT) TAIL = 0.107in [W4281-1XSG-3ES]
 - INTERMEDIATE = 0.202in [W4291-1XSG-3ES]
 - LONG = 0.267in [W4292-1XSG-3ES]

ASS'Y P/N	CONTACTS	HOLE POS. CLOSED
W4292-10SG-3ES	10 - #20	11, 12
W4292-11SG-3ES	11 - #20	12
W4292-12SG-3ES	12 - #20	NONE
W4292-1XSG-3ES		

NO. OF CONTACTS

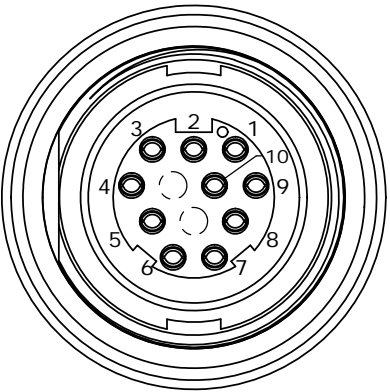

MATING VIEW
W4292-10SG-3ES
10-POS.

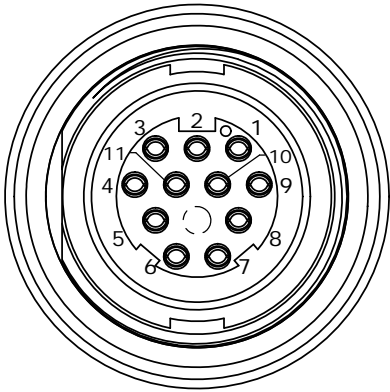

MATING VIEW
W4292-11SG-3ES
11-POS.

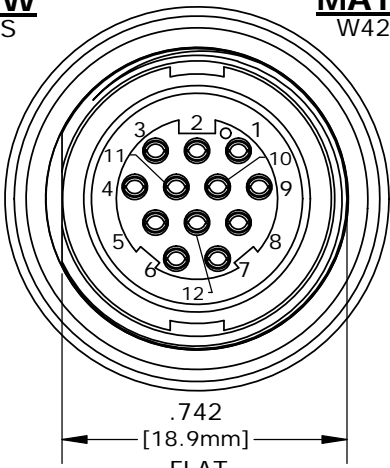

MATING VIEW
W4292-12SG-3ES
12-POS.

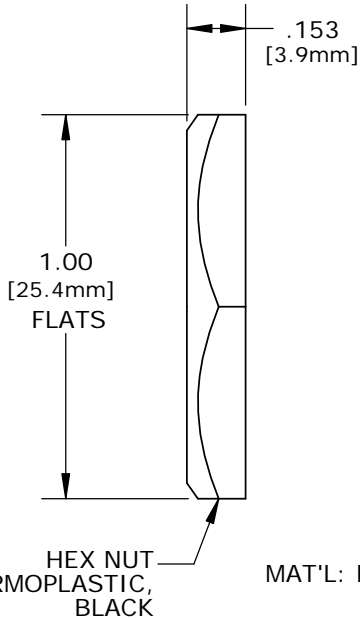

O-RING
MAT'L: RUBBER,
BLACK

13/16-27 UNS-2A
MOD. THREAD

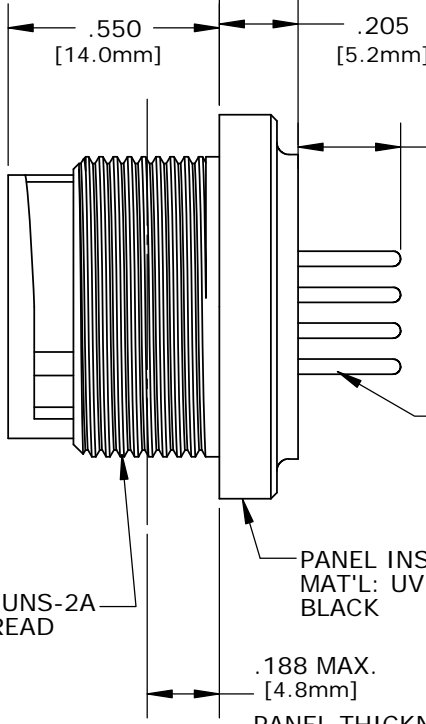

.267 REF.
[6.8mm]
SEE NOTE 5

EPOXY FILLED
SEE NOTE 3

SOCKET CONTACT
PC TAIL, LONG
GOLD PLATED

PANEL INSERT, SOCKET
MAT'L: UV THERMOPLASTIC,
BLACK

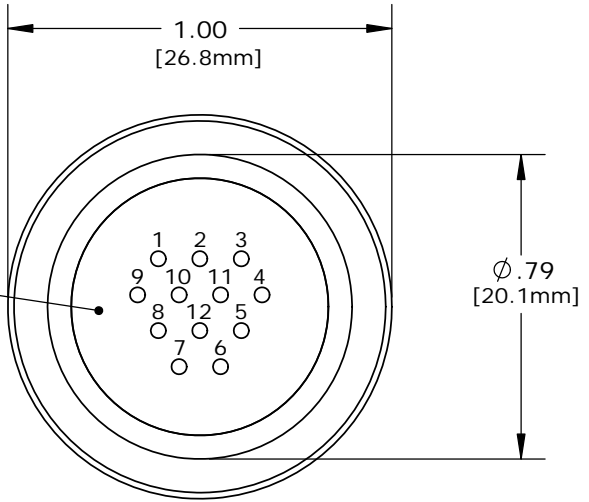

PC TAIL VIEW
W4292-10SG-3ES - 10-POS. (11&12 CLOSED)
W4292-11SG-3ES - 11-POS. (12 CLOSED)
W4292-12SG-3ES - 12-POS. (ALL OPEN)

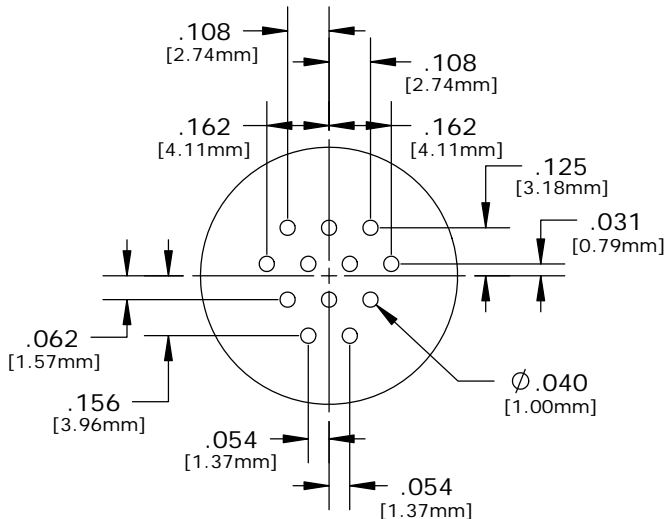
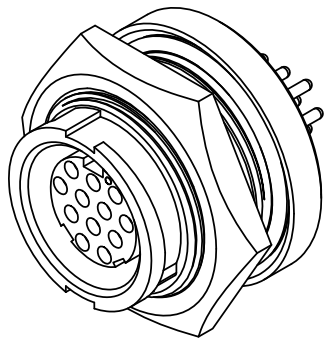

PC TAIL LAYOUT

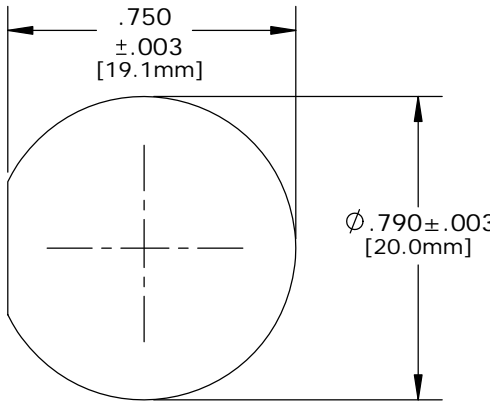

RECOMMENDED
PANEL CUTOUT
STANDARD MULTI-CON-X

CUSTOMER APPROVAL	
THIS DOCUMENT CONTAINS CONFIDENTIAL INFORMATION PROPRIETARY TO CONXALL CORPORATION. ANY REPRODUCTION, DISCLOSURE, OR USE OF THIS DOCUMENT /INFORMATION IS EXPRESSLY PROHIBITED UNLESS AUTHORIZED IN WRITING BY CONXALL CORPORATION.	
APPROVED BY: _____	DATE: _____

A	PAK	09/12/19	DRAWING CREATED AND RELEASED PER DOR 10-2523JS-1		
REV.	INIT.	DATE	DESCRIPTION		
	PAK	10/22/14	ORIG. DRAWN BY: DATE: 10/22/14		
			CHECKED BY:		
ALL INFORMATION ILLUSTRATED IS THE PROPERTY OF "CONXALL CORPORATION". UNAUTHORIZED DUPLICATION OR DISTRIBUTION OF THIS DOCUMENT IS PROHIBITED.			APPROVED BY:	TITLE: PANEL SOCKET, W/ EPOXY, E-KEY	
ALL UNITS ARE IN FEET, INCHES, FRACTION OF INCHES AND DECIMALS.			SCALE: NTS	SIZE: B	SHEET: 1 OF 1
UNLESS OTHERWISE SPECIFIED TOLERANCES: 3 PLACE DECIMALS ±.005 ANGLES ±1° FRACTIONS ±1/16			FILE: W4292-1XSG-3ES	DIRECTORY: SLW	PART NUMBER: W4292-1XSG-3ES
△ = CRITICAL CHARACTERISTIC FLAG PER SPEC. XXXX			CUSTOMER: STANDARD PRODUCT		
					REV A