

# EB2

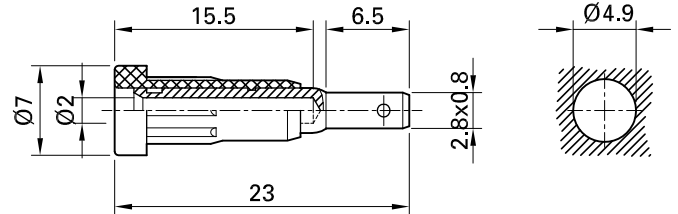

Item number 23.1011-\*

Insulated Ø 2 mm rigid made of machined brass. The socket is pressed into predrilled panels of plastic, metal etc. Flat connecting tab 2.8 mm x 0.8 mm.

Technical data	
Diameter of plug system	2 mm
Rated Values	30 V, 10 A / 60 V, 10 A
Surface treatment electrical contact	Au
Base material electrical contact	CuZn
Standard color(s) *	<span style="background-color: #90EE90; border: 1px solid black; padding: 2px;">20</span> <span style="background-color: #000000; color: white; border: 1px solid black; padding: 2px;">21</span> <span style="background-color: #FF0000; color: white; border: 1px solid black; padding: 2px;">22</span> <span style="background-color: #0000FF; color: white; border: 1px solid black; padding: 2px;">23</span> <span style="background-color: #FFFF00; border: 1px solid black; padding: 2px;">24</span> <span style="background-color: #008000; color: white; border: 1px solid black; padding: 2px;">25</span> <span style="background-color: #800080; color: white; border: 1px solid black; padding: 2px;">26</span> <span style="background-color: #FFA500; border: 1px solid black; padding: 2px;">27</span> <span style="background-color: #A9A9A9; border: 1px solid black; padding: 2px;">28</span> <span style="border: 1px solid black; padding: 2px;">29</span>
Test accessory acc. to	IEC EN 61010-2-030
Component parts	I-EB2; B-EB2
Remarks	Accessories: Press-in tool MB2; Flat connecting receptacle FSH2,8x0,8