

MOUNTING CODE 4
4-40 UNC THREAD
OR
MOUNTING CODE 6
M3 THREAD
X .240[6.10] MIN.
DEEP (4 PLACES)

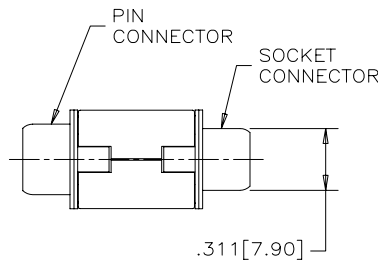
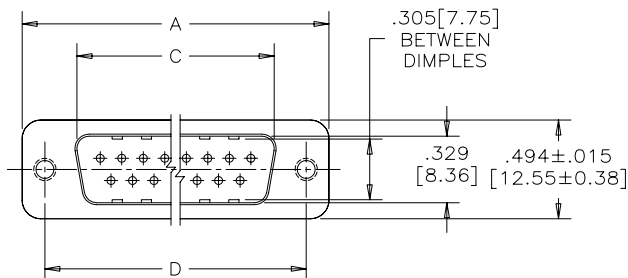
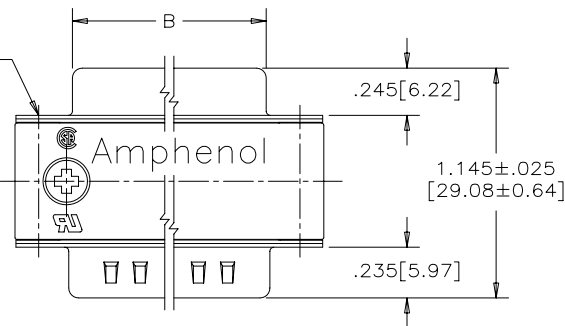

SIZE	A±.015 [0.38]	B±.005 [0.13]	C±.005 [0.13]	D±.005 [0.13]
E09	1.213[30.81]	.643[16.33]	.666[16.92]	.984[24.99]
A15	1.541[39.14]	.971[24.66]	.994[25.25]	1.312[33.32]
B25	2.088[53.04]	1.511[38.38]	1.534[38.96]	1.852[47.04]
C37	2.729[69.32]	2.159[54.84]	2.182[55.42]	2.500[63.50]

NOTES:

- MATERIALS: — SHELLS — TIN PLATED STEEL
— CONTACTS — PHOSPHOR BRONZE
PLATED WITH GOLD OVER NICKEL
ON THE MATING AREA.
— INSULATOR — ENGINEERING THERMOPLASTIC,
FLAMMABILITY RATING UL94V-0, BLACK.
— OUTSIDE SHELLS: ZINC DIECAST, TIN PLATED
- INSULATION RESISTANCE: 3000 MEGOHMS MINIMUM
- CURRENT RATING: 5 AMPS MAXIMUM
2 AMPS FILTERING MAXIMUM
- OPERATING TEMPERATURE: -40°C TO 85°C.
- TOLERANCE, UNLESS INDICATED OTHERWISE, ±.005 [0.13].

THIS DOCUMENT CONTAINS PROPRIETARY INFORMATION AND SUCH INFORMATION
MAY NOT BE DISCLOSED TO OTHERS FOR ANY PURPOSE OR USED FOR MANUFACTURING
PURPOSES WITHOUT WRITTEN PERMISSION FROM AMPHENOL CANADA CORP.

REVISIONS			
REV	ECN, ERN NO.	DATE	APPRD.
D	PRODUCT DRAWING	APR29/05	K.L.

MOUNTING CODE 2
.120[3.05] DIA
THROUGH HOLE
(2 PLACES) AND
MOUNTING POST
(2 SUPPLIED LOOSE
PER CONNECTOR)

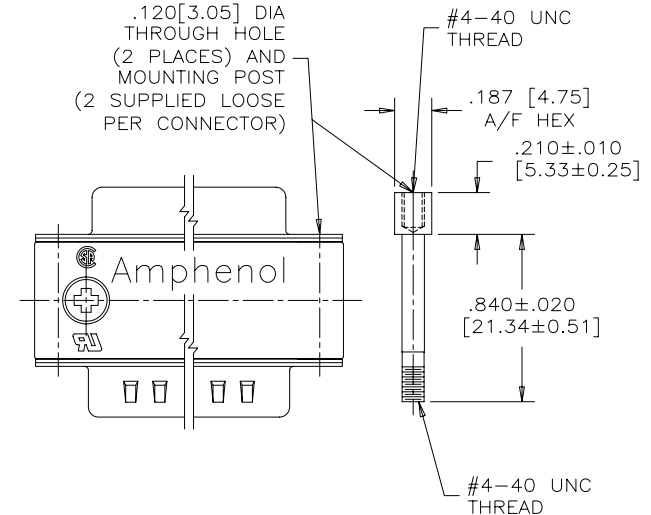

ORDERING CODE: F C C 1 7 - E 0 9 A D - 4 F O G

SERIES

SIZE/NUMBER OF CONTACTS
E09, A15, B25, OR C37

CONNECTOR STYLE
AD=PIN/SOCKET ADAPTER

MOUNTING
2=.120[3.05] DIA. THROUGH HOLE
WITH MOUNTING POST
3=OLD DESIGNATION FOR #4-40
THREAD — USE MOUNTING CODE 4.
4=#4-40 UNC THREAD
6=M3 THREAD

CONTACT FINISH/GOLD THICKNESS
NO DIGIT=STANDARD 15 MICROINCHES
[0.38 MICRONS] GOLD
G=50 MICROINCHES [1.27 MICRONS]
GOLD

MODIFIER
0=STANDARD

FILTER CAPACITANCE
D=50 pF 4=820 pF
B=100 pF 5=1000 pF
0=180 pF 7=1200 pF
F=330 pF E=2200 pF
L=380 pF 9=5600 pF
1=470 pF 8=47000 pF

REFER TO AMPHENOL CATALOGUE
FOR FILTER PERFORMANCE
CHARACTERISTICS

MATERIAL -----	DRAWN I.ESSAJEE	DATE 99/03/10	Amphenol Canada Corp.	
	DESIGNED K.LAMBIE	99/03/09		
	CHECKED			
	I. E. APPRD.			
FINISH -----	Q. A. APPRD.		TITLE FCC17 SERIES MALE/FEMALE ADAPTER	
	DWG. APPRD.			
	ENG. REL. NO.			
	REF. EAR C10727			
	DIMENSIONS ARE IN INCHES [mm]	CODE ID. NO. 03554	DWG C	D
			DRAWING NO. P-FCC17-XXXAD-XX0X	REV. 1
			SCALE 2/1	WT. -----
			SURF. -----	SHEET 1 OF 1