

PAGE 1/4	ISSUE 10-11-16B	SERIES SMP-MAX	PART NUMBER R222M10730
----------	-----------------	----------------	------------------------

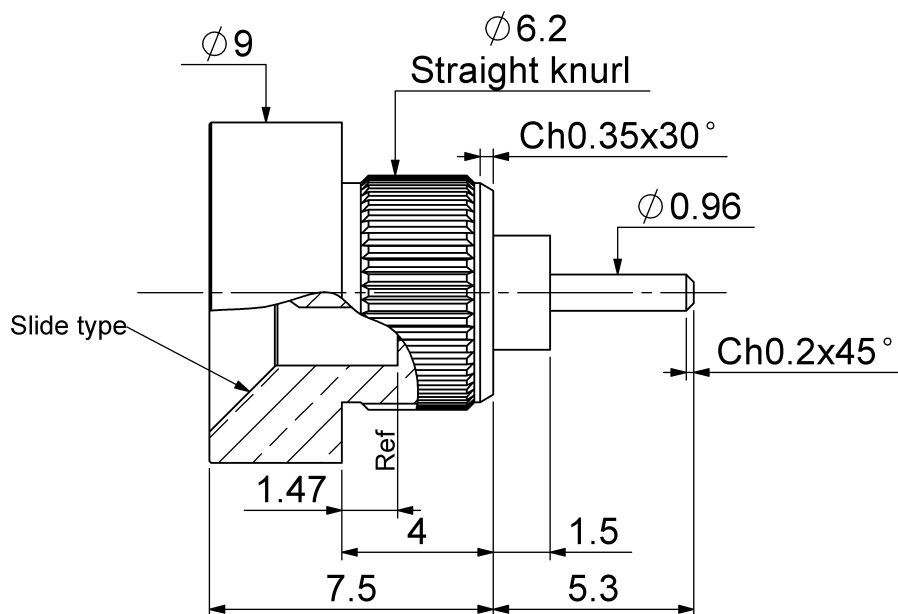

## PANEL CUT OUT

A

	mm	
	Maxi	mini
A	6.13	6.07

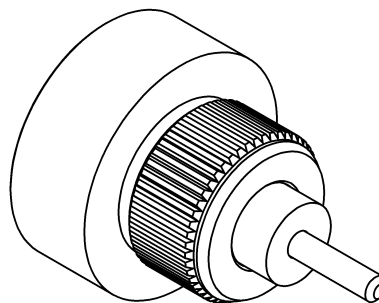
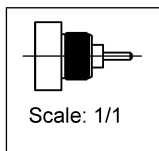

All dimensions are in mm.

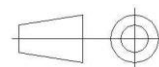

COMPONENTS	MATERIALS	PLATING (μm)
Body	BRASS	NPGR
Center contact	BRASS	NPGR
Outer contact		
Insulator	PTFE	
Gasket		
Others parts		
-	-	-
-	-	-

PAGE 2/4

ISSUE 10-11-16B

SERIES SMP-MAX

PART NUMBER R222M10730

#### PACKAGING

Standard	Unit	Other
100	Contact us	Contact us

#### ELECTRICAL CHARACTERISTICS

Impedance 50  $\Omega$   
 Frequency 0 - 10 GHz  
 VSWR (max.) / Return Loss (max.)

DC - 4 GHz	4 - 6 GHz
1.07 / -30dB	1.12 / -25dB

Insertion loss < 0.03\*  $\sqrt{F(\text{GHz})}$  dB  
 RF leakage - ( NA - F(GHz)) dB Maxi  
 Voltage rating 335 Veff Maxi  
 Dielectric withstanding voltage 500 Veff mini  
 Insulation resistance 5000 M $\Omega$  mini

#### MECHANICAL CHARACTERISTICS

Center contact retention  
 Axial force – Mating End 7 N mini  
 Axial force – Opposite end 15 N mini  
 Torque NA N.cm mini  
 Pull-in-range 0.0000 mm

Recommended torque  
 Mating NA N.cm  
 Panel nut NA N.cm

Mating life 100 Cycles mini  
 Weight 2.1310 g

#### ENVIRONMENTAL

Operating temperature -55/+165 °C  
 Hermetic seal NA Atm.cm3/s  
 Panel leakage NA

#### SPECIFICATION

#### OTHER CHARACTERISTICS

Assembly instruction:

Others:

\*Coaxial Transmission Line Only

PAGE 3/4

ISSUE 10-11-16B

SERIES SMP-MAX

PART NUMBER R222M10730

### GENERAL DATA OF SMP-MAX SERIE

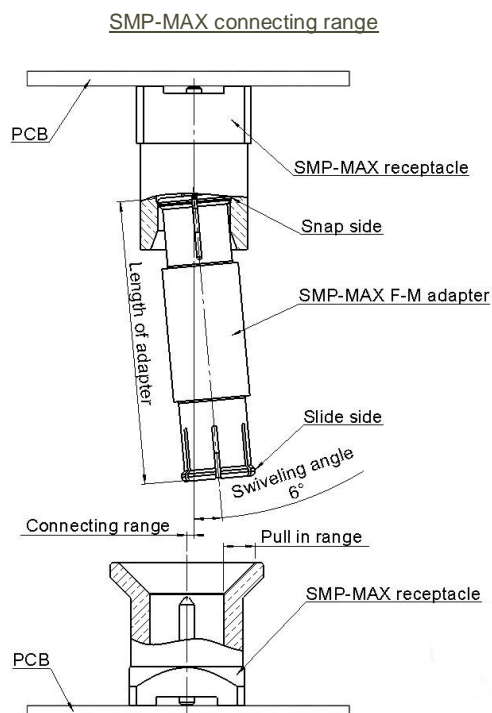

The connecting range represents the maximum misalignment during connection.

The swiveling angle is the maximum possible angle of the adapter in a snap receptacle.

A blind assembly is guaranteed if radial misalignment is smaller than connecting range. Otherwise a manual lead-in is necessary.

### SMP-MAX radial and axial working range

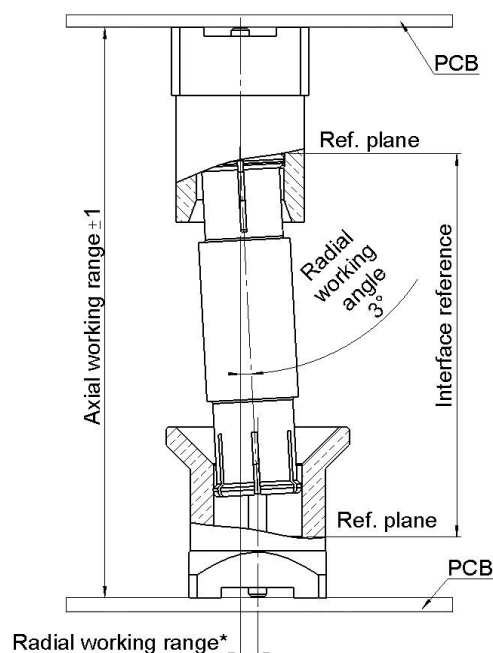

Electrical performance is achieved when radial and axial misalignments are within their working ranges.

Radial working range = (length of the adapter) x Sinus(radial working angle).

### Typical RF performances for a set:

slide receptacle + adapter + snap receptacle (receptacles soldered on boards):

V.S.W.R / Return loss	Misalignment	DC - 3 GHz	3 - 6 GHz
	Radial 0° , Axial 0mm	<1.15/-23.9 dB	<1.25/-19.10 dB
	Radial 0° , Axial +/-1mm	<1.20/-20.8 dB	<1.35/-16.5 dB
	Radial 3° , Axial 0mm	<1.15/-23.1 dB	<1.25/-19.1 dB
	Radial 3° , Axial +/-1mm	<1.20/-20.8 dB	<1.35/-16.5 dB
Insertion loss	Misalignment	DC - 3 GHz	3 - 6 GHz
	Radial 0° , Axial 0mm	<0.10 dB	<0.15 dB
	Radial 0° , Axial +/-1mm	<0.12 dB	<0.25 dB
	Radial 3° , Axial 0mm	<0.10 dB	<0.15 dB
	Radial 3° , Axial +/-1mm	<0.12 dB	<0.25 dB
handling power	>300W @2.7GHz at 25°C; >200W @2.7GHz at 85°C		

PAGE 4/4

ISSUE 10-11-16B

SERIES SMP-MAX

PART NUMBER R222M10730

### SOLDER PROCEDURE

1. Deposit solder paste 'SnAg4Cu0.5' on mounting zone by screen printing application. We recommend a low residue flux. We advise a thickness of 150 micromm ( 5.850 microinch ). Verify that the edges of the zone are clean.
2. Placement of the receptacle on the mounting zone with an automatic machine of 'pick and place' type. A video camera is recommended for positioning of the component. Adhesive agents must not be used on the receptacle.
3. This process of soldering has been tested with convection oven .Below please find, the typical profile to use.
4. The cleaning of printed circuit boards is not obliged.
5. Verification of solder joints and position of the component by visual inspection

### TEMPERATURE PROFILE

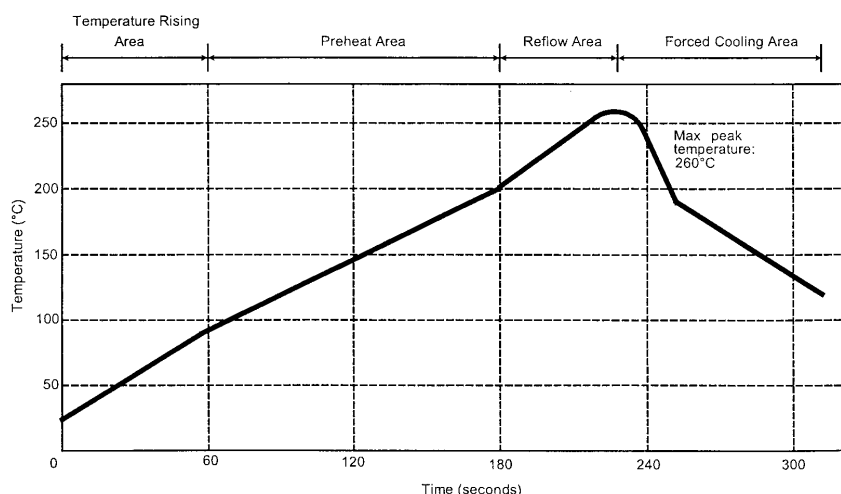

Parameter	Value	Unit
Temperature rising Area	1 - 4	°C/sec
Max Peak Temperature	260	°C
Max dwell time @260°C	10	sec
Min dwell time @235°C	20	sec
Max dwell time @235°C	60	sec
Temperature drop in cooling Area	-1 to - 4	°C/sec
Max dwell time above 100°C	420	sec