

### JUMPERS; LINE-TO-LINE (J & JS) & MULTIPLE POSITION (RJ & RJS)

Material: Brass  
Finish: Nickel Plate

#### J & JS JUMPERS

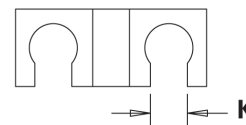
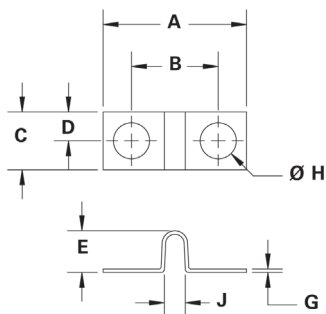

- Available for:
- 3/8" (.375)
  - 7/16" (.44)
  - 9/16" (.567)

CATALOG #	DIMENSIONS								
	A	B	C	D	E	G	H	J	K
J 600	0.62	0.38	0.25	0.12	0.16	0.015	0.16	0.08	N/A
J 601	0.71	0.45	0.31	0.15	0.19	0.015	0.17	0.11	N/A
J 602	0.91	0.56	0.37	0.18	0.27	0.015	0.19	0.16	N/A
J 603	1.13	0.69	0.43	0.21	0.25	0.031	0.20	0.24	N/A
J 604	1.38	0.88	0.50	0.25	0.35	0.035	0.23	0.32	N/A
J 605	1.75	1.13	0.62	0.31	0.39	0.035	0.27	0.54	N/A
J 621 *	0.69	0.44	0.30	0.17	0.38	0.015	0.14	0.11	0.14
JS 600	0.62	0.38	0.25	0.12	0.16	0.015	0.16	0.08	0.16
JS 601	0.71	0.45	0.31	0.15	0.19	0.015	0.17	0.11	0.17
JS 602	0.91	0.56	0.37	0.18	0.27	0.015	0.19	0.16	0.14

NOTE 1: These parts are not necessarily supplied flat. The functioning of the part, however, will not be interfered.  
NOTE 2: All dimensions are applicable after the bus (jumper) is torqued down into the associate terminal board.  
\* The J621 jumper is physically a JS style as illustrated, which is open on one side.

#### RJ TYPE JUMPERS

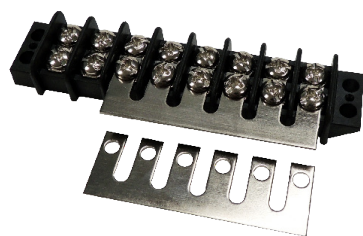

**600 RJ**  
Available only for  
Center to Center of .38" (3/8)

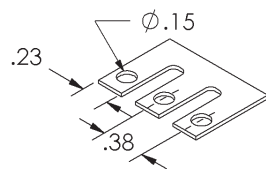

Max # of sections = 24

**601 RJ**  
Available only for  
Center to Center of .44" (7/16)

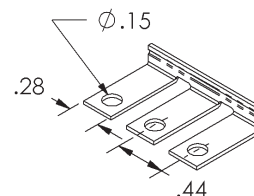

Max # of sections = 24

#### RJS TYPE JUMPERS



**600 RJS**

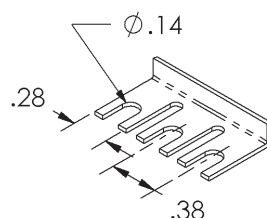

Max # of sections = 24

**601 RJS**

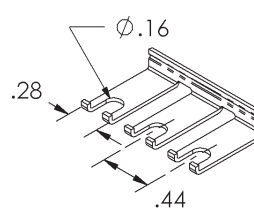

Max # of sections = 24