

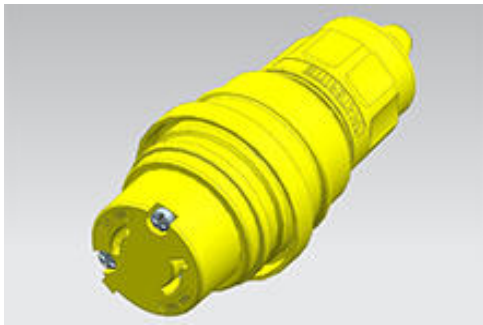

Part Number : [1301460091](#)
Product Description : Watertite Extreme Connector for Male Receptacle with Locking Blade, 2 Pole/2 Wire, NEMA L1-15, 125V, F2, Silicone Husk
Series Number : 130146
Status : Active
Product Category : Wiring Devices
Engineering Number : 25W04MB



Documents & Resources

Drawings

[1301460091_sd.pdf](#)

3D Models and Design Files

[STEP AP242](#)

[SOLIDWORKS](#)

[Creo](#)

Product Environment Compliance

Compliance

China RoHS	Not Reviewed
EU ELV	Not Reviewed
Low-Halogen Status	Not Reviewed
REACH SVHC	Not Reviewed
EU RoHS	Not Reviewed

Compliance Statements

- EU RoHS
- REACH SVHC
- Low-Halogen

Industry Documents

- IPC 1752A Class C
- IPC 1752A Class D
- Molex Product Compliance Declaration
- IEC-62474

- chemSHERPA (xml)

Substances of Interest

- PFAS

EU RoHS Certificate of Compliance

Additional Product Compliance Information

Part Details

General

Status	Active
Category	Wiring Devices
Series	130146
Description	Watertite Extreme Connector for Male Receptacle with Locking Blade, 2 Pole/2 Wire, NEMA L1-15, 125V, F2, Silicone Husk
IP Rating	IP69K
NEMA Configuration	NEMA L1-15
Product Name	Watertite Extreme
Specialty	N/A
Type	Connector
UPC	78678871182

Agency

CSA	LR6837
-----	--------

Electrical

Current - Maximum per Contact	15.0A
GFCI	No
Voltage - Maximum	125V

Physical

Cord Grip Body Size	F2 1/2"
Cord Type	N/A
Flange	No
Flip Lid	No
Gender	Female

Length	N/A
Lighted Connector	No
Locking Blade	Yes
Poles	2-pole/2-wire
Receptacle Type	Single

This document was generated on Sep 25, 2025