

8859000K911-000

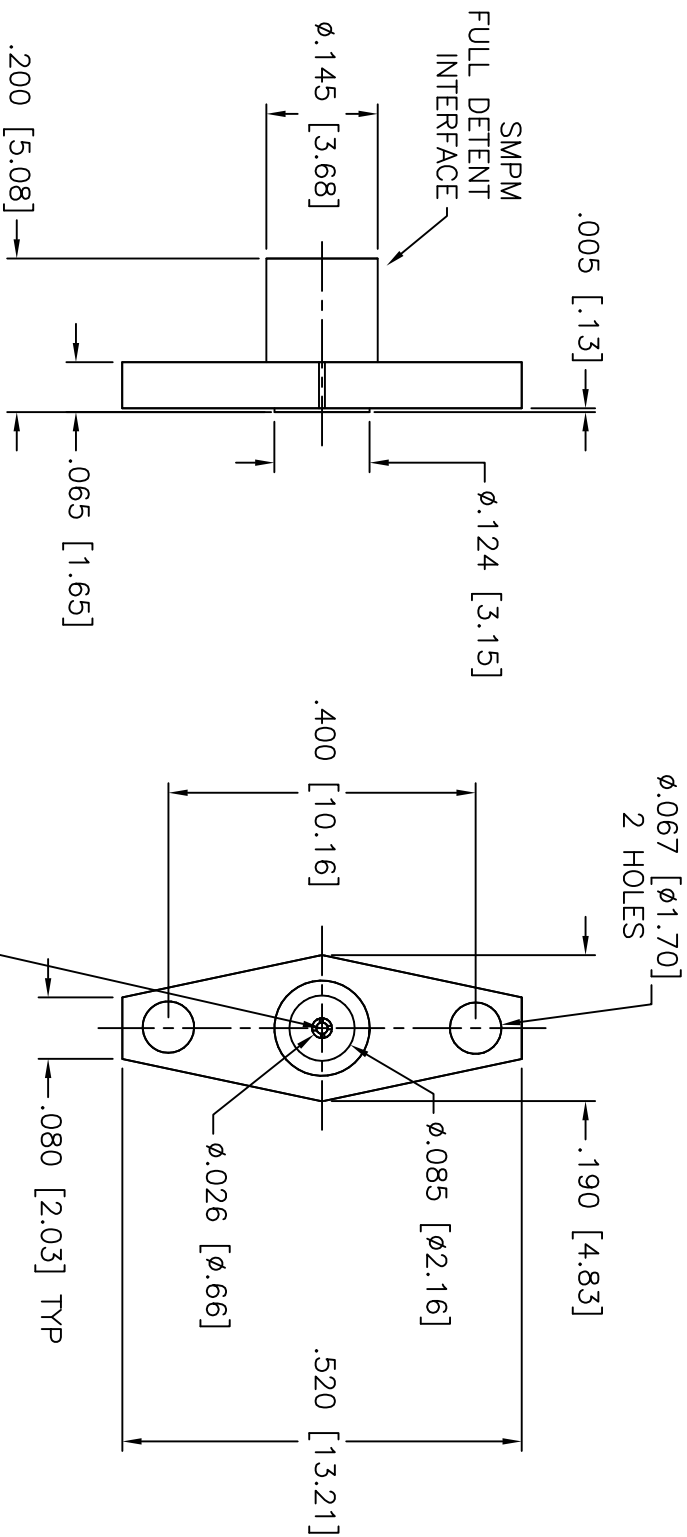

NOTES:

1. ASSEMBLED CONNECTOR INTERFACE IS DESIGNED IN ACCORDANCE WITH MIL-STD-348.
2. MATERIAL: BODY - CORROSION RESISTANT STEEL PER ASTM A582
CONTACT - BERYLLIUM COPPER PER ASTM B196.
INSULATOR - TEFLON PER ASTM D4894
3. FINISHES: BODY - PASSIVATE PER SAE-AMS-2700
CONTACT - GOLD PLATE PER ASTM B488

UNLESS OTHERWISE SPECIFIED: TOLERANCES: 3 PLACES = $\pm .005$, 2 PLACES = $\pm .02$, ANGLES = $\pm 1/2^\circ$, SURFACE FINISH = 63

REV.	DESCRIPTION	DATE
-	OUTLINE	10/23/10
ALT.	REVISIONS	DATE

THESE DRAWINGS AND SPECIFICATIONS ARE THE PROPERTY OF DELTA ELECTRONICS MFG. CORP. AND SHALL NOT BE REPRODUCED, OR COPIED OR USED AS THE BASIS FOR THE MANUFACTURE OR SALE OF APPARATUS OR DEVICES WITHOUT THEIR EXPRESS WRITTEN CONSENT.

DELTA ELECTRONICS MFG. CORP. Beverly, MA 01915

TITLE: SMPM PANEL MOUNT FULL DETENT
ACCEPTS .012 X .050 MAX LONG PIN

Drawn by BUM 10/23/10 Scale 4/1 Ckd. by MR Engr. Appd. MR FILE NAME: 8859000K911-000T

CODE IDENT. -00795

8859000K911-000

