

PRODUCT NUMBER SEE SHEET 2

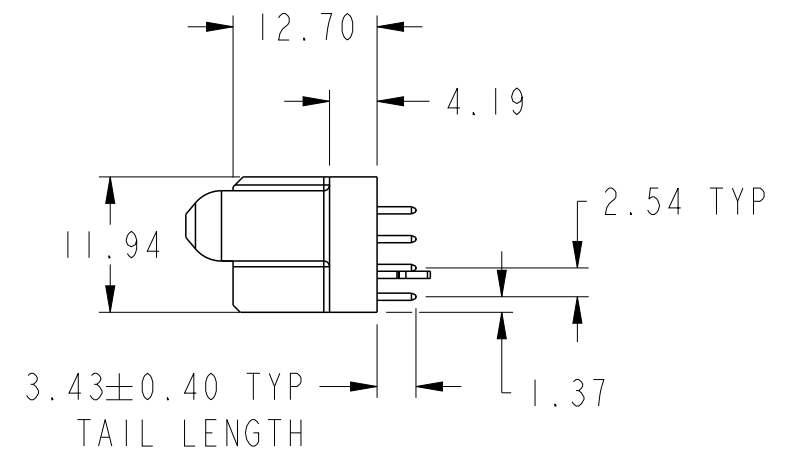
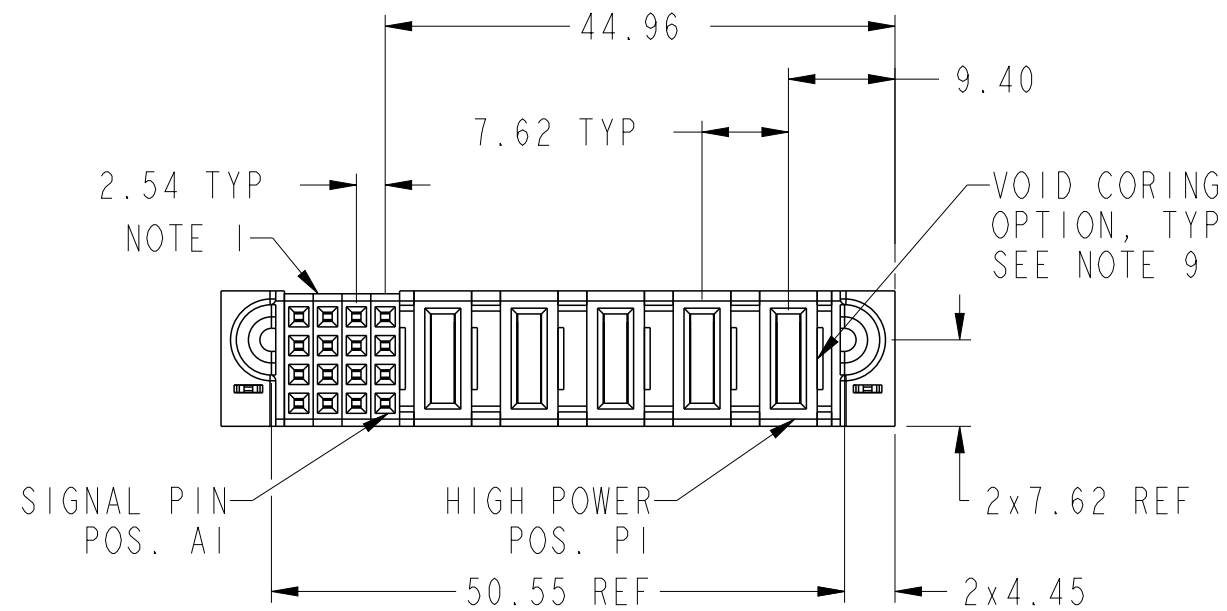
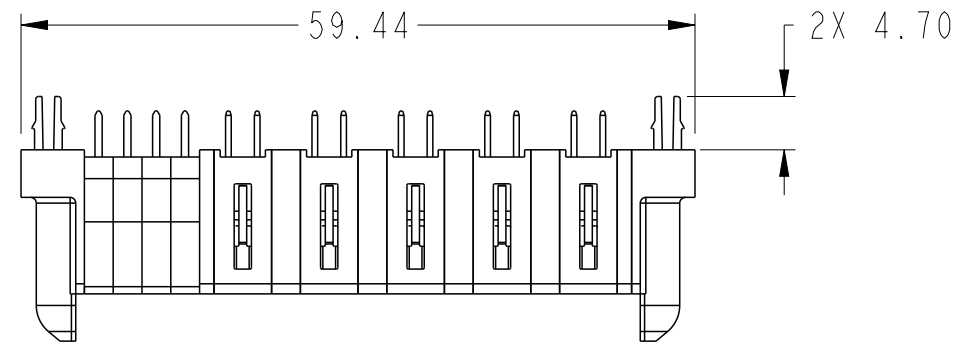
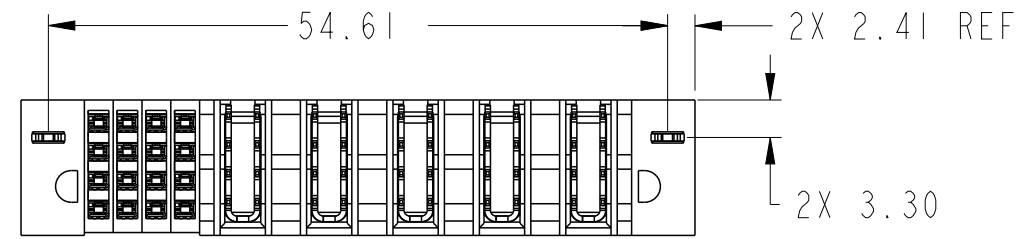

spec ref				dr	Vicking Liu	2016/04/21	<div>projection</div> <div></div>	<div>MM</div> <div></div>	size	A3	scale	3:2
tolerance std ASME Y14.5	TOLERANCES UNLESS OTHERWISE SPECIFIED			eng	Vicking Liu	2016/05/25			ecn no -			
				chr	Fancy Zhang	2016/05/25			rel level Released			
				appr	Pei-Ming Zheng	2016/05/25			product family PowerBlade+			
surface <div>✓</div> ASME Y14.5	linear	0.X	±0.50	Amphenol FCI	title 5ACP + 16S VT STB RECEPTACLE				dwg no 10106122-5004001	rev A		
		0.XX	±0.25									
		0.XXX	±0.10									
	angular	0°	±2°	cat. no.	Product - Customer Drw						sheet 1 of 3	

NOTES:

- 1) "FCI", PART NUMBER AND DATE CODE TO BE MARKED ON THIS SURFACE.
THE MARK CAN BE OMITTED IF THERE IS NOT ENOUGH SPACE ON THIS SURFACE.
- 2) MATERIALS:
-HOUSING - GLASS FILLED WITH HIGH TEMP THERMOPLASTIC, UL94V-0.
-SIGNAL CONTACT - COPPER ALLOY.
-POWER CONTACT - HIGH CONDUCTIVITY COPPER ALLOY.
- 3) PLATING SPECIFICATION REFER TO FCI 10116351
- 4) DENOTES CONNECTOR KEEP OUT ZONE.
- 5) DATUM AND BASIC DIMENIONS WERE ESTABLISHED BY CUSTOMER.
- 6) ALL HOLE DIAMETERS ARE FINISHED HOLE SIZES.
- 7) 1.15 ± 0.025 MM DRILLED HOLE PLATED WITH 0.00762MM MIN Sn
OVER 0.0254-0.0762MM Cu PLATING TO ACHIEVE A 1.02 ± 0.07 MM HOLE.
- 8) PRODUCT SPECIFICATION REFER TO FCI GS-12-658.
APPLICATION SPECIFICATION REFER TO FCI GS-20-141.
PRODUCT PACKAGED IN TRAYS, REFER TO FCI GS-14-1502.
- 9) THE VOID CORING IN BETWEEN POWER MODULES, SIGNAL
MODULES AND END MODULES ARE OPTIONAL AND THE SHAPE
MAY BE DIFFERENT FOR OPTIMIZE THE MOLDING PROCESS. THE
VOID CORING WILL NOT EFFECT TO PRODUCT FUNCTION.

spec ref				dr	Vicking Liu	2016/04/21	projection 	MM 	size	A3	scale	1:1	
tolerance std ASME Y14.5	TOLERANCES UNLESS OTHERWISE SPECIFIED			eng	Vicking Liu	2016/05/25			ecn no -				
				chr	Fancy Zhang	2016/05/25			rel level Released				
				appr	Pei-Ming Zheng	2016/05/25	product family		PowerBlade+				
surface 	linear	0.X	±0.50	Amphenol FCi	title	5ACP + 16S VT STB RECEPTACLE			dwg no	10106122-5004001		rev	A
		0.XX	±0.25										
		0.XXX	±0.10										
ASME Y14.5	angular	0°	±2°		cat. no.	Product - Customer Drw				sheet 3 of 3			