

PRODUCT NUMBER	PITCH
VLxx51x100J0G	5.08 mm

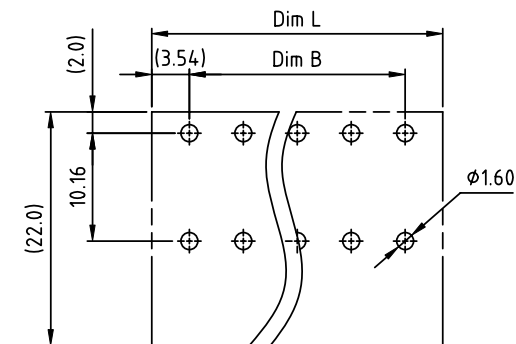
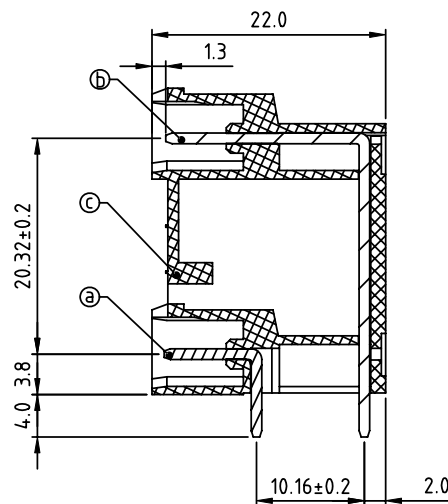
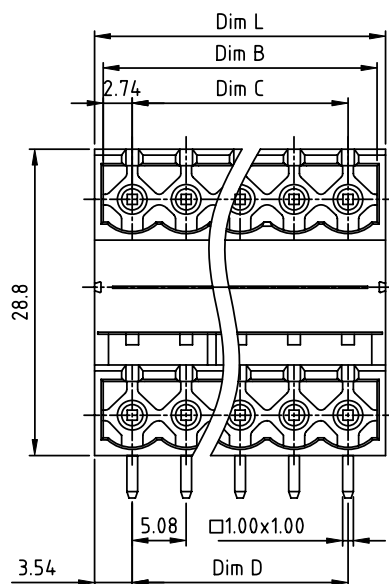
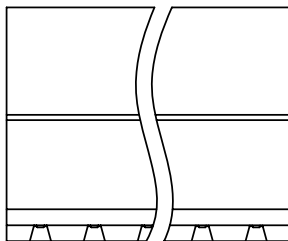

RECOMMENDED P.C.B LAYOUT
TOP VIEW

Material:

- Item ① Short pin: Copper Tin plated
 - Item ② Long pin: Copper Tin plated
 - Item ③ Terminal(housing): Thermoplastic (UL94V-0)
- Electrical: cULus
- Voltage rating: 300V
 - Current rating: 20A
 - Withstanding Voltage: 1.6 KV
 - Operating temperature: -40°C to +115°C
 - Soldering temperature: 260°C±15°C/5 Sec
 - Safety Approval: cULus

N=Number of poles
 $\text{Dim L} = (N/2 - 1) \times 5.08 + 7.08$
 $\text{Dim B} = N/2 \times 5.08 + 0.4$
 $\text{Dim C} = (N/2 - 1) \times 5.08$
 $\text{Dim D} = (N/2 - 1) \times 5.08$

Poles	Tolerance
2x2-2x6p	±0.15
2x7-2x12p	±0.25
2x13-2x18p	±0.35
2x19-2x24p	±0.40

PART NO.: VL xx 5 1 x 1 00J0 G

Solid block	No. of poles	Color	RoHS compliant
0	2	Black (RAL9005)	(lead<4%)
2	3	Red (RAL3001/D)	In copper Alloy
3	4	Orange(RAL2011/P)	
4	5	Yellow(RAL1018/A)	
5	6	Green(RAL6018/T)	
6	8	Blue (RAL5015/A)	
8	9	Grey(RAL7035/D)	
9	9	White(RAL1102)	
C	9	Green(RAL6018/U)	

mat'l. code				surface ASME Y14.5 ✓		tolerance ASME Y14.5		projection 		product family TERMINAL BLOCK													
ltr ecn no dr date				tolerances unless otherwise specified						title TERMINAL BLOCK													
				angles		linear		X.±0.5		MM		PLUGGABLE SOCKET,RIGHT ANGLE											
								X.X±0.3															
				X'±1"				X.XX±0.1		scale		dwg no sheet 1 of 1 size											
				dr		EVIN ZHONG		042814				VLxx51x100J0G A											
				enr		EVIN ZHONG		042814															
				chr		HANKE FENG		042814															
				appd		SHI JUN		042814				type CUSTOMER Drawing											
sheet index		revision sheet		A 1																			