

## 31181 Product Details

**Live Product Chat** US Only  
8:30am - 5pm ET, Mon - Fri

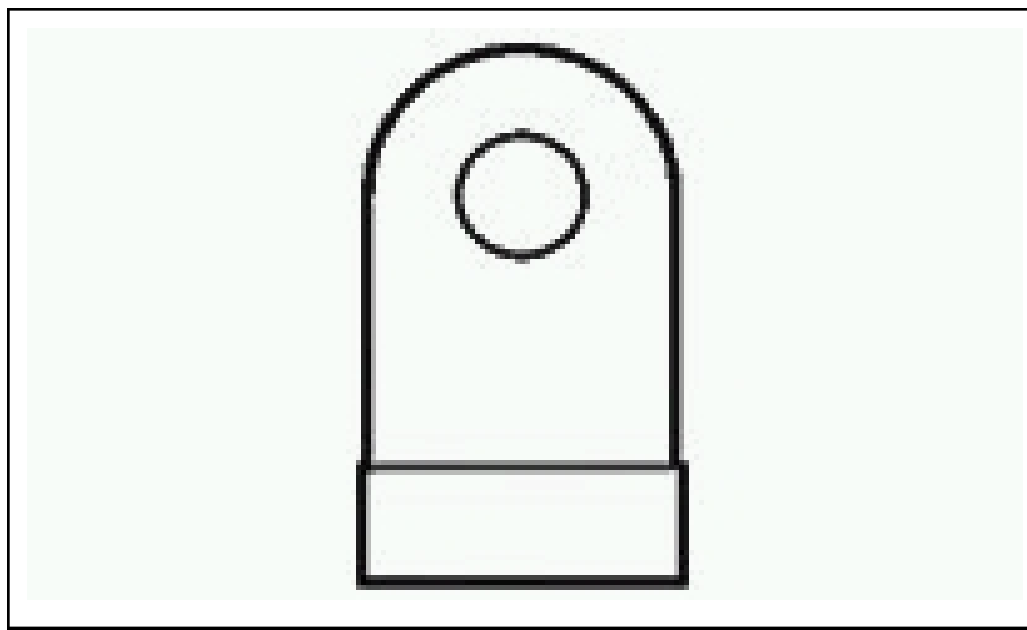

**31181**

[Active](#)

### Ring and Spade Tongue Terminals

[Always EU RoHS/ELV Compliant](#) ( [Statement of Compliance](#) )

#### Product Highlights:

- ? Terminal Shape = Ring Tongue
- ? Receptacle Style = Flag
- ? Body Style = Budget
- ? Barrel Type = Closed Barrel
- ? Wire/Cable Type = Regular Wire

[View all Features](#) | [Find Similar Products](#)

#### Quick Links

- [Check Pricing & Availability](#)
- [Search for Tooling Product Feature Selector](#)
- [Contact Us About This Product](#)

### Documentation & Additional Information

#### Product Drawings:

- ? [TERMINAL, RING TONGUE, FLAG, BUDGET](#) (PDF, English)

#### Catalog Pages/Data Sheets:

- ? None Available

#### Product Specifications:

- ? None Available

#### Application Specifications:

- ? None Available

#### Instruction Sheets:

- ? None Available

#### CAD Files:

- ? None Available

#### Additional Information:

- ? [Product Line Information](#)

#### Related Products:

- ? [Tooling](#)

[List all Documents](#)

### Product Features

(Please use the Product Drawing for all design activity)

#### Product Type Features:

- ? [Terminal Shape](#) = Ring Tongue
- ? [Receptacle Style](#) = Flag
- ? Body Style = Budget
- ? [Barrel Type](#) = Closed Barrel
- ? [Wire/Cable Type](#) = Regular Wire
- ? [Insulation](#) = No
- ? [Insulation Support](#) = Non -Insulation Support
- ? Stud Size = 10
- ? [Stud Diameter \(mm \[in\]\)](#) = 4.82 [0.190]
- ? [Shape](#) = RING -090
- ? [Heavy Duty](#) = No
- ? [Material](#) = Copper
- ? [Finish](#) = Tin

#### Body Related Features:

- ? [Wire Range \(mm \[AWG\]\)](#) = 1.25 -2.00 <sup>2</sup> [16-14]
- ? Wire Range (CMA) = 2,050 - 5,180
- ? Barrel I.D. Min. (mm [in]) = 2.26 [0.089]
- ? Stock Thickness (mm [in]) = 0.79 [0.031]

#### Industry Standards:

- ? Government/Industry Qualification = No
- ? [RoHS/ELV Compliance](#) = RoHS compliant, ELV compliant
- ? [Lead Free Solder Processes](#) = Not relevant for lead free process
- ? RoHS/ELV Compliance History = Always was RoHS compliant

#### Packaging Related Features:

- ? [Packaging Method](#) = Loose Piece

#### Other:

- ? Brand = AMP