

Technical drawing of a rectangular plate with dimensions and force vectors. The plate has a width of 101.24 [3.99] and a height of 56.79 [2.24]. The overall width including mounting flanges is 123.83 [4.88]. Force vectors A and B are applied at the corners. Vector A is applied at the top and bottom corners, pointing left. Vector B is applied at the left and right corners, pointing up. The plate is shown with mounting flanges and bolts.

Technical drawing of the inner box showing width and length dimensions.

Width: 51.94 [2.05] (Inner Box Width)

Length: 77.67 [3.06]

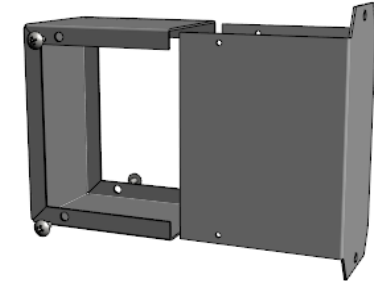

Diagram illustrating the dimensions of a rectangular box:

- Inner Box Height: 75.64 [2.98]
- Inner Box Length: 99.21 [3.91]
- Wall Thickness: 1.02 [0.04]

Technical drawing of a rectangular frame structure. The drawing shows a top view and a side view. The top view is a rectangle with a width of 90.12 mm [3.55] and a height of 66.88 mm [2.63]. The side view shows a vertical member with a height of 76.4 mm [3.01] and a horizontal member with a width of 82.19 mm [3.24]. The vertical member has a diameter of $\varnothing 4.76$ mm [0.19]. The drawing includes dimension lines and arrows indicating the measurements.

NOTE
Purchased assembly includes flanged bottom, cover and 4 cover screws. Bottom and cover are made from 0.04" Aluminum Panels.

PART NUMBERS	
1411FBF Enclosure	
Natural Finish Enclosure	1411FBFU
Black Enclosure	1411FBFBK
ACCESSORIES	
Plated Cover Screws (Pkg 6) [6-32 x 1/4" Self-Tapping Screws]	1421J6
Black Cover Screws (Pkg 6) [6-32 x 1/4" Self-Tapping Screws]	1421J6BK

