

EPIC® H-Q 5

With five working contacts in the proven crimp technology and one PE contact with screw termination.

The compact and powerful standard insert is a favourite thanks to its cost-saving crimping contact.

Info

Compact, powerful standard insert
Space saving, crimping contact
Made in Europe



M

F

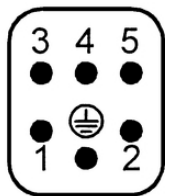
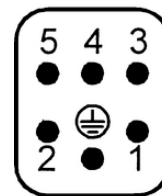

Supplementary automation components from Lapp



Mechanical and plant engineering

Benefits

High performance crimping contacts
PE contact with screw connection

Application range

Machine and equipment manufacturing
Control engineering

Technical Data

Classification ETIM 5:

ETIM 5.0 Class-ID: EC000438

ETIM 5.0 Class-Description: Contact insert for industrial connectors

Classification ETIM 6:

ETIM 6.0 Class-ID: EC000438

ETIM 6.0 Class-Description: Contact insert for industrial connectors

Rated voltage (V):

IEC: 230 V / 400 V

UL: 600 V

Last Update (30.09.2021)

©2021 Lapp Group - Technical changes reserved

Product Management www.lappkabel.de

You can find the current technical data in the corresponding data sheet.

PN 0456 / 02_03.16

EPIC® H-Q 5

	CSA: 600 V
Rated impulse voltage:	4 kV
Rated current (A):	IEC: 16 A UL: 16 A CSA: 16 A
Pollution degree:	3
Flammability:	UL94 V-0
Contact resistance:	< 2 mOhm
Contacts:	Copper alloy, hard silver/gold-plated
Number of contacts:	5 + PE
Termination methods:	Crimp termination: 0.5 - 2.5 mm ²
Material:	PBT Polyester
Cycle of mechanical operation:	100
Temperature range:	-40°C to +100°C, short-term up to +125°C

Note

Photographs and graphics are not to scale and do not represent detailed images of the respective products.
Prices are net prices without VAT and surcharges. Sale to business customers only.

EPIC® H-Q 5

Article number	Article description	Contact type	Number of operating contacts	Pieces / PU
H-Q 5 crimp termination				
10431500	H-Q 5 SC	male	1 - 5	10
10432500	H-Q 5 BC	female	1 - 5	10

Last Update (30.09.2021)

©2021 Lapp Group - Technical changes reserved

Product Management www.lappkabel.de

You can find the current technical data in the corresponding data sheet.

PN 0456 / 02_03.16

EPIC® H-Q 5

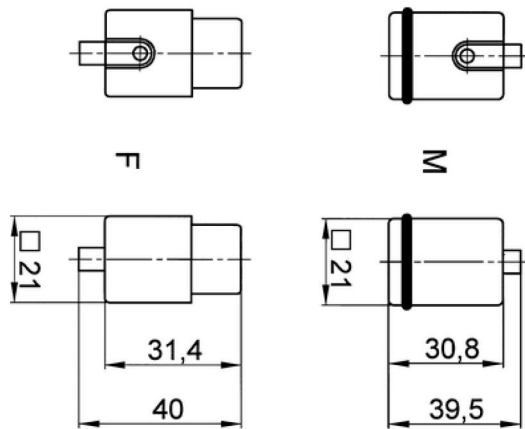

Last Update (30.09.2021)

©2021 Lapp Group - Technical changes reserved

Product Management www.lappkabel.de

You can find the current technical data in the corresponding data sheet.

PN 0456 / 02_03.16