

SPRING-LOADED PINS

DISCRETE SPRING-LOADED CONTACTS • SURFACE MOUNT

0900-0

0900-0-15-20-76-14-11-0
"Legacy P/N 0900-0-00-00-00-00-11-0"
Short stroke, Surface mount

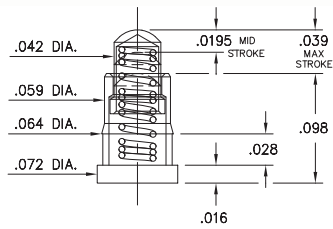

0900-1 ⇨ 4,8

0900-X-15-20-75-14-11-0
"Legacy P/N 0900-X-00-00-00-00-11-0"
Standard stroke, Surface mount

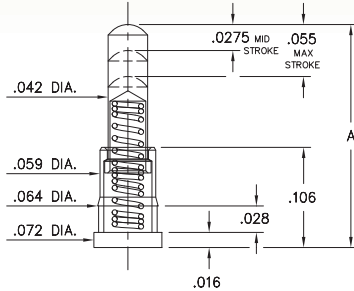

Basic Part Number	Length A
0900-1	.177
0900-2	.197
0900-3	.217
0900-4	.236
* 0900-8	.155

* 0900-8 has a .0195 Mid Stroke & .039 Max. Stroke
Order as:
0900-8-15-20-76-14-11-0

0934

0934-0-15-20-74-14-26-0
Standard stroke, Surface mount

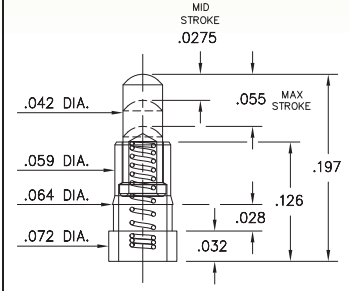

0936

0936-0-15-20-75-14-11-0
Standard stroke, Surface mount

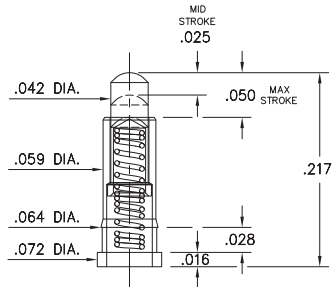

0907-0 ⇨ 9

0907-X-15-20-75-14-11-0
Standard stroke, Surface mount, Mid profile

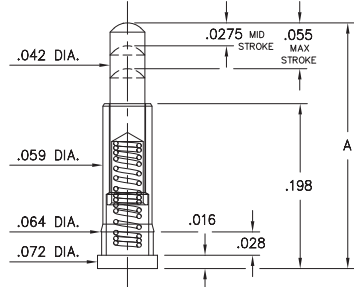

Basic Part Number	Length A
0907-0	.255
0907-1	.275
0907-2	.295
0907-3	.315
0907-4	.335
0907-5	.350
0907-6	.370
0907-7	.390
0907-8	.410
0907-9	.430

0928

0928-0-15-20-77-14-11-0
Long stroke, Surface mount

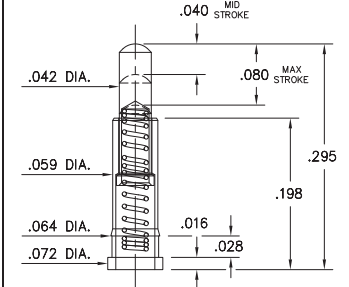

0913

0913-0-15-20-77-14-11-0
Long stroke, Surface mount, Mid profile

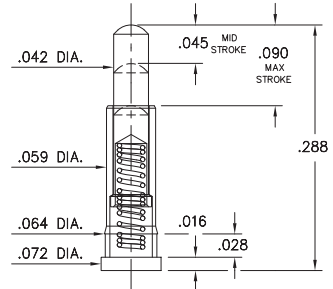

0925

0925-0-15-20-73-14-26-0
Standard stroke, Surface mount
Reduced plunger

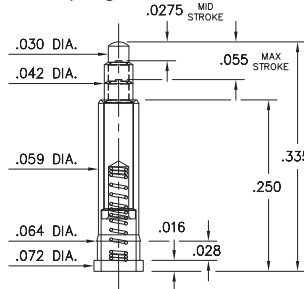

0927

0927-0-15-20-75-14-11-0
Standard stroke, Surface mount, Mid profile

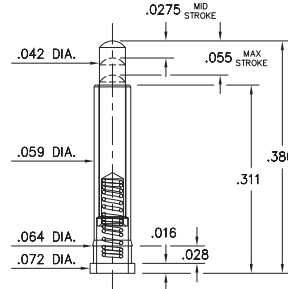

0905

0905-0-15-20-75-14-11-0
"Legacy P/N 0905-0-00-00-00-00-11-0"
Standard stroke, Surface mount, High profile

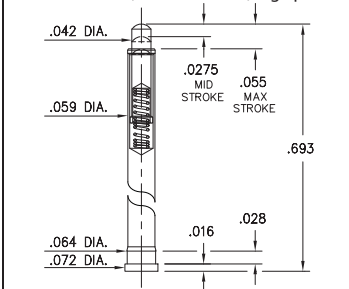

Material Specifications:

Sleeve & Plunger Material: Copper Alloy
Spring Material: Beryllium Copper
Sleeve & Plunger Finish: 20 μ" Gold over Nickel
Spring Finish: 10 μ" Gold over Nickel
Dimensions: Inches
Tolerances On: Lengths: ± .006
Diameters: ± .002
Angles: ± 2°



Mechanical & Electrical Specifications:

Durability: 1,000,000 cycles
Current Rating: 2A continuous, 3A peak
Contact Resistance: 20 mΩ max.
Environmental Specifications:
Operating temperature range: -55/+125° C

73, 74, 75, 76, 77 Springs are not interchangeable

Order Code: 09XX - X - 15 - 20 - **7X** - 14 - XX - 0

Spring Number

Spring Number	Mid. Stroke	Max. Stroke	Force @ Mid. Stroke	Initial Force (Pre-Load)
73	.0275	.055	60 g	25 g
74	.0275	.055	50 g	15 g
75	.0275	.055	60 g	25 g
76	.0195	.039	60 g	25 g
77	.045	.090	60 g	25 g



SPRING-LOADED PINS

DISCRETE SPRING-LOADED CONTACTS

<p>0965 0965-0-15-20-80-14-11-0 Ultra low profile, Surface mount * Stainless steel spring</p>	<p>0921-0 0921-0-15-20-76-14-11-0 Ultra low profile, Short stroke Solder mount in .070 min. mounting hole</p>	<p>0921-1 0921-1-15-20-75-14-11-0 Low profile, Standard stroke Solder mount in .070 min. mounting hole</p>	<p>0926-0 0926-0-15-20-76-14-11-0 Low Profile, Short Stroke Solder mount in .074 min. mounting hole</p>
<p>0926-1 0926-1-15-20-75-14-11-0 Low profile, Standard stroke Solder mount in .074 min. mounting hole</p>	<p>0977 0977-0-15-20-75-14-11-0 Standard stroke, Surface mount Also available on 24mm wide carrier tape: 1,100 parts per 13" reel. Order as: 0977-0-57-20-75-14-11-0</p>	<p>0980 0980-0-15-20-75-14-11-0 Double action, .055 Combined stroke Mount between parallel circuit boards</p>	
<p>0959 0959-0-54-20-75-14-11-0 Receptacle spring pin, Standard stroke Accepts .020" - .032" Dia. pins</p>			

Material Specifications:

Sleeve & Plunger Material: Copper Alloy
Spring Material: BeCu or Stainless Steel 302 *
Sleeve & Plunger Finish: 20 μ" Gold over Nickel
Spring Finish: 10 μ" Gold over Nickel
Dimensions: Inches
Tolerances On: Lengths: ± .006
 Diameters: ± .002
 Angles: ± 2°



Mechanical & Electrical Specifications:

Durability: 1,000,000 cycles
Current Rating: 2A continuous, 3A peak
Contact Resistance: 20 mΩ max.
Environmental Specifications:
Operating temperature range: -55/+125° C
75, 76, 80, 85 Springs are not interchangeable

Order Code: 09XX - X - 15 - 20 - XX - 14 - 11 - 0

Spring Number

Spring Number	Mid. Stroke	Max. Stroke	Force @ Mid. Stroke	Initial Force (Pre-Load)
75	.0275	.055	60 g	25 g
76	.0195	.039	60 g	25 g
80	.012	.024	70 g	25 g
85	.040	.080	60 g	25 g



SPRING-LOADED PINS

DISCRETE SPRING-LOADED CONTACTS • THROUGH-HOLE MOUNT

0906-0

0906-0-15-20-76-14-11-0

Short stroke

Solder mount in .020 min. mounting hole

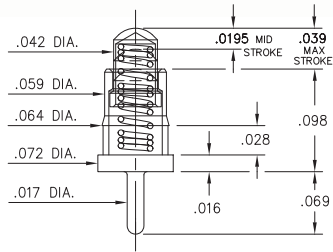

0906-1 ⇨ 4,8

0906-X-15-20-7X-14-11-0

Standard stroke

Solder mount in .020 min. mounting hole

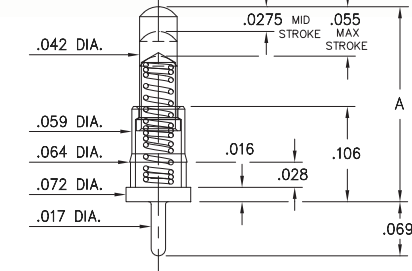

Basic Part Number	Length A
-------------------	----------

0906-1	.177
0906-2	.197
0906-3	.217
0906-4	.236
*0906-8	.155

*0906-8 has a .0195 Mid. Stroke & .039 Max. Stroke

0930

0930-0-15-20-75-14-11-0

Standard stroke

Solder mount in .020 min. mounting hole

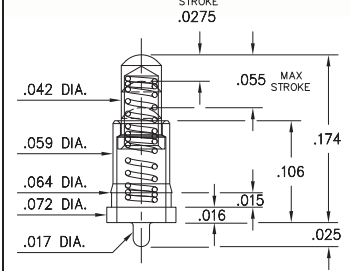

0914

0914-0-15-20-77-14-11-0

Long stroke

Solder mount in .029 min. mounting hole

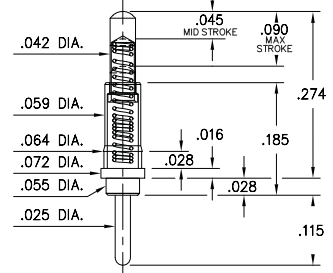

0908-0 ⇨ 9

0908-X-15-20-75-14-11-0

Standard stroke

Solder mount in .020 min. mounting hole

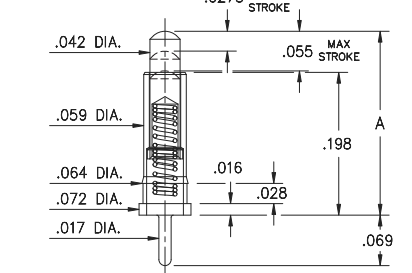

Basic Part Number	Length A
-------------------	----------

0908-0	.255
0908-1	.275
0908-2	.295
0908-3	.315
0908-4	.335
0908-5	.350
0908-6	.370
0908-7	.390
0908-8	.410
0908-9	.430

0932

0932-0-15-20-77-14-11-0

Long stroke

Solder mount in .029 min. mounting hole

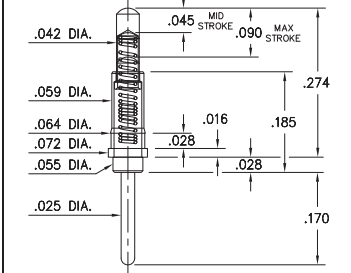

0901

0901-0-15-20-75-14-11-0

"Legacy P/N 0901-0-00-00-00-11-0"

Solder mount in .029 min. mounting hole

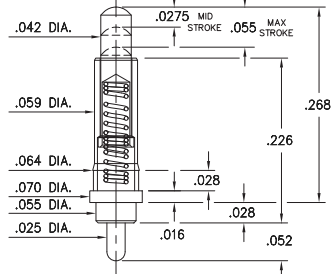

0929

0929-0-15-20-75-14-11-0

Standard stroke

Solder mount in .029 min. mounting hole

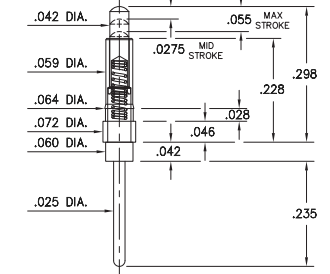

0922

0922-0-15-20-75-14-11-0

Standard stroke

Solder mount in .029 min. mounting hole

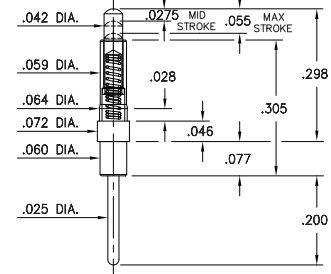

0956

0956-0-15-20-75-14-11-0

Standard stroke

Solder mount in .035 min. mounting hole

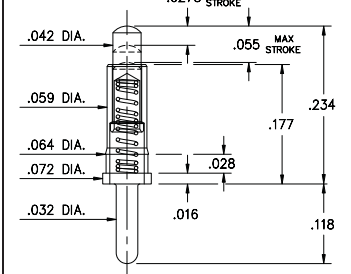

Material Specifications:

Sleeve & Plunger Material: Copper Alloy

Spring Material: Beryllium Copper

Sleeve & Plunger Finish: 20 μ" Gold over Nickel

Spring Finish: 10 μ" Gold over Nickel

Dimensions: Inches

Tolerances On: Lengths: ± .006

Diameters: ± .002

Angles: ± 2°

RoHS-2
2011/65/EU

Mechanical & Electrical Specifications:

Durability: 1,000,000 cycles

Current Rating: 2A continuous, 3A peak

Contact Resistance: 20 mΩ max.

Environmental Specifications:

Operating temperature range: -55/+125°C

75, 76, 77 Springs are not interchangeable

Order Code: 09XX - X - 15 - 20 - 7X - 14 - 11 - 0

Spring Number

Spring Number	Mid. Stroke	Max. Stroke	Force @ Mid. Stroke	Initial Force (Pre-Load)
75	.0275	.055	60 g	25 g
76	.0195	.039	60 g	25 g
77	.045	.090	60 g	25 g



Mill-Max Mfg. Corp. • 190 Pine Hollow Road, P.O. Box 300, Oyster Bay, NY 11771 • 516-922-6000 • Fax: 516-922-9253 • www.mill-max.com

SPRING-LOADED PINS

DISCRETE SPRING-LOADED CONTACTS • SURFACE MOUNT

0910-0

0910-0-57-20-76-14-11-0

Short stroke, Surface mount
Packaged on 16mm wide carrier tape:
2,000 parts per 13" reel.

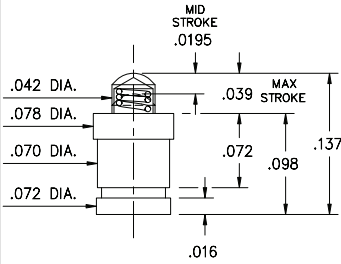

0910-1 ⇨ 4

0910-X-57-20-75-14-11-0

Standard stroke, Surface mount
Packaged on carrier tape.
See chart for tape width and qty. per reel

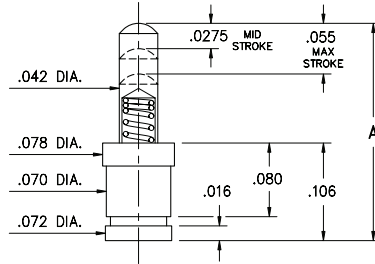

Basic Part Number	Length A
0910-1	.177
0910-2	.197
0910-3	.217
0910-4	.236

Basic Part Number	Tape Width	Quantity per Reel
0910-1	16mm	1,500
0910-2	24mm	1,100
0910-3	24mm	1,100
0910-4	24mm	1,100

0910-8

0910-8-57-20-76-14-11-0

Short stroke, Surface mount
Packaged on 16mm wide carrier tape:
1,800 parts per 13" reel.

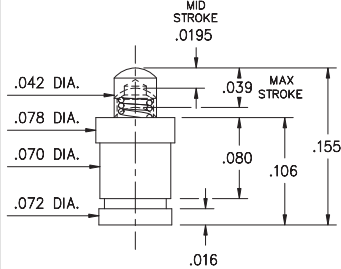

0967

0967-0-15-20-75-14-11-0

Standard stroke, Horizontal surface mount
Also available on 16mm wide carrier tape: 2,200 parts per 13" reel. Order as: 0967-0-58-20-75-14-11-0

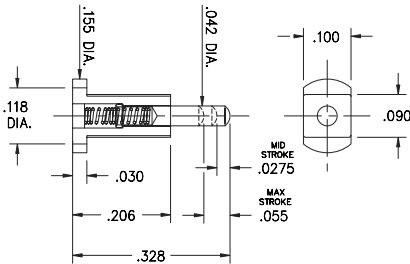

P.C.B. Layout

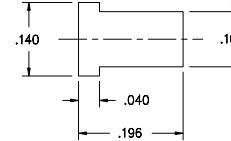

0990-0

0990-0-50-20-76-14-11-0

Short stroke, Surface mount, Large base

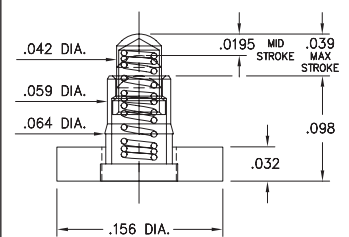

0990-1 ⇨ 4

0990-X-50-20-75-14-11-0

Standard stroke, Surface mount, Large base

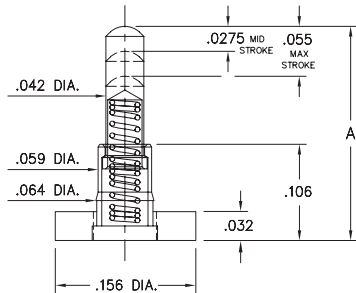

Basic Part Number	Length A
0990-1	.177
0990-2	.197
0990-3	.217
0990-4	.236

0997-0 ⇨ 9

0997-X-50-20-75-14-11-0

Standard stroke, Surface mount, Large base, Mid profile

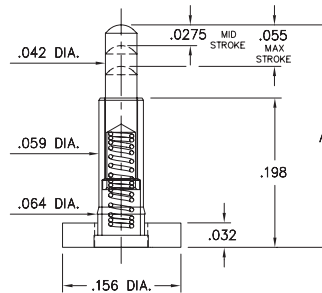

Basic Part Number	Length A
0997-0	.255
0997-1	.275
0997-2	.295
0997-3	.315
0997-4	.335
0997-5	.350
0997-6	.370
0997-7	.390
0997-8	.410
0997-9	.430

Material Specifications:

Sleeve & Plunger Material: Copper Alloy
Spring Material: Beryllium Copper
Sleeve & Plunger Finish: 20 μ" Gold over Nickel
Spring Finish: 10 μ" Gold over Nickel
Dimensions: Inches
Tolerances On: Lengths: ±.006
Diameters: ±.002
Angles: ±2°



Mechanical & Electrical Specifications:

Durability: 1,000,000 cycles
Current Rating: 2A continuous, 3A peak
Contact Resistance: 20 mΩ max.
Environmental Specifications:
Operating temperature range: -55/+125° C

75, 76 Springs are not interchangeable

Order Code: 09XX - X - XX - 20 - **7X** - 14 - 11 - 0

Spring Number

Spring Number	Mid. Stroke	Max. Stroke	Force @ Mid. Stroke	Initial Force (Pre-Load)
75	.0275	.055	60 g	25 g
76	.0195	.039	60 g	25 g



Mill-Max Mfg. Corp. • 190 Pine Hollow Road, P.O. Box 300, Oyster Bay, NY 11771 • 516-922-6000 • Fax: 516-922-9253 • www.mill-max.com

SPRING-LOADED PINS

DISCRETE SPRING-LOADED CONTACTS

0985

0985-0-15-20-71-14-11-0

Standard stroke

Solder mount in .019 min. mounting hole

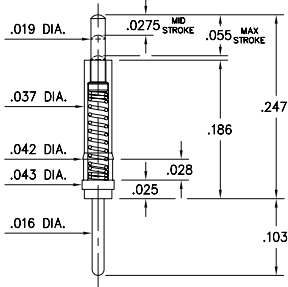

0933

0933-0-15-20-75-14-11-0

Standard stroke, Soldercup

Accepts wire sizes up to .025" Dia.

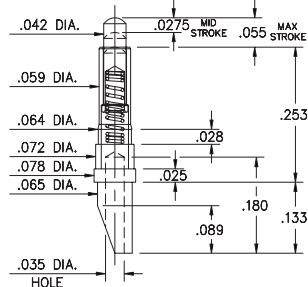

0962

0962-0-15-20-75-14-11-0

Standard stroke, Wire crimp termination

for wire sizes 24 AWG Max. / 28 AWG Min.

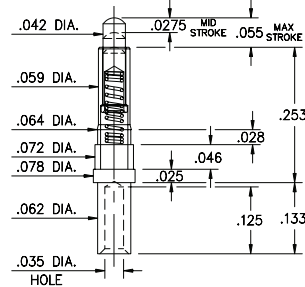

Material Specifications:

Sleeve & Plunger Material: Copper Alloy

Spring Material: Beryllium Copper

Sleeve & Plunger Finish: 20 μ" Gold over Nickel

Spring Finish: 10 μ" Gold over Nickel

Dimensions: Inches

Tolerances On: Lengths: ± .006

Diameters: ± .002

Angles: ± 2°



Mechanical & Electrical Specifications:

Durability: 1,000,000 cycles

Current Rating: 2A continuous, 3A peak

Contact Resistance: 20 mΩ max.

Environmental Specifications:

Operating temperature range: -55/+125° C

71, 75 Springs are not interchangeable

Order Code: 09XX - X - 15 - 20 - **7X** - 14 - 11 - 0

Spring Number

Spring Number	Mid. Stroke	Max. Stroke	Force @ Mid. Stroke	Initial Force (Pre-Load)
71	.0275	.055	50 g	15 g
75	.0275	.055	60 g	25 g



Mill-Max Mfg. Corp. • 190 Pine Hollow Road, P.O. Box 300, Oyster Bay, NY 11771 • 516-922-6000 • Fax: 516-922-9253 • www.mill-max.com

SPRING-LOADED PINS

DISCRETE SPRING-LOADED CONTACTS • POWER SPRING PINS

0850

0850-0-15-20-83-14-11-0

Power spring pin
Solder Mount in .090 min. mounting hole

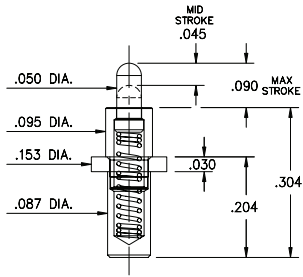

0851

0851-0-15-20-82-14-11-0

Power spring pin
Solder Mount in .090 min. mounting hole

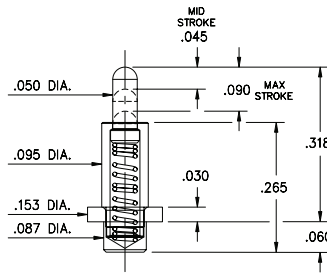

0853

0853-0-15-20-82-14-11-0

Power spring pin
Solder Mount in .090 min. mounting hole

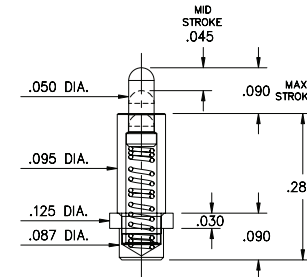

0852

0852-0-15-20-83-14-11-0

Power spring pin
Solder Mount in .043 min. mounting hole

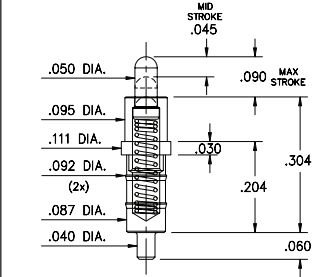

0854

0854-0-15-20-82-14-11-0

Power spring pin, Soldercup
Accepts wire sizes up to .057" Dia.

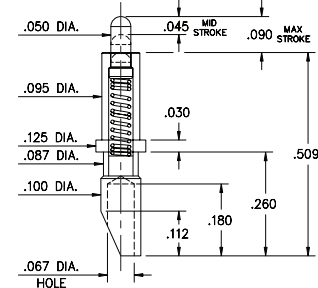

0855

0855-0-15-20-82-14-11-0

Power spring pin, Wire crimp termination
for wire sizes 16 AWG Max. / 20 AWG Min.

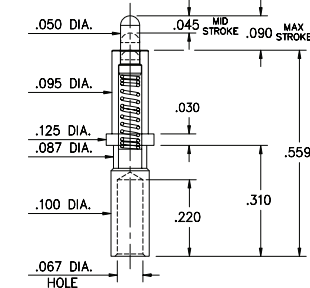

0856

0856-0-15-20-82-14-11-0

Power spring pin
Solder Mount in .043 min. mounting hole

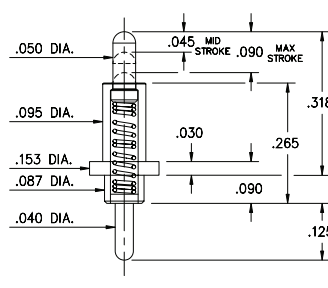

0861

0861-0-15-20-82-14-11-0

Solder Mount in .043 min. mounting hole
*Force @ Mid. Stroke 100g

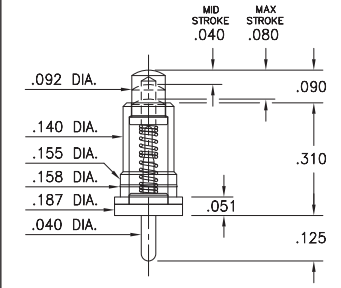

0871

0871-0-15-20-82-14-11-0

Long stroke, Surface Mount
*Force @ Mid. Stroke 100g

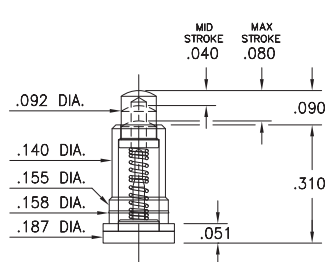

Material Specifications:

Sleeve & Plunger Material: Copper Alloy
Spring Material: Stainless Steel 302
Sleeve & Plunger Finish: 20 μ" Gold over Nickel
Spring Finish: 10 μ" Gold over Nickel
Dimensions: Inches
Tolerances On: Lengths: ±.006
Diameters: ±.002
Angles: ±2°



Mechanical & Electrical Specifications:

Durability: 1,000,000 cycles
Rated Current (Free air):
Continuous 9 amps @ 10° C temperature rise
Contact Resistance: 20 mΩ max.
Environmental Specifications:
Operating temperature range: -55/+125° C

82, 83 Springs are not interchangeable

Order Code: 08XX - X - 15 - 20 - **8X** - 14 - 11 - 0

Spring Number

Spring Number	Mid. Stroke	Max. Stroke	Force @ Mid. Stroke	Initial Force (Pre-Load)
* 82	.045	.090	120 g	25 g
83	.045	.090	120 g	25 g



Mill-Max Mfg. Corp. • 190 Pine Hollow Road, P.O. Box 300, Oyster Bay, NY 11771 • 516-922-6000 • Fax: 516-922-9253 • www.mill-max.com