

# K. S. TERMINALS INC.

## 健和興端子股份有限公司

Contact Us :: User Guide :: Site Map

19106 / 4 / 25 Tues. Visitor: 569931

» 繁體中文 » 简体中文

HOME

Profile

Products

News

Membership

M.O.P.S

Inquiry Basket

Feedback

» [HOME1](#) > [CATALOG](#) / [INSULATED COPPER TERMINALS](#)

### Product Catalog

Power Search

\* [VINYL-  
INSULATED  
\(MOLDED\)  
RING  
TERMINALS](#)

\* [VINYL-  
INSULATED  
\(MOLDED\)  
MULTIPLE-  
STUD RING  
TERMINALS](#)

\* [VINYL-  
INSULATED  
\(MOLDED\)  
FORK  
TERMINALS](#)

\* [VINYL-  
INSULATED  
\(MOLDED\)  
SPADE  
TERMINALS](#)

\* [VINYL-  
INSULATED  
\(MOLDED\)  
LOCKING  
SPADE  
TERMINALS](#)

\* [VINYL-  
INSULATED  
\(MOLDED\)  
FLANGE  
SPADE  
TERMINALS](#)

\* [VINYL-  
INSULATED  
\(MOLDED\)  
HOOK  
TERMINALS](#)

\* [VINYL-  
INSULATED  
\(MOLDED\)  
BLADE  
TERMINALS](#)

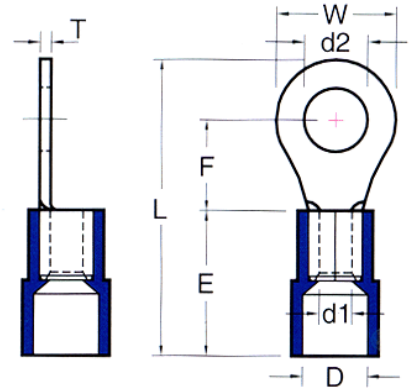
**MAXIMUM ELECTRICAL RATING:** 75°C 600 VOLTS MAX.**INSULATION MATERIAL:** VINYL**INSULATION COLOR:**22-16 A.W.G.: RED  16-14 A.W.G.: BLUE 12-10 A.W.G.: YELLOW **TERMINAL MATERIAL:** COPPER

select \* from Product where ItemNo='I037' and Meb\_Right like '%%' order by GpID,SNo

Product List (Total: 42 records)

BACK

WIRE RANGE A.W. G. mm <sup>2</sup>	ITEM NO.		STUD SIZE		DIMENSION inch(mm)							CRIMPING TOOL	Q'TY BOX
	BRAZED SEAM	BUTTED SEAM	d2		W	F	L	E	D	d1	T		
22-16 A.W. G.  0.5-1.5	RVYB1-3.2	RVY1-3.2	#4	0.126 3.2	0.217 5.50	0.197 5.00	0.728 18.50	0.433 11.00	0.157 4.00	0.067 1.70	0.030 0.75	IZUMI MODEL 34 WITH DIE INDEX COLOR: RED  OR K.S. MODEL KST2000A	1000
	RVYBS1-3.7	RVYS1-3.7	#6	0.146 3.7	0.217 5.50	0.197 5.00	0.728 18.50	0.433 11.00	0.157 4.00	0.067 1.70	0.030 0.75		1000
	RVYBM1-3.7	RVYM1-3.7	#6	0.146 3.7	0.260 6.60	0.248 6.30	0.803 20.40	0.433 11.00	0.157 4.00	0.067 1.70	0.030 0.75		1000
	RVYBL1-3.7	RVYL1-3.7	#6	0.146 3.7	0.315 8.00	0.276 7.00	0.858 21.80	0.433 11.00	0.157 4.00	0.067 1.70	0.030 0.75		1000
	RVYBS1-4	RVYS1-4	#8	0.169 4.3	0.260 6.60	0.248 6.30	0.803 20.40	0.433 11.00	0.157 4.00	0.067 1.70	0.030 0.75		1000
	RVYBL1-4	RVYL1-4	#8	0.169 4.3	0.315 8.00	0.276 7.00	0.858 21.80	0.433 11.00	0.157 4.00	0.067 1.70	0.030 0.75		1000
	RVYB1-5	RVY1-5	#10	0.209 5.3	0.315 8.00	0.276 7.00	0.858 21.80	0.433 11.00	0.157 4.00	0.067 1.70	0.030 0.75		1000
	RVYBL1-5	RVYL1-5	#10	0.209 5.3	0.457 11.60	0.433 11.00	1.094 27.80	0.433 11.00	0.157 4.00	0.067 1.70	0.030 0.75		1000

\* VINYL-  
INSULATED  
(MOLDED)  
LIPPED  
BLADE  
TERMINALS

\* VINYL-  
INSULATED  
(MOLDED)  
PIN  
TERMINALS

mm <sup>2</sup>	RVYB1-6	RVY1-6	1/4	0.252 6.4	0.457 11.60	0.433 11.00	1.094 27.80	0.433 11.00	0.157 4.00	0.067 1.70	0.030 0.75	WITH DIE INDEX COLOR: RED	1000
	RVYB1-8	RVY1-8	5/16	0.331 8.4	0.457 11.60	0.433 11.00	1.094 27.80	0.433 11.00	0.157 4.00	0.067 1.70	0.030 0.75		1000
	RVYB1-10	RVY1-10	3/8	0.413 10.5	0.535 13.60	0.547 13.90	1.240 31.50	0.433 11.00	0.157 4.00	0.067 1.70	0.030 0.75		1000
	RVYB1-12	RVY1-12	1/2	0.512 13	0.772 19.60	0.630 16.00	1.433 36.40	0.433 11.00	0.157 4.00	0.067 1.70	0.030 0.75		1000
	RVYB1-14	RVY1-14	9/16	0.591 15	1.063 27.00	0.827 21.00	1.783 45.30	0.433 11.00	0.157 4.00	0.067 1.70	0.031 0.80		1000
	RVYB1-16	RVY1-16	5/8	0.669 17	1.063 27.00	0.827 21.00	1.783 45.30	0.433 11.00	0.157 4.00	0.067 1.70	0.031 0.80		1000
	RVYB1-20	RVY1-20	3/4	0.827 21	1.063 27.00	0.827 21.00	1.783 45.30	0.433 11.00	0.157 4.00	0.067 1.70	0.031 0.80		1000
16-14 A.W. G.  1.5- 2.5 mm <sup>2</sup>	RVYB2-3.2	RVY2-3.2	#4	0.126 3.2	0.260 6.60	0.189 4.80	0.740 18.80	0.433 11.00	0.177 4.50	0.091 2.30	0.031 0.80	IZUMI MODEL 34 WITH DIE INDEX COLOR: BLUE  OR K.S. MODEL KST2000A WITH DIE INDEX COLOR: BLUE	1000
	RVYBS2-3.7	RVYS2-3.7	#6	0.146 3.7	0.260 6.60	0.189 4.80	0.740 18.80	0.433 11.00	0.177 4.50	0.091 2.30	0.031 0.80		1000
	RVYBM2-3.7	RVYM2-3.7	#6	0.146 3.7	0.260 6.60	0.248 6.30	0.803 20.40	0.433 11.00	0.177 4.50	0.091 2.30	0.031 0.80		1000
	RVYBL2-3.7	RVYL2-3.7	#6	0.146 3.7	0.335 8.50	0.291 7.40	0.898 22.80	0.433 11.00	0.177 4.50	0.091 2.30	0.031 0.80		1000
	RVYBS2-4	RVYS2-4	#8	0.169 4.3	0.260 6.60	0.248 6.30	0.803 20.40	0.433 11.00	0.177 4.50	0.091 2.30	0.031 0.80		1000
	RVYBL2-4	RVYL2-4	#8	0.169 4.3	0.335 8.50	0.291 7.40	0.898 22.80	0.433 11.00	0.177 4.50	0.091 2.30	0.031 0.80		1000
	RVYBS2-5	RVYS2-5	#10	0.209 5.3	0.335 8.50	0.291 7.40	0.898 22.80	0.433 11.00	0.177 4.50	0.091 2.30	0.031 0.80		1000
	RVYBL2-5	RVYL2-5	#10	0.209 5.3	0.374 9.50	0.287 7.30	0.898 22.80	0.433 11.00	0.177 4.50	0.091 2.30	0.031 0.80		1000
	RVYB2-6	RVY2-6	1/4	0.252 6.4	0.472 12.00	0.433 11.00	1.094 27.80	0.433 11.00	0.177 4.50	0.091 2.30	0.031 0.80		1000
	RVYB2-8	RVY2-8	5/16	0.331 8.4	0.472 12.00	0.433 11.00	1.094 27.80	0.433 11.00	0.177 4.50	0.091 2.30	0.031 0.80		1000
	RVYB2-10	RVY2-10	3/8	0.413 10.5	0.535 13.60	0.547 13.90	1.240 31.50	0.433 11.00	0.177 4.50	0.091 2.30	0.031 0.80		1000
	RVYB2-12	RVY2-12	1/2	0.512 13	0.756 19.20	0.630 16.00	1.433 36.40	0.433 11.00	0.177 4.50	0.091 2.30	0.031 0.80		1000
	RVYB2-14	RVY2-14	9/16	0.591 15	1.063 27.00	0.827 21.00	1.783 45.30	0.433 11.00	0.177 4.50	0.091 2.30	0.031 0.80		1000
	RVYB2-16	RVY2-16	5/8	0.669 17	1.063 27.00	0.827 21.00	1.783 45.30	0.433 11.00	0.177 4.50	0.091 2.30	0.031 0.80		1000
	RVYB2-20	RVY2-20	3/4	0.827 21	1.063 27.00	0.827 21.00	1.783 45.30	0.433 11.00	0.177 4.50	0.091 2.30	0.031 0.80		1000
	RVYB5-3.7	RVY5-3.7	#6	0.146 3.7	0.283 7.20	0.240 6.10	0.894 22.70	0.512 13.00	0.252 6.40	0.134 3.40	0.039 1.00		500

12-10 A.W. G. 4-6 mm <sup>2</sup>	RVYBS5-4	RVYS5-4	#8	0.169 4.3	0.283 7.20	0.240 6.10	0.894 22.70	0.512 13.00	0.252 6.40	0.134 3.40	0.039 1.00	IZUMI MODEL 5 WITH DIE INDEX COLOR: YELLOW  OR K.S. MODEL KST2000A WITH DIE INDEX COLOR: YELLOW	500
	RVYBL5-4	RVYL5-4	#8	0.169 4.3	0.374 9.50	0.327 8.30	1.024 26.00	0.512 13.00	0.252 6.40	0.134 3.40	0.039 1.00		500
	RVYB5-5	RVY5-5	#10	0.209 5.3	0.374 9.50	0.327 8.30	1.024 26.00	0.512 13.00	0.252 6.40	0.134 3.40	0.039 1.00		500
	RVYB5-6	RVY5-6	1/4	0.252 6.4	0.472 12.00	0.413 10.50	1.161 29.50	0.512 13.00	0.252 6.40	0.134 3.40	0.039 1.00		500
	RVYBM5-6	RVYM5-6	1/4	0.252 6.4	0.472 12.00	0.512 13.00	1.260 32.00	0.512 13.00	0.252 6.40	0.134 3.40	0.039 1.00		500
	RVYB5-8	RVY5-8	5/16	0.331 8.4	0.591 15.00	0.531 13.50	1.339 34.00	0.512 13.00	0.252 6.40	0.134 3.40	0.039 1.00		500
	RVYB5-10	RVY5-10	3/8	0.413 10.5	0.591 15.00	0.531 13.50	1.339 34.00	0.512 13.00	0.252 6.40	0.134 3.40	0.039 1.00		500
	RVYB5-12	RVY5-12	1/2	0.512 13	0.756 19.20	0.630 16.00	1.520 38.60	0.512 13.00	0.252 6.40	0.134 3.40	0.039 1.00		500
	RVYB5-14	RVY5-14	9/16	0.591 15	1.260 32.00	0.992 25.20	2.134 54.20	0.512 13.00	0.252 6.40	0.134 3.40	0.039 1.00		500
	RVYB5-16	RVY5-16	5/8	0.669 17	1.260 32.00	0.992 25.20	2.134 54.20	0.512 13.00	0.252 6.40	0.134 3.40	0.039 1.00		500
	RVYB5-20	RVY5-20	3/4	0.827 21	1.260 32.00	0.992 25.20	2.134 54.20	0.512 13.00	0.252 6.40	0.134 3.40	0.039 1.00		500

[BACK](#)
[HOME](#) :: [Profile](#) :: [Products](#) :: [News](#) :: [Membership](#) :: [M.O.P.S](#) :: [Inquiry Basket](#) :: [Feedback](#)
[sitemap](#)

•ADDRESS: 8, E. 3rd ROAD, CHANG PIN IND. PARK, HSIEN SHI, CHANG HWA, TAIWAN, R.O.C.  
 •TEL: 886-4-7586111      •FAX: 886-4-7586113  
 •E-MAIL: [exp@ksterminals.com.tw](mailto:exp@ksterminals.com.tw)      •WebMaster: [web@ksterminals.com.tw](mailto:web@ksterminals.com.tw)