

REVISIONS					
P	LTR	DESCRIPTION	DATE	DWN	APVD
A1		REVISED PER ECR-23-193507	04AUG2023	SSM	WH

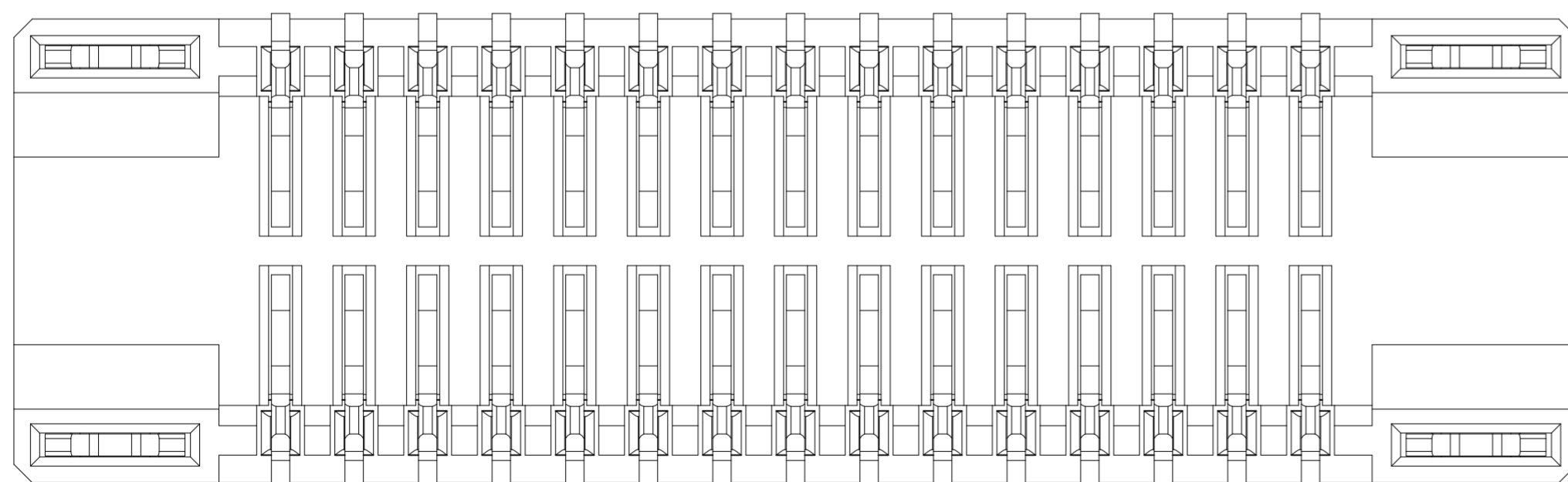
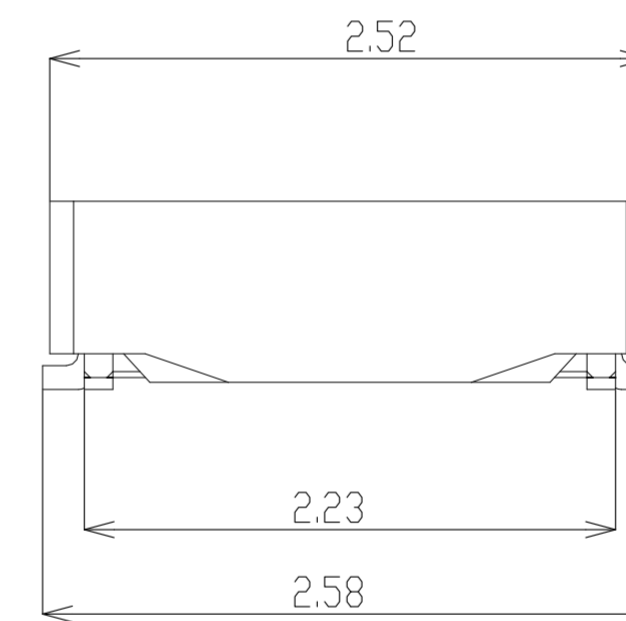
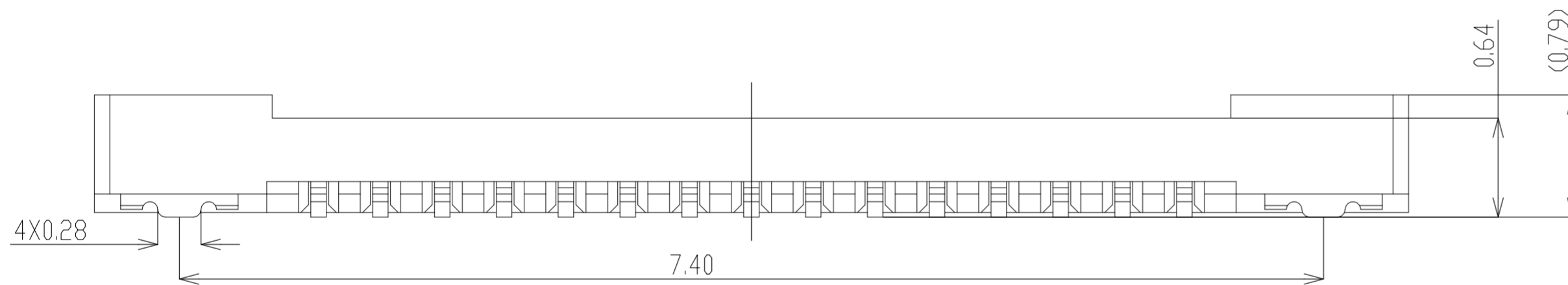
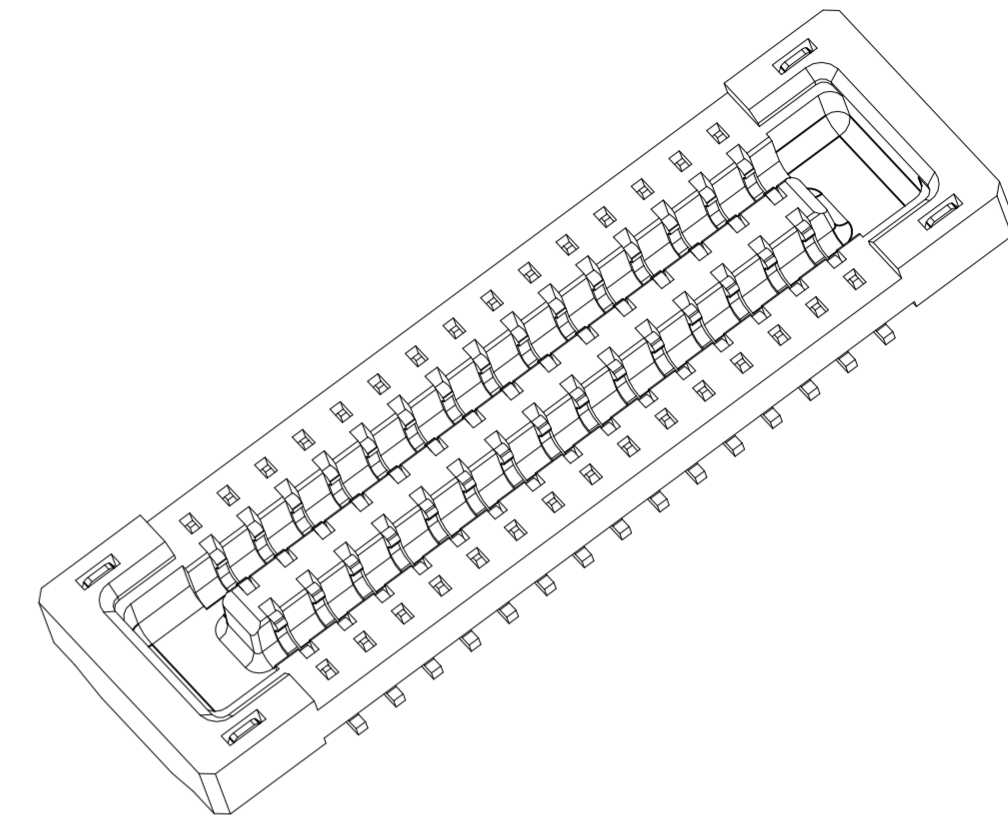
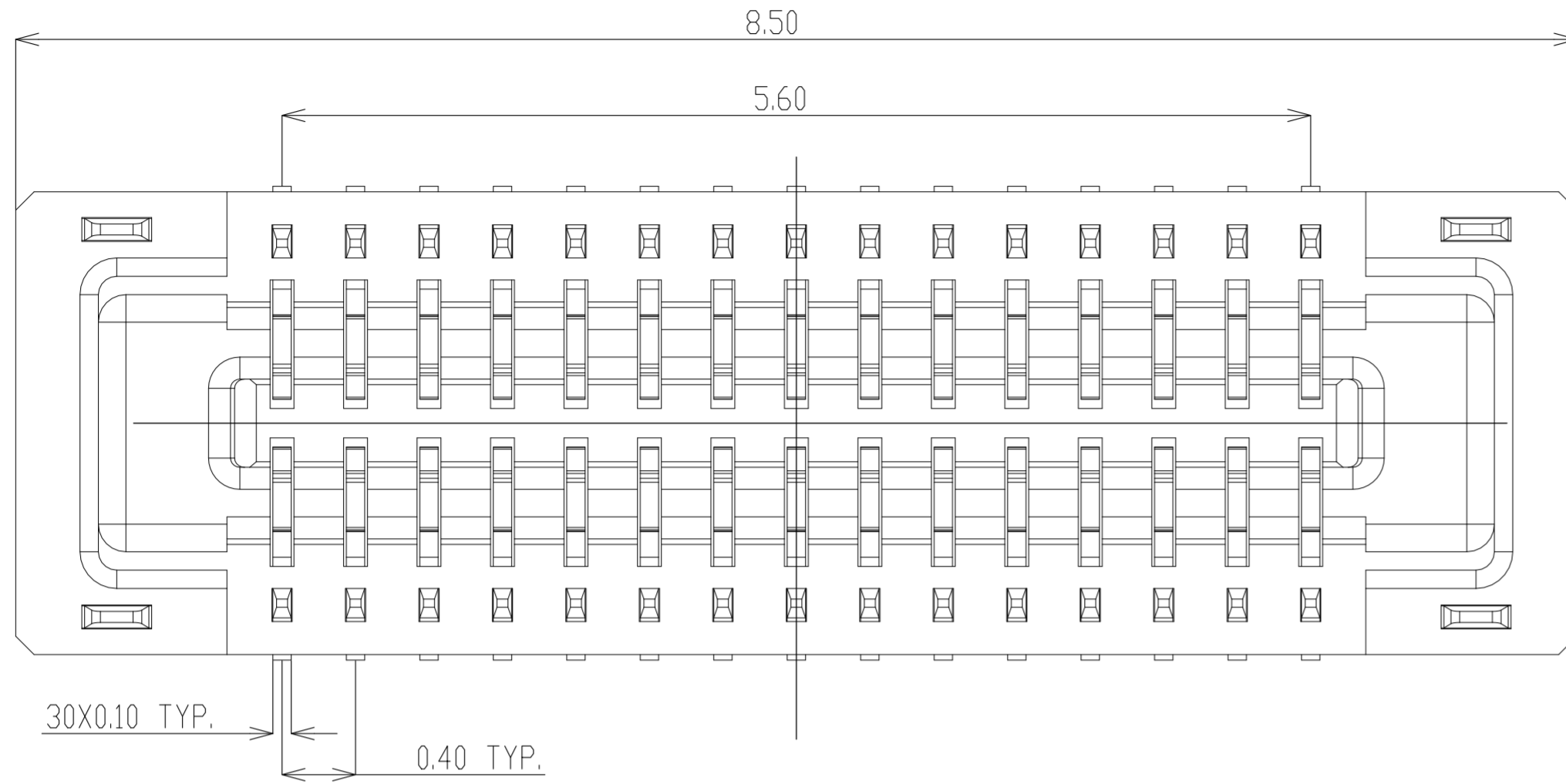

3-2363961-0
PART NUMBER

THIS DRAWING IS A CONTROLLED DOCUMENT.		DWN H.X	26SEP2019	TE TE Connectivity Ltd.	
		CHK W.H	26SEP2019		
DIMENSIONS: mm		TOLERANCES UNLESS OTHERWISE SPECIFIED:		NAME	
		0 PLC	± -	PRODUCT SPEC	
		1 PLC	± 0.3	SEE NOTE 5	
		2 PLC	± 0.20	APPLICATION SPEC	
		3 PLC	± 0.15	114-115040	
		4 PLC	± -	SIZE	CAGE CODE
		ANGLES	± -	A2	00779
MATERIAL		FINISH		DRAWING NO	RESTRICTED TO
1		2		C=2363961	-
CUSTOMER DRAWING				SCALE	SHEET
				12:1	1 of 9
				REV	A1

P	LTR	DESCRIPTION	DATE	DWN	APVD
-	-	SEE SHEET 1	-	-	-

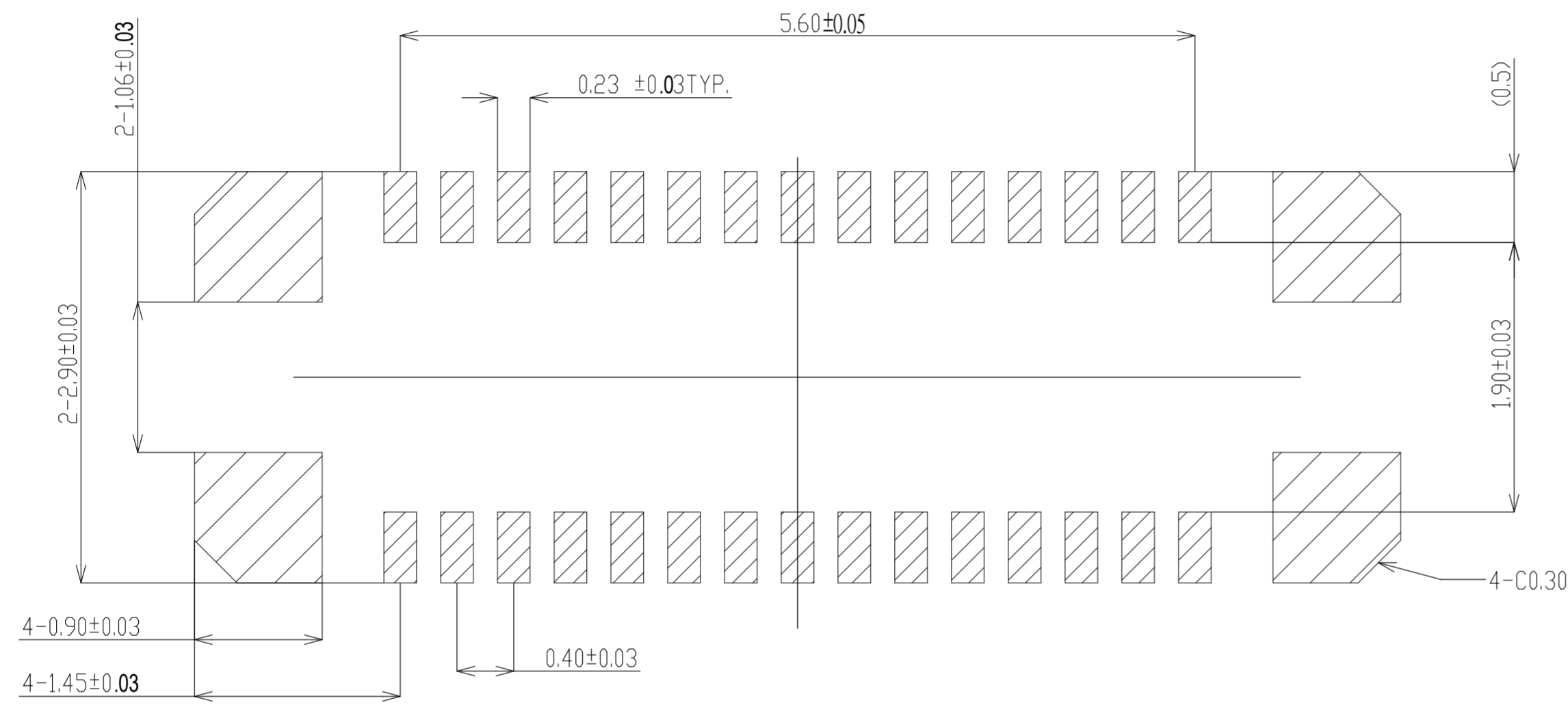

RECOMMENDED P.C.BOARD PATTERN DIMENSION (WITH HOLD DOWN)

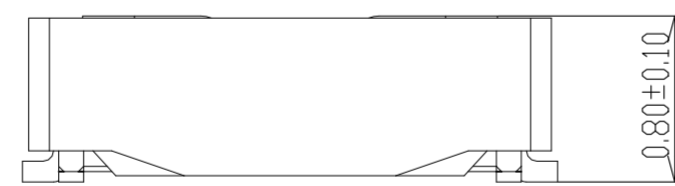

MATING HIGHT

NOTES:

1.MATERIAL:

- 1.1 HOUSING: LCP, UL 94 V-0, COLOR: BLACK.
- 1.2 CONTACT: COPPER ALLOY.
- 1.3 HOLD DOWN: COPPER ALLOY.

2. FINISH:

- 2.1 CONTACT:
GOLD FLASH ON CONTACT AND SOLDERING AREA.
NICKEL UNDER PLATING OVERALL.
- 2.2 HOLD DOWN:
TIN PLATING OVER NICKEL UNDER PLATING.

3. REFLOW SOLDER CAPABLE TO 260 °C.

4. MATING PLUG PART NUMBER: 3-2363962-0.

5. PRODUCT SPECIFICATION 108-115166

THIS DRAWING IS A CONTROLLED DOCUMENT.		DWN H.X	26SEP2019	TE Connectivity Ltd.	
		CHK W.H	26SEP2019		
		APVD -	-	NAME	
DIMENSIONS: mm		TOLERANCES UNLESS OTHERWISE SPECIFIED		PRODUCT SPEC	
		0 PLC	±	SEE NOTE 5	
		1 PLC	± 0.3	APPLICATION SPEC	
		2 PLC	± 0.20	114-115040	
		3 PLC	± -	SIZE CAGE CODE DRAWING NO	
MATERIAL		FINISH	-	WEIGHT	-
				SCALE	12:1
				SHEET	2 of 9
				REV	A1

REVISIONS					
P	LTR	DESCRIPTION	DATE	DWN	APVD
-	-	SEE SHEET 1	-	-	-

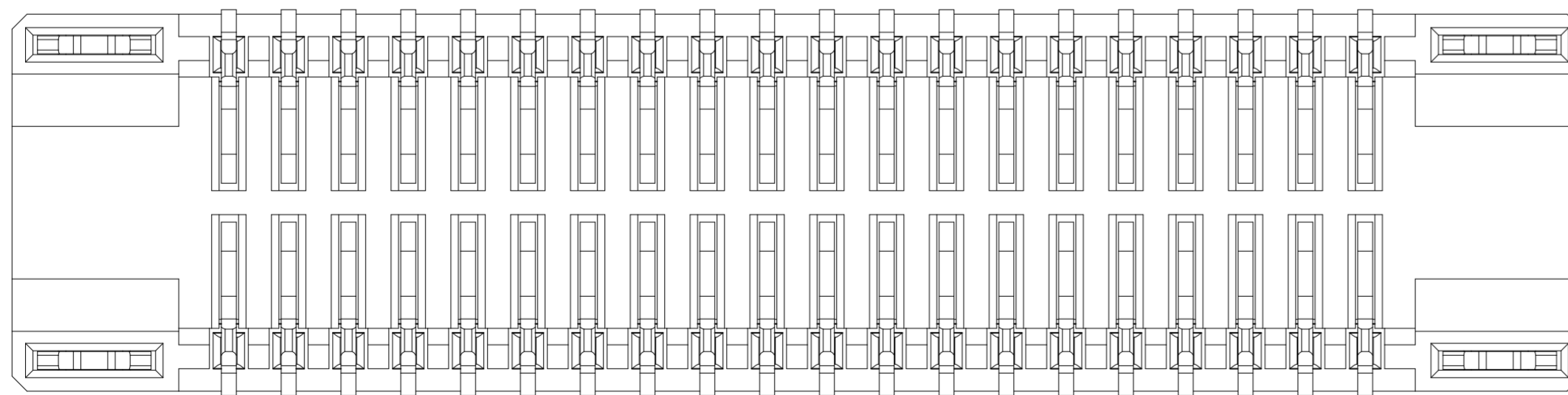
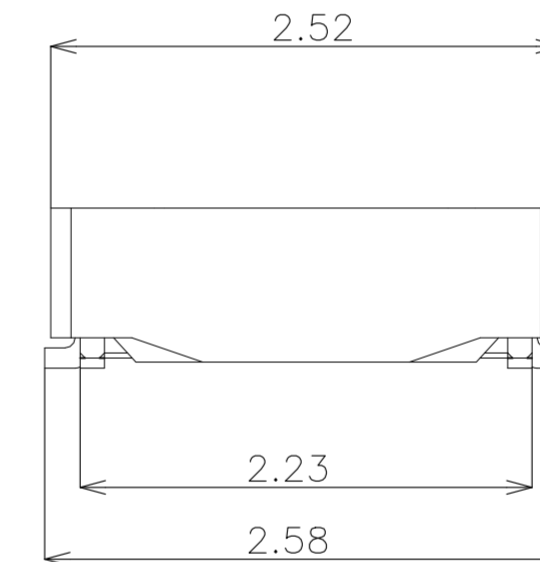
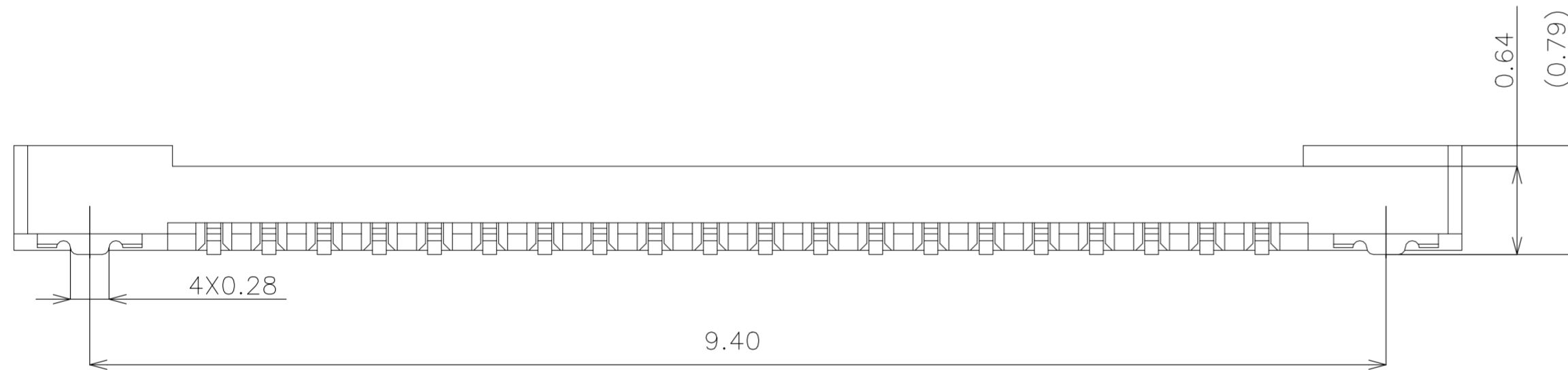
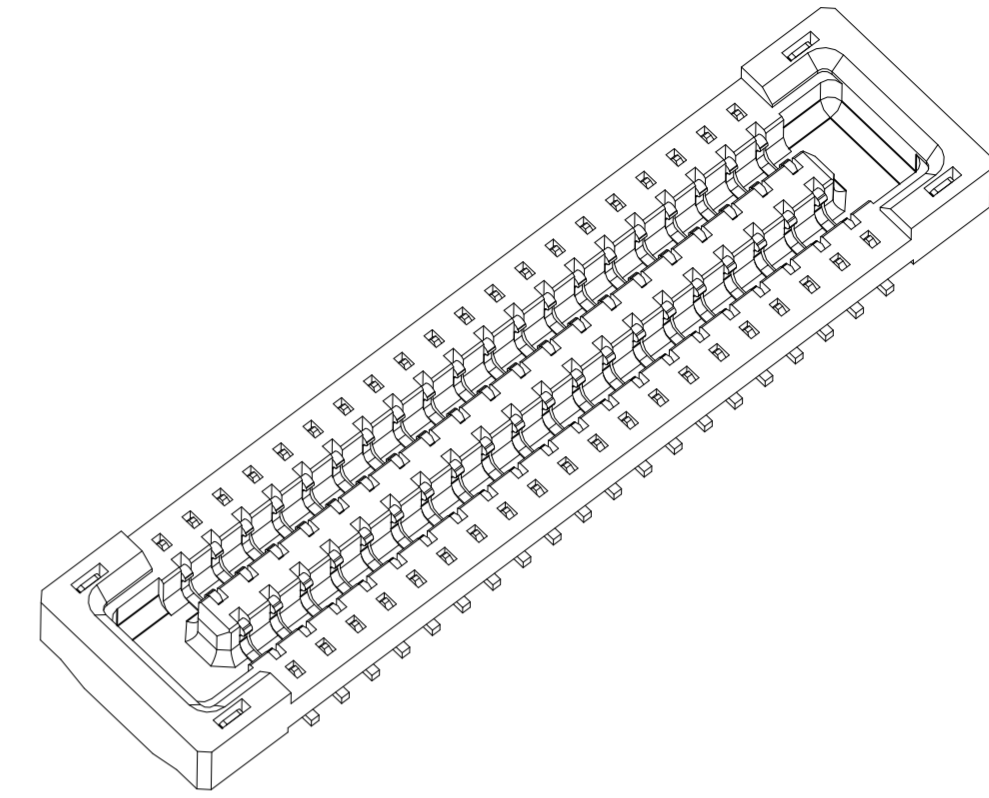
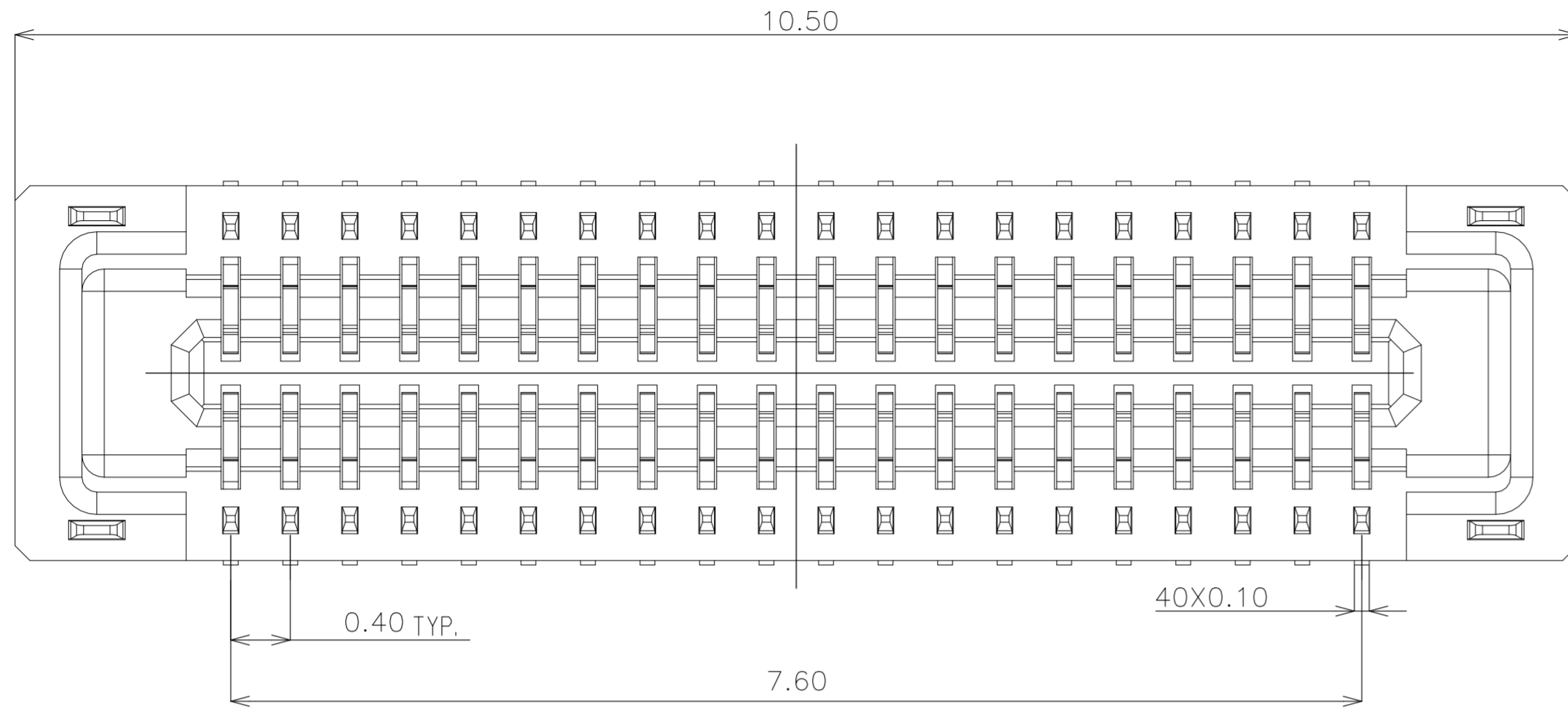

4-2363961-0
PART NUMBER

THIS DRAWING IS A CONTROLLED DOCUMENT.		DWN H.X	26SEP2019	TE Connectivity Ltd.	
		CHK W.H	26SEP2019		
		APVD -	-	NAME	
		PRODUCT SPEC		0.4mm PITCH BTB CONN. H0.8 REC ASSEMBLY	
		APPLICATION SPEC		-	
		114-115040		SIZE	A2
		WEIGHT		CAGE CODE	00779
		CUSTOMER DRAWING		DRAWING NO	C=2363961
				RESTRICTED TO	-
				SCALE	12:1
				SHEET	3 of 9
				REV	A1

P	LTR	DESCRIPTION	DATE	DWN	APVD
-	-	SEE SHEET 1	-	-	-

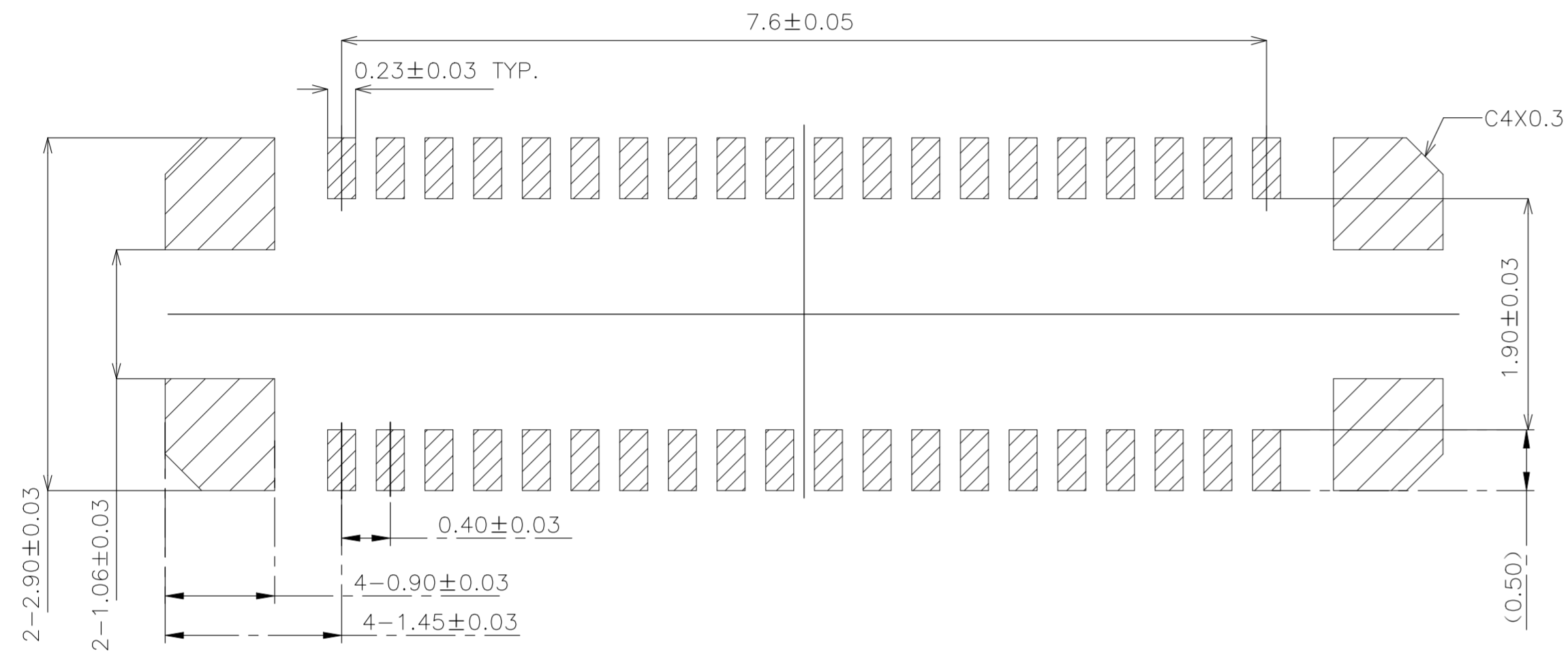

- NOTES:
- MATERIAL:
 - HOUSING: LCP, UL 94 V-0, COLOR: BLACK.
 - CONTACT: COPPER ALLOY.
 - HOLD DOWN: COPPER ALLOY.
 - FINISH:
 - CONTACT: GOLD FLASH ON CONTACT AND SOLDERING AREA. NICKEL UNDER PLATING OVERALL.
 - HOLD DOWN: TIN PLATING OVER NICKEL UNDER PLATING.
 - REFLOW SOLDER CAPABLE TO 260 °C.
 - MATING PLUG PART NUMBER: 4-2363962-0.
 - PRODUCT SPECIFICATION 108-115166

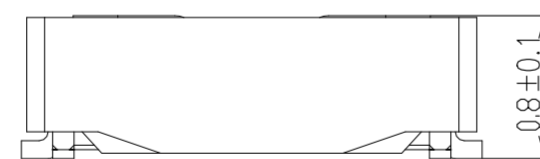

MATING HEIGHT

THIS DRAWING IS A CONTROLLED DOCUMENT.		DWN	26SEP2019	TE Connectivity Ltd.	
DIMENSIONS:		CHK	26SEP2019		
mm		APVD	-		
		NAME	0.4mm PITCH BTB CONN. HO.8 REC ASSEMBLY		
TOLERANCES UNLESS OTHERWISE SPECIFIED		PRODUCT SPEC	SEE NOTE 5	SIZE	A2
0 PLC ±		APPLICATION SPEC	114-115040	CAGE CODE	00779
1 PLC ± 0.3		WEIGHT	-	DRAWING NO	C=2363961
2 PLC ± 0.20		MATERIAL	-	RESTRICTED TO	-
3 PLC ±		FINISH	-	SCALE	12:1
4 PLC ±		CUSTOMER DRAWING		SHEET	4 of 9
ANGLES ±				REV	A1

P	LTR	DESCRIPTION	DATE	DWN	APVD
-	-	SEE SHEET 1	-	-	-

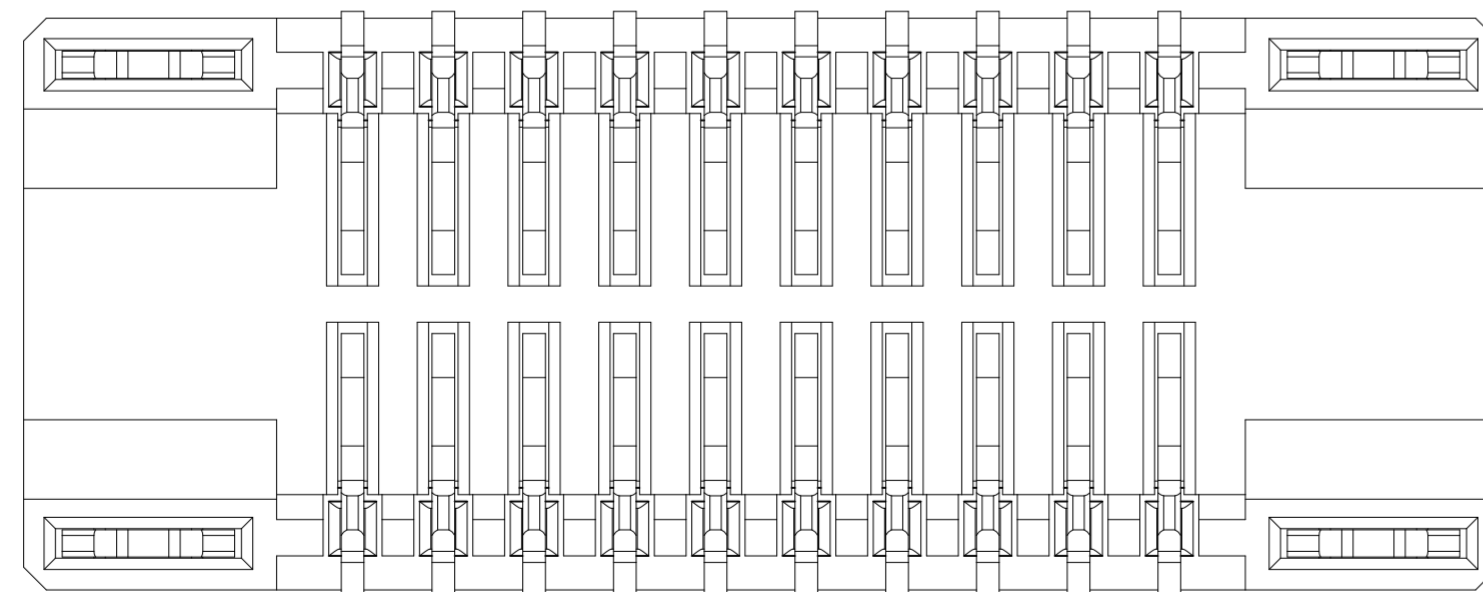
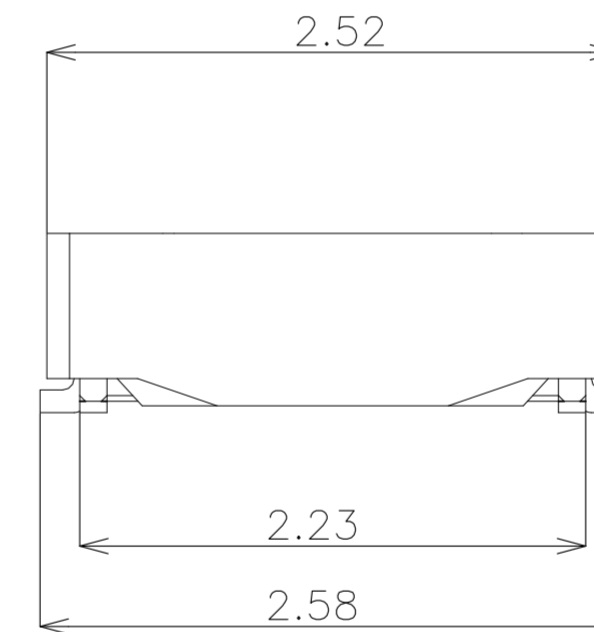
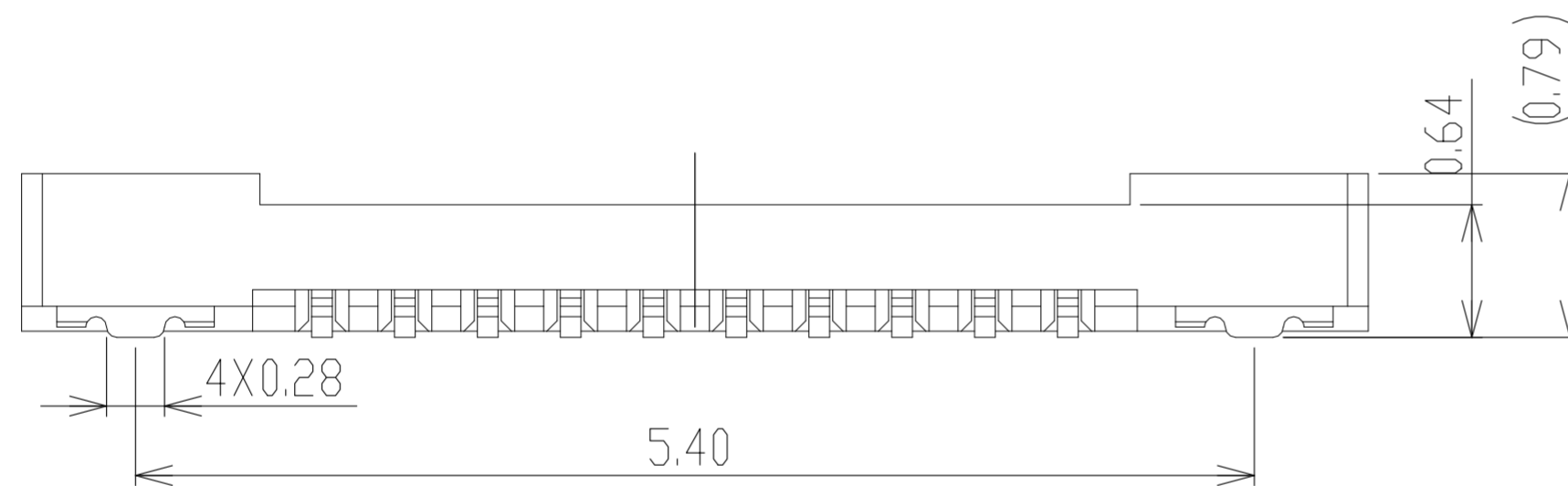
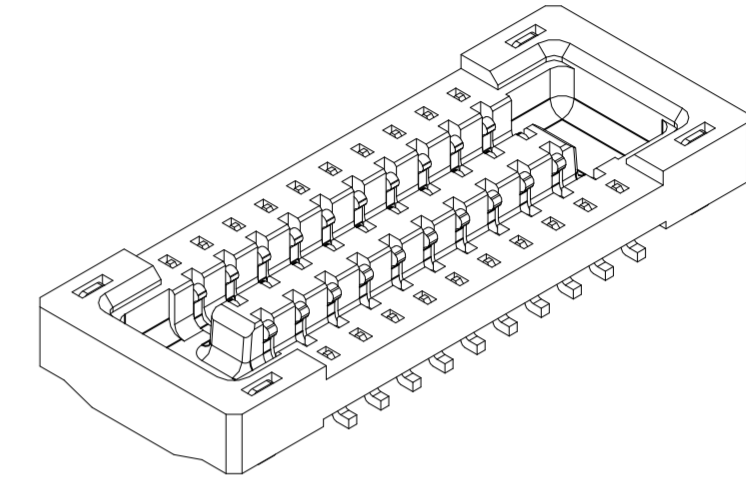
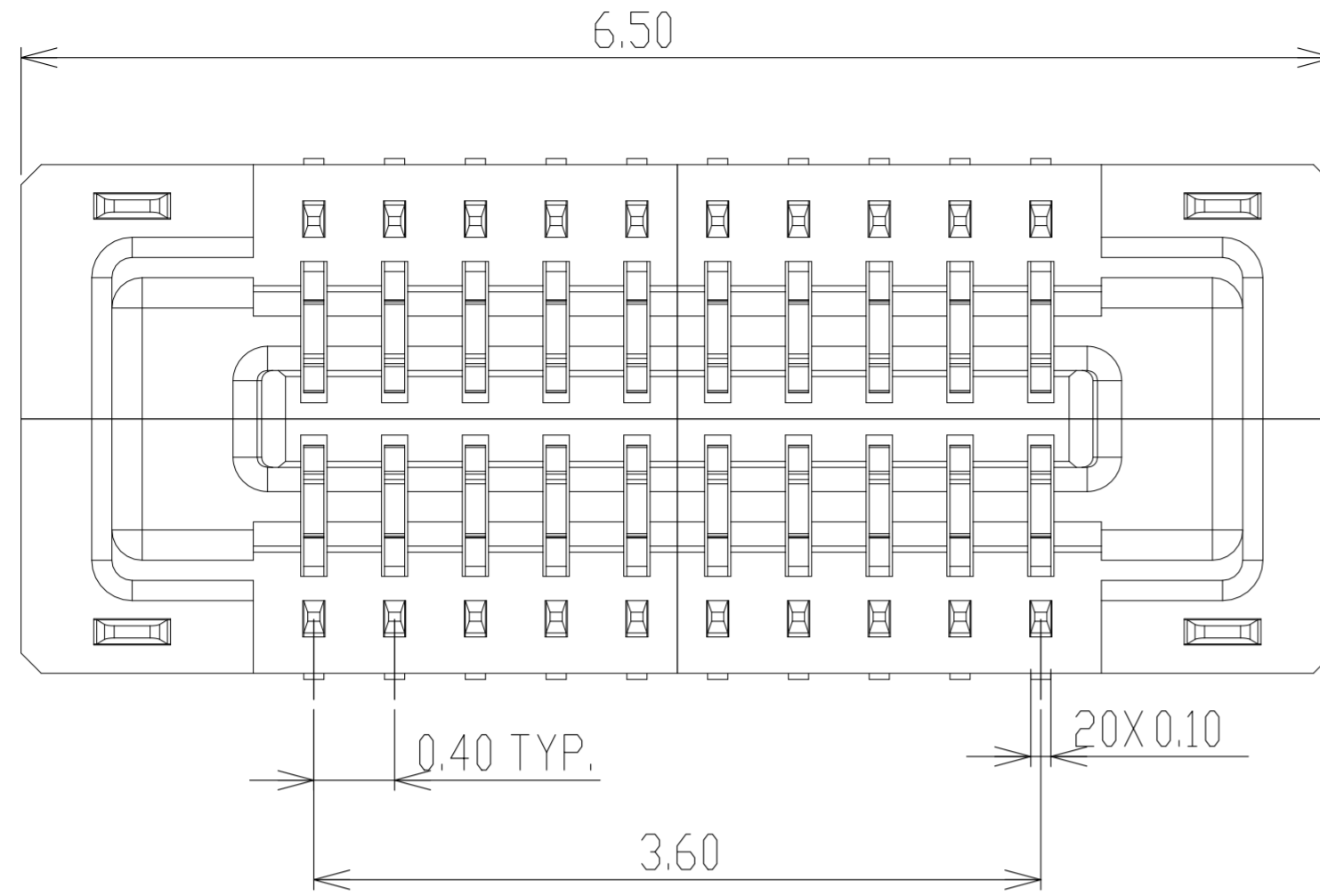

2-2363961-0
PART NUMBER

THIS DRAWING IS A CONTROLLED DOCUMENT.		DWN H.X 26SEP2019	TE Connectivity Ltd.		
DIMENSIONS: mm		CHK W.H 26SEP2019	0.4mm PITCH BTB CONN. H0.8 REC ASSEMBLY		
TOLERANCES UNLESS OTHERWISE SPECIFIED:		APVD -	NAME		
0 PLC ± -		PRODUCT SPEC	SEE NOTE 5		
1 PLC ± 0.3		APPLICATION SPEC	114-115040		
2 PLC ± 0.20		SIZE	CAGE CODE	DRAWING NO	RESTRICTED TO
3 PLC ± -		WEIGHT	A2	00779	-
4 PLC ± -		CUSTOMER DRAWING	C=2363961		-
ANGLES ± -		SCALE	12:1	SHEET	5 of 9
FINISH		REV	A1		

REVISIONS					
P	LTR	DESCRIPTION	DATE	DWN	APVD
-	-	SEE SHEET 1	-	-	-

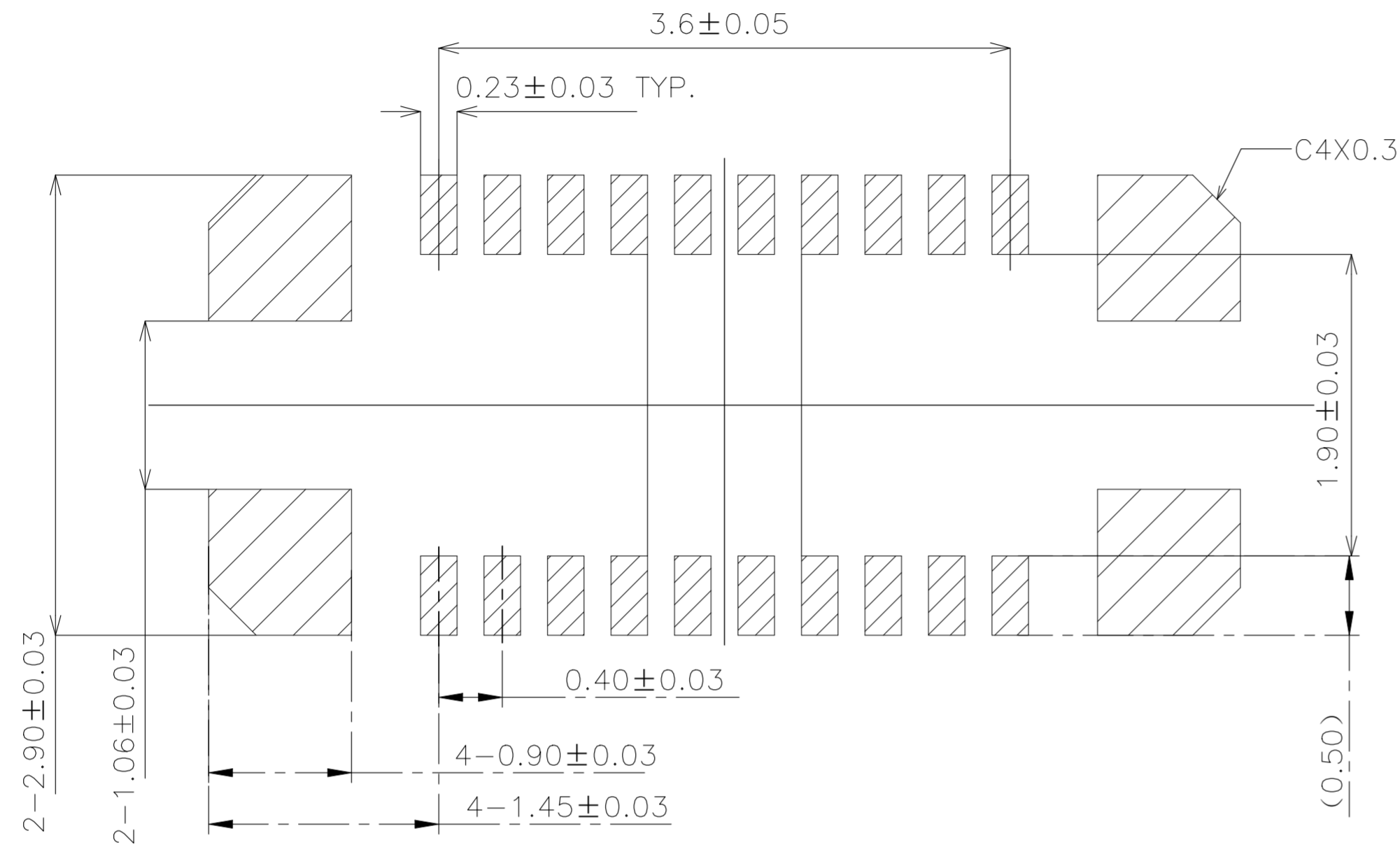

RECOMMENDED P.C. BOARD PATTERN DIMENSION (WITH HOLD DOWN)



MATING HIGHT

NOTES:

1. MATERIAL:

- 1.1 HOUSING: LCP, UL 94 V-0, COLOR: BLACK.
- 1.2 CONTACT: COPPER ALLOY.
- 1.3 HOLD DOWN: COPPER ALLOY.

2. FINISH:

- 2.1 CONTACT:
GOLD FLASH ON CONTACT AND SOLDERING AREA.
NICKEL UNDER PLATING OVERALL.
- 2.2 HOLD DOWN:
TIN PLATING OVER NICKEL UNDER PLATING.

3. REFLOW SOLDER CAPABLE TO 260 °C.

4. MATING PLUG PART NUMBER: 2-2363962-0.

5. PRODUCT SPECIFICATION 108-161052

THIS DRAWING IS A CONTROLLED DOCUMENT.		DWN H.X	26SEP2019	TE TE Connectivity Ltd.		
		CHK W.H	26SEP2019			
		APVD -	-	NAME		
DIMENSIONS: mm		TOLERANCES UNLESS OTHERWISE SPECIFIED:		PRODUCT SPEC 0.4mm PITCH BTB CONN. H0.8 REC ASSEMBLY		
		0 PLC	± -	APPLICATION SPEC SEE NOTE 5		
		1 PLC	± 0.3	114-115040		
		2 PLC	± 0.20	SIZE	CAGE CODE	DRAWING NO
		3 PLC	± -	A2	00779	C=2363961
MATERIAL		FINISH	WEIGHT	SCALE	SHEET	
-		-	-	12:1	6 of 9	
CUSTOMER DRAWING				RESTRICTED TO	REV	
				-	A1	

P	LTR	DESCRIPTION	DATE	DWN	APVD
-	-	SEE SHEET 1	-	-	-

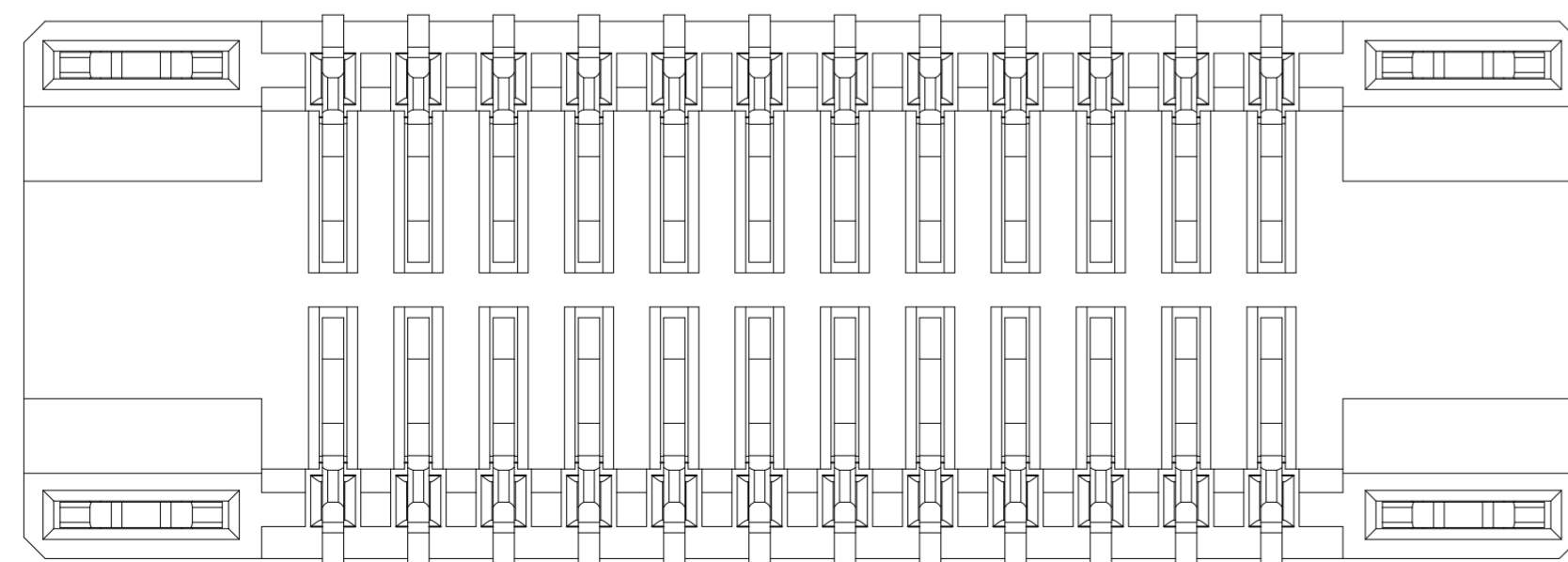
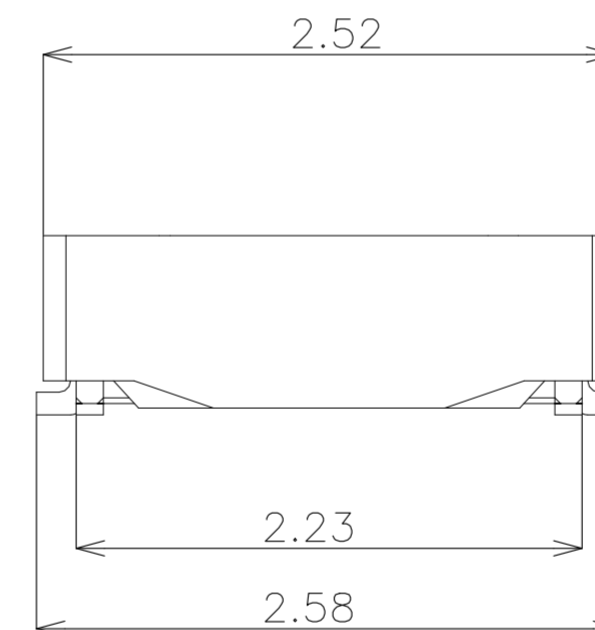
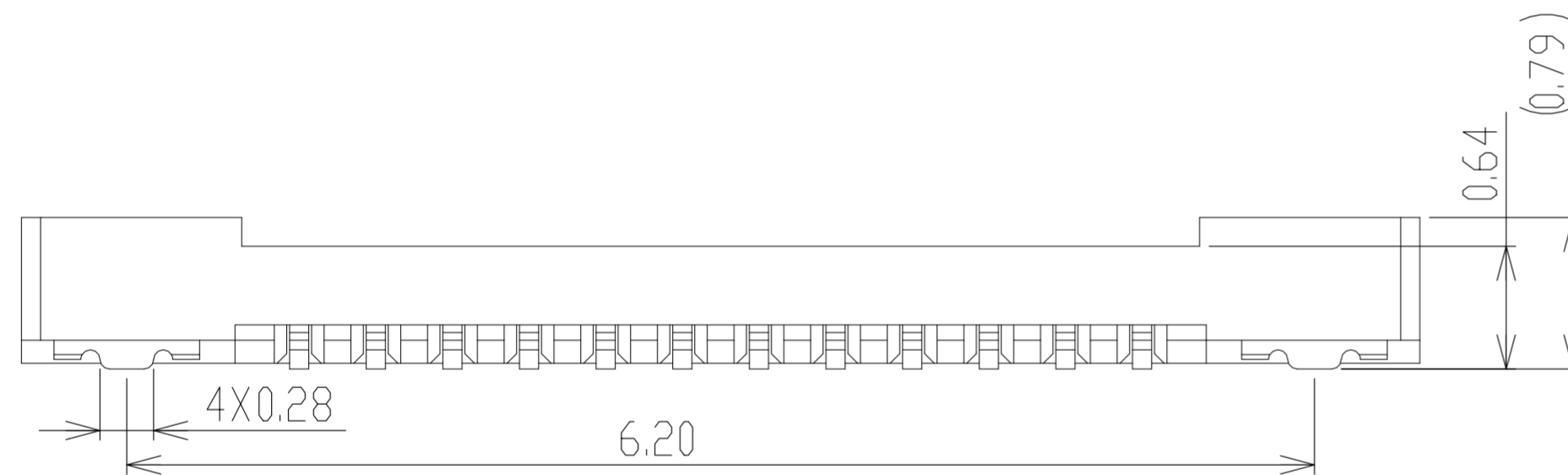
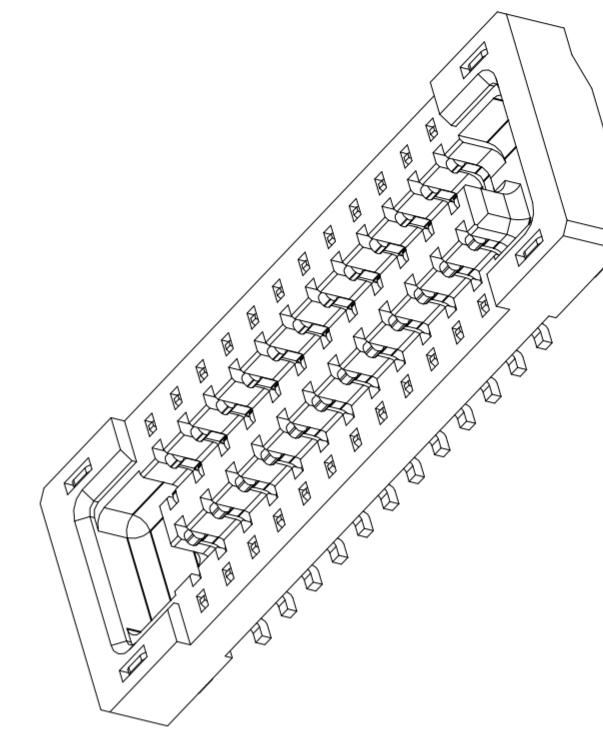
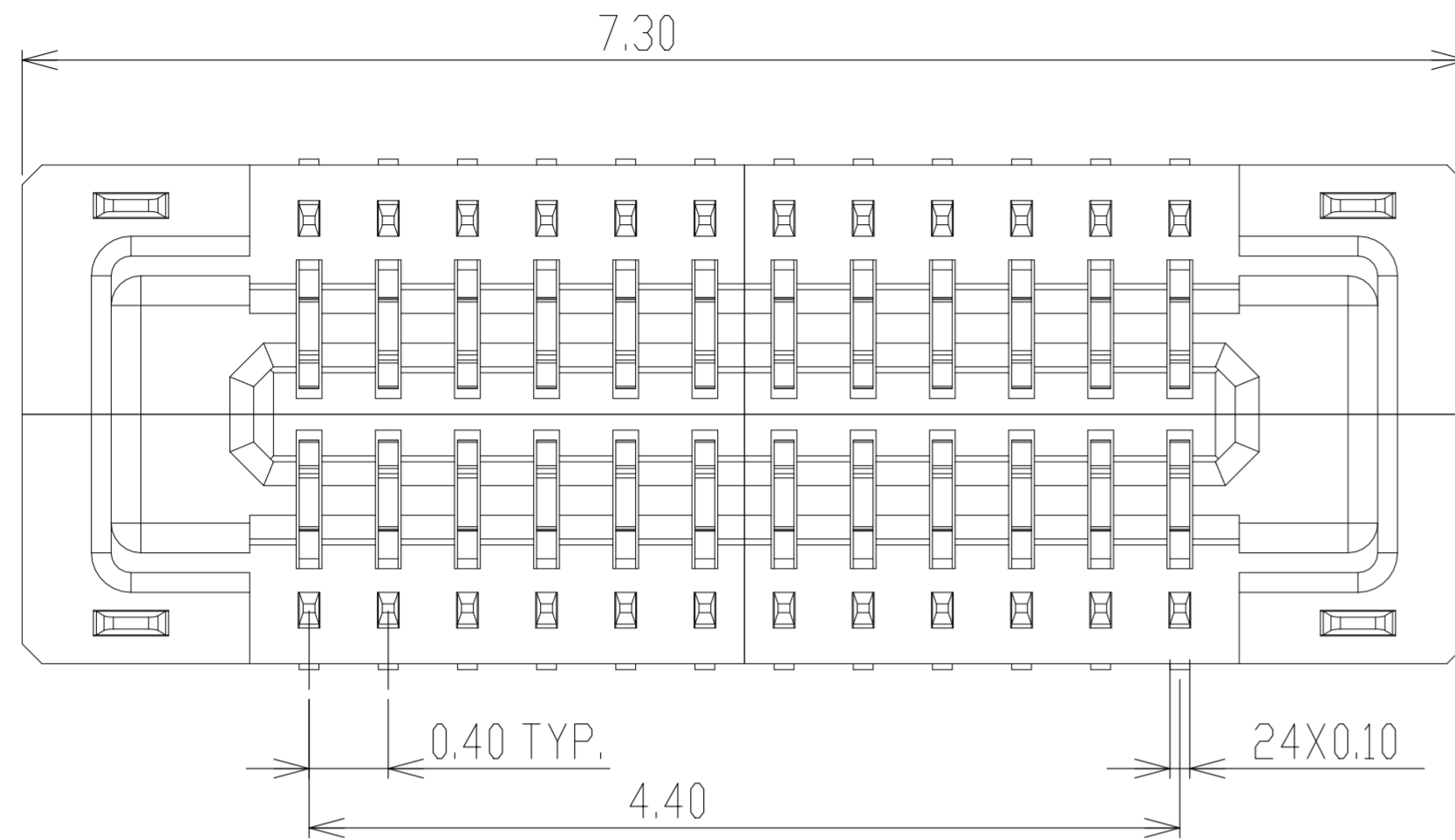

2-2363961-4
PART NUMBER

THIS DRAWING IS A CONTROLLED DOCUMENT.		DWN H.X	26SEP2019	TE Connectivity Ltd.	
		CHK W.H	26SEP2019		
DIMENSIONS: mm		TOLERANCES UNLESS OTHERWISE SPECIFIED:		NAME 0.4mm PITCH BTB CONN. H0.8 REC ASSEMBLY	
		0 PLC	± -	PRODUCT SPEC SEE NOTE 5	
		1 PLC	± 0.3	APPLICATION SPEC 114-115040	
MATERIAL		2 PLC	± 0.20	SIZE	A2
		3 PLC	± -	CAGE CODE	00779
		4 PLC	± -	DRAWING NO	C=2363961
		ANGLES	± -	RESTRICTED TO	-
		FINISH	-	SCALE	12:1
				SHEET	7 of 9
				REV	A1
				CUSTOMER DRAWING	

REVISIONS					
P	LTR	DESCRIPTION	DATE	DWN	APVD
-	-	SEE SHEET 1	-	-	-

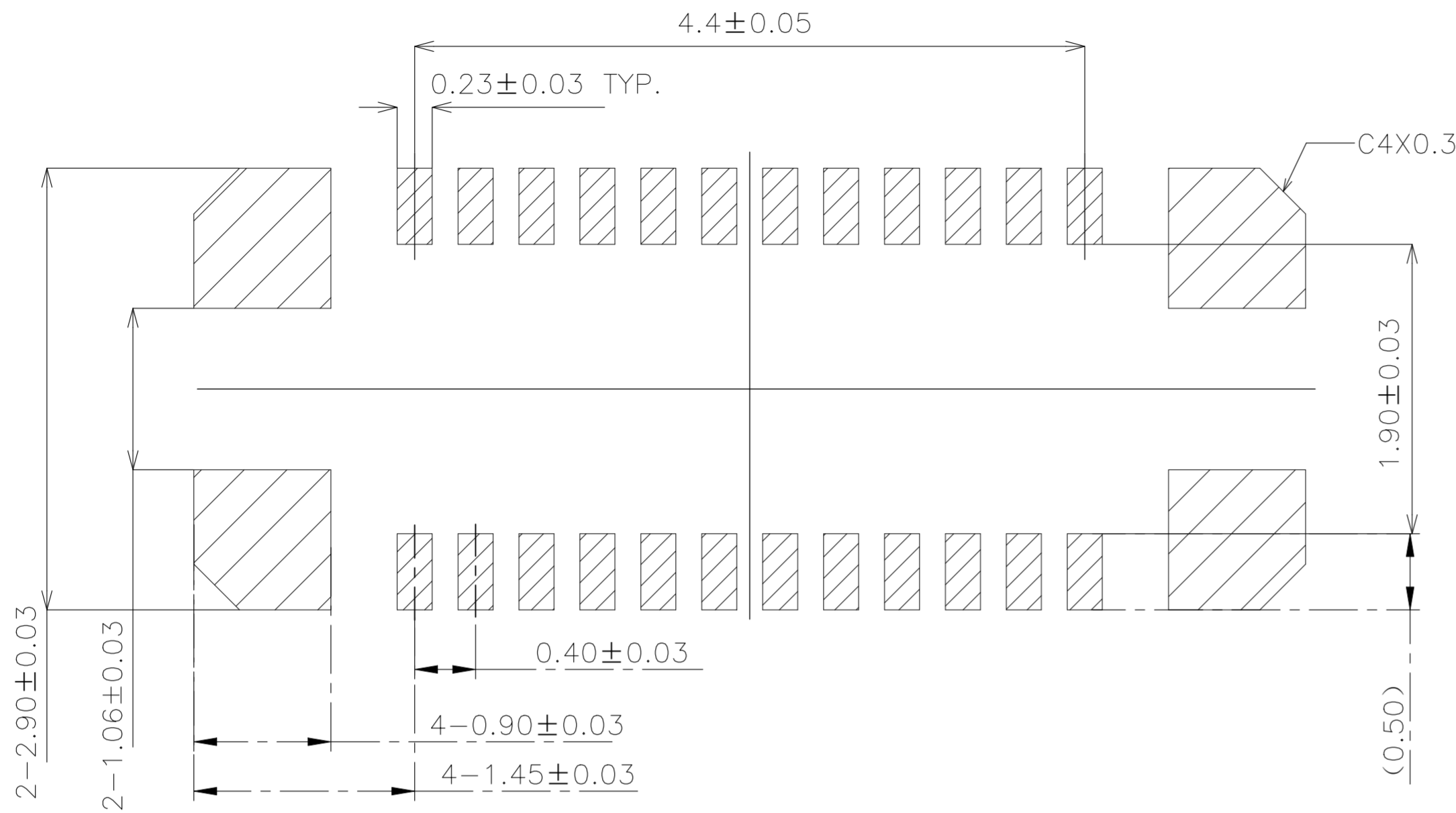

RECOMMENDED P.C.BOARD PATTERN DIMENSION (WITH HOLD DOWN)

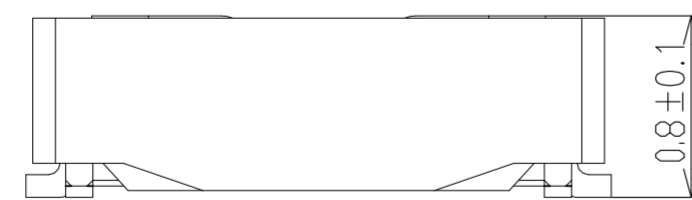

MATING HIGHT

- NOTES:
- MATERIAL:
 - 1.1 HOUSING: LCP, UL 94 V-0, COLOR: BLACK.
 - 1.2 CONTACT: COPPER ALLOY.
 - 1.3 HOLD DOWN: COPPER ALLOY.
 - FINISH:
 - 2.1 CONTACT: GOLD FLASH ON CONTACT AND SOLDERING AREA. NICKEL UNDER PLATING OVERALL.
 - 2.2 HOLD DOWN: TIN PLATING OVER NICKEL UNDER PLATING.
 - REFLOW SOLDER CAPABLE TO 260 °C.
 - MATING PLUG PART NUMBER: 2-2363962-0.
 - PRODUCT SPECIFICATION 108-161052

THIS DRAWING IS A CONTROLLED DOCUMENT.		DWN	26SEP2019		TE Connectivity Ltd.
		CHK	26SEP2019		
		APVD	-		
		NAME	-		
DIMENSIONS:	TOLERANCES UNLESS OTHERWISE SPECIFIED:	PRODUCT SPEC	0.4mm PITCH BTB CONN.		
mm		APPLICATION SPEC	H0.8 REC ASSEMBLY		
	0 PLC ± -	114-115040	SIZE	CAGE CODE	DRAWING NO
	1 PLC ± 0.3	SEE NOTE 5	A2	00779	C=2363961
	2 PLC ± 0.20		SCALE	SHEET	REV
	3 PLC ± -		12:1	8 of 9	A1
	4 PLC ± -		CUSTOMER DRAWING		
	ANGLES ± -				
MATERIAL	FINISH	WEIGHT	RESTRICTED TO		
-	-	-	-		

REVISIONS					
P	LTR	DESCRIPTION	DATE	DWN	APVD
-	-	SEE SHEET 1	-	-	-

- NOTES :
- PACKAGING MATERIAL IN PLASTIC, RUBBER, INK, PIGMENT AND PAINT MUST MEET CONTROLLED SUBSTANCES SPEC PER 230-702.
 - * CADMIUM AND CADMIUM COMPOUNDS NOT TO EXCEED: 5 PPM.
 - * LEAD, CADMIUM, CHROM VI AND MERCURY NOT TO EXCEED: 100 PPM (COMBINED).
 - * CARRIER TAPES, COVER TAPES, REELS AND TAPED COMPONENTS MUST MEET THE REQUIREMENTS DEFINED PER EIA-481-C.
- MATERIAL :
COVER TAPE : PET, COLOR: TRANSPARENT.
CARRIER TAPE : POLYSTYRENES, BLACK COLOR.
REEL : POLYSTYRENES, BLUE COLOR.
SHIPPING BOX: CORRUGATED FIBER
 - DIMENSION :
REEL : SEE DRAWING
SHIPPING BOX : SEE DRAWING
 - QUANTITY : SEE TABLE
 - WEIGHT : SEE TABLE
 - PEELING RESISTANCE : 10gf~130gf
 - PEELING SPEED : 300mm/MINUTES

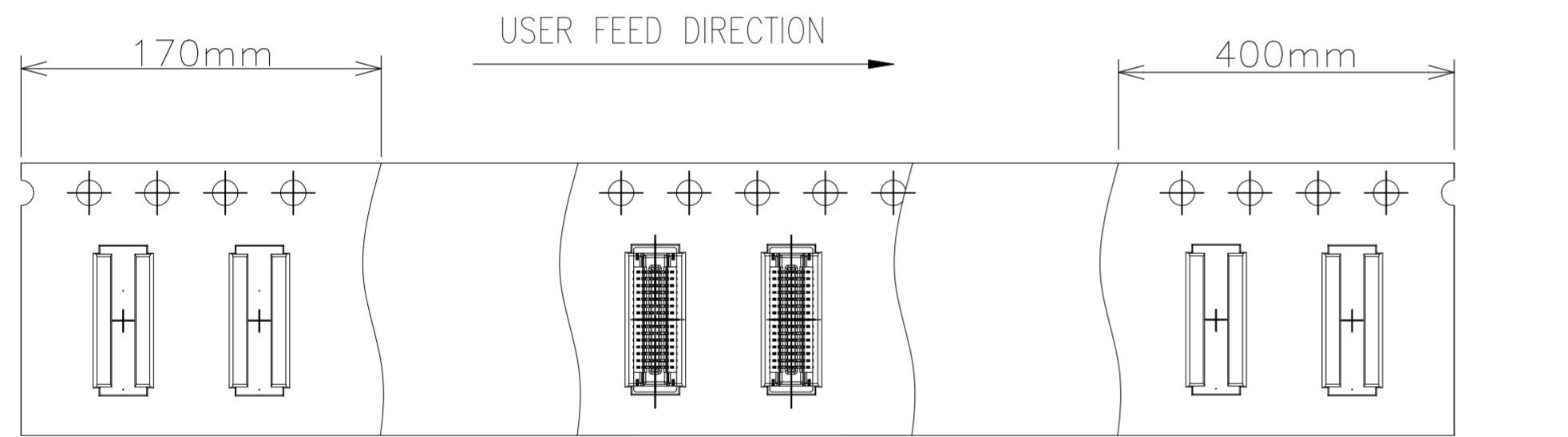
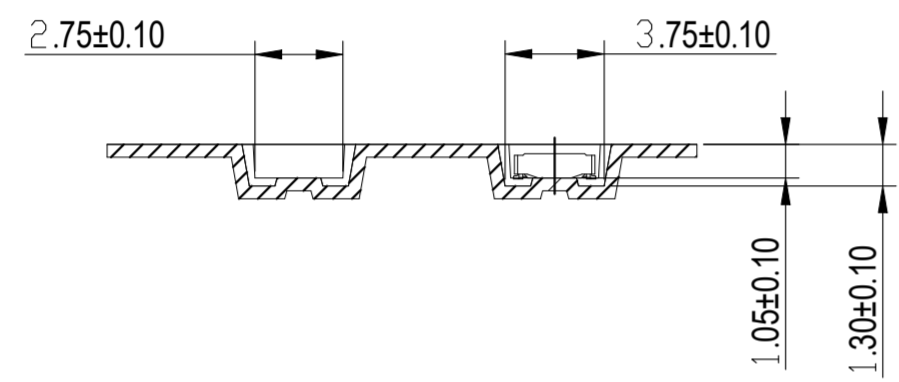
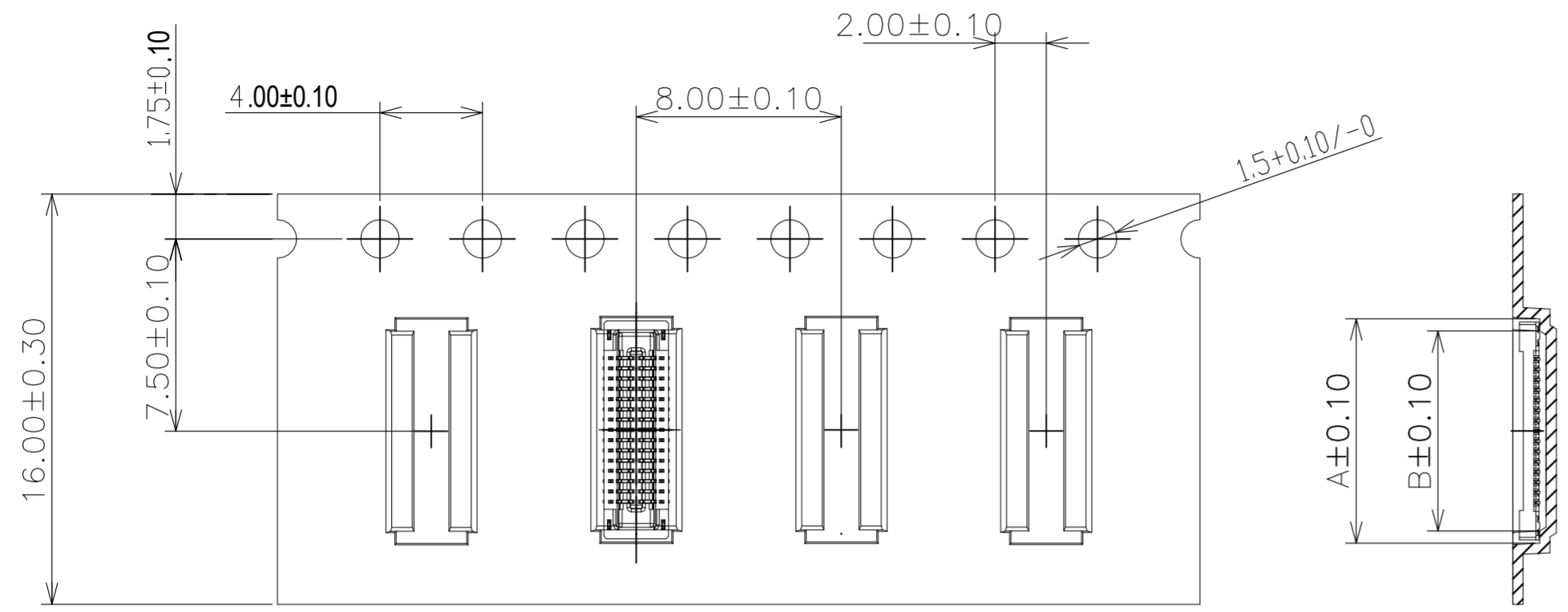

5.95	7.55	4.024KG	0.54KG	5000	6	30000	2-2363961-4
5.15	6.75	3.964KG	0.48KG	5000	6	30000	2-2363961-0
7.15	8.75	4.114KG	0.63KG	5000	6	30000	3-2363961-0
9.15	10.75	6.018KG	0.81KG	5000	6	30000	4-2363961-0
DIM B	DIM A	GROSS WEIGHT	NET WEIGHT	PCS/ REEL	REEL/ BOX	PCS/ BOX	PART NUMBER

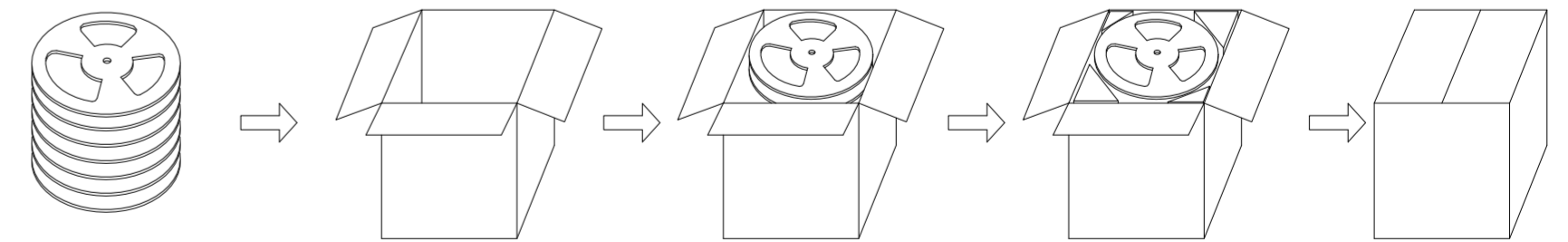
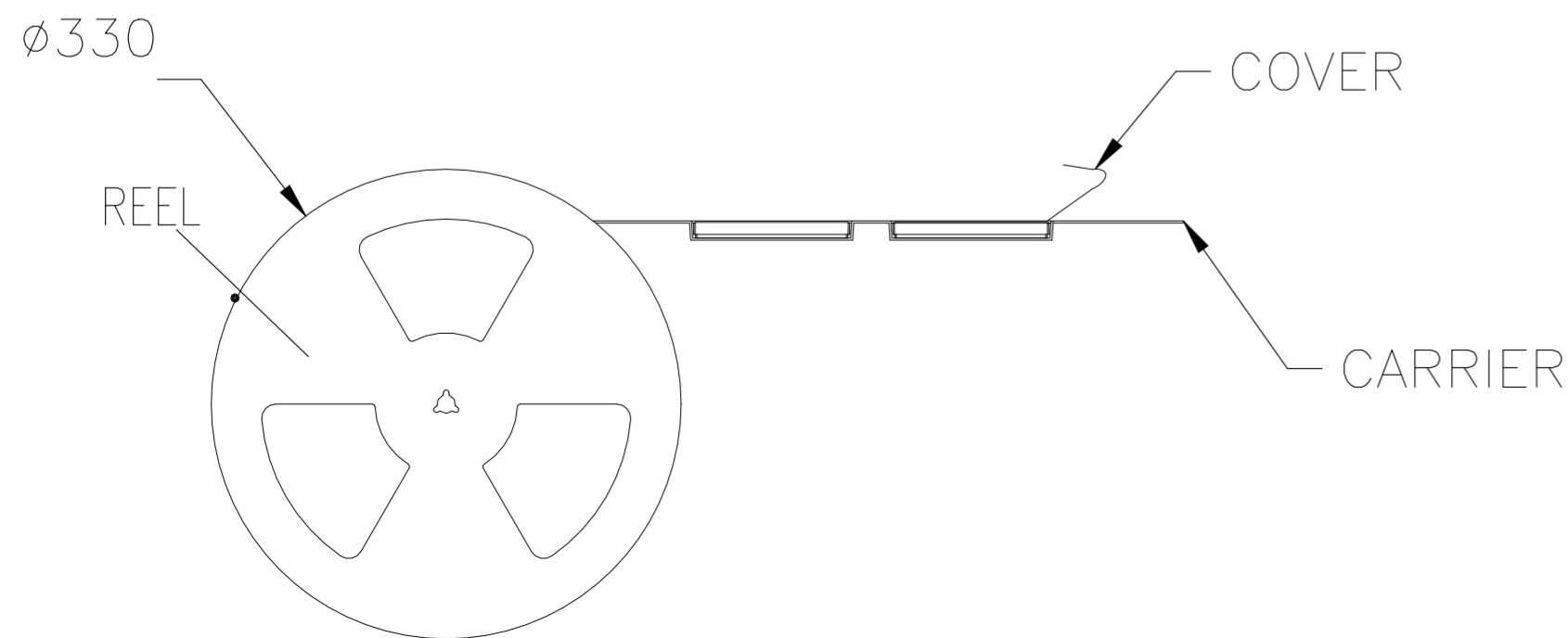

OUT BOX PACKAGE DIAGRAM DRAWING

THIS DRAWING IS A CONTROLLED DOCUMENT.		DWN	26SEP2019	TE Connectivity Ltd.																									
		CHK	26SEP2019																										
DIMENSIONS: mm		TOLERANCES UNLESS OTHERWISE SPECIFIED		NAME	0.4mm PITCH BTB CONN. HO.8 REC ASSEMBLY																								
<table border="1"> <tr><td>0</td><td>PLC</td><td>±</td><td></td></tr> <tr><td>1</td><td>PLC</td><td>±</td><td>0.3</td></tr> <tr><td>2</td><td>PLC</td><td>±</td><td>0.20</td></tr> <tr><td>3</td><td>PLC</td><td>±</td><td>-</td></tr> <tr><td>4</td><td>PLC</td><td>±</td><td>-</td></tr> <tr><td colspan="2">ANGLES</td><td>±</td><td>-</td></tr> </table>		0	PLC	±		1	PLC	±	0.3	2	PLC	±	0.20	3	PLC	±	-	4	PLC	±	-	ANGLES		±	-	PRODUCT SPEC	-		
0	PLC	±																											
1	PLC	±	0.3																										
2	PLC	±	0.20																										
3	PLC	±	-																										
4	PLC	±	-																										
ANGLES		±	-																										
MATERIAL		APPLICATION SPEC	114-115040		SIZE	CAGE CODE	DRAWING NO																						
-		FINISH	-		A2	00779	C=2363961																						
CUSTOMER DRAWING				SCALE	12:1	SHEET	9 of 9																						
				REV	A1																								