

PRODUCT NUMBER	PITCH
NKxxA0x100J0G	7.50mm

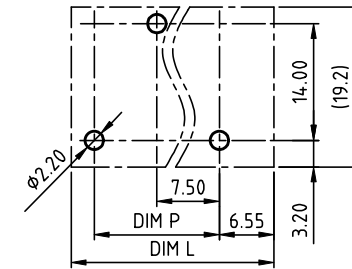
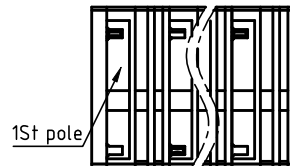
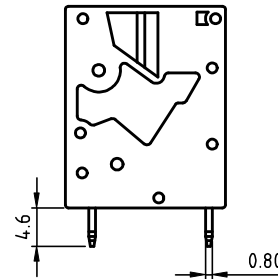
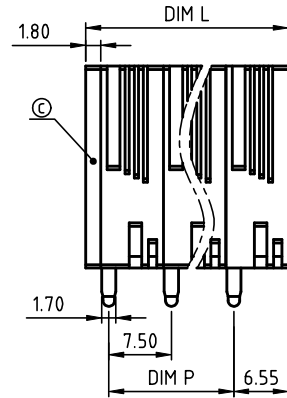
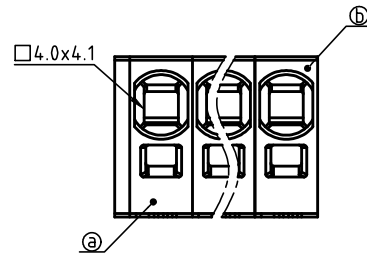
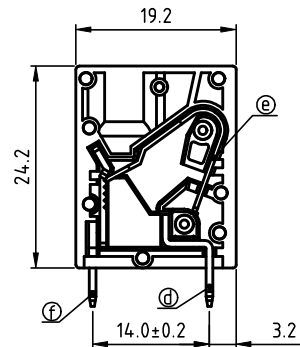

RECOMMENDED P.C.B LAYOUT  
TOP VIEW

Material:

- Item ③ Terminal body: Thermoplastic (UL94V-0)
- Item ④ Terminal side body: Thermoplastic (UL94V-0)
- Item ⑤ Terminal cover: Thermoplastic (UL94V-0)
- Item ⑥ Solder pin1: Copper, Tin Plated.
- Item ⑦ Spring clamp: Stainless steel
- Item ⑧ Solder pin2: Copper, Tin Plated.

- Electrical:
- |                          | cULus           | Use group(B,C) | Use group(D) |
|--------------------------|-----------------|----------------|--------------|
| ● Voltage rating:        | 300V            | 600V           |              |
| ● Current rating(Sol):   | 30A             | 5A             |              |
| ● Current rating(Str):   | 35 A            | 5A             |              |
| ● Solid wire(AWG):       | 10-24           |                |              |
| ● Stranded wire(AWG):    | 8-24            |                |              |
| ● Wire strip length:     | 15-16 mm        |                |              |
| ● Withstanding Voltage:  | 1.6KV           |                |              |
| ● Operating temperature: | -40°C to +115°C |                |              |
| ● Soldering temperature: | 260°C±5°C/5 Sec |                |              |
| ● Safety Approval:       | cULus           |                |              |

N=Number of poles  
Dim L=N×7.5+1.8  
Dim P=(N-1)×7.5

POLES	Dim L	Dim P
3p/5p	±0.15	±0.15
7p/9p/11p	±0.25	±0.25
13p/15p	±0.35	±0.35

PART NO.: NK xx A0 x 100J0 G

No. of poles	Color	RoHS compliant
0	Black (RAL9005)	(lead<4%)
End Stackable	2 Red (RAL3001/D)	In copper Alloy
03 3 poles	3 Orange(RAL2011/P)	
05 5 poles	4 Yellow(RAL1018/A)	
... ..	5 Green(RAL6018/T)	
15 15 poles	6 Blue (RAL5015/A)	
	8 Grey(RAL7004/P)	
	9 White(RAL1102)	
	C Multiple colors	

mat'l. code				surface	tolerance	projection	product family		
				ASME Y14.5	ASME Y14.5		TERMINAL BLOCK		
ltr	ecn no	dr	date	tolerances unless otherwise specified			title		
				angles	X.±0.5		TERMINAL BLOCK		
				flat	X.X±0.3		SPRING CLAMP, 90D WIRE INLET, INTERLACE TAIL B TYPE		
				X'±1"	X.XX±0.1		ODD POLES		
				dr	EVIN ZHONG	060514	scale		
				enr	EVIN ZHONG	060514	dwg no		
				chr	HANKE FENG	060514	sheet 1 of 2		
				appd	SHI JUN	060514	size		
sheet index							NKxxA0x100J0G		
revision sheet							A4		
							type		
							CUSTOMER Drawing		

PRODUCT NUMBER	PITCH
NKxxA0x100J0G	7.50mm

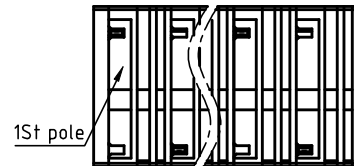
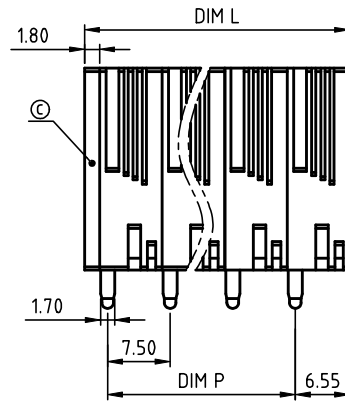
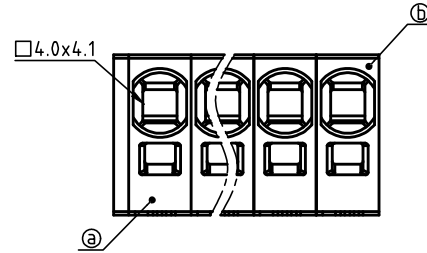
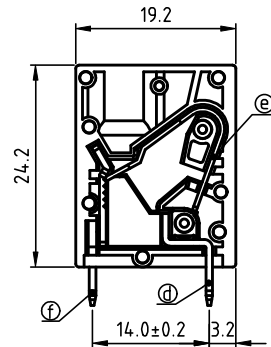

N=Number of poles  
 Dim L=N×7.5+1.8  
 Dim P=(N-1)×7.5

POLES	Dim L	Dim P
2p/4p/6P	±0.15	±0.15
8p/10p/12p	±0.25	±0.25
14p/16p	±0.35	±0.35

PART NO.: NK xx A0 x 100J0 G

No. of poles	Color	RoHS compliant
End Stackable 2	Black (RAL9005)	(lead<4%) In copper Alloy
02 2 poles	Red (RAL3001/D)	
04 4 poles	Orange(RAL2011/P)	
...	4 Yellow(RAL1018/A)	
...	5 Green(RAL6018/T)	
16 16 poles	6 Blue (RAL5015/A)	
	8 Grey(RAL7004/P)	
	9 White(RAL1102)	
	C Multiple colors	

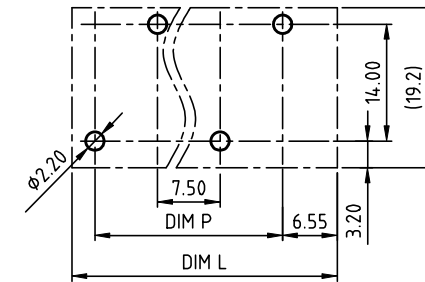

RECOMMENDED P.C.B LAYOUT  
TOP VIEW

Material:

- Item③ Terminal body: Thermoplastic (UL94V-0)
- Item④ Terminal side body: Thermoplastic (UL94V-0)
- Item⑤ Terminal cover: Thermoplastic (UL94V-0)
- Item⑥ Solder pin1: Copper, Tin Plated.
- Item⑦ Spring clamp: Stainless steel
- Item⑧ Solder pin2: Copper, Tin Plated.

	cULus	Use group(B,C)	Use group(D)
● Voltage rating:	300V	600V	
● Current rating(Sol):	30A	5A	
● Current rating(Str):	35 A	5A	
● Solid wire(AWG):	10-24		
● Stranded wire(AWG):	8-24		
● Wire strip length:	15-16 mm		
● Withstanding Voltage:	1.6KV		
● Operating temperature:	-40°C to +115°C		
● Soldering temperature:	260°C±5°C/5 Sec		
● Safety Approval:	UL		

mat'l. code	surface	tolerance	projection	product family
	ASME Y14.5	ASME Y14.5		TERMINAL BLOCK
ltr	ecn no	dr	date	title
				TERMINAL BLOCK
				SPRING CLAMP, 90D WIRE INLET, INTERLACE TAIL B TYPE
				EVEN POLES
				scale
				MM
				FCI
				type
				CUSTOMER Drawing
sheet	revision	A		
index	sheet	2		