

SPRING-LOADED PINS

DISCRETE SPRING-LOADED CONTACTS

0921-0

0921-0-15-20-76-14-11-0

Ultra low profile, Short stroke. Solder mount in .070 min. mounting hole
Also available on 24mm wide carrier tape: 1,700 parts per 13" reel
See page 28.2 for Tape & Reel details

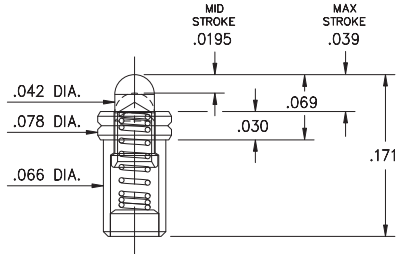

0921-1

0921-1-15-20-7X-14-11-0

Low profile, Standard stroke. Solder mount in .070 min. mounting hole
Also available on 24mm wide carrier tape: 1,500 parts per 13" reel
See page 28.2 for Tape & Reel details

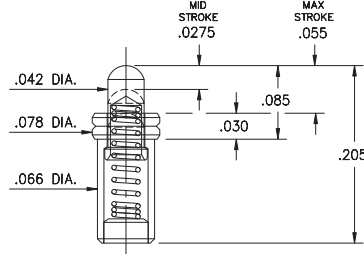

0911

0911-0-15-20-86-14-11-0

Standard stroke, Surface mount
*Stainless steel spring

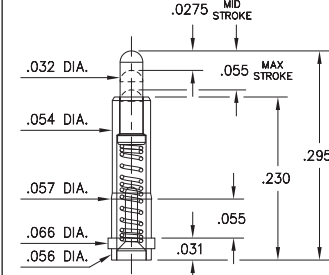

0926-0

0926-0-15-20-76-14-11-0

Low profile, Short stroke. Solder mount in .074 min. mounting hole
Also available on 16mm wide carrier tape: 1,700 parts per 13" reel
See page 28.3 for Tape & Reel details

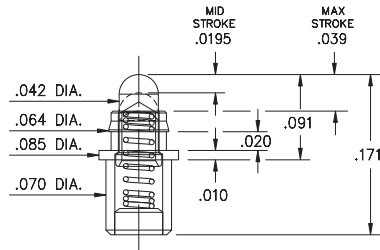

0926-1

0926-1-15-20-75-14-11-0

Low profile, Standard stroke. Solder mount in .074 min. mounting hole
Also available on 24mm wide carrier tape: 1,450 parts per 13" reel
See page 28.3 for Tape & Reel details

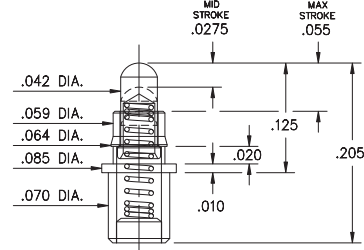

0980

0980-0-15-20-7X-14-11-0

Double action, .055 Combined stroke
Mount between parallel circuit boards

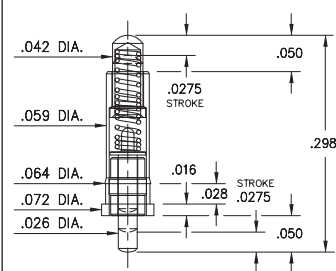

0977

0977-0-15-20-7X-14-11-0

Standard stroke, Surface mount
Also available on 24mm wide carrier tape: 1,100 parts per 13" reel
See page 28.3 for Tape & Reel details

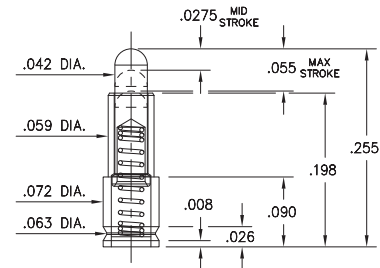

0965

0965-0-15-20-80-14-11-0

Ultra low profile, Surface mount, *Stainless steel spring
Also available on 16mm wide carrier tape: 3,000 parts per 13" reel
See page 28.3 for Tape & Reel details

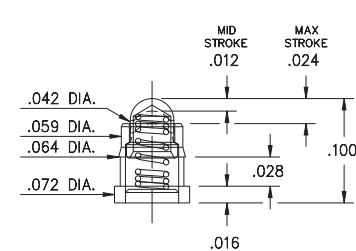

0959

0959-0-54-20-7X-14-11-0

Receptacle spring pin, Standard stroke
Accepts .020" - .032" Dia. pins

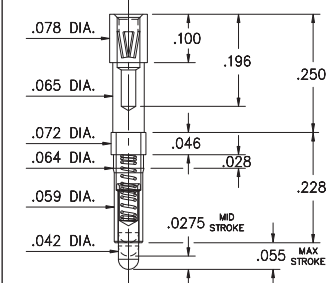

Material Specifications:

Sleeve & Plunger Material: Copper Alloy
Spring Material: BeCu or Stainless Steel 302 *
Sleeve & Plunger Finish: 20 μ " Gold over Nickel
Spring Finish: 10 μ " Gold over Nickel
Dimensions: Inches
Tolerances On: Lengths: $\pm .006$
Diameters: $\pm .002$
Angles: $\pm 2^\circ$



Mechanical & Electrical Specifications:

Durability: Up to 1,000,000 cycles
Current Rating: 2A continuous, 3A peak
Contact Resistance: 20 m Ω max.

Environmental Specifications:

Operating temperature range:
-55/+125°C (discontinuous)

75, 76, 80, 85, 86 Springs are not interchangeable

Order Code: 09XX - X - 15 - 20 - XX - 14 - 11 - 0

Spring Number

Spring Number	Mid. Stroke	Max. Stroke	Force @ Mid. Stroke	Initial Force (Pre-Load)
75	.0275	.055	60 g	25 g
76	.0195	.039	60 g	25 g
80	.012	.024	70 g	25 g
85	.040	.080	60 g	25 g
86	.0275	.055	60 g	25 g



Mill-Max Mfg. Corp. • 190 Pine Hollow Road, P.O. Box 300, Oyster Bay, NY 11771 • 516-922-6000 • Fax: 516-922-9253 • www.mill-max.com