

# EB2-A

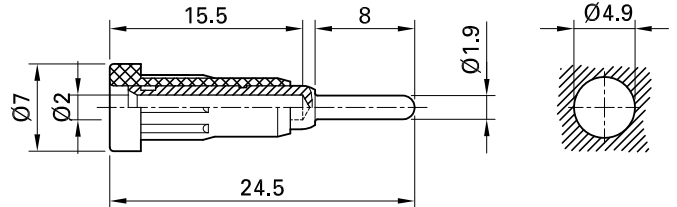

Item number 23.1012-\*

Insulated Ø 2 mm rigid made of machined brass. The socket is pressed into predrilled panels of plastic, metal etc. Round connecting pin Ø 1.9 mm.

Technical data	
Diameter of plug system	2 mm
Rated Values	30 V, 10 A / 60 V, 10 A
Surface treatment electrical contact	Au
Base material electrical contact	CuZn
Standard color(s) *	<span style="background-color: #ffff00; border: 1px solid black; padding: 2px;">20</span> <span style="background-color: #000000; color: white; border: 1px solid black; padding: 2px;">21</span> <span style="background-color: #ff0000; color: white; border: 1px solid black; padding: 2px;">22</span> <span style="background-color: #0000ff; color: white; border: 1px solid black; padding: 2px;">23</span> <span style="background-color: #ffff00; border: 1px solid black; padding: 2px;">24</span> <span style="background-color: #00ff00; border: 1px solid black; padding: 2px;">25</span> <span style="background-color: #800080; border: 1px solid black; padding: 2px;">26</span> <span style="background-color: #8b4513; border: 1px solid black; padding: 2px;">27</span> <span style="background-color: #808080; border: 1px solid black; padding: 2px;">28</span> <span style="border: 1px solid black; padding: 2px;">29</span>
Test accessory acc. to	IEC EN 61010-2-030
Component parts	I-EB2; B-EB2-A
Remarks	Accessories: Press-in tool MB2