

## Top View of Assembly

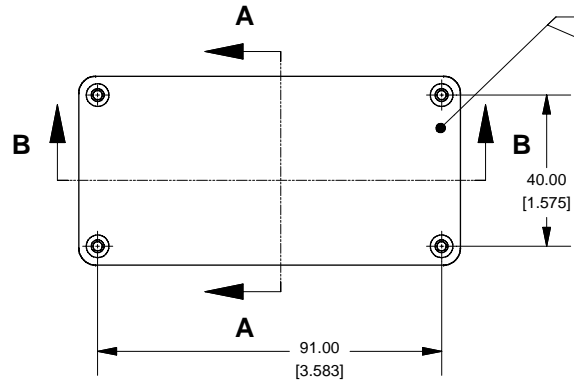

## SECTION A-A End View of Assembly

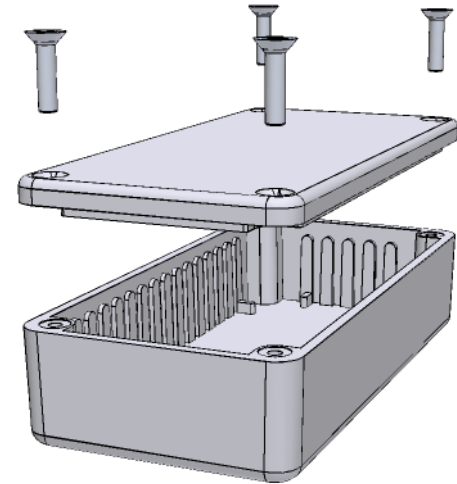
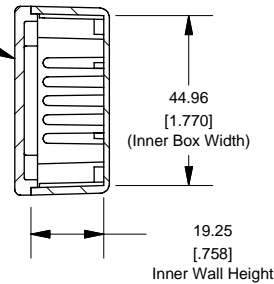

## SECTION B-B Side View of Assembly

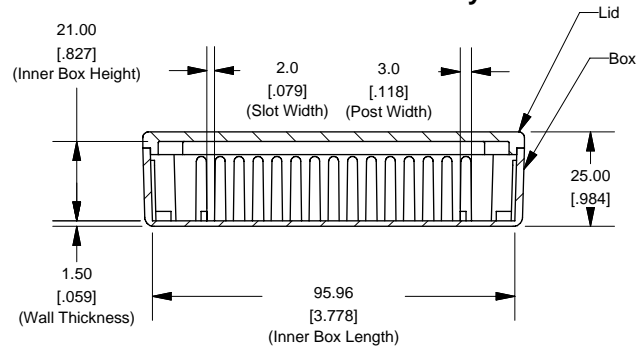

## Top View Looking Inside Box

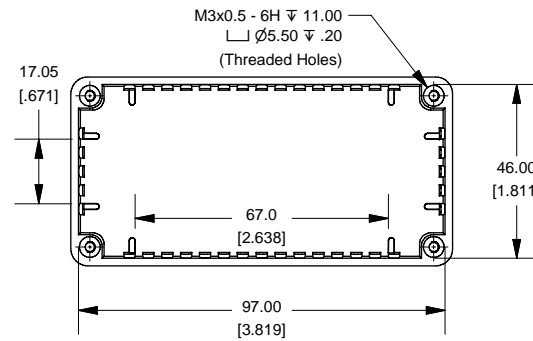

Enclosures can be Factory Modified ( Milling, Drilling, Printing etc.)  
Contact Factory [mjm@hammondmfg.com](mailto:mjm@hammondmfg.com) for quotes  
Solid models of this enclosure available in STEP or IGES.

### NOTE

Purchased assembly includes box, lid and 4 cover screws.  
Box and lid are made from Diecast Aluminum Alloy (alloy type 380).  
Silicone Gasket Loctite #5950

### PART NUMBERS

#### 1590L Enclosure

Unfinished	1590L
Grey Textured Polyester Powder Paint - RAL 7038	1590LGY
Black Textured Polyester Powder Paint - RAL 9011	1590LBK
<b>ACCESSORIES</b>	
<b>Recommended Torque: 75 ozf.in / 55 cNm</b>	
Unfinished Cover Screws (Pkg 100) [M3 - 0.5 x 10mm Nickel Plated Screws]	1591MS100
Black Textured Cover Screws (Pkg 100) [M3 - 0.5 x 10mm Nickel Plated Screws]	1591MS100BK

## Lid

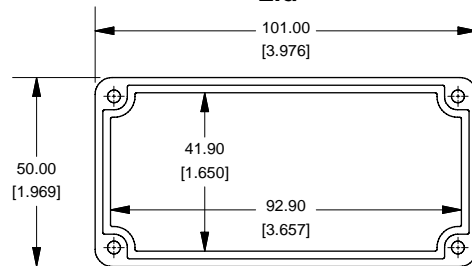

## DETAIL C Interior Features

