

PRODUCT NUMBER	PITCH
VCxx00x100J0G	7.62mm

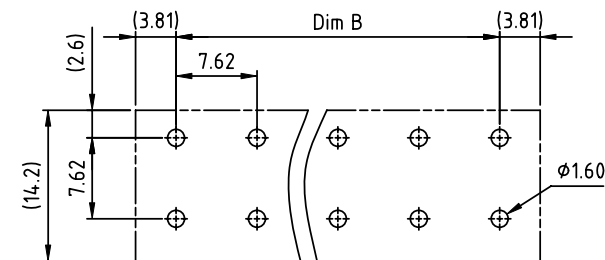

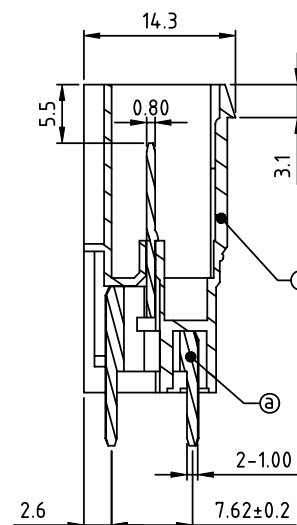
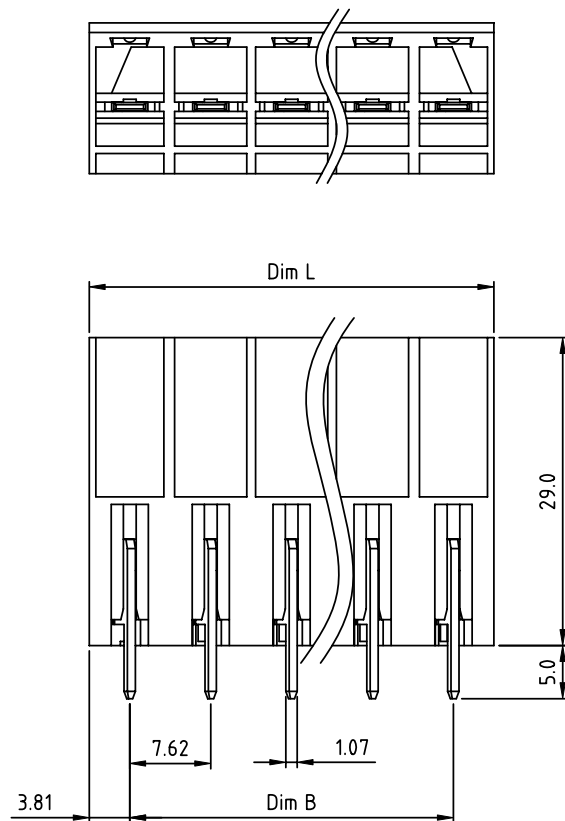

RECOMMENDED P.C.B LAYOUT  
TOP VIEW

#### Material:

- Item① Pin: Copper with Tin plated
- Item② Terminal (housing): Thermoplastic (UL94V-0)

#### Electrical

	cULus	TUV
● Voltage rating:	300V	800V
● Current rating:	32A	32A
● Withstanding Voltage:	1.6KV	6KV
● Operating temperature:	-40°C to +115°C	
● Soldering temperature:	260°C ± 5°C/5 Sec	
● Safety Approval:		

N = Number of poles  
Dim L = N x 7.62  
Dim B = (N-1) x 7.62

Poles	Tolerance
2-5p	±0.20
6-10p	±0.30
11-13p	±0.35
14-16p	±0.40

PART NO.: VC xx 00 x 1 00J0 G

Solid block	No. of poles	Color	RoHS compliant (lead<4%) In copper Alloy
02	2 poles	Black (RAL9005)	
03	3 poles	Red (RAL3001/D)	
...	...	Orange (RAL2011/P)	
16	16 poles	Yellow (RAL1018/A)	
		Green (RAL6018/T)	
		Blue (RAL5015/A)	
		Grey (RAL7035/D)	
		White (RAL1102)	
		Green (RAL6018/U)	

mat'l. code				surface	tolerance	projection	product family	
ltr	ecn	no	dr	date	ASME Y14.5 ✓	ASME Y14.5	TERMINAL BLOCK	
					tolerances unless otherwise specified		title	
					angles	X.±0.5	TERMINAL BLOCK	
					flatness	X.X±0.3	PLUGGABLE SOCKET, VERTICAL, TWO TAIL A TYPE	
					X'±1"	X.XX±0.1	scale	
					dr	EVIN ZHONG 042314	dwg no	
					enr	EVIN ZHONG 042314	sheet 1 of 1	
					chr	HANKE FENG 042314	VCxx00x100J0G	
					appd	SHI JUN 042314	type	
							CUSTOMER Drawing	
sheet index	revision	A						
	sheet	1						