

Part Number : [192890800](#)

Product Description : DIN-Style Die Set for Coeur CST High-Current Female Crimp Terminal, 1/0 AWG

Series Number : 207129

Status : Active

Product Category : Applicators and Crimp Modules

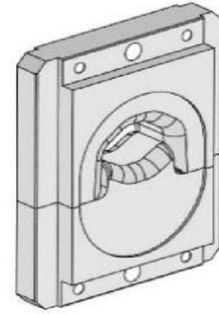

Documents and Resources

Tooling Specifications

[192890800-000.pdf](#)

Product Environment Compliance

Compliance

GADSL/IMDS	Not Relevant
China RoHS	Not Relevant
EU ELV	Not Relevant
Low-Halogen Status	Not Relevant
REACH SVHC	Not Contained per D(2025)7771-DC (04 Feb 2026)
EU RoHS	Compliant per EU 2015/863

Compliance Statements

- EU RoHS
- REACH SVHC
- Low-Halogen

Industry Documents

- IPC 1752A Class C
- IPC 1752A Class D
- Molex Product Compliance Declaration
- IEC-62474
- chemSHERPA (xml)

Substances of Interest

- PFAS

EU RoHS Certificate of Compliance

Part Details

General

Status	Active
Category	Applicators and Crimp Modules
Series	207129
Description	DIN-Style Die Set for Coeur CST High-Current Female Crimp Terminal, 1/0 AWG
Comments	See Tooling Specification (PDF) Above
Function	Crimp
Geographic Area	Global
Level of Automation	Manual
More Detailed Tech Information	toolingsupport@molex.com
Product Name	Coeur CST
Tool Type	Crimp Module
UPC	191130979226
Warranty Disclaimer	CAUTION: Molex tooling crimp specifications are valid only when used with Molex terminals and tooling manufactured by Molex and sold by Molex or authorized distributors ("Molex Tooling"). When using tooling other than Molex Tooling with Molex specific connector systems listed in our ATS documents, the Molex tooling qualification does not apply and the responsibility for full qualification of the connector system is that of the customer. Molex accepts no liability for connector performance or tooling support where tooling other than Molex Tooling is used or where Molex Tooling is modified.

Mates With / Use With

Use with Part(s)

Description	Part Number
Crimp Adapter For DIN Style Dies in Molex Pneumatic Universal Crimp Machine	<u>638018901</u>
Power Crimp Head for Din Style Crimp Dies	<u>638161100</u>

Applicable Parts

Description	Part Number
PowerWize 8.00mm Copper Alloy Crimp Socket, 1/0 AWG, Tray	<u>2046080001</u>

This document was generated on Apr 14, 2026