

NOTES:

- 1. TERMINAL TO BE USED IN HOUSINGS 70066-**** AND 70450-****
- 2. REFER TO PRODUCT SPECIFICATION PS-71851
- 3. REFER TO MOLEX OPERATIONS AND SERVICE MANUAL FOR CRIMP DETAILS
- 4. TERMINAL TO BE USED WITH (0.64)/.025 SQUARE PINS
- 5. TERMINAL TO BE USED WITH 24-30 AWG STRANDED WIRE WITH (1.52)/.060 MAX. DIA. INSULATION
- 6. TERMINALS SUPPLIED LOOSE PER DRAWING PK-70873-0822

PLATING:

.000150 MINIMUM TIN PLATE
OVER NICKEL PLATE.

*THE PRIMARY SHIPPING CARTON WILL BE LABELED "COMPLIANT TO
RoHS DIRECTIVE 2002/95/EC AND ELV ANNEX II OF DIRECTIVE 2000/53/EC".
CARTONS WITHOUT THIS LABEL MAY CONTAIN PRODUCT WITH LEAD.

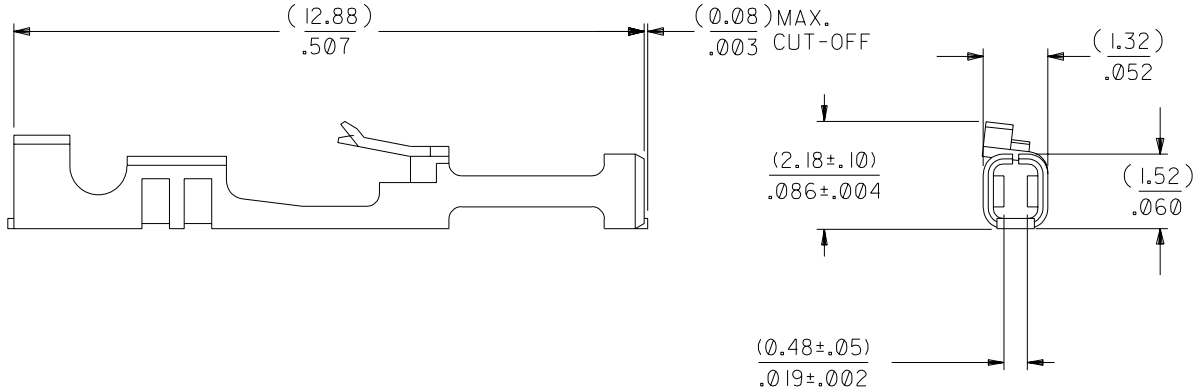
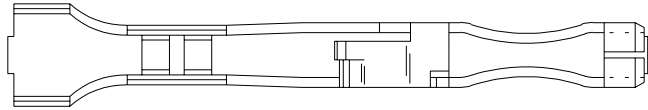

				C I	REVISED PER ECR #U70928 MCGRATH 97/06/26	DIMENSIONS SHOWN (METRIC) INCH		▽ = 0 ▼ = 0		REVISE ONLY ON CAD SYSTEM	
						UNLESS OTHERWISE SPECIFIED TOLERANCES: ANGULAR ± 1/2°		TITLE			
						INCH METRIC		TERMINAL-BOX/CRIMP HIGH FORCE CONTACT			
		D	LEAD FREE UCP2004-1769 RWHITE 04/03/24	C	164 PLATING WAS 102 PER ECR # U31149 08/17/93 REED	3 PLACE ± .010 --- 2 PLACE ± .014 ± 0.25 1 PLACE --- ± 0.35					
						DRAFT WHERE APPLICABLE MUST REMAIN WITHIN DIMENSIONS		MOLEX INCORPORATED			
								LITSE,ILL. 60532		SHEET NO. 1	DATE 03/25/88
		C2	REVISED ECR #U80270 MCGRATH 97/07/31	B	REVISE PER ECR #U80064 3/25/88 MJM	DRWG. BY MJM CHK'D. BY MJM		PART NO. 016-02-1116		DRWG. NO. SD-71851-0204	
						APP'D. BY WAZ SCALE 10: 1		FILE NAME S71851X22		THIS DRAWING CONTAINS INFORMATION THAT IS PROPRIETARY TO MOLEX INC. AND SHOULD NOT BE USED WITHOUT WRITTEN PERMISSION.	
		LTR.	REVISIONS	LTR.	REVISIONS			DIV. DA		SIZE B	