

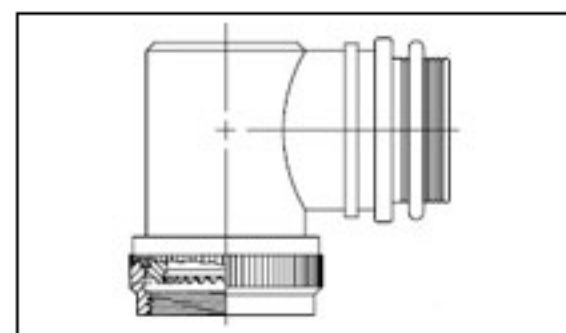

TXR40AB90-1210BI Product Details

 [Share](#)  [Print](#)  [Email](#)



TXR40AB90-1210BI

TE Internal Number: 789941-000

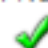
 [Active](#)

Braid, Fixed, Spin and Tinel Lock Adapters

[Not EU RoHS or ELV Compliant](#)

Product Highlights:

- Applies To Cable
- Style = Tinel Lock
- Connector Code = 40
- 90°
- Shell Size = 13, C

[View all Features](#)

Quick Links

- ▶ [Check Pricing & Availability](#)
- ▶ [Search for Tooling](#)
- ▶ [Product Feature Selector](#)
- ▶ [Contact Us About This Product](#)

 [Add to My Part List](#)  [Request Sample](#)  [Find Similar Products](#)  [Buy Product](#)

Documentation & Additional Information	
<p>Product Drawings:</p> <ul style="list-style-type: none">• Tinel-Lock Adapter (PDF, English) <p>Catalog Pages/Data Sheets:</p> <ul style="list-style-type: none">• None Available <p>Product Specifications:</p> <ul style="list-style-type: none">• None Available <p>Application Specifications:</p> <ul style="list-style-type: none">• None Available <p>Instruction Sheets:</p> <ul style="list-style-type: none">• None Available <p>CAD Files:</p> <ul style="list-style-type: none">• None Available	<p>Related Products:</p> <ul style="list-style-type: none">• Tooling
List all Documents	

Product Features (Please use the Product Drawing for all design activity)	
<p>Product Type Features:</p> <ul style="list-style-type: none">• Style = Tinel Lock• Angle = 90°• Shell Size = 13, C• Finish = Cadmium Plating over Electroless Nickel• Material = Aluminum Alloy• Color = Olive Drab <p>Electrical Characteristics:</p> <ul style="list-style-type: none">• Boot Diameter (mm [in]) = 23.49 [0.925]• Entry Diameter (mm [in]) = 15.90 [0.630]• Finish Code = B <p>Body Features:</p> <ul style="list-style-type: none">• Connector Code = 40• Entry Size = 10• Cable Diameter (Max.) (mm [in]) = 15.37 [0.605]	<p>Configuration Features:</p> <ul style="list-style-type: none">• Braid = Double 36 AWG Braid, Single 30 AWG Braid• Material Code = A <p>Industry Standards:</p> <ul style="list-style-type: none">• RoHS/ELV Compliance = Not ELV/RoHS compliant• Lead Free Solder Processes = Not relevant for lead free process <p>Conditions for Usage:</p> <ul style="list-style-type: none">• Applies To = Cable <p>Other:</p> <ul style="list-style-type: none">• Brand = Raychem