

4.5 mm Square SMD Light Touch Switches

Type: **EVQPQ**



■ Features

- External dimensions: 4.5 mm×4.5 mm, Height 0.55 mm
- Lightweight: 20 mg (1/2 compared with conventional type)

■ Recommended Applications

- Operation switches for portable electronic equipment (Camcorders, Portable audio players, etc.)

■ Explanation of Part Numbers

| | | | | | | | | |
|--------------|---|---|------|---|---|---|--------|---|
| 1 | 2 | 3 | 4 | 5 | 6 | 7 | 8 | 9 |
| E | V | Q | P | Q | | B | 5 | 5 |
| Product Code | | | Type | | | | Height | |

■ Specifications

| | | |
|-------------------------------|---------------------------------|--|
| Type | | Snap action/Push-on type SPST |
| Electrical | Rating | 10 μ A 2 Vdc to 20 mA 15 Vdc (Resistive load) |
| | Contact Resistance | 100 m Ω max. |
| | Insulation Resistance | 50 M Ω min. (at 100 Vdc) |
| | Dielectric Withstanding Voltage | 250 Vac for 1 minute |
| | Bouncing | 3 ms max. (ON) 10 ms max. (OFF) |
| Mechanical | Operating Force | 1.6 N \pm 0.5 N 2.4 N \pm 0.6 N |
| | Travel | 0.2 mm \pm 0.1 mm |
| Endurance | Operating Life | 200000 cycles min. (1.6 N), 50000 cycles min. (2.4 N) |
| Operating Temperature | | -20 $^{\circ}$ C to +70 $^{\circ}$ C |
| Storage Temperature | | -40 $^{\circ}$ C to +85 $^{\circ}$ C (Bulk) -20 $^{\circ}$ C to +60 $^{\circ}$ C (Taping) |
| Minimum Quantity/Packing Unit | | 10000 pcs. Embossed Taping (Reel Pack) |
| Quantity/Cartron | | 50000 pcs. |

Note: Non washable

Design and specifications are each subject to change without notice. Ask factory for the current technical specifications before purchase and/or use.
Should a safety concern arise regarding this product, please be sure to contact us immediately.

■ Dimensions in mm (not to scale)

EVQPQ

(Embossed Taping)

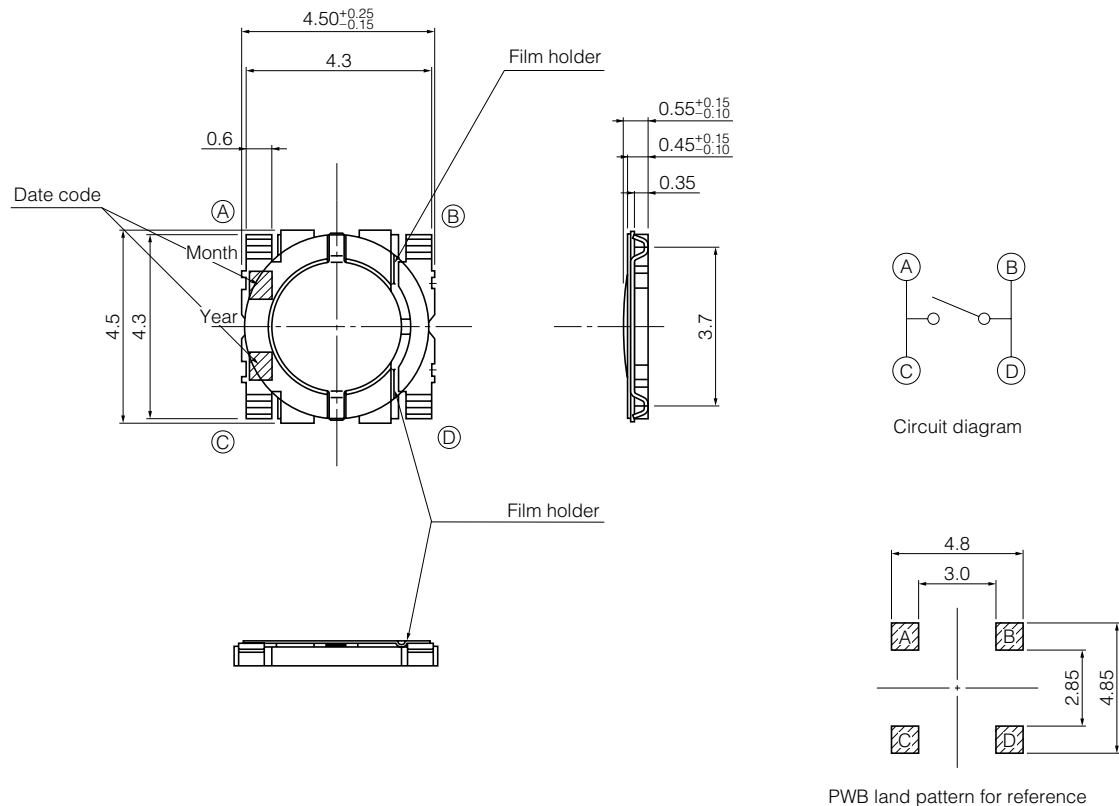

| | | | |
|--------------|-----------------|---------|----------------|
| Part Numbers | Operating Force | Height | Operating Life |
| EVQPQHB55 | 1.6 N | 0.55 mm | 200000 cycles |
| EVQPQMB55 | 2.4 N | 0.55 mm | 50000 cycles |

■ Before using this product

- If the inclination of the actuator is widened by using soft materials, such as rubber, for the setting side of the operation section (connecting area between button and actuator), it may cause functional problems.

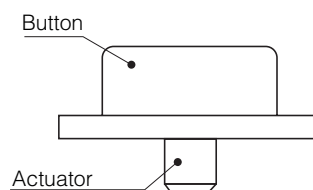

Design and specifications are each subject to change without notice. Ask factory for the current technical specifications before purchase and/or use. Should a safety concern arise regarding this product, please be sure to contact us immediately.

00 Oct. 2012

■ Recommended Reflow Soldering Conditions

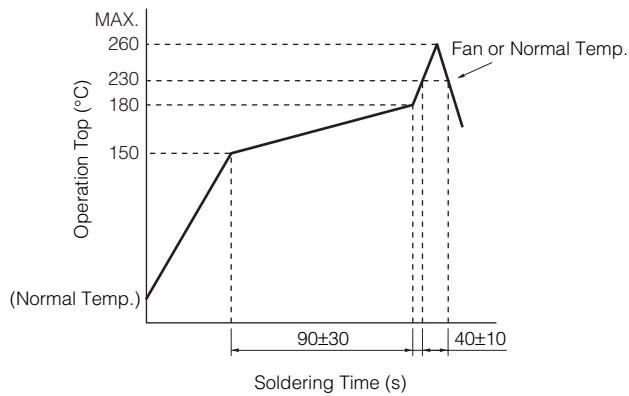

● Embossed Carrier Taping

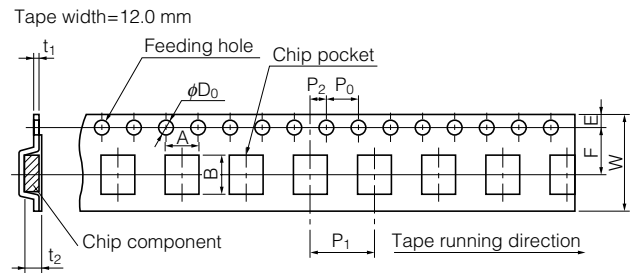

Unit: mm

| Part No. | Height | A | B | W | F | E | P ₁ | P ₂ | P ₀ | D ₀ Dia. | t ₁ | t ₂ |
|----------|--------|---------------------------------------|-----------------------------------|----------|---------|-----------|----------------|----------------|----------------|-----------------------------------|----------------|--------------------------------------|
| EVQPQ | 0.55 | 5.0 ^{+0.30} _{-0.25} | 4.6 ^{+0.3} ₋₀ | 12.0±0.1 | 5.5±0.1 | 1.75±0.10 | 8.0±0.1 | 2.0±0.1 | 4.0±0.1 | 1.5 ^{+0.1} ₋₀ | 0.30±0.05 | 0.65 ^{+0.2} _{-0.1} |

● Standard Reel Dimensions in mm (not to scale)

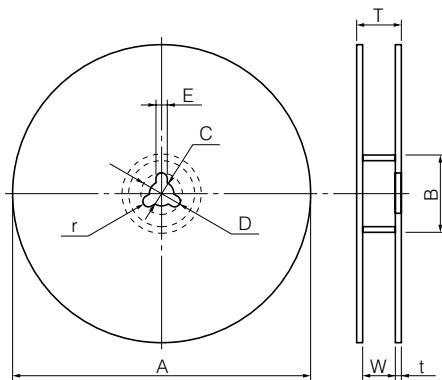

| Item | A | B | C | D | E |
|-----------|------------|------------|-----------|-----------|---------|
| Rate (mm) | φ370.0±2.0 | φ50.0 min. | φ13.0±0.5 | φ21.0±1.0 | 2.0±0.5 |

| Item | W | T | t | r |
|-----------|----------|---|------------|---------|
| Rate (mm) | 14.0±1.5 | — | 1.0 to 3.0 | 1.0±0.5 |

■ Recommended Shape of Test Pole

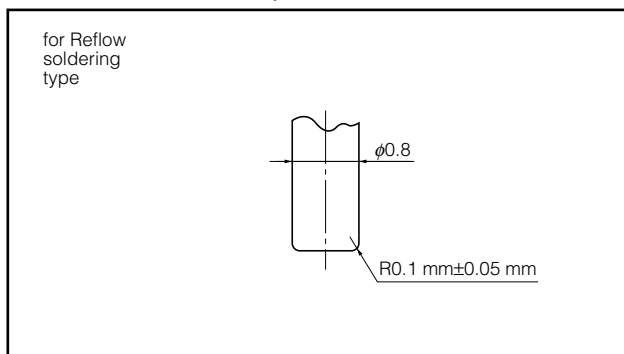

■ Recommended Operating Conditions

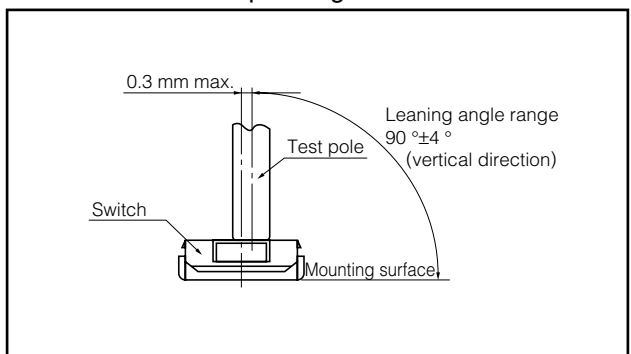

Design and specifications are each subject to change without notice. Ask factory for the current technical specifications before purchase and/or use.
Should a safety concern arise regarding this product, please be sure to contact us immediately.

00 Oct. 2012