

THIS IS ISSUED IN STRICT CONFIDENCE THAT IT IS NOT USED AS A BASIS FOR MANUFACTURE OR SALE AND THAT IT IS NOT COPIED, REPRINTED OR DISCLOSED TO A THIRD PARTY EITHER WHOLLY OR IN PART WITHOUT THE PRIOR WRITTEN CONSENT OF CAL TEST ELECTRONICS, INC.

- 4mm EXTENDED SAFETY ADAPTER.
APPLICATION: CONVERTS STANDARD 4mm JACK TO ACCEPT SHEATH BANANA PLUGS. UPGRADES JACK TO IEC SAFETY SPECIFICATIONS.
- SPECIFICATIONS:
INSULATOR: POLYACETAL
CONTACT: BRASS, NICKEL PLATED
SET SCREW: STEEL
- RATING:
VOLTAGE: 1000 V CAT I P2 (IEC 61010-031)
CURRENT: 36 A MAX.
RESISTANCE: <5 mΩ.
TEMPERATURE: -20° C TO +80° C.
- INSERT ADAPTER INTO SOCKET, TIGHTEN INTERNAL SET SCREW WITH 1.5 mm ALLEN WRENCH SUPPLIED SPERATELY (CT2919).

PART NUMBER

CT2247-#

COLOR: 0 - BLACK
2 - RED
4 - YELLOW
5 - GREEN
6 - BLUE
9 - WHITE

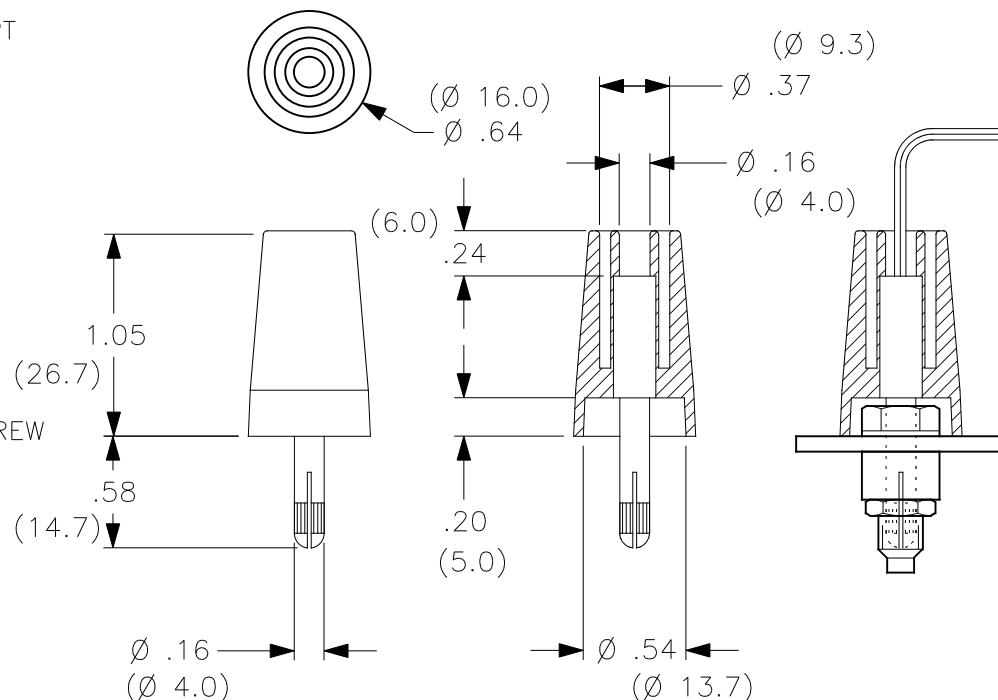

Assembly Instructions:

- Insert Safety Adapter in 4mm Banana Plug Socket. (Reference CT2228-#)
- Tighten internal Set-Screw using 1.5mm Allen Wrench (Cal Test P/N 2919).

THIRD ANGLE PROJECTION		UNLESS OTHERWISE SPECIFIED DIMENSIONS ARE IN INCHES TOLERANCES ARE: FRACTIONS DECIMALS ± 1/32 .XX ± .02 .XXX ± .005 DO NOT SCALE DRAWING		CONTRACT NO.		Cal Test Electronics 22820 Savi Ranch Parkway Yorba Linda, CA 92887-4610			
		MATERIAL		APPROVALS		DATE		TITLE 4mm EXTENDED SAFETY SOCKET ADAPTER	
		FINISH		DRAWN WDH		7/12/99			
NEXT ASSY		USED ON		CHECKED		ENGR.		SIZE A	
APPLICATION				DESIGN ACTIVITY				CAGE CODE 43F45	
								DWG. NO. P224700	
								REV. -	
								SCALE 1:1	
								SHEET 1 OF 1	