

DS Series Detect Switch



Features/Benefits

- Compact design
- Low actuation force
- Detect mechanical movement
- Left and right options
- Right angle options

Typical Applications

- Computer peripherals
- Office equipment
- Consumer electronics
- Appliances
- Audio and visual equipment

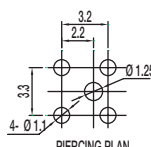
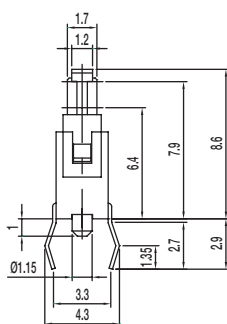
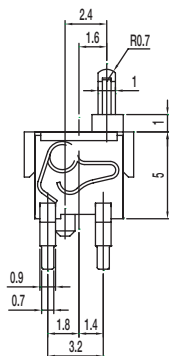
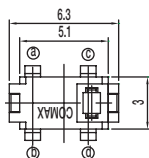

| PART NUMBER | PACKAGING | SCHEMATIC |
|-----------------|--------------|-----------|
| DS-02005 | 1,000 pieces | 1P-1T |

Specifications

CONTACT ARRANGEMENT: SPST, NO
 CONTACT RATING: 100mA @ 30 VDC
 OPERATING LIFE: 50,000 cycles
 OPERATING FORCE: 50 gf max.
 PRE-TRAVEL: 0.7 mm
 TOTAL TRAVEL: 2.6 mm
 INITIAL CONTACT RESISTANCE: 1 Ω max.
 INSULATION RESISTANCE: 100 M Ω min. @ 100 VDC 60 sec.
 DIELECTRIC STRENGTH: 100 V AC (50-60Hz) 60 sec.
 OPERATING TEMPERATURE: -40°C to +85°C.

Materials

KNOB: PA
 COVER: PA
 SPRING: Gold plated, copper alloy
 HOUSING: PA
 TERMINAL: Silver plated, copper alloy

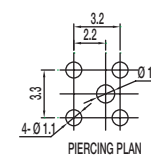
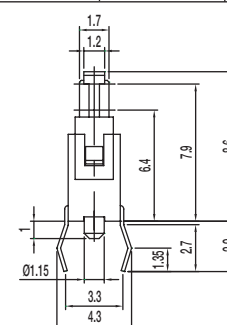
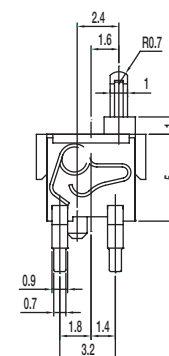
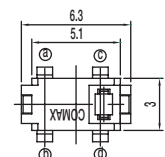

| PART NUMBER | PACKAGING | SCHEMATIC |
|----------------------|--------------|-----------|
| DS-02005 (30) | 1,000 pieces | 1P-1T |

Specifications

CONTACT ARRANGEMENT: SPST, NO
 CONTACT RATING: 100mA @ 30 VDC
 OPERATING LIFE: 50,000 cycles
 OPERATING FORCE: 30 gf max.
 PRE-TRAVEL: 0.7 mm
 TOTAL TRAVEL: 2.2 mm
 INITIAL CONTACT RESISTANCE: 1 Ω max.
 INSULATION RESISTANCE: 100 M Ω min. @ 100 VDC 60 sec.
 DIELECTRIC STRENGTH: 100 V AC (50-60Hz) 60 sec.
 OPERATING TEMPERATURE: -40°C to +85°C.

Materials

KNOB: PA
 COVER: PA
 SPRING: Gold plated, copper alloy
 HOUSING: PA
 TERMINAL: Silver plated, copper alloy

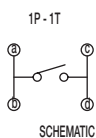



| PART NUMBER | PACKAGING | SCHEMATIC |
|------------------|--------------|-------------------|
| DS-040-02 | 1,000 pieces | 1P-1T N.O. |

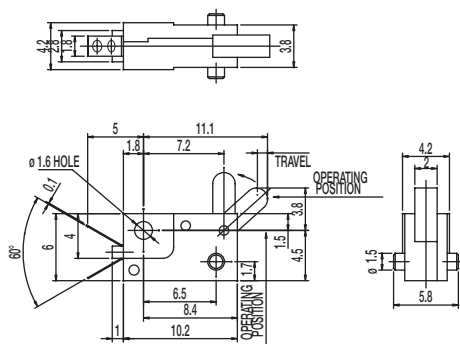

Specifications

CONTACT ARRANGEMENT: SPST, NO
 CONTACT RATING: 0.1A @ 16 VDC
 OPERATING LIFE: 20,000 cycles
 OPERATING FORCE: 30 ± 15 gf
 TRAVEL: 0.90 ± 0.20 mm
 INITIAL CONTACT RESISTANCE: 40 m Ω max.
 INSULATION RESISTANCE: 100 M Ω min. @ 250 VDC 60 sec.
 DIELECTRIC STRENGTH: 250 V AC (50-60Hz) 60 sec.
 OPERATING TEMPERATURE: -20°C to +70°C.

Materials

LEVER: POM
 CASE: PBT
 COVER: PC

| PART NUMBER | PACKAGING | SCHEMATIC |
|------------------|-------------|---------------------|
| DS-180 RT | 3000 pieces | 1P - 1T N.O. |

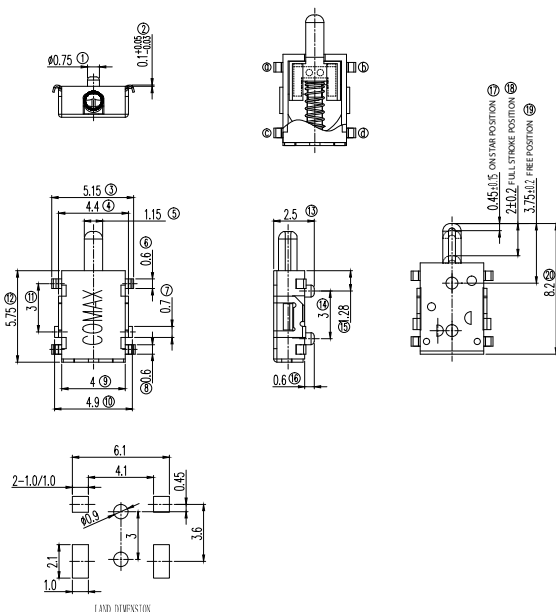

Specifications

CONTACT ARRANGEMENT: SPST NO
 CONTACT RATING: 1mA @ 5 VDC
 OPERATING LIFE: 50,000 cycles
 OPERATING FORCE: 60 gf max.
 TOTAL TRAVEL: 2.0±0.2 mm
 INITIAL CONTACT RESISTANCE: 5Ω max.
 INSULATION RESISTANCE: 100 M Ω min. @ 100 VDC 60 sec.
 DIELECTRIC STRENGTH: 100 V AC (50-60Hz) 60 sec.
 OPERATING TEMPERATURE: -40°C to +85°C.

Materials

KNOB: PA
 COVER: SPTE
 SPRING: SUS
 HOUSING: LCP
 TERMINAL: Silver plated



Detect

DS Series Detect Switch



| PART NUMBER | PACKAGING | SCHEMATIC |
|---------------|--------------|-------------|
| DS-080 | 1,000 pieces | 1P - 2T |

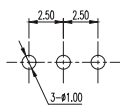
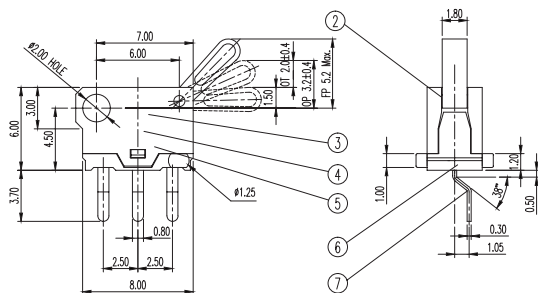

PIERCING PLAN

Specifications

CONTACT ARRANGEMENT: SPDT
 CONTACT RATING: 100mA @ 30 VDC
 OPERATING LIFE: 20,000 cycles
 OPERATING FORCE: 30 ± 20 gf
 OVER TRAVEL: 2.0 ± 0.40 mm
 INITIAL CONTACT RESISTANCE: 200 m Ω max.
 INSULATION RESISTANCE: 10 M Ω min. @ 250 VDC 60 sec.
 DIELECTRIC STRENGTH: 250 V AC (50-60Hz) 60 sec.
 OPERATING TEMPERATURE: -20°C to +70°C.

Materials

KNOB: POM
 COVER: PA46
 SLIDER: PBT
 HOUSING: PA46
 TERMINAL: Silver plated



| PART NUMBER | PACKAGING | SCHEMATIC |
|--------------------|--------------|-------------|
| DS-080-C PA | 1,000 pieces | 1P - 2T |

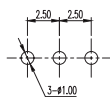
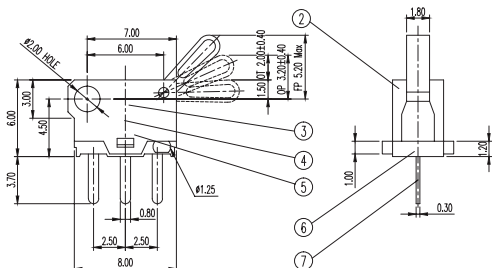

PIERCING PLAN

Specifications

CONTACT ARRANGEMENT: SPDT
 CONTACT RATING: 100mA @ 30 VDC
 OPERATING LIFE: 20,000 cycles
 OPERATING FORCE: 30 ± 20 gf
 OVER TRAVEL: 2.0 ± 0.40 mm
 INITIAL CONTACT RESISTANCE: 200 m Ω max.
 INSULATION RESISTANCE: 10 M Ω min. @ 250 VDC 60 sec.
 DIELECTRIC STRENGTH: 250 V AC (50-60Hz) 60 sec.
 OPERATING TEMPERATURE: -20°C to +70°C.

Materials

KNOB: POM
 COVER: PA46
 SLIDER: PBT
 HOUSING: PA46
 TERMINAL: Silver plated



E

Detect



| PART NUMBER | PACKAGING | SCHEMATIC |
|-----------------------|------------|-----------|
| DS-09005-02 RP | 500 pieces | |

Specifications

CONTACT ARRANGEMENT: SPST

CONTACT RATING: 1mA @ 5 VDC

OPERATING LIFE: 100,000 cycles

OPERATING FORCE: 50 gf max.

TOTAL TRAVEL: 4.5±0.2 mm

INITIAL CONTACT RESISTANCE: 500 m Ω max.

INSULATION RESISTANCE: 100 M Ω min. @ 500 VDC 60 sec.

DIELECTRIC STRENGTH: 500 V AC (50-60Hz) 60 sec.

OPERATING TEMPERATURE: -20°C to +70°C.

Materials

LEVER: POM

COVER: PA

HOUSING: PA

TERMINAL: Silver plated

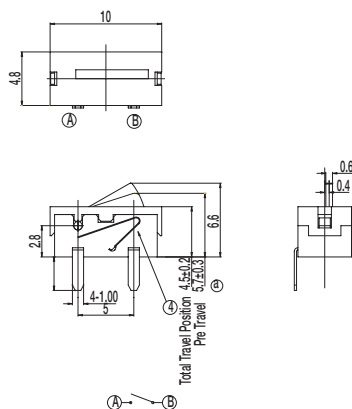

Detect