

PRODUCT NUMBER
98416-XXX-XX-XXXLF

PLATING _____ RoHS COMPATIBLE, SEE NOTE 8

S = 0.38µm GOLD/GXT
ON CONTACT AREA
3.81µm TIN LEAD
ON TAIL

G = 0.76µm GOLD/GXT
ON CONTACT AREA
3.81µm TIN LEAD
ON TAIL

F = GOLD FASH
ON CONTACT AREA
3.81µm TIN LEAD
ON TAIL

POLARIZATION, SEE NOTE 7
PACKAGING, SEE NOTE 5
TOTAL NB OF POS, 04 UP TO 50
ONLY 16 POS TOOLED.
COLOR OPTION NOTE 1

PIN STYLE	TAIL LENGTH
04	2.00
06	2.50
08	3.10
10	3.70

NOTES:

1. MATERIAL HOUSING: HIGH TEMP. THERMOPLASTIC UL-94VO
- = STANDARD COLOR CREAM
B = OPTIONAL COLOR BLACK

2. MATERIAL TERMINAL: COPPER ALLOY

3. TO DETERMINE DIMENSIONS:
N = NUMBER OF POSITIONS PER ROW

4. 7N MIN. PIN RETENTION IN EITHER DIRECTION.

5. PACKAGING:

= PLASTIC BOX
- = PLASTIC BOX WHEN POLARISATION FEATURE APPLICABLE
U = TUBE AVAILABLE FROM 06 TO 50 POS

6. DIM "C" = $(N \times 2) + 1.4$
EXAMPLE: N = 7
DIM "C" = $(7 \times 2) + 1.4 = 15.4$ mm

7. FOR POLARIZATION, SPECIFIED PIN
EXAMPLE : A03 = ROW A, POSITION 03 TO OMIT PIN
OMIT FROM PRODUCT NUMBER IF THIS FEATURE IS NOT APPLICABLE.

8. RoHS COMPATIBLE PRODUCT SPECIFICATIONS

a - PLATING:

- "LF" MEANS THE PRODUCT IS LEAD-FREE,
2µm MINIMUM MATTE TIN OVER 1.27µm
MINIMUM NICKEL UNDERPLATE.

b - MANUFACTURING PROCESS COMPATIBILITY

- THE HOUSING WILL WITHSTAND EXPOSURE TO
260°C ±5°C SOLDER BATH TEMPERATURE FOR
5 SECONDS IN A WAVE SOLDER APPLICATION
WITH A 1.6mm MIN THICK CIRCUIT BOARD.

c - LABELLING:

- MEETS PACKAGING SPECS AS PER GS-14-920

d - THIS PRODUCT MEETS EUROPEAN DIRECTIVES
AND OTHER COUNTRY REGULATIONS AS DISCRIBED
IN GS-47-0004.

INDICATES POS 1

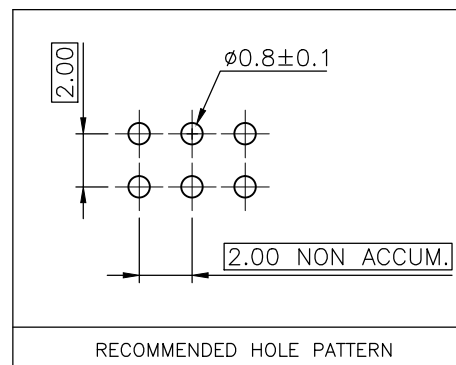
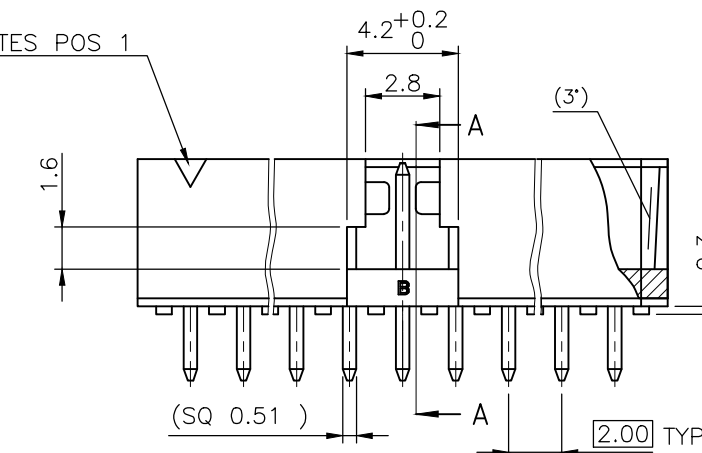

DIM "C" $+0.2$
0
SEE NOTE 6

$(N-1) \times 2$
SEE NOTE 3

$((N+1) \times 2)$
SEE NOTE 3

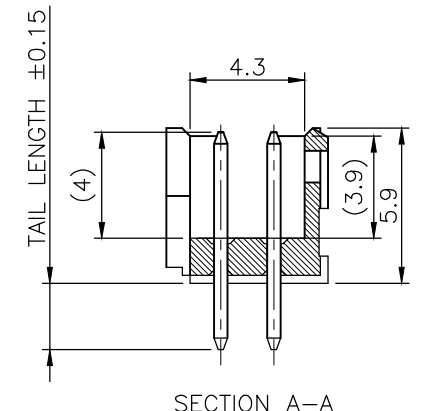
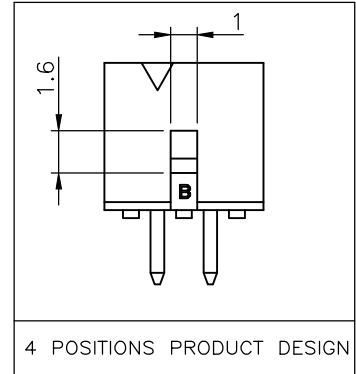

mat'l. code SEE NOTES				surface ISO 1302 ✓	tolerance ISO 406 ISO 101	projection 101	product family MINITEK	
ltr	ecn	no	dr	date	tolerances unless otherwise specified		title	
A			AMA	14.12.11	angles	X.X ±0.3	SHR HEADER	
B	B-20254	LMU	15.02.16		linear	X.XX ±0.13 X.XXX ±0.05	2.0MM, HIGH END WALLS	
				dr	L.MULIN	11.05.19	dwg no	
				engr	J.COMPAGNON	11.05.19	sheet 1 of 2	
				chr	JCO	11.05.20	98416	
				appd	JCO	11.12.02	A3	
						scale 1:1	type	
							CUSTOMER Drawing	
sheet index	revision sheet	B	B	1	2			

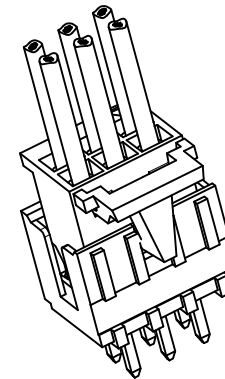
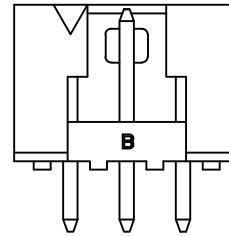
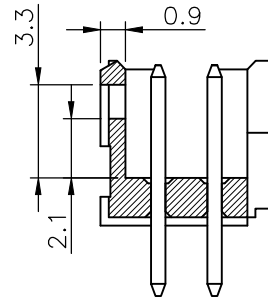
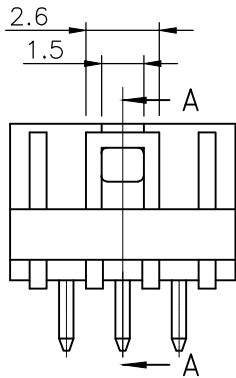

2x3 POS AND 2x4 POS CONFIGURATION
NO LATCHING AVAILABLE FOR 2x2 POS

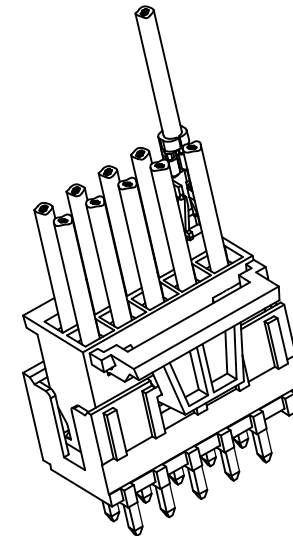
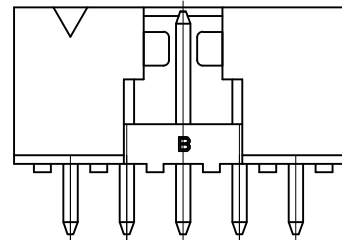
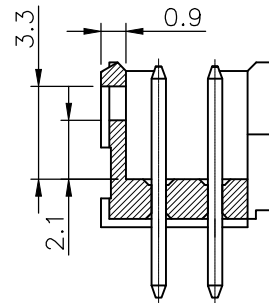
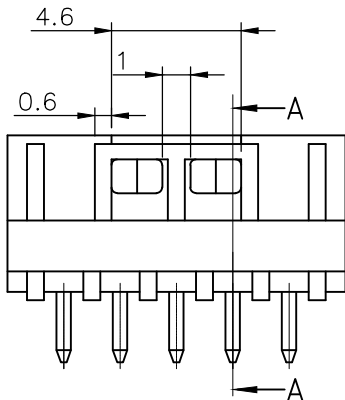

2x5 POS UP TO 2x25 POS CONFIGURATION

LATCHING FEATURES WHEN USED IN COMBINATION
WITH ACTIVE LATCH HOUSING 10073599

mat'l. code SEE NOTES				surface ISO 1302	tolerance ISO 406	projection ISO 101	product family MINITEK
ltr	ecr no	dr	date	tolerances unless otherwise specified			title
A		AMA	14.12.11	angles	X.X ±0.3	mm	SHR HEADER
B	B-20254	LMU	15.02.16	linear	X.XX ±0.13		2.0MM, HIGH END WALLS
					X.XXX ±0.05	scale 1:1	dwg no
				dr	L.MULIN	11.05.19	sheet 2 of - size
				engr	J.COMPAGNON	11.05.19	98416
				chr	JCO	11.05.20	A3
				appd	JCO	11.12.02	type
sheet	revision						CUSTOMER Drawing
index	sheet						

