

RAFIX 22 FS<sup>+</sup>, signal indicator, flat bezel, round collar, bezel green

Description



Flat variants can be labelled on request. The illumination status of the high variants is also clearly visible from the side.



technical data

> general

Disassembly possible	no
Bezel color	green
Property of bezel / mushroom	translucent
Collar shape	round
Operating temperature, min.	-25 °C
Operating temperature, max.	70 °C
Storage temperature, min.	-40 °C
Storage temperature, max.	80 °C
illuminated	Yes
Packaging	Box
Packaging unit	10 pcs.
net weight	6.8 g
Degree of protection, front side, according to DIN EN 60529	IP65
UL Enclosure Type Rating front side	type 1 type 4X indoor
Environment resistance	IEC 60068-2-14 IEC 60068-2-30 IEC 60068-2-33 IEC 60068-2-78
Salt-spray resistance according to standard	IEC 60068-2-11
Minimum order quantity (MOQ)	10 pcs.
RoHS compliant	Yes
REACH compliant	Yes
country of origin	HU

direct links

> [RAFI eCatalog](#)

> mounting diameters

Outside dimension, length	29.8 mm
Outside dimension, width	29.8 mm
Outside dimension, height	20.8 mm
Mounting hole	22.3 mm
Mounting depth	9.2 mm
Installation height	9.7 mm

Grid, min.	30 x 30 mm
------------	------------

Collar dimension	ø 29,8 mm
------------------	-----------

**> mechanical data**

Fixing	Threaded ring
--------	---------------

Threaded ring torque, max.	1.2 Nm
----------------------------	--------

**> Specifications according to UL 60947**

UL Enclosure Type Rating front	type 1
--------------------------------	--------

side	type 4X indoor
------	----------------

**Use according to UL:**

---

RAFIX control devices are defined at RAFI as modular elements, consisting of an actuating element, if necessary a coupling and an individual contact or lighting unit.

Actuating elements (such as pushbuttons, emergency stop actuators, etc.) have the intended tactility, reset and function only when assembled with the appropriate switching elements.

## drawings

### Dimensioned drawing

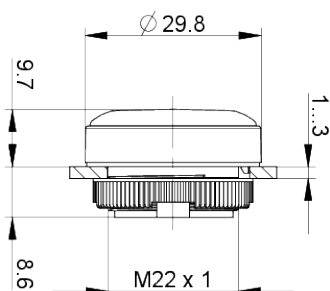

### System drawing

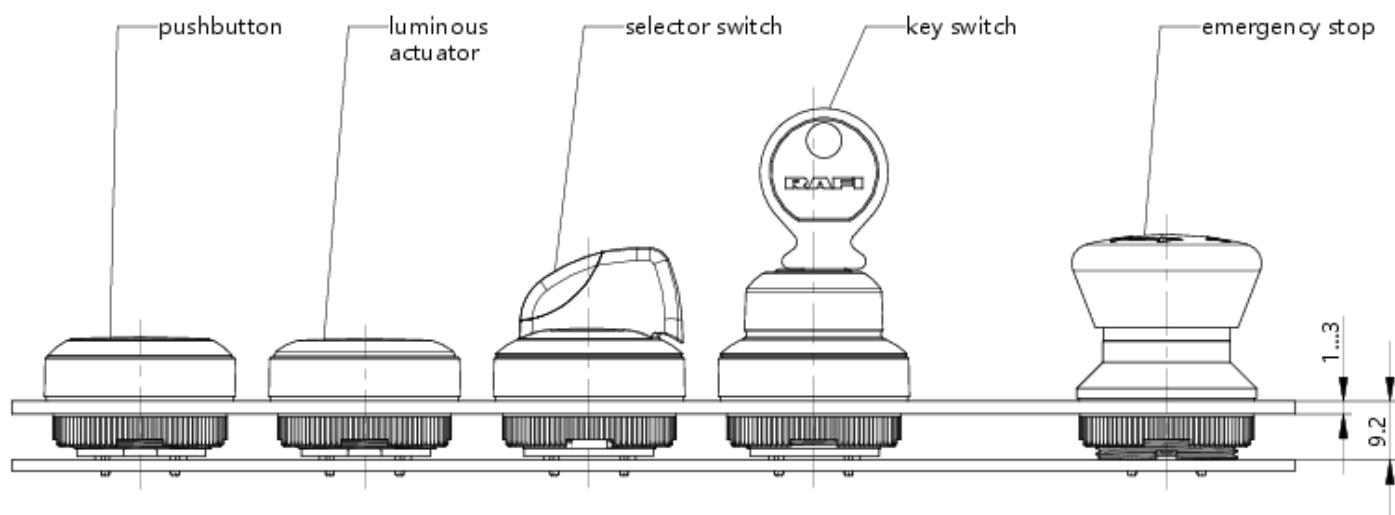

## System drawing



## Mounting hole drawing



acc. to IEC 60947-5-1

## front panel drawing

