

PRODUCT NUMBER	PITCH
VFxx70x000J0G	5.00 mm

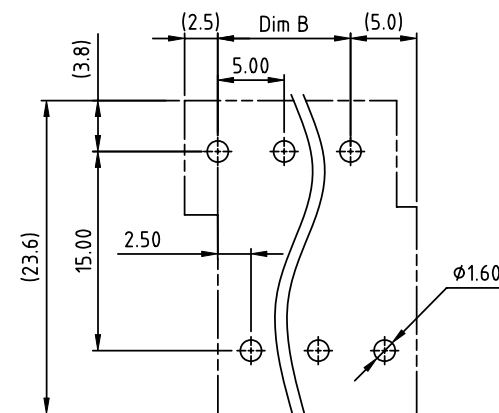
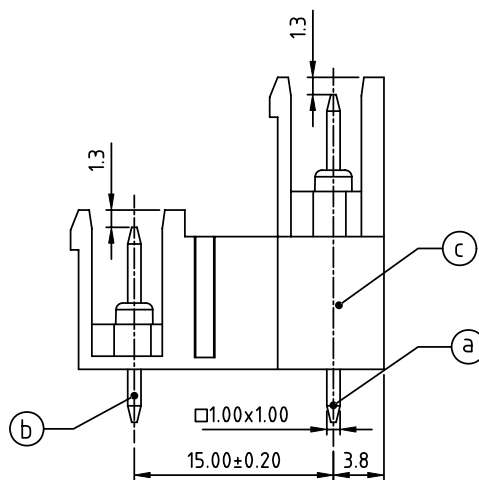
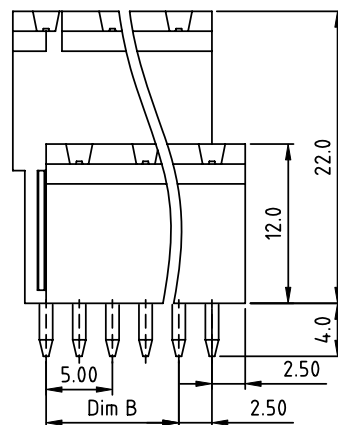
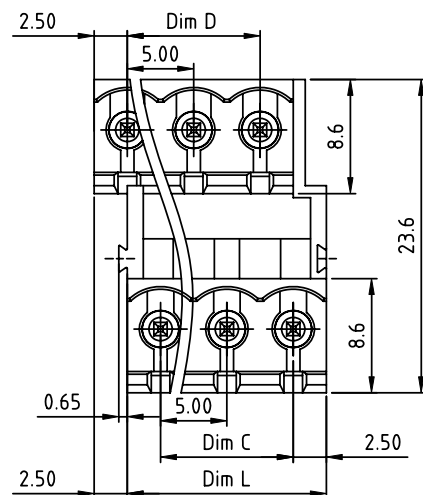

RECOMMENDED P.C.B LAYOUT
TOP VIEW

Material:

- Item (a) Short pin: Copper, Tin plated
- Item (b) Long pin: Copper, Tin plated
- Item (c) Terminal (housing): Thermoplastic (UL94V-0)

Electrical cULus

- Voltage rating: 300VAC
- Current rating: 10A
- Withstanding Voltage: 1.6KV
- Operating temperature: -40°C to +115°C
- Soldering temperature: 260°C±5°C/5 Sec
- Safety Approval: cULus

PART NO.: VF xx 70 x 0 00J0 G

N=Number of poles

Dimension	
Dim L	N/2×5.0
Dim B	(N/2-1)×5.0
Dim C	(N/2-1)×5.0
Dim D	(N/2-1)×5.0

Poles	Tolerance
2×2P-2×5P	±0.15
2×6P-2×10P	±0.20
2×11P-2×15P	±0.25
2×16P-2×20P	±0.30
2×21P-2×24P	±0.35

Solid block	No. of poles	Color	RoHS compliant (lead<4%) In copper Alloy
0	Black (RAL9005)		
2	Red (RAL3001/D)		
04	2x2poles	3 Orange(RAL2011/P)	
06	2x3poles	4 Yellow(RAL1018/A)	
...	...	5 Green(RAL6018/T)	
48	2x24poles	6 Blue (RAL5015/A)	
		8 Grey(RAL7035/D)	
		9 White(RAL1102)	
		C Green(RAL6018/U)	

mat'l. code				surface ASME Y14.5	tolerance ASME Y14.5	projection	product family			
ltr	ecn	no	dr	date	tolerances unless otherwise specified	MM	TERMINAL BLOCK			
					angles		title			
					tolerances		TERMINAL BLOCK			
					dr		PLUGGABLE SOCKET, OPEN TYPE, VERTICAL			
					engr		dwg no			
					chr		VFxx70x000J0G			
					appd		type			
sheet index	revision	A					CUSTOMER Drawing			
	sheet	1								