

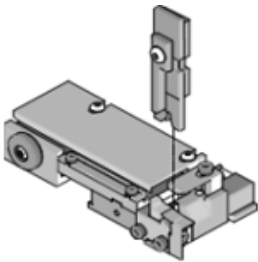

Part Number : [690011027](#)  
Product Description : TM-40/TM-42 Applicator  
Series Number : 207126  
Status : Obsolete  
Product Category : Applicators and Crimp Modules



Documents & Resources

Tooling Specifications  
[SD-69001-1027-001.pdf](#)

Product Environment Compliance

Compliance

|                    |              |
|--------------------|--------------|
| China RoHS         | Not Reviewed |
| EU ELV             | Not Reviewed |
| Low-Halogen Status | Not Reviewed |
| REACH SVHC         | Not Reviewed |
| EU RoHS            | Not Reviewed |

Multiple Part Product Compliance Statements

- Eu RoHS
- REACH SVHC
- Low-Halogen

Multiple Part Industry Compliance Documents

- IPC 1752A Class C
- IPC 1752A Class D
- Molex Product Compliance Declaration
- IEC-62474
- chemSHERPA (xml)

EU RoHS Certificate of Compliance

Part Details

General

|        |          |
|--------|----------|
| Status | Obsolete |
|--------|----------|

|                                |  |
|--------------------------------|--|
| Category                       | Applicators and Crimp Modules  |
| Series                         | 207126   |
| Description                    | TM-40/TM-42 Applicator   |
| Function                       | Crimp  |
| Geographic Area                | Global   |
| Level of Automation            | Semi-Automatic   |
| More Detailed Tech Information | toolingsupport@molex.com   |
| Product Name                   | N/A  |
| Tool Type                      | Applicator   |
| UPC                            | 800754359948   |
| Warranty Disclaimer            | <p>CAUTION: Molex tooling crimp specifications are valid only when used with Molex terminals and tooling manufactured by Molex and sold by Molex or authorized distributors ("Molex Tooling"). When using tooling other than Molex Tooling with Molex specific connector systems listed in our ATS documents, the Molex tooling qualification does not apply and the responsibility for full qualification of the connector system is that of the customer. Molex accepts no liability for connector performance or tooling support where tooling other than Molex Tooling is used or where Molex Tooling is modified.</p> |

---

This document was generated on Feb 10, 2025