

REVISIONS			
REV	DESCRIPTION, ECN, EAR NO.	DATE	APP'D
A	PROPOSAL DRAWING	AUG19/19	S.M
B	MODIFIED INTERNAL CAVITY	AUG22/19	S.M

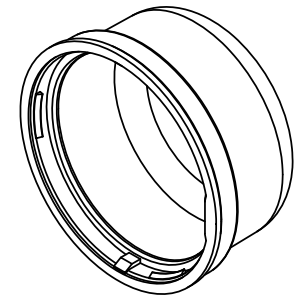

NAMING SYSTEM FLS - C40 - XX X -000

HEIGHT "H"

XX	"H"	"Y"
25	25 mm	16.0 mm
40	40 mm	31.0 mm

COLOUR

1 - GREY  
2 - CLEAR

NOTES:  
MATERIALS:  
HOUSING: POLYCARBONATE, UL 94-5V A RATED  
COLOR: AS PER PART NUMBERING SYSTEM

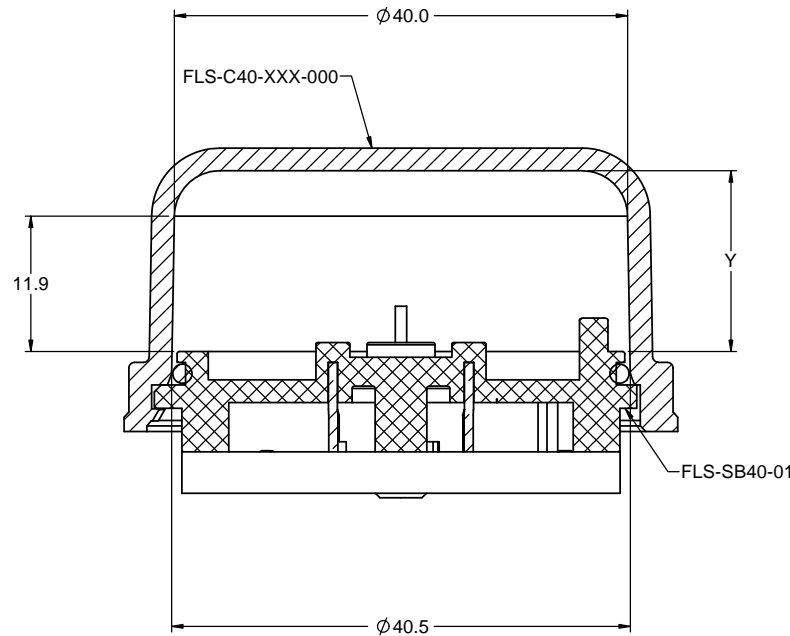
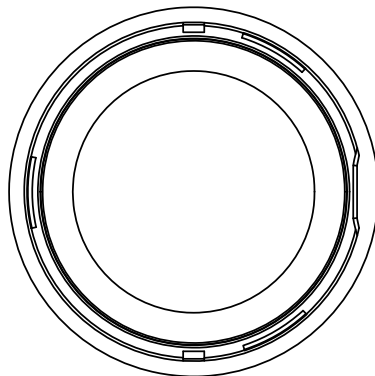
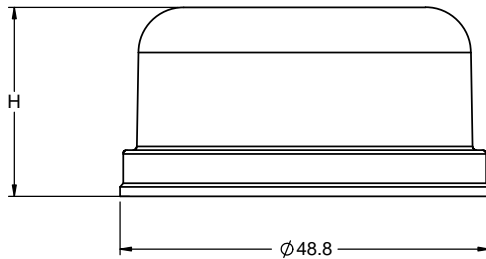

AMPHENOL PART NUMBER: FLS-C40-XXX-000

UNLESS SPECIFIED OTHERWISE		DRAWN	I.NELSON	JUL31/19	<b>Amphenol Canada Corp.</b> Commercial Products <b>FLS SERIES</b> <b>DOME COVER 40 mm DIA</b> <b>MULTIPLE HEIGHTS</b> <b>RoHS COMPLIANT</b>	REV <b>B</b>
PRIMARY UNITS	MILLIMETERS	CHECKED	S.MUGAN	AUG19/19		
SECONDARY		M.E. APP'D				
REFERENCE IN PARENTHESES		Q.A. APP'D				
GENERAL TOLERANCES		DWG APPR.			<b>P-FLS-C40-XXX-000</b>	REV <b>B</b>
1 DECIMAL PLACE	± 0.2	ENG. REL. NO.				
2 DECIMAL PLACES		REF.				
3 DECIMAL PLACES		THIRD ANGLE PROJECTION				
ANGULAR DEGREES		DO NOT SCALE DRAWING			CODE ID NO. <b>03554</b>   DWG SIZE: <b>X</b>   SCALE: <b>2:1</b>   SHEET <b>1 OF 1</b>	

THIS DOCUMENT CONTAINS PROPRIETARY INFORMATION AND SUCH INFORMATION MAY NOT BE DISCLOSED TO OTHERS FOR ANY PURPOSE OR USED FOR MANUFACTURING PURPOSES WITHOUT WRITTEN PERMISSION FROM AMPHENOL CANADA CORP.