

THE INFORMATION CONTAINED IN THIS DRAWING IS THE SOLE PROPERTY OF
BUD INDUSTRIES INC. ANY REPRODUCTION IN PART OR WHOLE WITHOUT
THE WRITTEN PERMISSION OF BUD INDUSTRIES INC. IS PROHIBITED.

DWG. NO. SNC-3757	
ISSUE	REVISIONS
(A)	REVISED DESIGN 6-30-08 DAB
(B)	PER ECN #10404 12-4-08 DAB
(C)	PER ECN #10446 1-13-09 BT

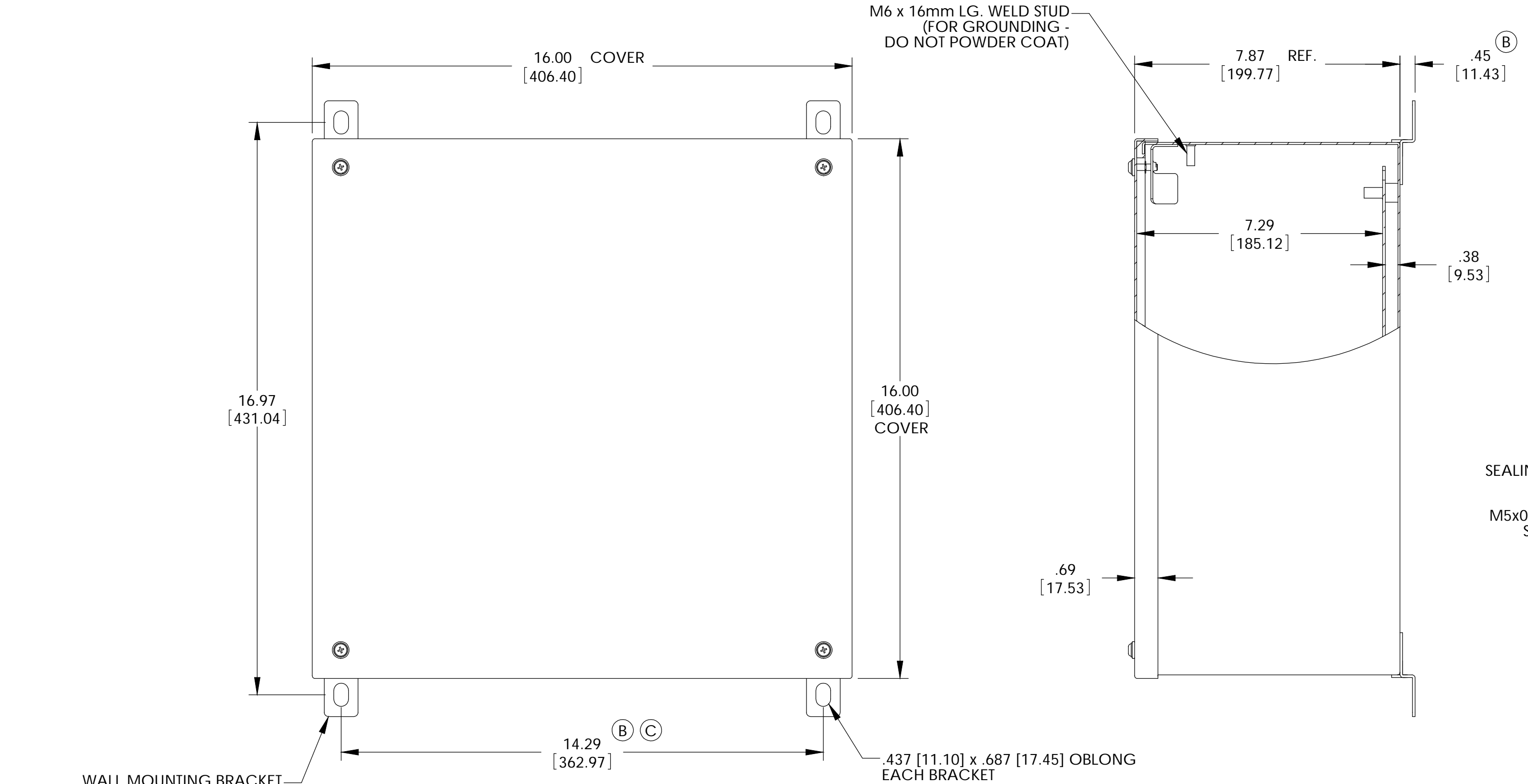

WALL MOUNTING BRACKET
KIT TO CONTAIN THE FOLLOWING:
(4) BRACKETS, (4) BOLTS, (4) SEALING
WASHERS, (4) FLAT WASHERS,
(4) LOCKWASHERS & (4) HEX NUTS

MATERIAL: BODY, COVER MOUNTING BRACKETS, COVER - 16 GA. [1.5mm] C.R.S.
INTERNAL PANEL - 14 GA. [2.0mm] C.R.S.
WALL MOUNTING BRACKETS - 14 GA. [2.0mm] STAINLESS STEEL
HARDWARE - STAINLESS STEEL
GASKET - .25 [6.35] THICK NEOPRENE (BLACK) OR EQUIVALENT
SEALING WASHERS - BLACK NEOPRENE OR EQUIVALENT

FINISH:
BODY & COVER - LIGHT GRAY SMOOTH POWDER COAT
INTERNAL PANEL - ZINC CHROMATE
WALL MOUNTING BRACKETS - NATURAL

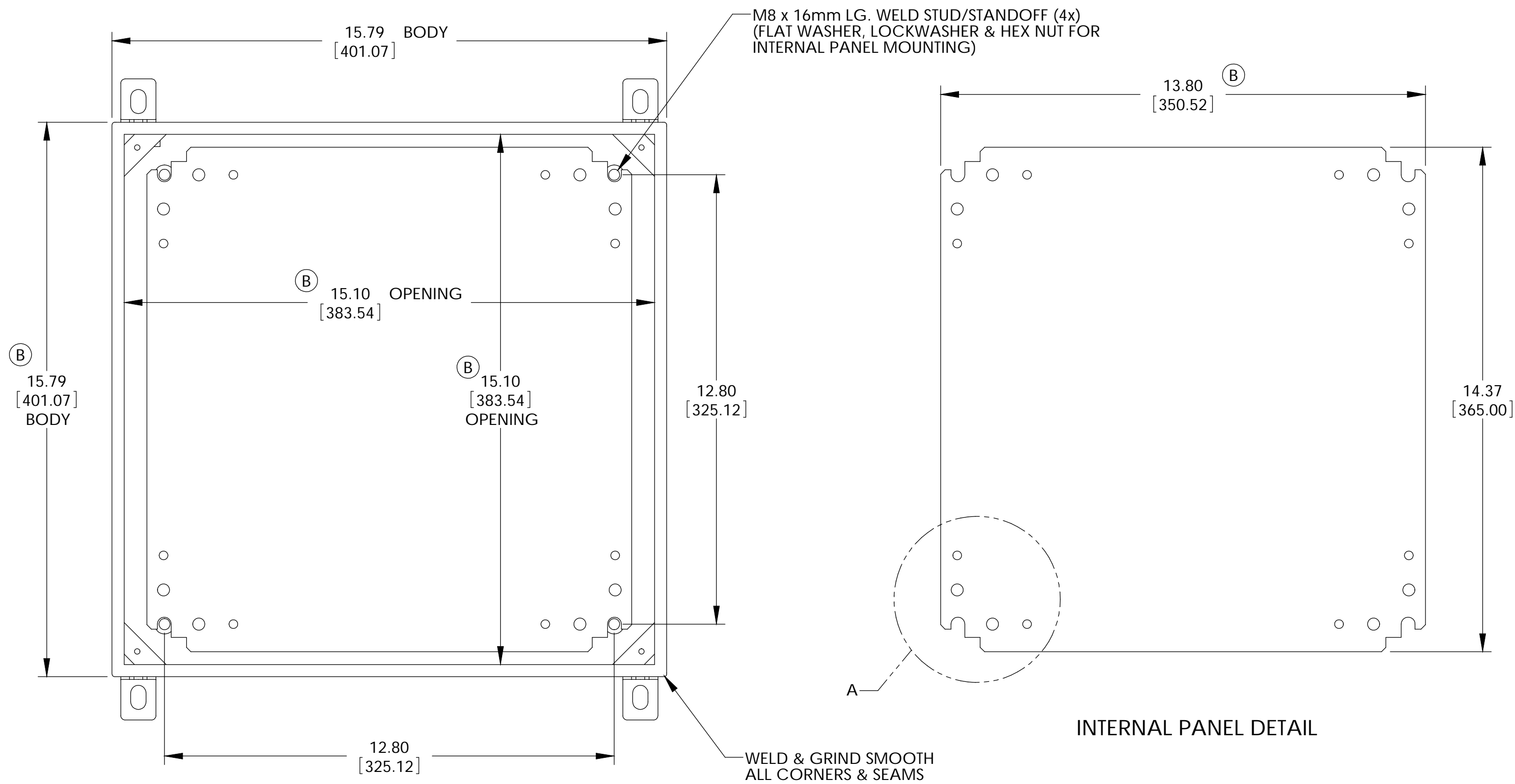
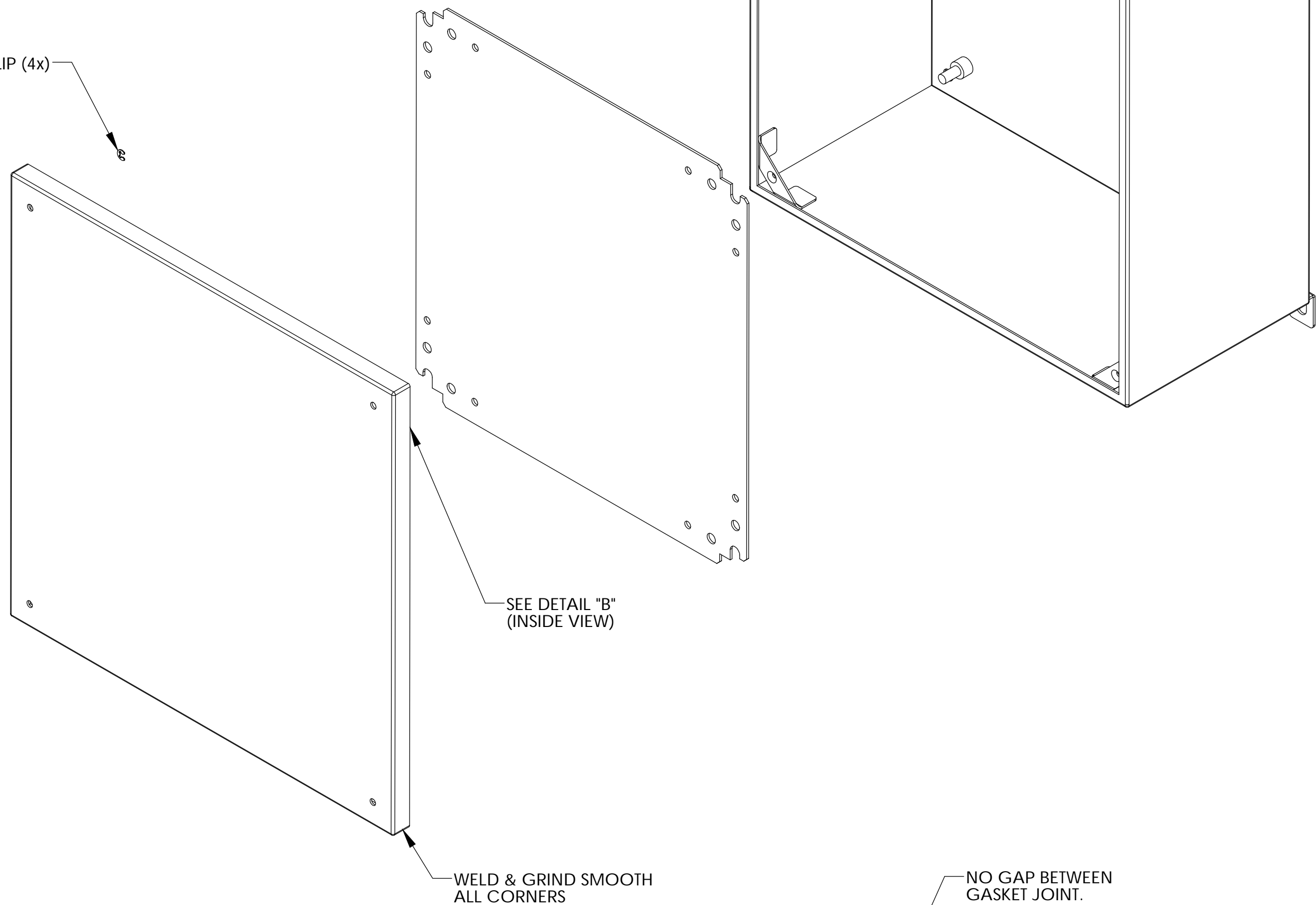
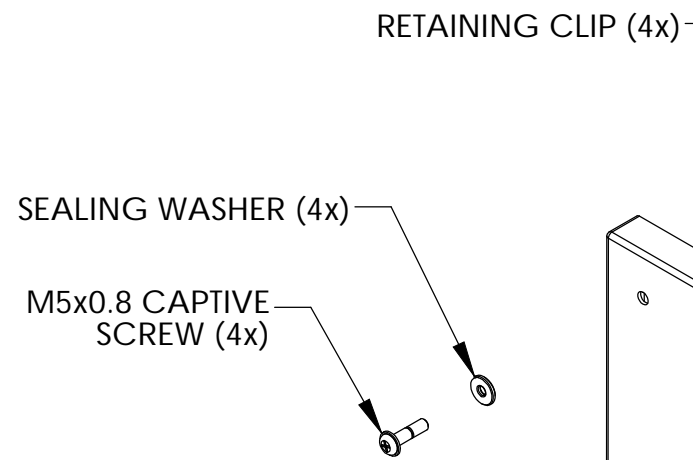

FRONT VIEW (LESS COVER)

INTERNAL PANEL DETAIL

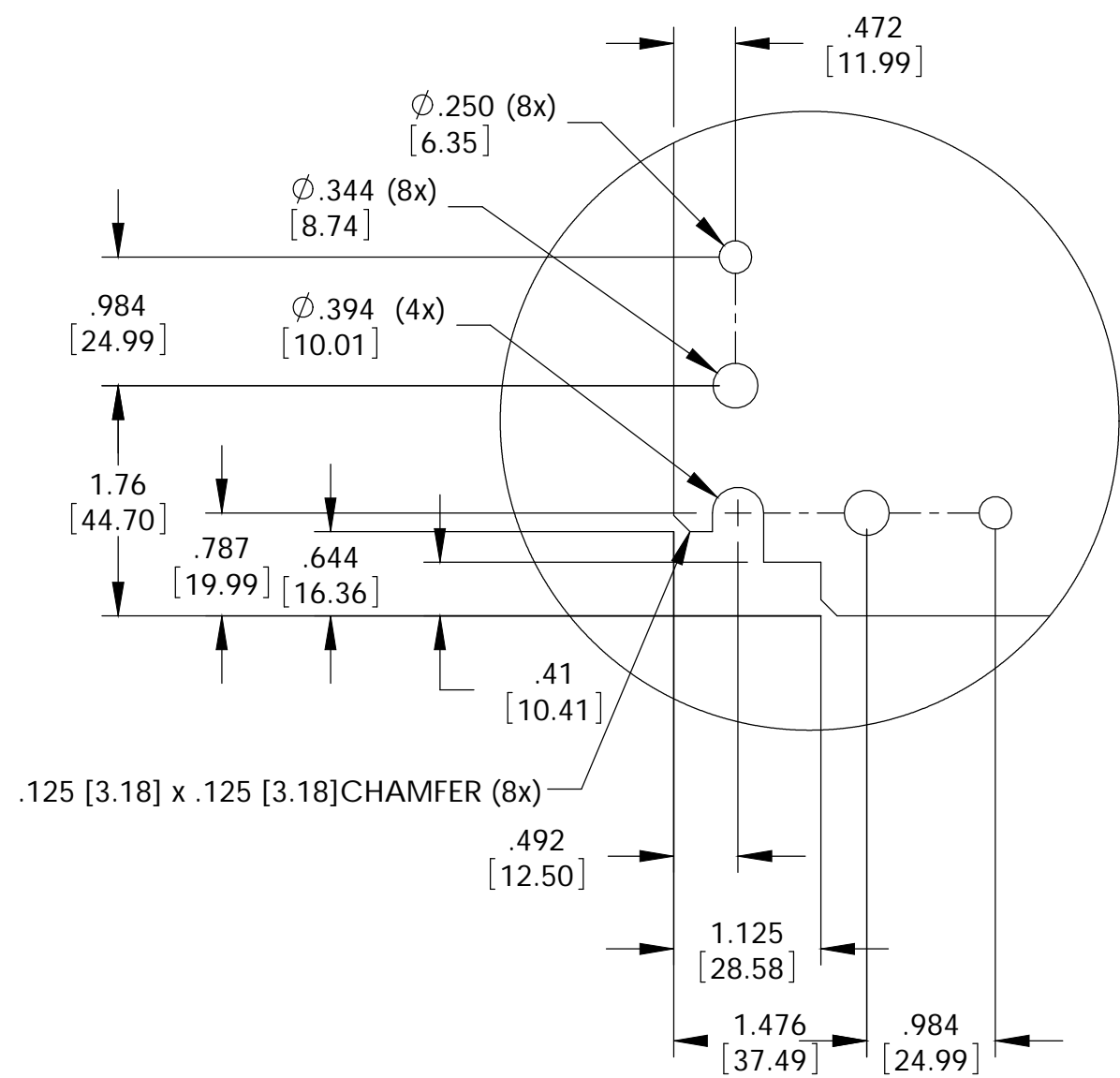

DETAIL A
SCALE 2 : 2.75

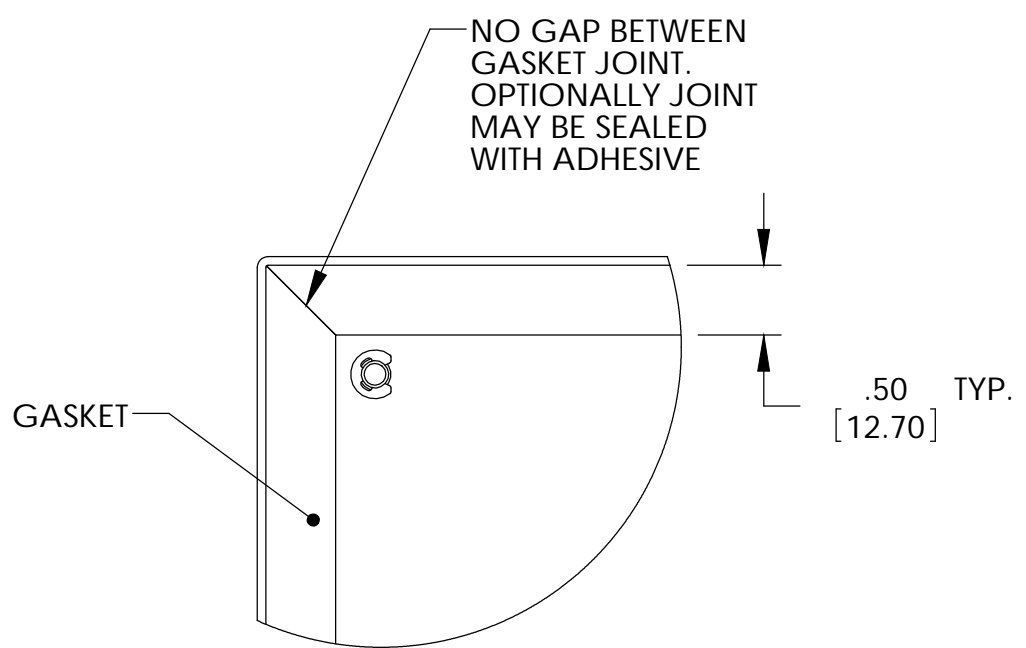

DETAIL B
SCALE 2 : 2.75

UNLESS OTHERWISE SPECIFIED ALL DIMENSIONS ARE IN INCHES (MILLIMETERS)		CAD GENERATED DRAWING, DO NOT MANUALLY UPDATE		BUD INDUSTRIES INC.	
TOLERANCES: DECIMALS: XX +.03 XXX +.010		APPROVALS	DATE		
MATERIAL	AS NOTED	DRAWN DAB	5-5-08	NEMA SHEET METAL BOX W/LIFT-OFF SCREW COVER	
FINISH	AS NOTED	CHECKED			
DO NOT SCALE DRAWING		APPROVED			
		SIZE D	OWG. NO.	SNC-3757	REV.
		SCALE	CAD FILE		SHEET 1 OF 1