

AUXILIARY VIEWS  
SCALE 1:1

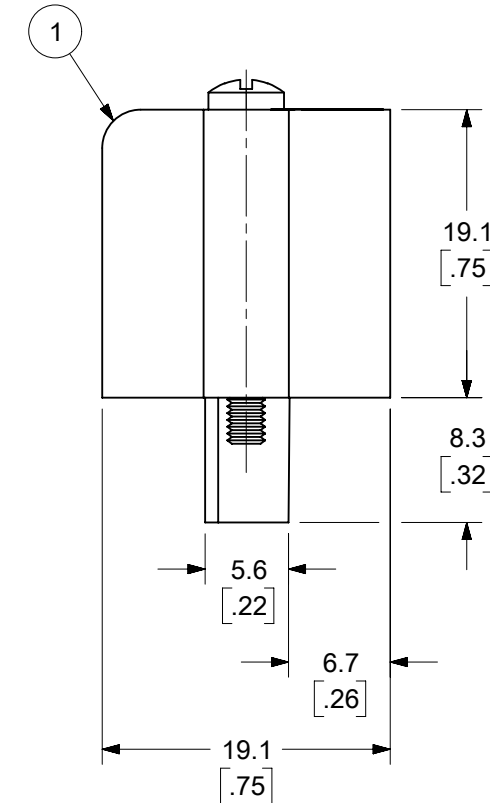

- NOTES:
1. MATERIAL: SEE TABLE
  2. FINISHES: SEE TABLE
  3. PRODUCT SPECIFICATION: NOT REQUIRED
  4. PACKAGING: NOT REQUIRED
  5. MATES WITH: MOST 5.08 (.200) PIN HEADERS
  6. "XX" REFERS TO THE QUANTITY OF CIRCUITS
  7. ROHS COMPLIANT

ITEM	QTY. (EVEN NO. OF CIRCUITS)	QTY. (ODD NO. OF CIRCUITS)	DESCRIPTION	MATERIAL	FINISH
8	2	2	SCREW, MOUNTING, M2.5 X .450	STEEL	ZINC CHROMATE
7	XX	XX	SCREW, M3.5 X .280	STEEL	ZINC CHROMATE
6	XX	XX	NUT, M3.5, HEX	STEEL	ZINC CHROMATE
5	XX/2	(XX-1)/2	REAR ROW TERMINAL (-G30 OPT.)	PHOS. BRONZE	SELECTIVE GOLD
4	XX/2	(XX+1)/2	FRONT ROW TERMINAL (-G30 OPT.)	PHOS. BRONZE	SELECTIVE GOLD
3	XX/2	(XX-1)/2	REAR ROW TERMINAL	PHOS. BRONZE	HOT TIN DIP
2	XX/2	(XX+1)/2	FRONT ROW TERMINAL	PHOS. BRONZE	HOT TIN DIP
1	1	1	BARRIER	THERMOPLASTIC	BLACK

THIS DRAWING CONTAINS INFORMATION THAT IS PROPRIETARY TO MOLEX ELECTRONIC TECHNOLOGIES, LLC AND SHOULD NOT BE USED WITHOUT WRITTEN PERMISSION

FUNCTIONAL SYMBOLS	DIMENSION UNITS	SCALE	CURRENT REV DESC: REMOVED "OPTIONAL 10A IMPRINTING" FROM SHEET-2	<b>molex</b>		
$\frac{E}{A} = 0$	MM/INCH	2:1				
$\frac{E}{E} = 0$	GENERAL TOLERANCES (UNLESS SPECIFIED)			5.08/.200 PLUG ASSY, RWE WITH STD. MOUNTING ENDS (9468XX)		
$\frac{E}{E} = 0$		MM	INCH	PRODUCT CUSTOMER DRAWING		
DIVISIONAL SYMBOLS	4 PLACES	±	---	±	---	EC NO: 790249
	3 PLACES	±	---	±	0.005	DRWN: ABENJAMINLW 2024/06/21
	2 PLACES	±	0.13	±	0.01	CHK'D: DACHAMMER 2024/06/24
	1 PLACE	±	0.3	±	---	APPR: JFMURPHY 2024/07/01
	0 PLACES	±	---	±	---	INITIAL REVISION:
	ANGULAR TOL	±	2.0°			DRWN: CYORK 2004/03/18
	DRAFT WHERE APPLICABLE MUST REMAIN WITHIN DIMENSIONS					APPR: grobertson 2004/03/19
	THIRD ANGLE PROJECTION			DRAWING	SERIES	DOCUMENT NUMBER
				B-SIZE	39940	SD-39940-002
						DOC TYPE
						PSD
						DOC PART
						001
						REVISION
						F3
						MATERIAL NUMBER
						SEE TABLE
						CUSTOMER
						GENERAL MARKET
						SHEET NUMBER
						1 OF 2

NO. OF CIRC. "XX"	"A" +0.3 [-0.5] [+0.01] [-0.02]		"B"		"C" REF.		"D" +0.0 [-0.25] [+0.00] [-0.010]		MATERIAL NO. (STANDARD)
	MM	IN	MM	IN	MM	IN	MM	IN	
03	25.9	[1.02]	10.16	[.400]	20.32	[.800]	15.2	[.60]	399400403
04	31.0	[1.22]	15.24	[.600]	25.40	[1.000]	20.3	[.80]	399400404
05	36.1	[1.42]	20.32	[.800]	30.48	[1.200]	25.4	[1.00]	399400405
06	41.1	[1.62]	25.40	[1.000]	35.56	[1.400]	30.5	[1.20]	399400406
07	46.2	[1.82]	30.48	[1.200]	40.64	[1.600]	35.6	[1.40]	399400407
08	51.3	[2.02]	35.56	[1.400]	45.72	[1.800]	40.6	[1.60]	399400408
09	56.4	[2.22]	40.64	[1.600]	50.80	[2.000]	45.7	[1.80]	399400409
10	61.5	[2.42]	45.72	[1.800]	55.88	[2.200]	50.8	[2.00]	399400410
11	66.5	[2.62]	50.80	[2.000]	60.96	[2.400]	55.9	[2.20]	399400411
12	71.6	[2.82]	55.88	[2.200]	66.04	[2.600]	61.0	[2.40]	399400412
13	76.7	[3.02]	60.96	[2.400]	71.12	[2.800]	66.0	[2.60]	399400413
14	81.8	[3.22]	66.04	[2.600]	76.20	[3.000]	71.1	[2.80]	399400414
15	86.9	[3.42]	71.12	[2.800]	81.28	[3.200]	76.2	[3.00]	399400415
16	91.9	[3.62]	76.20	[3.000]	86.36	[3.400]	81.3	[3.20]	399400416
17	97.0	[3.82]	81.28	[3.200]	91.44	[3.600]	86.4	[3.40]	399400417
18	102.1	[4.02]	86.36	[3.400]	96.52	[3.800]	91.4	[3.60]	399400418
19	107.2	[4.22]	91.44	[3.600]	101.60	[4.000]	96.5	[3.80]	399400419
20	112.3	[4.42]	96.52	[3.800]	106.68	[4.200]	101.6	[4.00]	399400420
21	117.3	[4.62]	101.60	[4.000]	111.76	[4.400]	106.7	[4.20]	399400421
22	122.4	[4.82]	106.68	[4.200]	116.84	[4.600]	111.8	[4.40]	399400422
23	127.5	[5.02]	111.76	[4.400]	121.92	[4.800]	116.8	[4.60]	399400423
24	132.6	[5.22]	116.84	[4.600]	127.00	[5.000]	121.9	[4.80]	399400424

FUNCTIONAL SYMBOLS										THIS DRAWING CONTAINS INFORMATION THAT IS PROPRIETARY TO MOLEX ELECTRONIC TECHNOLOGIES, LLC AND SHOULD NOT BE USED WITHOUT WRITTEN PERMISSION											
DIMENSION UNITS					SCALE					CURRENT REV DESC: REMOVED "OPTIONAL 10A IMPRINTING" FROM SHEET-2											
MM/INCH					2:1					<p><b>molex</b></p> <p>5.08/.200 PLUG ASSY, RWE WITH STD. MOUNTING ENDS (9468XX)</p> <p>PRODUCT CUSTOMER DRAWING</p> <p>EC NO: 790249 DRWN: ABENJAMINLW 2024/06/21 CHK'D: DACHAMMER 2024/06/24 APPR: JFMURPHY 2024/07/01</p> <p>INITIAL REVISION: DRWN: CYORK 2004/03/18 APPR: grobertson 2004/03/19</p>											
GENERAL TOLERANCES (UNLESS SPECIFIED)																					
4 PLACES		±	---	±	---	3 PLACES		±	---											±	0.005
2 PLACES		±	0.13	±	0.01	1 PLACE		±	0.3											±	---
0 PLACES		±	---	±	---	ANGULAR TOL		±	2.0°												
DIVISIONAL SYMBOLS					THIRD ANGLE PROJECTION					DRAWING					SERIES						
										B-SIZE					39940						
DOCUMENT STATUS					P1					RELEASE DATE					2024/07/01 17:23:47						
DOCUMENT NUMBER					SD-39940-002					DOC TYPE					PSD						
DOC PART					001					REVISION					F3						
MATERIAL NUMBER					SEE TABLE					CUSTOMER					GENERAL MARKET						
SHEET NUMBER					2 OF 2																