

PRODUCT NUMBER	PITCH
VCxx00x000J0G	7.62mm

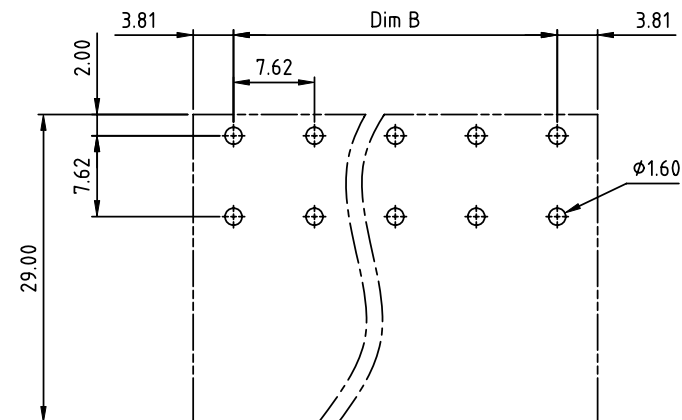

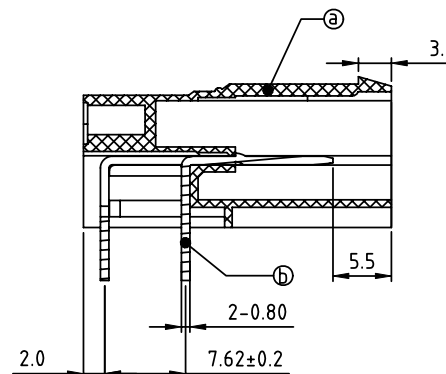
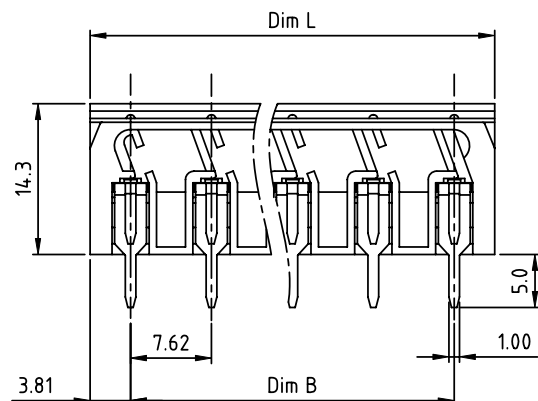
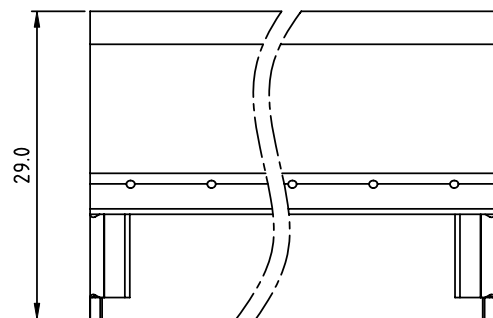

RECOMMENDED P.C.B LAYOUT
TOP VIEW

Material:

- Item① Pin: Copper with Tin plated
- Item② Terminal (housing): Thermoplastic (UL94V-0)

Electrical

- Voltage rating: 300V
- Current rating: 32A
- Withstanding Voltage: 1.6KV
- Operating temperature: -40°C to +115°C
- Soldering temperature: 260°C± 5°C/5 Sec
- Safety Approval:

	cULus	TUV
Voltage rating:	300V	800V
Current rating:	32A	32A
Withstanding Voltage:	1.6KV	6KV
Operating temperature:	-40°C to +115°C	
Soldering temperature:	260°C± 5°C/5 Sec	
Safety Approval:		

N = Number of poles
Dim L=Nx7.62
Dim B=(N-1)x7.62

Poles	Tolerance
2-5p	±0.20
6-10p	±0.30
11-13p	±0.35
14-16p	±0.40

PART NO.: VC xx 00 x 0 00J0 G

Solid block	No. of poles	Color	RoHS compliant (lead<4%) In copper Alloy
02	2 poles	0 Black (RAL9005)	
03	3 poles	2 Red (RAL3001/D)	
...	...	3 Orange(RAL2011/P)	
16	16 poles	4 Yellow(RAL1018/A)	
		5 Green(RAL6018/T)	
		6 Blue (RAL5015/A)	
		8 Grey(RAL7035/D)	
		9 White(RAL1102)	
		C Green(RAL6018/U)	

mat'l. code				surface	tolerance	projection	product family	
ltr	ecn	no	dr	date	ASME Y14.5	ASME Y14.5	TERMINAL BLOCK	
					tolerances unless otherwise specified		title	
					angles	X.±0.5	TERMINAL BLOCK	
					flat	X.X±0.3	PLUGGABLE SOCKET, RIGHT ANGLE	
					X'±1"	X.XX±0.1	TWO TAIL A TYPE	
					dr	EVIN ZHONG 042314	dwg no	
					enrg	EVIN ZHONG 042314	sheet 1 of 1	
					chr	HANKE FENG 042314	VCxx00x000J0G	
					appd	SHI JUN 042314	A4	
							type	
							CUSTOMER Drawing	
sheet index	revision	A						
	sheet	1						